

21395 x (AKA 5573)

21395 X

HP
2008

5573 X (formerly)

PHASE IB
FIELD INVESTIGATION

BRONX RIVER
PEDESTRIAN GREENWAY

BRONX, NEW YORK

NYSDOT PIN # X027.05
NYSOPRHP # 05PR01491

RECEIVED
ENVIRONMENTAL REVIEW

OCT 14 2008

LANDMARKS PRESERVATION
COMMISSION



1106

**PHASE IB
FIELD INVESTIGATION**

BRONX RIVER PEDESTRIAN GREENWAY

BRONX, NEW YORK

**NYSDOT PIN # X027.05
NYSOPRHP # 05PR01491**

Prepared For:
NYSDOT
47-40 21st Street
Long Island City, NY 11101

Prepared By:
Historical Perspectives, Inc.
P.O. Box 3037
Westport, CT 06880

Authors:
Faline Schneiderman-Fox, M.A., R.P.A.
Julie Abell Horn, M.A., R.P.A.
Christine Flaherty, M.A.

August 2008

MANAGEMENT SUMMARY

SHPO Project Review Number (if available): 05PR01491

Involved State and Federal Agencies: NYSDOT

Phase of Survey: Phase IB Field Investigation

Location Information

Location: Both sides of Bronx River between Westchester and East Tremont Avenues in the West Farms and Tremont neighborhoods of the Bronx

Minor Civil Division: 00501

County: Bronx

Survey Area

Length: varies, irregularly shaped parcels and testing areas

Width: varies, irregularly shaped parcels and testing areas

Number of Acres Surveyed: approximately eight acres

USGS 7.5 Minute Quadrangle Map: Central Park and Flushing

Archaeological Survey Overview

Number & Interval of Shovel Tests: 121 shovel tests (STs) at 15 meter intervals and 8 array tests

Number & Size of Units: 5 machine-excavated test trenches (TTs)

Width of Plowed Strips: N/A

Surface Survey Transect Interval: N/A

Results of Archaeological Survey

Number & name of precontact sites identified: None

Number & name of historic sites identified: None

Number & name of sites recommended for Phase II/Avoidance: None

Report Authors(s): Faline Schneiderman-Fox, M.A., R.P.A., Julie Abell Horn, M.A., R.P.A., and Christine Flaherty, M.A., Historical Perspectives, Inc.

Date of Report: August 2008

EXECUTIVE SUMMARY

The New York State Department of Transportation (DOT) has proposed the creation of a Pedestrian Greenway along both sides of the Bronx River. The proposed Greenway site lies between Westchester and East Tremont Avenues in the West Farms and Tremont neighborhoods of the Bronx. An initial review by the New York City Landmarks Preservation Commission (LPC) concluded that the site may be potentially sensitive for Native American and 19th century archaeological sensitivity (LPC Environmental Review April 30, 2004).

The proposed development necessitated the completion of an Archaeological Documentary Study of the project site. The study, completed by Historical Perspectives, Inc. (HPI) in January 2005, addressed the potential archaeological sensitivity of the project site for both precontact and historical resources. As per New York State Office of Parks, Recreation and Historic Preservation (NYSOPRHP) and LPC regulations, the portion of the project site that will experience subsurface disturbance through any form of land manipulation is considered the impact area and is referred to as the Area of Potential Effect (APE). The Archaeological Documentary Study was submitted and accepted by both the NYSOPRHP and the LPC. It identified areas that may have not been disturbed that may have both precontact and/or historical archaeological sensitivity. The site was artificially subdivided into seven distinct study Areas, and it was determined that four of those areas are potentially sensitive for buried resources. Areas 1, 2, 3, and 4 were identified as possibly possessing buried precontact and/or historical deposits.

Area 1 is located in the northernmost portion of the APE, on the east side of the Bronx River between East Tremont Avenue and the Cross Bronx Expressway and is potentially sensitive for both precontact and undocumented mill remains. Area 2 is roughly bounded by the Cross Bronx Expressway and East 174th Street on the east side of the Bronx River, and is potentially sensitive for precontact and 19th century carpet factory remains. Area 3 is located on the east side of the Bronx River between East 174th and East 172nd Streets and is potentially sensitive for precontact resources and a 19th century factory. Area 4 is a small triangular section of the APE bounded by the Bronx River on the west, East 172nd Street on the north, the AMTRAK rail line on the east, and the AMTRAK bridge over the river on the south, and is potentially sensitive for precontact resources.

A Phase IB Archaeological Investigation was completed in July 2008. Fieldwork was undertaken to satisfy the requirements of New York State's environmental review process and Section 106 of the National Historic Preservation Act, and complies with the standards of the NYSOPRHP (New York Archaeological Council 1994; NYSOPRHP 2005), the LPC (CEQR 2001, LPC 2002). The archaeological study complied with the New York State Education Department's *Cultural Resources Survey Program, Work Scope Specifications for Cultural Resource Investigations on New York State Department of Transportation Projects*, March 2004. Archaeologists meeting the Secretary of the Interior's Professional Qualifications Standards (48 FR 44716) and that were Registered Professional Archaeologists (RPA) oversaw the field investigations. A 233 Permit was obtained from the New York State Department of Education, New York State Museum.

For the Phase IB investigation, the Bronx River Greenway project site was tested with the hand excavation of 129 Shovel Tests (STs) and five larger Test Trenches (TTs). Results of the Phase IB testing program revealed no precontact artifacts or features. In addition, no 18th or early 19th century artifacts or features were found in any of the STs or TTs.

A number of STs within the four Areas identified as potentially sensitive for precontact and/or historical period archaeological resources contained limited quantities of late-19th century artifacts. Some of these materials may have been associated with the Astor mansion that once stood where the Cross Bronx Expressway now passes over the site. However, they could just as easily have been dumped on the site from surrounding residential areas or by workers affiliated with the rail lines that border the eastern boundary of the APE. The source of these late 19th century artifacts can not be definitively determined, nor were any of them found *in situ*. The majority of the artifacts recovered appear to date to the early to mid-20th century and likely originated from Starlight Park and or activities associated with the adjacent rail lines. Clearly the disturbance observed in so much of the site is the result of the demolition of Starlight Park, the construction of the Cross Bronx Expressway, the rerouting of the Bronx River, and the earthmoving activities associated with creating the adjacent rail line. Furthermore, some artifacts (spark plugs, a bicycle seat) were probably the result of dumping from nearby businesses and dwellings. None of these 20th century resources are considered to be archaeologically significant because they lack integrity and context. The STs and the five trenches have clearly demonstrated that the Bronx River Greenway site is disturbed, and does not contain intact archaeological deposits. Therefore, no additional archaeological investigations are warranted.

TABLE OF CONTENTS

MANAGEMENT SUMMARY.....	i
EXECUTIVE SUMMARY	ii
TABLE OF CONTENTS	iv
I. INTRODUCTION	1
II. IDENTIFIED RESOURCES AND RESEARCH ISSUES.....	1
III. FIELD METHODOLOGY	3
IV. RESULTS OF SUBSURFACE TESTING.....	4
V. CONCLUSIONS AND RECOMMENDATIONS	7
VI. BIBLIOGRAPHY.....	8

FIGURES

PHOTOGRAPHS

APPENDIX A: RECORD OF EXCAVATED SHOVEL TESTS

APPENDIX B: CATALOG OF RECOVERED ARTIFACTS

LIST OF FIGURES

1. U.S.G.S. Topographic Map: Central Park and Flushing, NY Quadrangles.
2. Project Site Boundaries and Area Designations.
3. Bronx River Greenway, Potential Archaeological Sensitivity.
4. Archaeological Testing Plan 08
5. Archaeological Testing Plan 07.
6. Archaeological Testing Plan 06.
7. Archaeological Testing Plan 05.
8. Archaeological Testing Plan 04.
9. Archaeological Testing Plan 03.
10. Archaeological Testing Plan 02.
11. Archaeological Testing Plan 01.

PHOTOGRAPHS

1. Photograph of ST 8-8, facing south.
2. Location of Trench E, prior to excavation.
3. Photograph and profile of Trench E, east wall.
4. Photograph and profile of Trench D, east wall.
5. Plan view of Trench D, sewer pipe in center of trench.
6. Photograph and profile of Trench C, west wall.
7. Location of Trench B, prior to excavation.
8. Photograph and profile of Trench B, east wall.
9. Trench B east wall close up, profile view and plan view.
10. Photograph and profile of Trench B, west wall.
11. Location of Trench A, prior to excavation.
12. Photograph and profile of Trench A, east wall.
13. Photograph and profile of Trench A, west wall.

I. INTRODUCTION

The New York State Department of Transportation (DOT) has proposed the creation of a Pedestrian Greenway along both sides of the Bronx River. The proposed Greenway site lies between Westchester and East Tremont Avenues in the West Farms and Tremont neighborhoods of the Bronx (Figures 1, 2). An initial review by the New York City Landmarks Preservation Commission (LPC) concluded that the site may be potentially sensitive for Native American and 19th century archaeological sensitivity (LPC Environmental Review April 30, 2004).

The proposed development necessitated the completion of an Archaeological Documentary Study of the project site. The study, completed by Historical Perspectives, Inc. (HPI) in January 2005, addressed the potential archaeological sensitivity of the project site for both precontact and historical resources. As per New York State Office of Parks, Recreation and Historic Preservation (NYSOPRHP) and LPC regulations, the portion of the project site that will experience subsurface disturbance through any form of land manipulation is considered the impact area and is referred to as the Area of Potential Effect (APE). The Archaeological Documentary Study was submitted and accepted by both the NYSOPRHP and the LPC.

The Archaeological Documentary Study identified areas of extensive prior disturbance which now lack archaeological potential, and areas that have not been disturbed that may have both precontact and/or historical archaeological sensitivity. For the ease of discussion and presentation, the site was artificially subdivided into seven distinct study Areas, and it was determined that four of those areas are potentially sensitive for buried resources, while three have experienced extensive disturbance that negated archaeological potential (Figure 3). Areas 1, 2, 3, and 4 were identified as possibly possessing buried precontact and/or historical deposits.

Area 1 is located in the northernmost portion of the APE, on the east side of the Bronx River between East Tremont Avenue and the Cross Bronx Expressway. Area 2 is roughly bounded by the Cross Bronx Expressway and East 174th Street on the east side of the Bronx River. Area 3 is located on the east side of the Bronx River between East 174th and East 172nd Streets. Area 4 is a small triangular section of the APE bounded by the Bronx River on the west, East 172nd Street on the north, the AMTRAK rail line on the east, and the AMTRAK bridge over the river on the south. Figure 3 outlines the Areas determined to have archaeological sensitivity based upon the results of the documentary study. Specifically, the study concluded that:

- Area 1 is potentially sensitive for Native American resources and potential undocumented mill remains;
- Area 2 is potentially sensitive for Native American resources and 19th century carpet factory features;
- Area 3 is potentially sensitive for Native American resources and the footprint and associated shaft features of a 19th century factory; and
- Area 4 is potentially sensitive for Native American resources.

A Phase IB Archaeological Investigation was recommended for archaeologically sensitive areas that will be impacted by the proposed project. This report presents the results of the recommended Phase IB Archaeological Investigation, which was prepared to satisfy the requirements of New York State's environmental review process and Section 106 of the National Historic Preservation Act, and complies with the standards of the NYSOPRHP (New York Archaeological Council 1994; NYSOPRHP 2005), the LPC (CEQR 2001, LPC 2002). The archaeological study was completed in accordance with the New York State Education Department's *Cultural Resources Survey Program, Work Scope Specifications for Cultural Resource Investigations on New York State Department of Transportation Projects*, March 2004. Archaeologists meeting the Secretary of the Interior's Professional Qualifications Standards (48 FR 44716) and that were Registered Professional Archaeologists (RPA) oversaw the field investigations. A 233 Permit was obtained from the New York State Department of Education, New York State Museum, prior to the commencement of any excavations.

II. IDENTIFIED RESOURCES AND RESEARCH ISSUES

A. Precontact Archaeological Resources

The Archaeological Documentary Study (January 2005) and a subsequent Soil Boring Analysis of Areas 1 through 4 (June 2005) concluded that there may be natural strata within the Bronx River Greenway project APE that may be

potentially sensitive for precontact archaeological resources. Typically, precontact resources are encountered within several feet of the predevelopment land surface. An exception to this is when resources were initially deposited on a floodplain along waterways. Yearly flooding can result in the accumulation of alluvial soils which can bury and protect precontact deposits. In an urban environment such as the Bronx, potentially sensitive strata are frequently disturbed by historical development, or buried beneath fill prior to a site being developed. However, the deep alluvial deposits recorded in the soil boring logs taken from the APE may have served to protect potential precontact resources from subsequent historic disturbance.

Coastal and riverine areas could provide a mix of aquatic, estuarial, and terrestrial resources. In particular, the confluences of streams and/or rivers were considered choice sites for habitation and have a high potential to yield precontact-period archaeological resources. Furthermore, riparian land often bears evidence of riverine resource harvesting and processing.

Area 1 is potentially sensitive for precontact resources within the APE. The depth of sensitivity varies, but is generally thought to be from the current grade down to at least the depth of the borings (approximately 33 feet or 10 meters). However, it should be noted that historical development of an amusement park in this vicinity has disturbed the uppermost strata in specific locations which are generally south of East 177th Street and outside of the boring sampling program.

Area 2 possesses seemingly natural soil levels from the current grade down to approximately 49 feet (15 meters) below grade. The water table was encountered at 12 feet (3.6 meters) below grade, suggesting that any precontact deposits below this depth would be inundated. Portions of Area 2 were disturbed by the late-19th /early 20th century construction of an amusement park. Deeply excavated park features, such as a reservoir and pool, would have disturbed at least the top several feet of the ground surface, if not more. Outside of the location of these features, Area 2 is still considered potentially sensitive for precontact resources.

Area 3 is potentially sensitive for precontact archaeological deposits from the current grade down to the depth of potential impacts, which is estimated to be no more than 30 feet (9 meters) below grade, with the exception of the top two feet (60cm) of fill in one area. However, since the water table was encountered between five and nine feet (1.5 to 2.7 meters) below grade, any potential resources below this depth would probably be inundated. Testing efforts would require dewatering below this depth.

Area 4 is potentially sensitive for precontact resources. Two boring logs previously reviewed showed some fill extending from the surface down to between 6 and 10 feet (1.9 to 3 meters) below grade. Potentially sensitive strata may exist below the fill, where it exists, and from the surface down to the depth of bedrock where fill is not evident. However, since the water table ranges from about two to 15 feet (60 cm to 4.5 meters) below grade, any potential resources beneath this depth may be inundated. As with Area 3, testing below the water table would require dewatering.

B. Historical Archaeological Resources

The potential historical archaeological features that may exist within the APE can not be specifically sited on the modern landscape due to the imprecise nature of historical mapping. Nineteenth-century maps and atlases consulted for this project were vague in their siting of structures on the landscape, and sometimes the location of a structure varied depending on the cartographer. Furthermore, the rerouting of the Bronx River and surrounding roads has altered topographic and manmade landmarks from their 19th century configuration. Therefore, while the Archaeological Documentary Study identified locations that are potentially sensitive for historical archaeological resources, the precise footprints and locations of these historical features are not known.

Historical archaeological resources relating to residential and manufacturing sites are often preserved in privies, cisterns, or wells, which in the days before the construction of municipal services - namely sewers and a public water supply - were an inevitable part of daily life. These shafts became convenient receptacles for all sorts of trash, providing a valuable time capsule of stratified deposits for the modern archaeologist. They frequently provide the best resources recovered on urban sites. Truncated portions of these deep shaft features are often encountered because the shafts' deeper, and therefore earlier, layers remain undisturbed by subsequent construction.

Area 1 was found to be potentially sensitive for an unmapped mill or mills in the APE that may have been associated with a water control feature that once ran through this Area. There are no historical Mapped Documented Structures (MDS) in Area 1. David Lydig, who owned this parcel in the 19th century, had a series of prominent mills on the Bronx River north of East Tremont Street. Although none of his mills were mapped in the APE, at one point there was an offshoot of the Bronx River diverted through Area 1 and a dam was built across it. It is possible that there may have been a mill which operated along the river or its offshoot at some point in the vicinity of the APE. The offshoot of the river was filled by 1921 and Area 1 was redeveloped south of East 177th Street as the Starlight Amusement Park (ca. 1918 through the 1940s). South of East 177th Street were a carousel, a theater, and pony track while to the north were four small structures, one of which was a gas station. A comparison of the historical route of the river, when mills may have been located along it, to the river's current location, which was altered by the creation of a bulkhead line and the 1950's realignment, suggests that any mills once located on the banks of the river would have been located west of the current project site boundaries. However, the historical presence of a water control feature in the APE – the offshoot of the river and a dam across it – suggest that a mill or mills may have been present on Lydig's property in the APE.

Area 2 was originally part of William W. Astor's landholdings, with the former Astor mansion located roughly where the Cross Bronx Expressway now passes over the project site. The site of the mansion itself was extensively disturbed when the highway was built in the mid-20th century. In the mid-19th century Smith's Carpet Factory was located somewhere on or adjacent to this tract, however, mid-19th century maps and atlases conflict in their portrayal of the exact location of the factory. One map places it in the APE, while another places it west of the APE on the opposite bank of the Bronx River. Regardless, this was the original carpet factory of Alexander Smith – who established his manufacturing business in West Farms in 1845. Smith moved his factory to Yonkers in the mid-1860s where he expanded it into an enormous manufacturing facility with 45 buildings, 800 looms, and over 4,000 workers. In 1929 Alexander Smith & Sons was the largest manufacturer of carpets and rugs in the world, eventually merging with Mohawk Carpets. From the early 20th century forward, Area 2 was developed in the same manner as Area 1. In 1918 construction began on Starlight Park, and by 1927 Area 2 hosted race car tracks, a roller coaster, numerous gaming stands and rides, a restaurant and dance hall, and a large swimming pool, complete with an artificial beach and reservoir just located north of 174th Street. Excavations for the reservoir and swimming pool probably disturbed any historical archaeological resources that may have once existed in these locations, but the remainder of the APE is considered potentially sensitive for the ca. 1845-1865 carpet factory and associated shaft features.

Area 3 may be potentially sensitive for remnants of a mid-to-late 19th century factory that was mapped in the project site in 1868, but disappeared from maps by 1872. A structure in the same approximate location was later depicted as a dwelling and then an ice house in the early 20th century. The ca. 1868 structure stood prior to the availability of sewer and water lines – which were laid in Westchester Avenue in the late 19th century and documented on Bronx River Avenue between 1921 and 1927 – so there is the potential for shaft features associated with the structure to exist in the APE.

Area 4 was determined to lack historical archaeological potential.

III. FIELD METHODOLOGY

The objective of field testing was to (1) ascertain the presence/absence of precontact and/or historical archaeological resources on the project site and (2) determine the potential significance and National Register eligibility of recovered resources in accordance with 36 CFR Part 800.4(c). The field testing program involved a combination of hand-excavated shovel tests (STs) and machine-aided test trenches (TTs), restricted to locations identified as potentially sensitive within Areas 1-4, which would experience subsurface impacts from development. Phase IB archaeological field testing was conducted by Project Director Faline Schneiderman-Fox, and several archaeological technicians in July 2008.

A Testing Plan and Unanticipated Discovery Plan was prepared by HPI and approved by both the NYSOPRHP and LPC (June 3, 2008 and May 5, 2008 respectively). The testing procedure first entailed completing a series of hand-excavated STs where precontact and historical archaeological resources may be located and for which subsurface impacts are anticipated. Locations where proposed testing had a fill overmantle or was covered by pavement were monitored by archaeologists during mechanical removal of such in order to complete the hand-excavated STs. All

STs were hand excavated and soil was sifted through a 1/4 inch hardware cloth. Artifacts were collected and bagged in the field. The appropriate field notations, drawings, and photographs were made during field testing and each ST was documented. Key locations of STs were surveyed and demarcated on the ground by Langan Engineering.

Due to the season, ground visibility varied according to density of vegetation on the project site. Regardless, a total of 121 STs placed on a grid or in linear transects, and 8 array tests, each 50 cm x 50 cm (20" x 20") were excavated by the archaeologists during the course of fieldwork. Appendix A presents complete ST records for the project site and Appendix B presents the catalog of recovered artifacts.

Following the completion of the STs, five machine-excavated TTs, that were each large enough to allow for the sides to be canted during excavation as allowed by OSHA, were completed. The four corners of each planned TT were surveyed and marked in the field by Langan Engineering, Inc. prior to testing. Backhoe trenches were excavated in such a way that soil strata could be examined, profiled, recorded, photographed, and sampled safely. Complete and detailed profiles of the five TTs are included in this report, including the depth, length, and width of the trench. The trenches generally measured ca. 10 meters x 5 meters (32.8 x 16.4 feet) in plan and ca. 1.524 meters (5 feet) in depth. Where feasible, a narrow trench was excavated down the center of each trench below these depths to see if natural soil levels beneath the fill contained any precontact cultural material. However, for safety reasons, archaeologists refrained from entering this deeper cut, and only examined excavated soils brought up by the backhoe bucket. The final location of each TT was mapped, and photographs of profiles were taken with a photo board and vertical scale. Although the depth of the trenching was not to exceed the anticipated depth of excavation required for construction at that specific location, because of changes to the design plans, trenches in some locations were excavated far below the depths of anticipated impacts.

All excavations proceeded under the direction of a RPA-certified professional archaeologist who is experienced working with heavy machinery, and who had the authority to direct the depth and breadth of all mechanical action, including suspending excavations.

IV. RESULTS OF SUBSURFACE TESTING

As noted above, four Areas were deemed sensitive for archaeological resources by the Archaeological Documentary Study. Each Area subjected to Phase IB testing is addressed separately, below. Corresponding Testing Plans, numbered 01 through 08, depict the results of testing (see Figures 4 through 11).

Area 1 (Archaeological Testing Plans 07 and 08; Figures 4 and 5)

A total of 18 STs were excavated in Area 1; eight in a paved parking lot north of East 177th Street, and ten in an unpaved area uphill and east of the Bronx River south of East 177th Street (Figures 4 and 5). Pavement was removed by a backhoe under the supervision of an archaeologist, and STs were then excavated by hand. Although nine STs were planned for the area north of East 177th Street, only eight could be completed as one of the STs was sited where land was too sloped and disturbed to test (greater than 30% slope; see Figure 4).

STs excavated north of East 177th Street, numbered 8-1 through 8-9 (Figure 4), were generally deep, extending down to as much as 93cm (37ins) below existing grade (Appendix A). Most STs contained relatively modern material in the uppermost fill levels, with sterile soils or degrading bedrock beneath. No definitively historical period deposits or precontact material was encountered (Appendix B).

To the south of East 177th Street, STs 8-10 through 8-12, and 7-1 through 7-7 were completed (Figures 4 and 5; Photograph 1). STs were generally shallower than those excavated to the north as concrete obstructions were encountered immediately beneath fill (Appendix A). Again, no definitively historical period deposits or precontact material was encountered in this Area (Appendix B).

After the STs were completed, TTs were then excavated to see if any intact deposits existed below the depths reached by the hand-excavated STs. Three TTs were completed in a paved parking lot immediately west of the MTA West Farms depot parking area, and east of the Bronx River. A backhoe was employed to remove the existing blacktop and a gravel base. Due to logistic constraints and the length of the backhoe arm, trenches were excavated in halves with the trench split into north and south sections – each five meters (16.5 feet) in length.

Trench E was excavated in the paved parking lot that lies between the MTA Bus Depot parking lot to the east – and out of the APE – and the unpaved land uphill of the Bronx River to the west (Figure 4). The trench was originally planned to be excavated fairly close to East 177th Street, but it was shifted to the south by 10 meters in order to avoid unmapped drainage culverts that would have otherwise been in the center of the trench (Photograph 2).

Trench E encountered multiple fill levels throughout (Photograph 3; Appendix B). Boulder fill was found beneath more modern fill down to about nine feet below grade (2.75 meters). A pocket of late 19th to early 20th century fill, containing bottles (e.g., an Albert Krumenaker lager bottle dating to between 1893 and 1913), whiteware, and a piece of salt-glazed stoneware, was encountered along the western portion of the trench (Appendix B). However, it was not entirely distinct from the mixed 19th and 20th century deposits around it. The mixing of artifacts was probably due to the presence of several large subsurface features. A poured concrete pier, possibly a base of a former parking lot lamp or similar feature, was observed in eastern wall of the trench (Photograph 3). Fill levels around this contained mixed 19th and 20th century material, with an extensive collection of bottles dating to the early 20th century (Appendix B). Most of the material appeared to have been associated with Starlight Park, built in 1918, or possibly dumping that occurred prior to this. There was an obvious lack of domestic resources and architectural debris, other than a few bricks. No evidence of undocumented mill remains or 18th century material was recovered.

South of this, Trench D was also excavated in the parking lot, west of the MTA Bus Depot parking area and east of the Bronx River (Figure 5). Concrete piers reinforced with rebar were encountered in both the eastern and western wall of the trench (Photograph 4). These appeared to be either lamp post bases or structure supports, but were clearly of 20th century origin. Multiple fill levels were encountered, and there was fairly modern (mid-to-late 20th century) material encountered throughout the trench, such as rubber and plastic, as well as a spark plug dating to the late 1960s (Appendix B). After the trench was excavated to about 1.65 meters (5.4 feet) in depth, and all mapping and photographs were completed, a deeper narrow trench was excavated from north to south through the center of the trench (Photograph 5). This revealed the presence of an unmapped sewer pipe, measuring roughly 90 cm (3 feet) in diameter. Original excavations for the installation of the pipe clearly disturbed the upper levels, as did the installation of the two reinforced concrete piers. No undisturbed artifact deposits were encountered.

Trench C was excavated to the south of Trench D, immediately east of an entrance ramp to the Cross Bronx Expressway (Figure 5). Again, multiple fill levels with late 19th and early 20th century material were found throughout the TT (Appendix B; Photograph 6). This trench encountered the most domestic material of all the trenches, including bottles, ceramics, and cut bone (Appendix B).

Beneath the uppermost level of pavement, a layer of gravel bedding, and a layer of 20th century fill, evidence of an earlier poured cement drive or walkway was encountered along the eastern portion of the trench (Appendix A). The location and presence of 20th century material immediately above it suggests that it was a walkway or internal road affiliated with Starlight Park (ca. 1918-1940s), and was covered over when the Cross Bronx Expressway was constructed. Beneath this were mixed deposits of late 19th and early 20th century material predating the 1940s that included brick, bone, bottle glass, and cut stone pavers measuring roughly 18x12.5x10cm (7x5x4ins) (Appendix B). One possible feature was identified; a pocket of distinct soil with red and yellow bricks, as well as a shoe, that was observed emanating from the western wall (Photograph 6). The feature was interpreted as a discrete dumping episode, probably dating to the 20th century demolition of Starlight Park. Beneath and slightly north of this discrete dumping episode was a rusting 12.7cm (5ins) water pipe jutting out of the west wall, indicating that at least a portion of the trench had previously been excavated and disturbed for the installation of municipal water (Photograph 6).

The STs and TTs excavated in Area 1 found extensive subsurface disturbance associated with the construction and demolition of Starlight Park in the early-to-mid 20th century, the construction of the Cross Bronx Expressway in the mid-20th century, and the creation of a parking area in the late 20th century. No undisturbed historical or precontact deposits were encountered in any portion of Area 1, and none are anticipated due to the extent of prior disturbance.

Area 2 (Archaeological Testing Plans 06 and 07; Figures 6 and 7)

A total of 67 STs were excavated in Area 2 (Figures 6 and 7). These were numbered ST 6-1, and 5-1 through 5-67 (minus 5-43 which was not completed) (see Appendix A). Most of the STs in this area encountered fill over concrete or rock obstructions, most likely the remnants of a bathhouse, pool, and cement lined reservoir that covered

much of this Area when Starlight Park was in business. Although scattered fragments of late 19th and early-to-late 20th century material was found, no intact historical deposits or precontact material was recovered from any of the STs in Area 2 (Appendix B).

In an attempt to examine soils beneath the pavement and rock encountered in so many of the STs in order to see if there was any intact stratigraphy, Trench B was planned to be excavated near the Bronx River. However, because of a change in the design plans to the proposed park, deep impacts from the proposed project were no longer anticipated for this location. As a result, Trench B was shifted to the north and east where deeper (ca. 1.5 meters [5 feet]) impacts are planned. Both LPC and the NYSOPRHP approved the relocation of the trench (July 7, 2008).

The relocated Trench B was placed southwest of the West Farms Bus Depot parking lot between mature trees (Photograph 7; Figure 7). The uppermost fill level contained dozens of plexiglass sheets and modern debris. Beneath this, along the eastern edge of the trench, were a poured cement walkway and the eastern wall of the pool that was built as part of Starlight Park (ca. 1918). Excavations extended to 1.5 meters (5 feet) below grade, in an attempt to get beneath the level of disturbance by the pool to see if intact precontact or historical features were present. Several additional cement and fill levels were noted, and wood planks, which probably served as forms for the poured concrete, were observed up against the cement pool wall (Photograph 8). No undisturbed precontact or historical deposits were encountered, as the pool depth extended below the depth of proposed impacts, and beyond the depth of the trench (Figure 7; Photographs 8 and 9). The poured-cement pool wall still bore evidence of its turquoise paint.

Backfill in the pool's concavity consisted of concrete slabs from the pool's demolition, bottles, whiteware, sheet metal, plastic, bone, iron, ceramic floor and wall tiles, wood planks, and a few bricks (Appendix B; Photograph 10). Most of the material appeared to be associated with the site's use as an amusement park. No undisturbed intact features or deposits were encountered. The artifacts generally dated from the late 19th through mid-20th century, suggesting that the fill layers did not represent evidence of historic occupation, but rather dumping and other earthmoving episodes associated with the demolition of Starlight Park and possibly the construction of the Cross Bronx Expressway immediately to the north.

The STs and TT demonstrated that Area 2 was extensively disturbed by the creation and subsequent demolition of Starlight Park in the early 20th century. No evidence of Native American resources and/or 19th century carpet factory features was encountered.

Area 3 (Archaeological Testing Plans 02, 03, and 04; Figures 8, 9, and 10)

A total of 23 STs were excavated in Area 3 along the route of proposed walkways (Figures 8, 9, and 10). These were STs 4-1 through 4-11; 3-1, and 2-1 through 2-8, 2-13, and 2-14. In most locations, fill levels were found immediately above rock obstructions (Appendix A). Cultural material recovered dated to the 20th century (e.g., aluminum foil, modern bottle glass, and plastic), with the exception of one questionable chert flake that was encountered in the second level of ST 2-8 (Appendices A, B; Figure 10). An array of eight additional STs was completed around ST 2-8, with tests placed at 1 and 3 meter (3.3 and 9.8 foot) intervals in each of the cardinal directions. No additional precontact cultural material was found in any of the STs (Appendix A).

Area 3 did not possess any undisturbed stratigraphy, and was likely disturbed by the rerouting of the Bronx River and the construction of railroad tracks immediately to the east. No intact precontact resources were recovered, nor were any historical features or artifacts related to a 19th century factory that may have once stood in or near this Area.

Area 4 (Archaeological Testing Area 01; Figure 11)

Eight STs were excavated in Area 4 (Appendix A; Figure 11). These were numbered 1-1 through 1-8 (Figure 11). Very little cultural material was recovered from Area 4, with all of the artifacts dating to the 20th century (Appendix B).

After the STs were completed, and a NYS DEP permit was obtained, Trench A was excavated in Area 4. The trench was placed mid-way between the Bronx River to the west and AMTRAK railroad tracks to the east (Figure 11;

Photograph 11). Excavations to 1.5 meters (5 feet) below grade found multiple fill levels, as shown on Photographs 12 and 13.

Artifacts were noted in many of the fill layers, and included railroad related debris (metal spikes, wood planks, a sign-post base, etc.) limited architectural debris (red brick, smaller cut stones, concrete chunks, etc.) and an extremely limited amount of domestic debris (a rubber bicycle seat cover, whiteware, and several bottles; see Appendix B). Within the trench, there was no evidence of any intact features, or remnants of a factory that once stood near this location. The trench stratigraphy clearly reflected extensive disturbance, probably from the construction of the railroad tracks. The artifacts dated from the 20th century, suggesting that the fill layers did not represent evidence of historic occupation, but rather dumping or other earthmoving episodes associated with non-site specific activities.

V. CONCLUSIONS AND RECOMMENDATIONS

In total, the Bronx River Greenway project site was tested with the hand excavation of 129 STs and five larger TTs. Results of the Phase IB testing program revealed no precontact artifacts or features. In addition, no 18th or early 19th century artifacts or features were found in any of the STs or TTs.

A number of STs within the four Areas identified as potentially sensitive for precontact and/or historical period archaeological resources contained limited quantities of late-19th century artifacts. Some of these materials may have been associated with the Astor mansion that once stood where the Cross Bronx Expressway now passes over the site. However, they could just as easily have been dumped on the site from surrounding residential areas or by workers affiliated with the rail lines that border the eastern boundary of the APE. The source of these late 19th century artifacts can not be definitively determined, nor were any of them found *in situ*. The majority of the artifacts recovered appear to date to the early to mid-20th century and likely originated from Starlight Park and or activities associated with the adjacent rail lines. Clearly the disturbance observed in so much of the site is the result of the demolition of Starlight Park, the construction of the Cross Bronx Expressway, the rerouting of the Bronx River, and the earthmoving activities associated with creating the adjacent rail line. Furthermore, some artifacts (spark plugs, a bicycle seat) were probably the result of dumping from nearby businesses and dwellings. None of these 20th century resources are considered to be archaeologically significant because they lack integrity and context.

The STs and the five trenches have clearly demonstrated that the Bronx River Greenway site is disturbed, and does not contain intact archaeological deposits. Therefore, no additional archaeological investigations are warranted.

VI. BIBLIOGRAPHY

Historical Perspectives, Inc. (HPI)

2005 *Archaeological Documentary Study, Bronx River Pedestrian Greenway DOT PIN X027*. Prepared for AKRF, Inc., New York.

New York Archaeological Council (NYAC)

1994 *Standards for Cultural Resource Investigations and the Curation of Archaeological Collections*. The New York Archaeological Council.

New York State Historic Preservation Office (SHPO)

2005 *Phase I Archaeological Report Format Requirements*. Prepared by the New York State Historic Preservation Office (SHPO), April, 2005.

U.S.G.S.

1979 *Central Park, N.Y.-N.J. and Flushing, N.Y. Quadrangles*. United States Geological Survey, U.S. Department of the Interior.

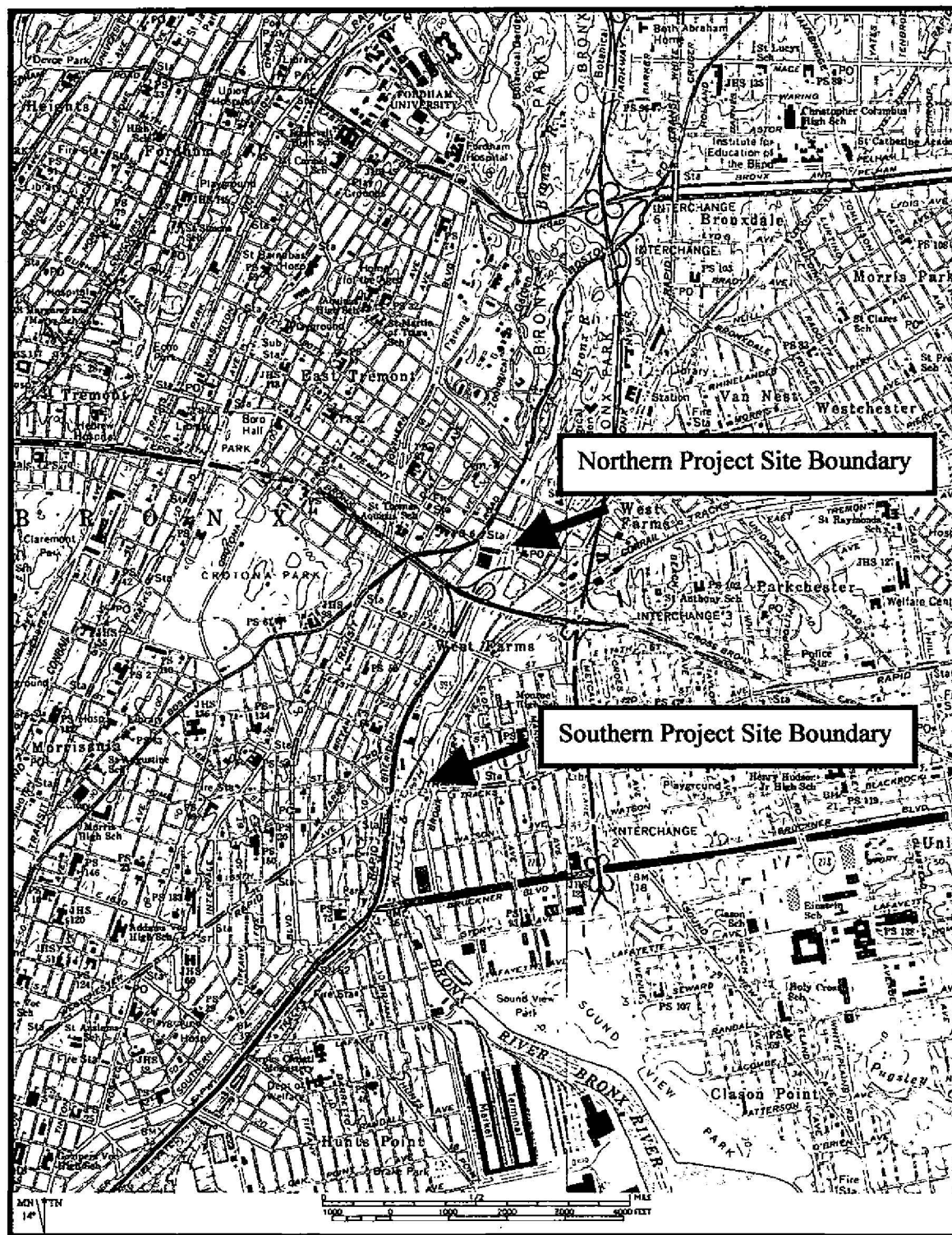

FIGURE 1

U.S.G.S. Topographic Map: Central Park and Flushing, NY Quadrangles.

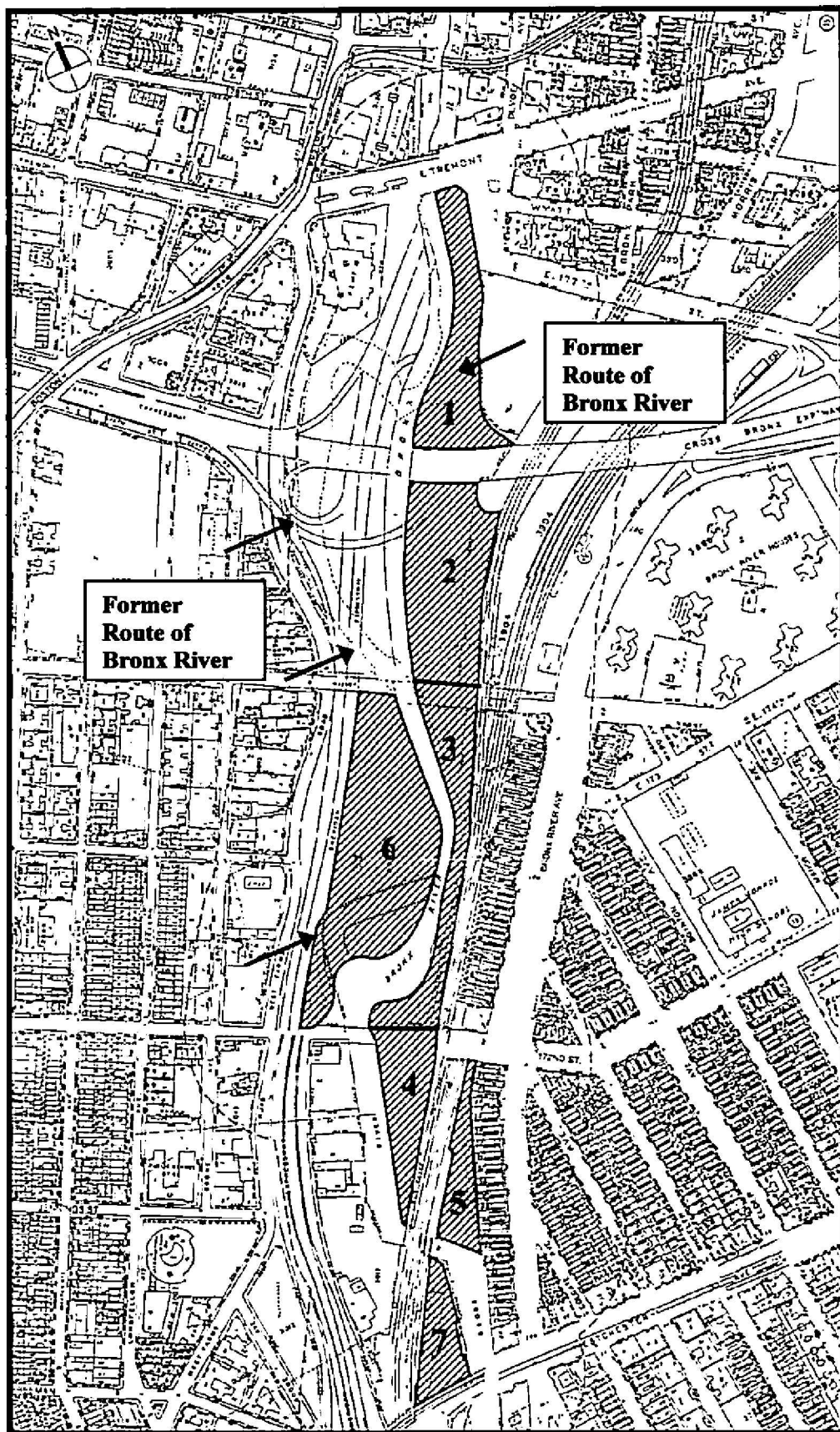
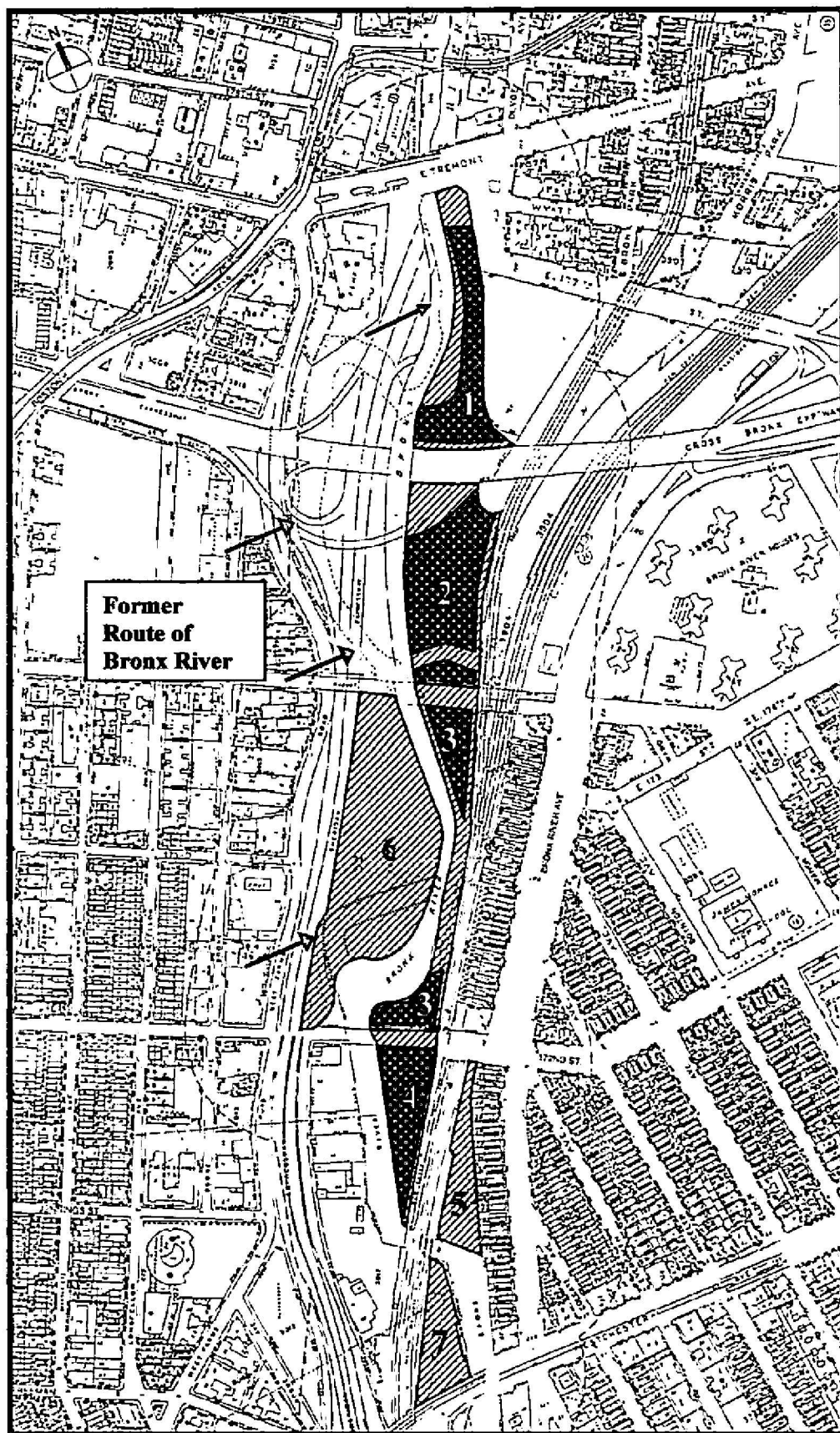

FIGURE 2

Project Site Boundaries and Area Designations.
Note: Dashed lines indicate former route of Bronx River.



 POTENTIAL ARCHAEOLOGICAL SENSITIVITY

FIGURE 3
Bronx River Greenway, Potential Archaeological Sensitivity.

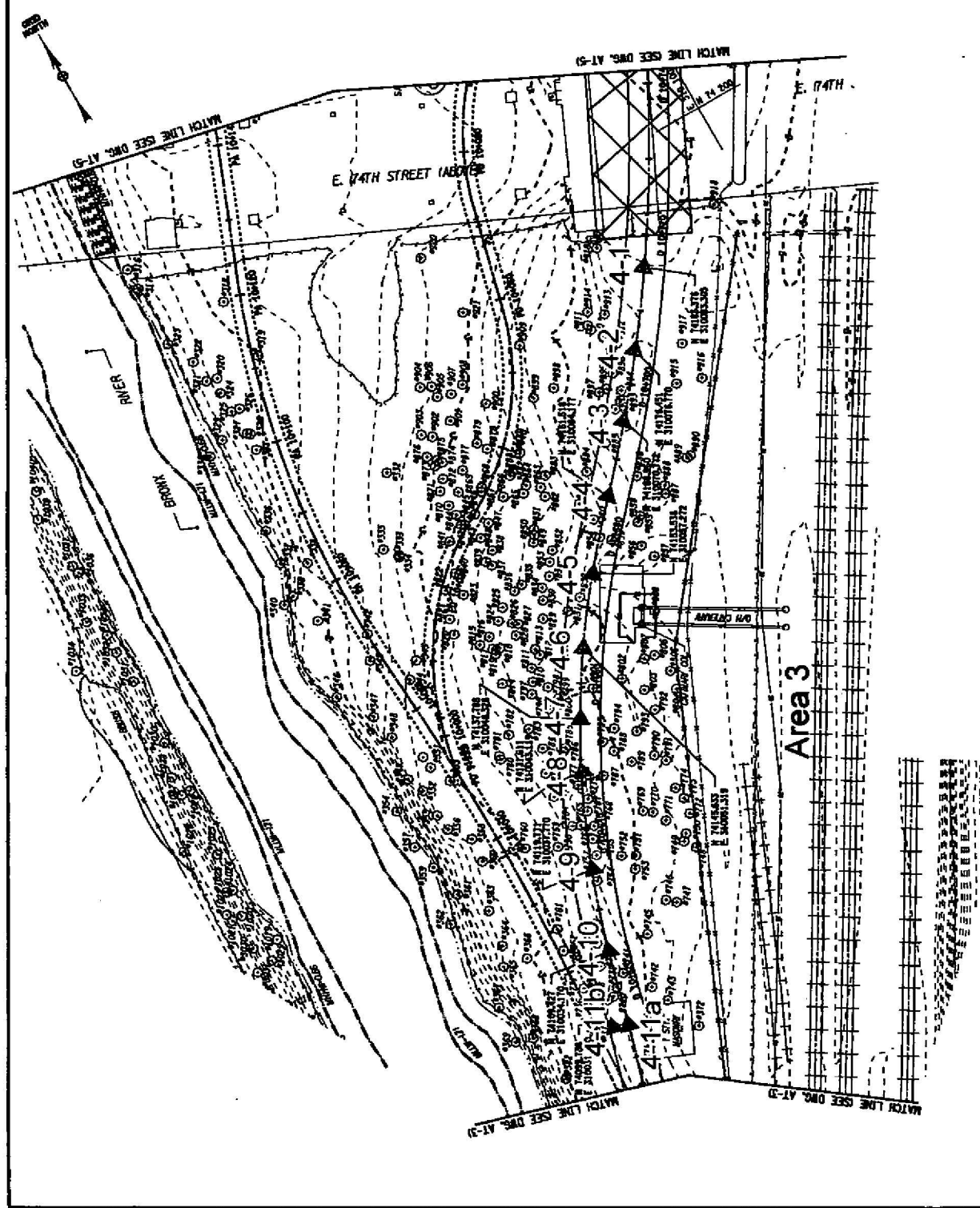

PROJECT NAME	STATE	COUNTY	SHEET NO.	TOTAL SHEETS
BRONX RIVER GREENWAY	NY	BRONX	1	1
PROJECT LOCATION				
WESTCHESTER AVENUE TO EAST TRENT AVENUE				
BRONX COUNTY				

- LEGEND:**
- SAMPLE TESTS
 - DISTURBED - NO TESTING
 - PROPOSED 10m x 10m GRID
 - APPROXIMATE LOCATIONS
 - MEAN HIGHER HIGH WATER
 - MEAN LOWER LOW WATER
 - ELEVATION POINT

NOTES:
SEE ARCHAEOLOGICAL TESTING NOTES



ALL DIMENSIONS ARE IN M UNLESS OTHERWISE NOTED
AS BUILT EXISTING

FIGURE 8 ARCHAEOLOGICAL TESTING PLAN 04

STATE OF NEW YORK
DEPARTMENT OF TRANSPORTATION

SECTION	DATE	PROJECT NO.
11	03/17/2008	AT-14

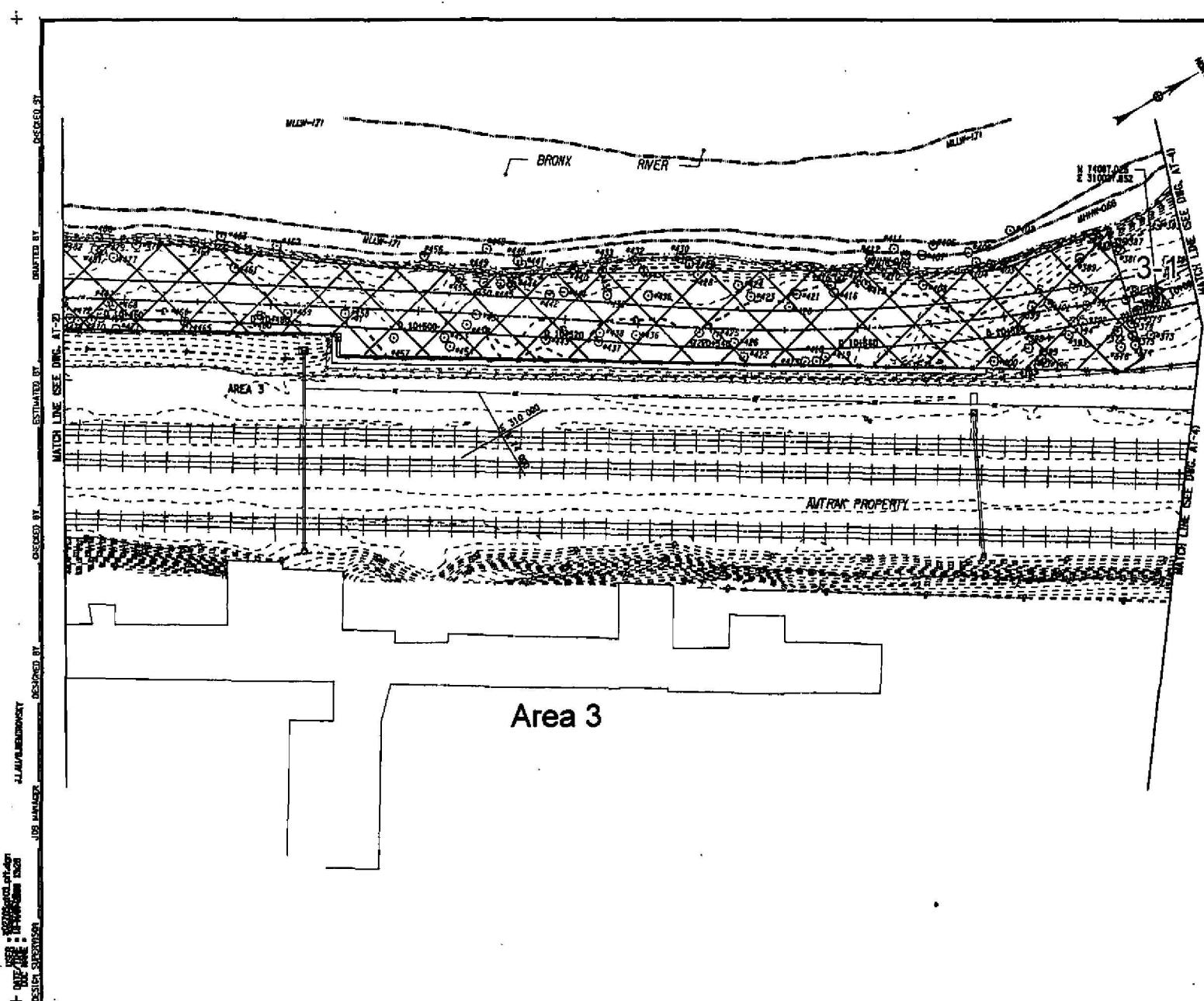

FED. ROAD REG. NO.	STATE	CONTRACT NO.	SHEET NO.	TOTAL SHEETS
3	N.Y.	B.L.N.		
P.L.N. X027.05				
BRONX COUNTY				
BRONX RIVER GREENWAY				
WESTCHESTER AVENUE TO EAST TREMONT AVENUE				

- LEGEND**
- SHOVEL TESTS
 - DISTURBED - NO TESTING
 - PROPOSED (10m x 5m TEST TRENCHES APPROXIMATE LOCATIONS)
 - MEAN HIGHER HIGH WATER
 - MEAN LOWER LOW WATER
 - COORDINATE POINT

NOTES:
SEE ARCHAEOLOGICAL TESTING NOTES

0 5 10 15 20 25 m
HORIZONTAL SCALE = 1:500
(B - SIZE SHEET)

ALL DIMENSIONS ARE IN M UNLESS OTHERWISE NOTED
AT ALL TESTATIONS

FIGURE 9	
SIGNATURE	DATE
ARCHAEOLOGICAL TESTING PLAN 03	
STATE OF NEW YORK DEPARTMENT OF TRANSPORTATION	
REGION 11	DATE 03/17/2008
DRAWING NO. AT-3	

DESIGNED BY: [blank]
 DRAFTED BY: [blank]
 ESTIMATED BY: [blank]
 CHECKED BY: [blank]
 APPROVED BY: [blank]
 DESIGN APPROVAL: [blank]

FED. ROAD STATE		CONTRACT NO.		SHEET TOTAL	
NO. 1		1		1	
P.L.N. 1077.25		B.L.N.		BRONX COUNTY	
BRONX RIVER OVERLAY SEGMENT					
WESTCHESTER AVENUE TO EAST TRENT AVENUE					

- LEGEND:
- SHOVEL TESTS
 - DISTURBED - NO TESTING
 - PROPOSED 400 X 800 TEST TRENCHES APPROXIMATE LOCATIONS
 - MEAN HIGHER HIGH WATER
 - MEAN LOWER LOW WATER
 - CONDUIT
 - POINT

NOTE: SEE ARCHAEOLOGICAL TESTING NOTES

HORIZONTAL SCALE = 1" = 40'

VERTICAL SCALE = 1" = 10'

ALL DIMENSIONS ARE IN FEET UNLESS OTHERWISE NOTED

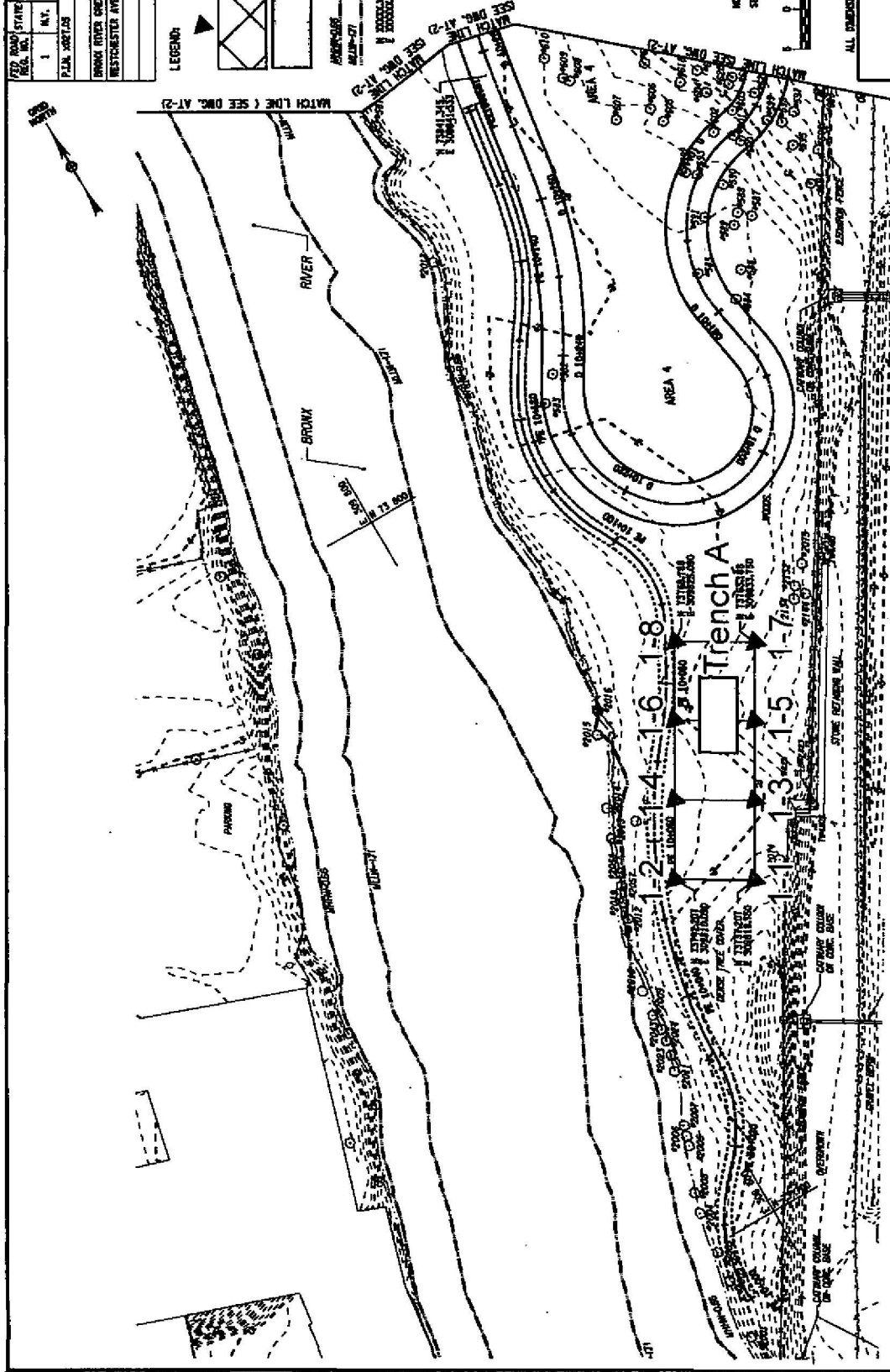

Area 4

FIGURE 11 ARCHAEOLOGICAL TESTING PLAN 01

STATE OF NEW YORK

DEPARTMENT OF TRANSPORTATION

SECTION 11

DATE 05/17/2008

DESIGN NO. 41-1

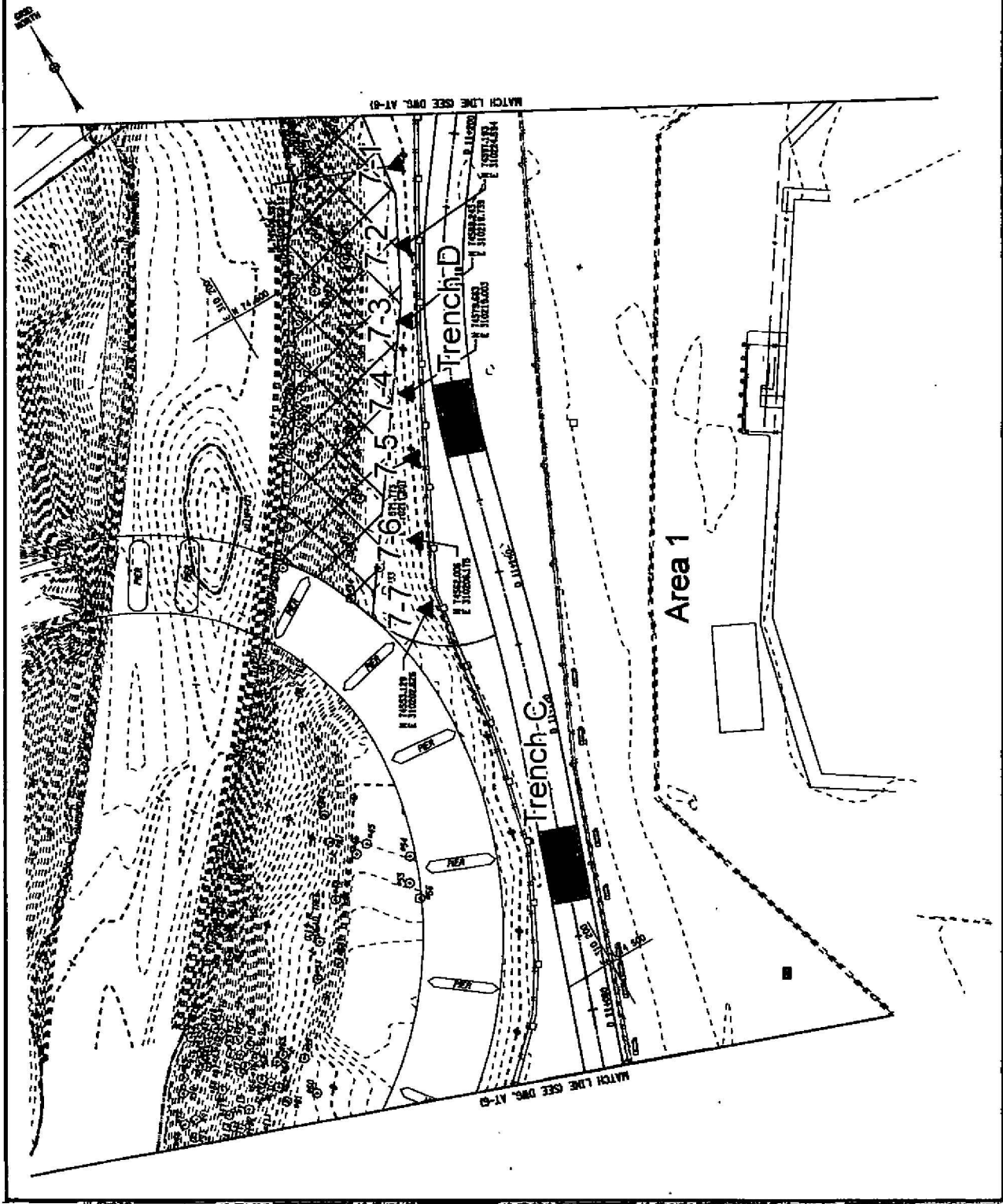

FED. ROAD DIST. NO.	STATE	CONTRACT NO.	SHEET NO.	TOTAL SHEETS
1	NY			
P.L.A. DIST. NO.				
BRONX COUNTY				
BRONX RIVER CREEKWAY SEGMENT				
RESTORATION FROM TO EAST TOWARD AVENUE				

- LEGEND**
- ▲ SURVEY TESTS
 - DISTURBED - NO TESTING
 - PROPOSED LOW 4' 6" TEST TRENCHES (APPROXIMATE LOCATIONS)
 - MEAN HIGHER HIGH WATER
 - MEAN LOWER LOW WATER
 - CORROBORATE POINT

NOTES:
SEE ARCHAEOLOGICAL TESTING NOTES



ALL DIMENSIONS ARE IN M. UNLESS OTHERWISE NOTED.
AS NOTED OTHERWISE

FIGURE 5 **ARCHAEOLOGICAL TESTING PLAN 07**

STATE OF NEW YORK DEPARTMENT OF TRANSPORTATION	
REGION	DATE
11	02/17/2008
DRAWING NO. AT-7	



Bronx River Greenway Phase IB
Photograph 1: Photograph of ST 8-8, facing south.





Bronx River Greenway Phase IB
Photograph 2: Location of Trench E, prior to excavation.





Legend



Level 1, Gravel



Level 2, Fill, 10 YR
4/4 fine silty sand



Level 3, Fill, 10 YR
4/3 and 3/1, gravelly
silty coarse sand

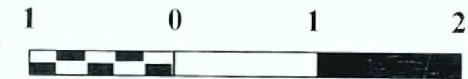

Scale in Meters

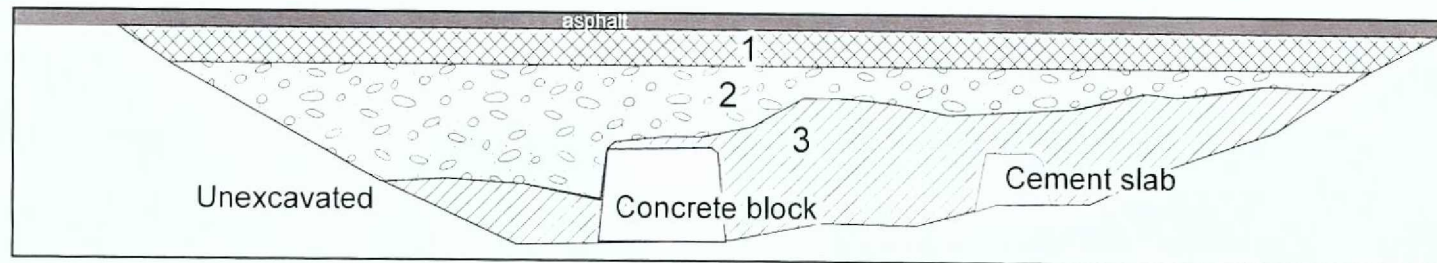

Bronx River Greenway Phase IB
Photograph 3: Photograph and profile of Trench E, east wall.



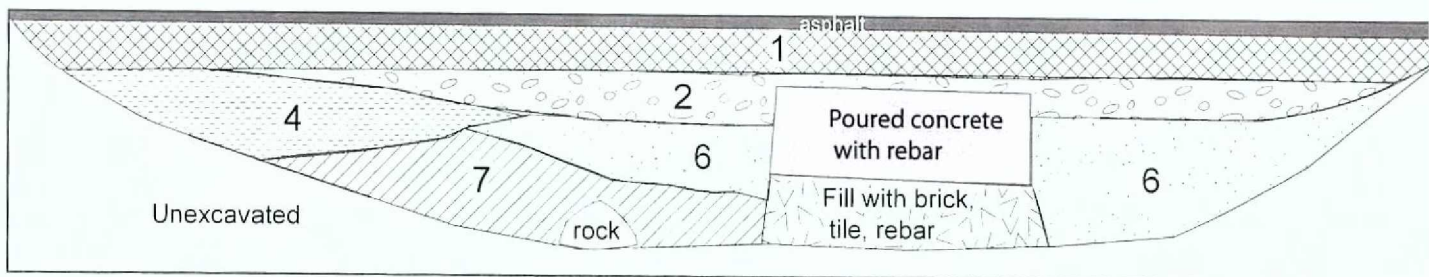
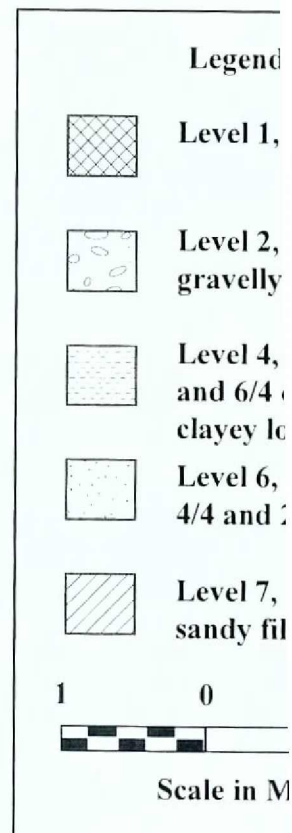

Bronx River Greenway Phase IB
 Photograph 4: Photograph and profile of Trench D, east wall.





Bronx River Greenway Phase IB

Photograph 5: Plan view of Trench D, sewer pipe in center of trench.





Legend



Level 1, Gravel



Level 2, 7.5 YR 4/4
fill with red brick



Level 7, 7.5 YR
4/6 sandy silt with
yellow and red bricks



Feature 1, 7.5 YR 5/4,
red and yellow bricks,
cobblestone, shoe

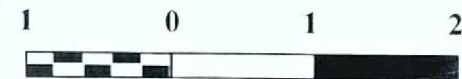

Scale in Meters

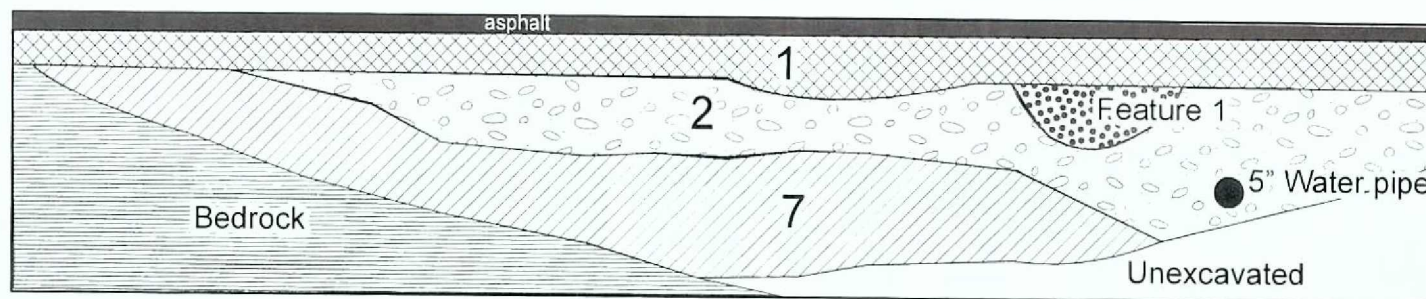

Bronx River Greenway Phase IB

Photograph 6: Photograph and profile of Trench C, west wall.





Bronx River Greenway Phase IB
Photograph 7: Location of Trench B, prior to excavation.



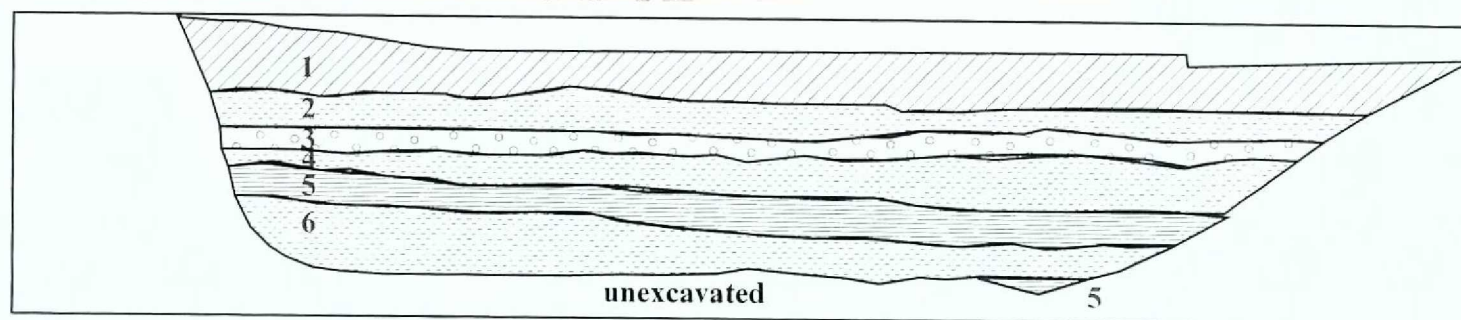
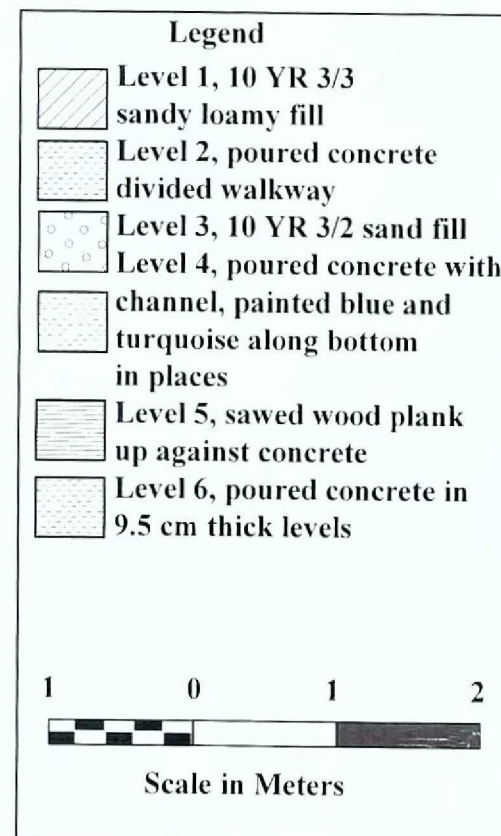

Bronx River Greenway Phase IB
 Photograph 8: Photograph and profile of Trench B, east wall





Bronx River Greenway Phase IB
 Photograph 9: Trench B east wall close up, profile view and plan view.



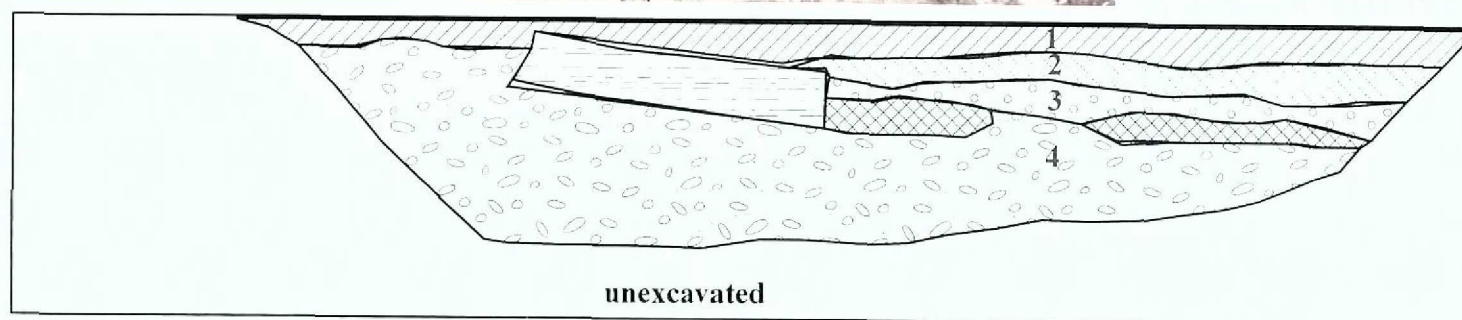
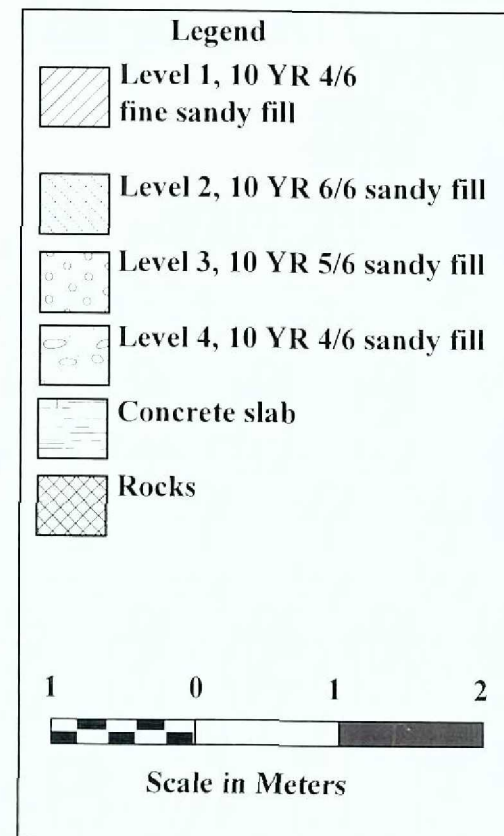

Bronx River Greenway Phase IB
 Photograph 10: Photograph and profile of Trench B, west wall





Bronx River Greenway Phase IB
Photograph 11: Location of Trench A, prior to excavation.





Legend



Level 1, 10 YR 2/1
fine sandy silt



Level 2, 10 YR 5/6
silty sand mottled
with 10 YR 5/2 compact
fill



Level 3, Moist 10 YR
3/1 gravelly sand
mottled with 10 YR 5/2
sand



Scale in Meters

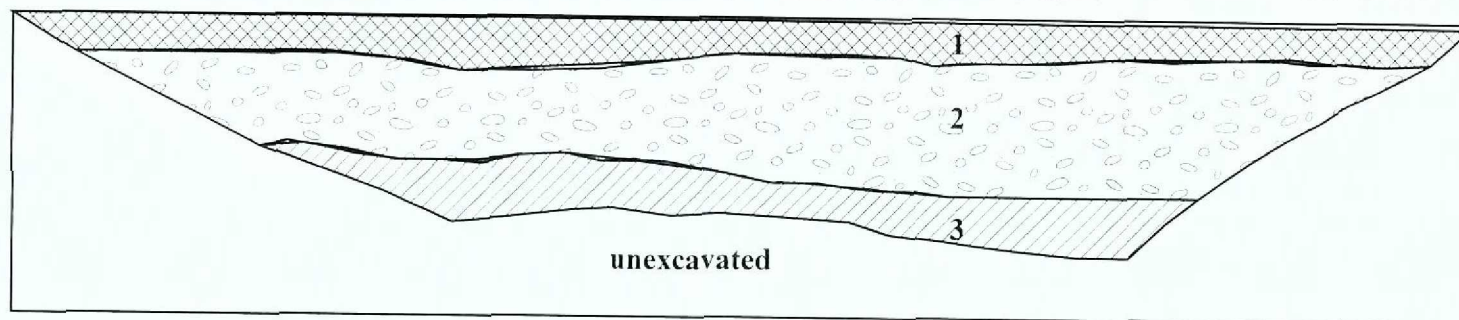

Bronx River Greenway Phase IB

Photograph 12: Photograph and profile of Trench A, east wall



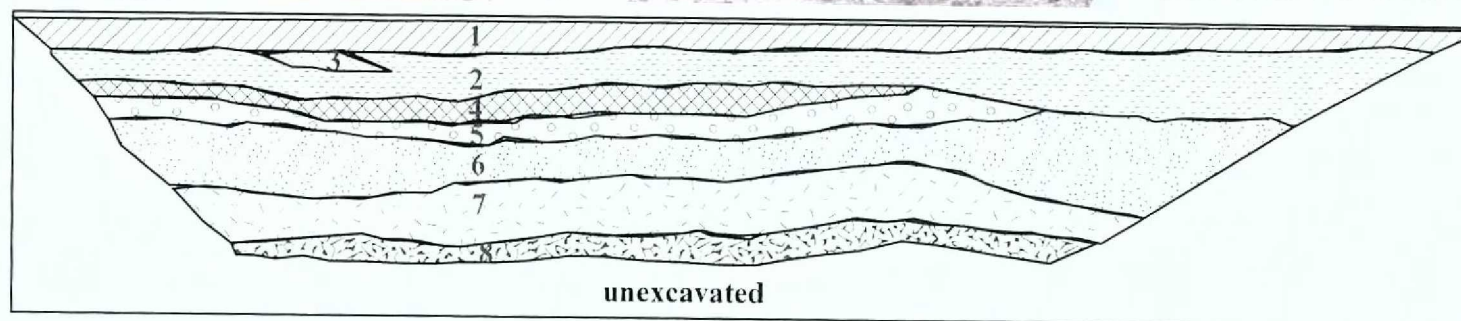
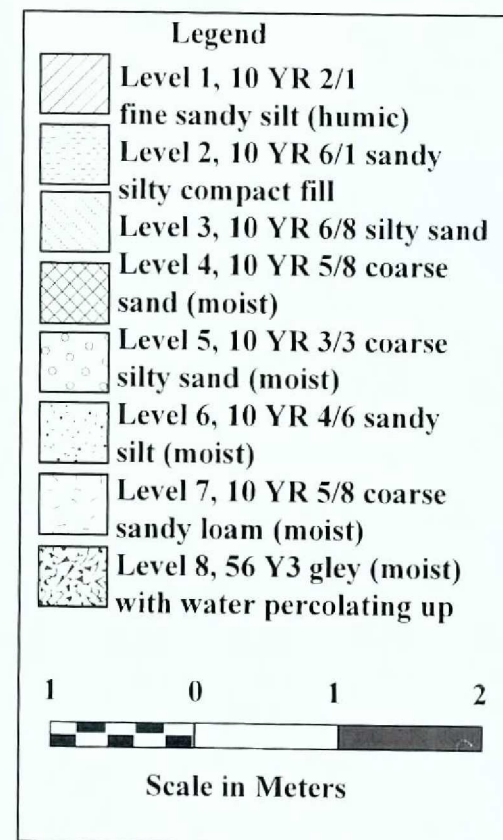

Bronx River Greenway Phase IB
Photograph 13: Photograph and profile of Trench A, west wall



APPENDIX A

RECORD OF EXCAVATED SHOVEL TESTS

BRONX RIVER GREENWAY PHASE IB

ST #	Area	Level	Horizon	Depth cmbs	Soil Color	Soil Description	Cultural Material	Comments/Reason for Termination
8-1	1	1	A/Fill	0-18	10YR4/4	silty sand	NCM	modern trash
8-1	1	2	A2/Fill	18-46	10YR4/6	gravelly sand	glass	
8-1	1	3	C	46-57	10YR5/6	fine sand	NCM	
8-2	1	1	gravel	0-34	10YR4/4	gravel w/ash	NCM	
8-2	1	2	A/Fill	34-72	10YR2/1	gravelly sand	metal, glass, ceramic	
8-2	1	3	C	72-82	10YR5/6	fine sand	NCM	sterile
8-3	1	1	asphalt/ gravel	0-54	10YR2/1	gravel, slag	ceramic, brick	partially removed by backhoe, slag
8-3	1	2	C	54-93	10YR5/6	fine sand	NCM	sterile
8-4	1							too steep to dig
8-5	1	1	gravel/fill	0-47	10YR4/4	gravel w/ash	ceramic, metal	removed by backhoe
8-5	1	2	A/Fill	47-75	10YR2/1	gravelly sand	ceramic, metal	
8-5	1	3	C	75-89	10YR5/6	fine sand	NCM	sterile
8-6	1	1	A/Fill	0-35	10YR4/4	silty sand	NCM	removed by backhoe
8-6	1	2	A2/Fill	35-90	10YR4/6	gravelly sand	plastic, glass, metal, ceramic	brick w/mortar clusters and street cobblestones, obstruction @90cmbs
8-7	1	1	A/Fill	0-24	10YR4/4	silty sand	NCM	modern trash
8-7	1	2	A2/Fill	24-62	10YR4/6	sandy silt	button, glass, ceramic	brick and tile
8-7	1	3	C	62-72	10YR5/6	fine sand	NCM	sterile
8-8	1	1	A/Fill	0-18	10YR4/4	silty sand	glass, metal, ceramic	one bag for both levels
8-8	1	2	A2/Fill	18-59	10YR4/6	gravelly sand	glass, ceramic	
8-8	1	3	C	59-72	10YR5/6	fine sand	NCM	sterile
8-9	1	1	Asphalt/ gravel	0-38	10YR2/1	asphalt and gravel	NCM	removed by backhoe
8-9	1	2	A/Fill	38-62	10YR4/6	gravelly sand	glass, tile	
8-9	1	3	A/Fill	62-75	10YR5/6	fine sand	glass, tile	degrading bedrock
8-10	1	1	A/Fill	0-18	10YR3/2	sandy silty	glass	
8-10	1	2	B	18-32	10YR4/6	gravelly sand	NCM	Concrete Obstruction
8-11	1	1	Fill	0-59	10YR3/2	sandy gravel	metal, glass	Rock Obstruction
8-12	1	1	A	0-31	10YR3/3	silty sand	glass, plastic	Rock Obstruction

ST #	Area	Level	Horizon	Qty	Category	Mat/Color	Item	Portion	Comments
1-1	4	1	A	7	metal	iron	unidentified	fragment	
1-1	4	1	A	1	metal	iron	nail	complete	
1-1	4	1	A	4	glass	colorless	window	fragment	
1-3	4	2	B	1	organic	bone	hoof	complete	
1-3	4	2	B	2	glass	colorless	bottle	fragment	
1-3	4	2	B	1	rubber	black	unidentified	fragment	
1-3	4	2	B	1	metal		electrical	fragment	sparkplugs?
1-4	4	1	A	3	metal	iron	unidentified	fragment	one may be nail
1-4	4	1	A	1	glass	brown	bottle	fragment	
1-5	4	1	A	1	glass	colorless	bottle	fragment	
1-7	4	1	A	4	architectural	clay	brick	fragment	
1-7	4	1	A	1	metal	iron	nail	fragment	
1-7	4	2	B	1	glass	colorless	bottle	fragment	embossed "...F..."
1-7	4	2	B	3	glass	colorless	bottle	fragment	
1-7	4	2	B	1	ceramic	earthenware	vessel	fragment	redware
1-7	4	2	B	1	ceramic	porcelain	tile	fragment	hexagonal floor tile
1-7	4	2	B	3	architectural	clay	brick	fragment	
1-8	4	1	A	1	architectural	clay	brick	fragment	
1-8	4	1	A	1	metal	iron	screw	complete	
1-8	4	1	A	1	glass	green	bottle	fragment	
2-1	3	1	Fill	2	glass	green	bottle	fragment	
2-1	3	1	Fill	1	metal	aluminum	unidentified	fragment	thin sheet
2-1	3	1	Fill	2	organic	shell	clam	fragment	
2-1	3	1	Fill	1	glass	light green tint	window	fragment	
2-1	3	1	Fill	1	metal	aluminum	pop top	complete	
2-2	3	1	Fill1	1	metal	iron	bolt	fragment	
2-2	3	1	Fill1	1	glass	green tint	bottle	fragment	
2-2	3	1	Fill1	4	glass	colorless	bottle	fragment	
2-2	3	1	Fill1	12	glass	light green tint	window	fragment	
2-2	3	1	Fill1	1	ceramic	porcelain	tile	fragment	
2-3	3	1	Fill1	2	glass	light green tint	bottle	fragment	
2-3	3	1	Fill1	4	glass	light green tint	window	fragment	
2-3	3	1	Fill1	2	glass	light green tint	bottle	fragment	melted
2-3	3	1	Fill1	1	metal	iron	screw	fragment	
2-3	3	1	Fill1	1	metal	lead alloy	unidentified	fragment	sheet metal
2-3	3	1	Fill1	1	unknown	stone	unidentified	fragment	
2-3	3	1	Fill1	3	glass	clear	window	fragment	circular, smooth, 1cm thick
2-4	3	1	A	1	plastic	colorless	unidentified	complete	plug or cork?
2-4	3	1	A	1	architectural	earthenware	tile	fragment	
2-4	3	1	A	1	architectural	clay	brick	fragment	
2-5	3	1	Fill1	1	ceramic	porcelain	vessel	fragment	plain rim
2-5	3	1	Fill1	1	metal	iron	cotter pin	fragment	
2-5	3	1	Fill1	3	glass	light green tint	unidentified	fragment	melted
2-5	3	1	Fill1	3	glass	colorless	window	fragment	
2-5	3	1	Fill1	1	plastic	white	unidentified	fragment	
2-5	3	1	Fill1	11	glass	colorless	window	fragment	
2-5	3	1	Fill1	9	glass	light green tint	window	fragment	
2-6	3	1	A	1	architectural	clay	brick	fragment	
2-7	3	1	A	1	glass	colorless	bottle	fragment	base, machine made

APPENDIX B

CATALOG OF
RECOVERED ARTIFACTSBRONX RIVER GREENWAY
PHASE 1B

ST #	Area	Level	Horizon	Qty	Category	Mat/Color	Item	Portion	Comments
2-7	3	1	A	1	plastic	red	unidentified	fragment	possibly part of toy
2-7	3	1	A	1	plastic	blue	unidentified	fragment	thin sheet
2-7	3	1	A	1	plastic	translucent red	unidentified	fragment	textured
2-7	3	1	A	1	glass	colorless	bottle	fragment	
2-7	3	1	A	2	metal	iron	unidentified	fragment	1 piece is circular
2-8	3	2	B	1	glass	brown	bottle	fragment	
2-8	3	2	B	1	lithic	chert	flake	complete	
2-8 W3	3	1	A	1	glass	green	bottle	fragment	
2-8 W3	3	1	A	1	glass	colorless	bottle	fragment	
2-8 W3	3	1	A	1	ceramic	stoneware	tile	fragment	
2-8 W3	3	1	A	2	glass	colorless	mirror	fragment	silvered backing
2-8 W1	3	1	A	1	glass	green	bottle	fragment	
2-8 W1	3	1	A	1	glass	colorless	bottle	fragment	
2-8 W1	3	1	A	1	glass	colorless	window	fragment	
2-8 W1	3	2	B	1	other	coal	anthracite	fragment	
2-8 N3	3	1	A	1	plastic	white	unidentified	fragment	
2-8 N1	3	1	A	1	metal	iron	nail	complete	wire/round
2-8 N1	3	1	A	1	glass	colorless	window	fragment	
2-8 E3	3	1	A	1	glass	colorless	bottle	fragment	
2-8 S3	3	1	A	1	glass	green	bottle	fragment	
2-8 S3	3	1	A	2	glass	clear	bottle	fragment	
2-8 S3	3	1	A	3	architectural	clay	brick	fragment	
2-8 S1	3	1	A	2	glass	brown	bottle	fragment	
2-8 S1	3	1	A	2	glass	colorless	bottle	fragment	
2-9	4	1	A	1	glass	brown	bottle	fragment	
2-9	4	1	A	2	glass	clear	window	fragment	
2-10	4	2	Fill2	1	glass	light green tint	bottle	fragment	
2-10	4	2	Fill2	2	glass	light green tint	window	fragment	
2-11	4	2	Fill2	3	metal	iron	nail	fragment	round
2-13	3	1	A	2	glass	green	bottle	fragment	
2-14	3	1		1	plastic	light blue	unidentified	fragment	
2-14	3	1		1	glass	clear	bottle	fragment	
2-14	3	1		1	glass	light green tint	window	fragment	
2-14	3	1		1	metal	iron	unidentified	fragment	sheet
2-14	3	1		1	organic?	coal	anthracite	fragment	
2-14	3	1		1	plastic	red	cap	complete	small pointed cap
2-14	3	2		1	metal	iron	unidentified	fragment	
4-2	2	1	Fill	1	metal	tin	can	fragment	base or top
4-3	3	1	A1/Fill	1	metal	iron	wire	fragment	partial coil
4-3	3	1	A1/Fill	1	glass	colorless	bottle	fragment	
4-3	3	1	A1/Fill	1	glass	green	bottle	fragment	
4-6	6	1	A	1	glass	light green tint	bottle	fragment	
4-6	6	1	A	2	organic	shell	clam	fragment	
4-7	7	1	A/Fill	1	ceramic	earthenware	unidentified	fragment	possibly crock lid?
4-11A	11A	1	A	1	plastic	white	unidentified	fragment	flat with hole
4-11A	11A	1	A	1	metal	iron	hook	complete	large hook
4-11A	11A	1	A	5	architectural	earthenware	tile	fragment	
4-11A	11A	1	A	8	glass	brown	bottle	fragment	one piece with ACL printing "EE..."

ST #	Area	Level	Horizon	Qty	Category	Mat/Color	Item	Portion	Comments
4-11A	11A	1	A	2	glass	green	bottle	fragment	
4-11A	11A	1	A	25	glass	colorless	bottle	fragment	
4-11A	11A	1	A	2	glass	colorless	bottle	fragment	base, machine made, embossed "B (in circle)/8 78/2"
4-11B	11B	1	A	2	architectural	earthenware	tile	fragment	
4-11B	11B	1	A	1	glass	brown	bottle	fragment	
4-11B	11B	1	A	1	glass	colorless	bottle	fragment	
5-1	2	2	B	1	glass	green	bottle	fragment	
5-1	2	2	B	2	plastic	colorless	vessel	fragment	rim
5-1	2	2	B	1	glass	brown	bottle	fragment	
5-1	2	2	B	1	ceramic	earthenware	vessel	fragment	whiteware, small blue flowers with green leaves transferware
5-1	2	2	B	1	plastic	brown	unidentified	fragment	possibly Bakelite, semicircular
5-1	2	2	B	1	metal	iron	unidentified	fragment	strip of sheet metal, 1x2cm
5-1	2	2	B	14	glass	light green tint	window	fragment	
5-1	2	2	B	8	glass	light green tint	bottle	fragment	
5-1	2	2	B	7	glass	colorless	window	fragment	
5-1	2	2	B	1	glass	colorless	vessel	fragment	pressed glass, flower pattern
5-1	2	2	B	13	glass	colorless	bottle	fragment	
5-1	2	2	B	1	glass	colorless	bottle	fragment	applied lip
5-2	2	1	A/Fill	1	organic	clam	shell	fragment	
5-2	2	1	A/Fill	1	architectural	clay	brick	fragment	
5-2	2	1	A/Fill	4	glass	light green tint	window	fragment	
5-2	2	1	A/Fill	2	ceramic	earthenware	vessel	fragment	buff body, hand painted blue on white decoration
5-2	2	1	A/Fill	2	ceramic	earthenware	vessel	fragment	whiteware
5-2	2	1	A/Fill	2	glass	colorless	vessel	fragment	scalloped edge, pressed glass
5-2	2	1	A/Fill	5	glass	colorless	bottle	fragment	lip and base, embossed "2" on base
5-2	2	1	A/Fill	1	glass	colorless	bottle	fragment	
5-2	2	1	A/Fill	1	glass	light green tint	bottle	fragment	melted
5-3	2	1	A/Fill	1	metal	iron	unidentified	fragment	lump
5-3	2	1	A/Fill	2	glass	colorless	bottle	fragment	
5-3	2	1	A/Fill	3	glass	light green tint	window	fragment	
5-3	2	1	A/Fill	1	glass	colorless	bottle	fragment	lip and neck, early m-m screw top
5-3	2	1	A/Fill	1	ceramic	earthenware	vessel	fragment	redware,
5-4	2	1	A/Fill	1	architectural	clay	brick	fragment	
5-4	2	1	A/Fill	1	glass	light green tint	window	fragment	

ST #	Area	Level	Horizon	Qty	Category	Mat/Color	Item	Portion	Comments
5-8	2	2	B	2	metal	steel alloy	spoon	complete	
5-8	2	2	B	1	glass	light green tint	window	fragment	
5-8	2	2	B	1	glass	light green tint	bottle	fragment	
5-12	2	1	A/Fill	1	glass	brown	bottle	fragment	
5-12	2	1	A/Fill	1	glass	colorless	bottle	fragment	
5-13	2	1	A	2	glass	colorless	bottle	fragment	
5-15	2	1	Fill	1	glass	colorless	bottle	fragment	
5-21	2	1	Fill	1	ceramic	porcelain	unidentified	fragment	embossed "21...", possibly electrical insulator
5-21	2	1	Fill	2	architectural	clay	brick	fragment	
5-21	2	1	Fill	2	glass	colorless	bottle	fragment	
5-22	2	1	Fill	1	other	Styrofoam	unidentified	fragment	
5-27	2	1	A/Fill	1	ceramic	earthenware	vessel	fragment	whiteware
5-27	2	1	A/Fill	1	personal	metal	dog tag	complete	stamped "ASPCA/EXP. SEP 30 1975"
5-27	2	1	A/Fill	1	architectural	clay	brick	fragment	
5-27	2	1	A/Fill	1	organic	shell	clam	fragment	
5-27	2	1	A/Fill	6	glass	light green tint	window	fragment	
5-27	2	1	A/Fill	2	glass	colorless	bottle	fragment	
5-31	2	1	A	1	ceramic	earthenware	sewer pipe	fragment	
5-31	2	2	A/B	4	unknown	burnt	unidentified	fragment	burnt material
5-32	2	1	A1/Fill	1	ceramic	earthenware	plate	fragment	whiteware
5-33	2	1	A/Fill	3	glass	colorless	bottle	fragment	
5-33	2	1	A/Fill	13	glass	light green tint	window	fragment	
5-33	2	1	A/Fill	1	glass	green	bottle	fragment	
5-33	2	1	A/Fill	1	metal	iron	unidentified	fragment	
5-33	2	1	A/Fill	2	glass	brown	bottle	fragment	
5-33	2	1	A/Fill	1	metal	iron	screw	complete	
5-34	2	1	A1/Fill	1	metal	iron	nail	fragment	
5-34	2	1	A1/Fill	1	glass	white	unidentified	fragment	flat
5-37	2	1	A1/Fill	1	glass	colorless	bottle	fragment	
5-37	2	1	A1/Fill	1	glass	green	bottle	fragment	
5-37	2	1	A1/Fill	1	ceramic	earthenware	vessel	fragment	whiteware
5-37	2	1	A1/Fill	1	glass	green	bottle	fragment	
5-37	2	1	A1/Fill	2	glass	light green tint	bottle	fragment	
5-37	2	1	A1/Fill	1	organic	shell	clam	fragment	
5-37	2	1	A1/Fill	1	ceramic	earthenware	pipe	fragment	sewer pipe
5-41	2	1	A/Fill	1	metal	iron	ring	complete	flat ring
5-41	2	1	A/Fill	3	glass	colorless	bottle	fragment	
5-41	2	1	A/Fill	3	glass	green	bottle	fragment	machine made
5-41	2	1	A/Fill	1	plastic	colorless	unidentified	fragment	flat sheet
5-41	2	1	A/Fill	1	ceramic	earthenware	unidentified	fragment	pipe or crock?
5-41	2	1	A/Fill	1	glass	brown	bottle	fragment	
5-42	2	1	A1/Fill	1	metal	iron	nail	complete	wire
5-42	2	1	A1/Fill	4	glass	brown	bottle	fragment	screw top lip
5-42	2	1	A1/Fill	2	glass	light green tint	window	fragment	
5-42	2	1	A1/Fill	2	glass	colorless	bottle	fragment	
5-42	2	1	A1/Fill	2	metal	lead	unidentified	fragment	thin strips
5-42	2	1	A1/Fill	1	metal	aluminum	cap	complete	green screw cap
5-42	2	1	A1/Fill	1	architectural	earthenware	tile	fragment	tan glaze

ST #	Area	Level	Horizon	Qty	Category	Mat/Color	Item	Portion	Comments
5-42	2	1	A1/Fill	2	architectural	mortar	unidentified	fragment	smooth on top
5-44	2	1	A1/Fill	1	metal	iron	unidentified	fragment	
5-45	2	1	A1/Fill	1	glass	colorless	bottle	fragment	
5-45	2	1	A1/Fill	1	glass	green	bottle	fragment	
5-45	2	1	A1/Fill	1	glass	brown	bottle	fragment	
5-46	2	1	A/Fill	3	glass	light green tint	bottle	fragment	
5-46	2	1	A/Fill	1	glass	colorless	window	fragment	
5-47	2	1	A	1	ceramic	earthenware	vessel	fragment	
5-47	2	0	A	4	glass	colorless	bottle	fragment	
5-47	2	1	A	5	glass	colorless	window	fragment	
5-47	2	1	A	4	glass	light green tint	window	fragment	
5-48	2	1	A1/Fill	2	glass	colorless	bottle	fragment	
5-48	2	2	A2/Fill	1	ceramic	earthenware	flowerpot	fragment	
5-48	2	2	A2/Fill	1	glass	colorless	bottle	fragment	
5-48	2	3	A3/Fill	3	ceramic	earthenware	flowerpot	fragment	
5-48	2	3	A3/Fill	1	ceramic	earthenware	plate	fragment	whiteware, embossed dot pattern on rim
5-48	2	3	A3/Fill	1	glass	green	bottle	fragment	
5-48	2	3	A3/Fill	1	glass	light green tint	window	fragment	
5-48	2	3	A3/Fill	1	plastic	red	unidentified	fragment	
5-50	2	1	Fill	1	ceramic	earthenware	sewer pipe	fragment	
5-51	2	1	Fill	6	glass	light green tint	window	fragment	
5-51	2	1	Fill	3	glass	colorless	bottle	fragment	
5-51	2	1	Fill	2	ceramic	earthenware	tile	fragment	
5-51	2	1	Fill	1	glass	white	bottle	fragment	
5-51	2	1	Fill	1	ceramic	earthenware	unidentified	fragment	screw thread
5-52	2	1	Fill	7	glass	colorless	bottle	fragment	
5-52	2	1	Fill	2	glass	green	bottle	fragment	
5-52	2	1	Fill	2	glass	brown	bottle	fragment	
5-52	2	1	Fill	2	architectural	clay	brick	fragment	
5-54	2	1	Fill	2	glass	colorless	window	fragment	
5-55	2	1	A	4	glass	colorless	bottle	fragment	
5-57	2	1	Fill	4	plastic	white	unidentified	fragment	
5-57	2	1	Fill	2	glass	brown	bottle	fragment	
5-57	2	1	Fill	1	glass	green	bottle	fragment	
5-57	2	1	Fill	8	glass	colorless	bottle	fragment	
5-58	2	1	Fill	2	glass	green tint	bottle	fragment	
5-58	2	1	Fill	1	metal	iron	nail	complete	
5-58	2	1	Fill	5	glass	colorless	bottle	fragment	
5-58	2	1	Fill	1	glass	green	bottle	fragment	
5-58	2	1	Fill	1	ceramic	earthenware	vessel	fragment	whiteware
5-59	2	2	A2/Fill	1	metal	iron	wire	fragment	
5-59	2	2	A2/Fill	1	metal	iron	nail	fragment	round/wire
5-59	2	2	A2/Fill	4	glass	colorless	bottle	fragment	
5-59	2	2	A2/Fill	1	organic	shell	clam	fragment	
5-59	2	2	A2/Fill	2	glass	colorless	window	fragment	
5-59	2	2	A2/Fill	4	glass	light green tint	window	fragment	
5-60	2	1	A/Fill	1	metal	iron	unidentified	fragment	
5-60	2	1	A/Fill	1	glass	white	plate	fragment	painted white
5-60	2	1	A/Fill	1	glass	colorless	window	fragment	
5-60	2	1	A/Fill	1	ceramic	earthenware	tile	fragment	pink
5-61	2	1	A/Fill	1	ceramic	earthenware	tile	fragment	
5-61	2	1	A/Fill	1	personal	plastic	comb	fragment	
5-62	2	1	Fill	1	glass	green	bottle	fragment	

ST #	Area	Level	Horizon	Qty	Category	Mat/Color	Item	Portion	Comments
5-62	2	1	Fill	3	glass	colorless	bottle	fragment	
5-62	2	1	Fill	1	metal	iron	nail	fragment	
5-62	2	1	Fill	1	glass	brown	bottle	fragment	
5-62	2	2	Fill2	2	glass	light green tint	bottle	fragment	
5-62	2	2	Fill2	2	architectural	clay	brick	fragment	
5-67	2	1	Fill	1	glass	green	bottle	fragment	
5-67	2	1	Fill	2	glass	brown	bottle	fragment	
6-1	2	2	B	1	glass	green	bottle	fragment	
6-1	2	2	B	5	glass	colorless	window	fragment	
6-1	2	2	B	1	glass	light green tint	window	fragment	
6-1	2	2	B	2	glass	colorless	bottle	fragment	
7-1	1	1	A/Fill	2	glass	green	bottle	fragment	
7-1	1	1	A/Fill	1	metal	iron	unidentified	fragment	sheet
7-1	1	1	A/Fill	1	ceramic	earthenware	tile	fragment	
7-1	1	1	A/Fill	1	plastic	gray	unidentified	fragment	
7-1	1	1	A/Fill	2	glass	colorless	bottle	fragment	
7-2	1	2	A	1	personal	glass	button	complete	white, 4 hole
7-2	1	2	A	1	metal	aluminum	pop-top	complete	modern
7-2	1	2	A	1	organic	shell	clam	fragment	
7-2	1	2	A	8	glass	colorless	bottle	fragment	
7-2	1	2	A	1	glass	light green tint	bottle	fragment	
7-2	1	2	A	2	glass	green	bottle	fragment	
7-2	1	2	A	1	personal	plastic	bead	complete	
7-2	1	2	A	2	plastic	gray	unidentified	fragment	
7-2	1	2	A	1	glass	brown	bottle	fragment	
7-2	1	2	A	11	glass	light green tint	window	fragment	1 pc is safety glass
7-3	1	2	Fill	3	glass	colorless	bottle	fragment	
7-3	1	2	Fill	1	glass	brown	bottle	fragment	screw top
7-3	1	2	Fill	1	glass	light green tint	window	fragment	
7-3	1	2	Fill	1	metal	alloy	pipe fitting	complete	quarter-flange
7-3	1	2	Fill	1	ceramic	earthenware	plate	fragment	whiteware, rim, pink flower decal
7-3	1	2	Fill	1	glass	green	bottle	fragment	
7-4	1	1	A/Fill	1	glass	colorless	bottle	fragment	
7-4	1	1	A/Fill	1	ceramic	earthenware	tile	fragment	
7-4	1	1	A/Fill	2	architectural	clay	brick	fragment	
7-4	1	1	A/Fill	1	glass	green	bottle	fragment	
7-5	1	1	A/Fill	1	glass	colorless	bottle	fragment	
7-5	1	1	B	1	metal	iron	pipe fitting	complete	
7-7	1	1	A/Fill	1	personal	plastic	token	complete	gold coin token, young Elizabeth II on front, US quarter dollar on back, front embossed "ELIZABETH II DEI GRATIA (sic) REGINA F.D."
7-7	1	1	A/Fill	1	glass	colorless	bottle	fragment	
7-7	1	1	A/Fill	2	ceramic	earthenware	plate	fragment	blue willow pattern
8-1	1	2	fill	2	glass	colorless	bottle	fragment	

ST #	Area	Level	Horizon	Qty	Category	Mat/Color	Item	Portion	Comments
8-1	1	2	fill	1	glass	green	bottle	fragment	
8-2	1	2	fill	2	other	plastic	unidentified	fragment	safety orange color
8-2	1	2	fill	2	glass	green	bottle	fragment	
8-2	1	2	fill	3	glass	clear/mirrored	?	fragment	
8-2	1	2	fill	12	glass	clear	bottle	fragment	
8-2	1	2	fill	1	glass	clear	window	fragment	
8-2	1	2	fill	1	glass	clear	unidentified	fragment	pebbled surface
8-2	1	2	fill	1	ceramic	porcelain	vessel	fragment	white
8-2	1	2	fill	2	ceramic	earthenware	vessel	fragment	rim, 1 fragment hard-fired
8-2	1	2	fill	1	ceramic	earthenware	tile	fragment	bullnose, white glazed with speckles
8-2	1	2	fill	1	ceramic	earthenware	tile	fragment	white glaze
8-2	1	2	fill	1	ceramic	earthenware	tile	fragment	black glaze, buff body, large square tile
8-2	1	2	fill	1	other	unknown	unidentified	fragment	flat composite material, red
8-2	1	2	fill	1	other	rubber	unidentified	fragment	thin sheet
8-2	1	2	fill	2	other	plastic	unidentified	fragment	black, 1 piece embossed "KOREA"
8-2	1	2	fill	1	other	plastic	cap	fragment	white ribbed bottle cap
8-2	1	2	fill	1	personal?	wood/lead	pencil	fragment	wooden pencil, painted green
8-2	1	2	fill	1	other	anthracite	coal	fragment	
8-2	1	2	fill	7	ceramic	earthenware	tile	fragment	red body, matte brown glaze
8-2	1	2	fill	1	other	plastic	tile	fragment	square tile, printed "11-0"
8-2	1	2	fill	4	metal	iron	nail	complete	round/wire
8-2	1	2	fill	3	metal	iron	nail	fragment	square
8-2	1	2	fill	1	metal	alloy	unidentified	complete	flat bent strip with pronged end
8-2	1	2	fill	1	metal	alloy	ring	complete	~15mm diameter
8-2	1	2	fill	1	metal	lead alloy	unidentified	fragment	curved strip
8-2	1	2	fill	3	metal	copper alloy	unidentified	fragment	possibly part of small motor or wheel mechanism
8-3	1	1	fill	1	ceramic	earthenware	unidentified	fragment	terracotta, squared corner
8-3	1	1	fill	1	glass	brown	bottle	fragment	base, machine made, embossed "INC NEW YOR"

ST #	Area	Level	Horizon	Qty	Category	Mat/Color	Item	Portion	Comments
8-3	1	1	fill	1	glass	clear	bottle	fragment	base, embossed "25"
8-3	1	1	fill	1	other	anthracite	coal	fragment	
8-3	1	1	fill	1	organic	oyster	shell	fragment	
8-3	1	1	fill	1	other	slag		fragment	
8-3	1	1	fill	5	ceramic	earthenware	vessel	fragment	whiteware
8-3	1	1	fill	1	ceramic	earthenware	vessel	fragment	whiteware, green leaf decoration
8-3	1	1	fill	1	other	plastic	unidentified	fragment	white, rippled
8-3	1	1	fill	1	glass	white/amber	unidentified	fragment	slightly pearlescent, swirled amber/white
8-3	1	1	fill	3	glass	clear	bottle	fragment	
8-5	1	1	fill	2	metal	iron	nail	complete	square
8-5	1	1	fill	1	metal	iron	unidentified	fragment	metal glob with several nails
8-5	1	1	fill	1	metal	iron	unidentified	fragment	wire
8-5	1	1	fill	9	metal	iron	nail	fragment	round/wire
8-5	1	1	fill	32	metal	iron	nail	complete	round/wire
8-5	1	1	fill	1	metal	iron	unidentified	fragment	
8-5	1	1	fill	1	metal	iron	tubing	fragment	
8-5	1	1	fill	2	glass	brown	bottle	fragment	
8-5	1	1	fill	2	glass	green	bottle	fragment	
8-5	1	1	fill	4	glass	colorless	mirror	fragment	
8-5	1	1	fill	1	plastic	white	unidentified	fragment	
8-5	1	1	fill	2	glass	colorless	window	fragment	
8-5	1	1	fill	8	glass	light green tint	window	fragment	
8-5	1	1	fill	10	glass	colorless	bottle	fragment	1 pc with white paint
8-5	1	1	fill	1	glass	light green tint	bottle	fragment	
8-5	1	1	fill	2	organic	bone	unidentified	fragment	butchered
8-5	1	1	fill	1	plastic	gray	unidentified	fragment	scalloped
8-5	1	1	fill	2	ceramic	porcelain	tile	fragment	small white square
8-5	1	1	fill	1	ceramic	porcelain	tile	complete	small white square
8-5	1	2	fill	9	metal	iron	nail	complete	wire/round
8-5	1	2	fill	1	metal	iron	screw	complete	
8-5	1	2	fill	1	metal	iron	nail	complete	cut/square
8-5	1	2	fill	1	metal	iron	wire	fragment	
8-5	1	2	fill	1	metal	iron	unidentified	fragment	latch or lever
8-5	1	2	fill	2	other	plastic	unidentified	fragment	translucent orange (safety/hazard orange color)
8-5	1	2	fill	3	glass	green	bottle	fragment	
8-5	1	2	fill	1	ceramic	earthenware	vessel	fragment	rim, J304 whiteware with brown and beige annular decoration

ST #	Area	Level	Horizon	Qty	Category	Mat/Color	Item	Portion	Comments
8-5	1	2	fill	1	other	plastic	unidentified	fragment	translucent embossed grid pattern
8-5	1	2	fill	1	glass	brown	unidentified	fragment	melted blob of glass
8-5	1	2	fill	1	glass	clear	vessel	fragment	gilded rayed design painted/printed on
8-5	1	2	fill	2	glass	clear	window	fragment	
8-5	1	2	fill	2	glass	clear	bottle	fragment	machine-made, pebbled surface
8-5	1	2	fill	5	glass	clear	bottle	fragment	
8-5	1	2	fill	1	ceramic	porcelain?	tile	complete	small square white-glazed
8-5	1	2	fill	1	glass	clear	unidentified	fragment	white paint on interior
8-6	1	2	fill	1	personal	shell	button	complete	2 hole
8-6	1	2	fill	5	ceramic	earthenware	vessel	fragment	whiteware
8-6	1	2	fill	4	glass	opaque white	bottle	fragment	2 pieces have brown/white painted decoration
8-6	1	2	fill	6	glass	brown	bottle	fragment	
8-6	1	2	fill	21	glass	colorless	bottle	fragment	
8-6	1	2	fill	5	glass	light green tint	bottle	fragment	
8-6	1	2	fill	5	glass	light green tint	window	fragment	1 pc safety glass
8-6	1	2	fill	2	glass	colorless	window	fragment	pressed flower pattern
8-6	1	2	fill	6	glass	green	bottle	fragment	
8-6	1	2	fill	1	other	coal	anthracite	fragment	
8-6	1	2	fill	5	metal	iron	nail	complete	round/wire
8-6	1	2	fill	4	metal	iron	nail	fragment	round/wire
8-6	1	2	fill	2	metal	iron	screw	complete	
8-6	1	2	fill	1	metal	iron	staple	complete	construction staple
8-6	1	2	fill	1	metal	iron	link	complete	large chain link
8-6	1	2	fill	1	metal	iron	unidentified	fragment	t-shaped
8-6	1	2	fill	1	metal	iron	pin	complete	straight
8-6	1	2	fill	1	metal	iron	unidentified	complete	fastener with plastic around head
8-6	1	2	fill	1	metal	iron	link	complete	small rectangular chain link
8-6	1	2	fill	1	metal	zinc alloy	unidentified	fragment	flat
8-6	1	2	fill	1	metal	iron	unidentified	fragment	hollow tube
8-6	1	2	fill	2	plastic	white	cap	fragment	
8-6	1	2	fill	1	plastic	white	unidentified	fragment	flat
8-6	1	2	fill	1	organic	leather	unidentified	fragment	
8-6	1	2	fill	1	organic	shell	clam	fragment	

ST #	Area	Level	Horizon	Qty	Category	Mat/Color	Item	Portion	Comments
8-6	1	2	fill	1	plastic	red	unidentified	fragment	flat, embossed "GILMARK.../MA DE IN..."
8-6	1	2	fill	1	unaffiliated	slag		fragment	
8-7	1	2	fill	1	glass	light green tint	bottle	fragment	lip and neck, machine made
8-7	1	2	fill	1	architectural	mortar	?	fragment	
8-7	1	2	fill	1	personal	plastic	button	complete	4 hole
8-8	1	1/2	fill	22	glass	clear	bottle	fragment	
8-8	1	1/2	fill	4	glass	clear	bottle	fragment	screw-top lip, machine made
8-8	1	1/2	fill	1	glass	clear	bottle	fragment	base, embossed "36H", machine made
8-8	1	1/2	fill	1	glass	clear	bottle	fragment	base, machine made
8-8	1	1/2	fill	2	glass	clear	window	fragment	wire reinforced, pebbled surface
8-8	1	1/2	fill	7	glass	clear	window	fragment	6 pieces thick, 1 thin
8-8	1	1/2	fill	1	glass	brown	bottle	fragment	
8-8	1	1/2	fill	1	glass	aqua tint	bottle	fragment	
8-8	1	1/2	fill	6	ceramic	earthenware	tile	fragment	white glazed, white body
8-8	1	1/2	fill	4	ceramic	earthenware	vessel	fragment	whiteware, rim and body, stepped ribbing on exterior
8-8	1	1/2	fill	1	metal	iron	pipe	fragment	threaded interior on one end
8-8	1	1/2	fill	1	other	plastic	tubing	fragment	black tubing, ~10mm diameter
8-8	1	1/2	fill	2	metal	iron	nail	complete	round/wire
8-8	1	1/2	fill	3	other	plastic	unidentified	fragment	white
8-8	1	1/2	fill	1	other	plastic	unidentified	fragment	baby blue ribbed flat piece
8-8	1	1/2	fill	1	other	plastic	cap interior	complete	
8-8	1	1/2	fill	1	other	plastic	cap	fragment	black ribbed
8-8	1	1/2	fill	1	ceramic	earthenware	vessel	fragment	redware (terracotta)
8-8	1	1/2	fill	1	organic	oyster	shell	fragment	
8-8	1	1/2	fill	2	glass	green	bottle	fragment	1 with block letters "F" then either F/H/P/R
8-8	1	1/2	fill	2	glass	green	bottle	fragment	machine-made, rim
8-8	1	1/2	fill	6	glass	clear	bottle	fragment	
8-8	1	1/2	fill	1	glass	clear	window	fragment	

ST #	Area	Level	Horizon	Qty	Category	Mat/Color	Item	Portion	Comments
8-8	1	1/2	fill	1	glass	white frosted	bottle	fragment	
8-8	1	1/2	fill	1	other	plastic	unidentified	fragment	gray
8-8	1	1/2	fill	3	ceramic	stoneware	tile	fragment	white glazed, square
8-8	1	1/2	fill	1	metal	aluminum	cap	complete	modern bottle screw cap
8-8	1	1/2	fill	1	ceramic	earthenware	unidentified	fragment	whiteware
8-8	1	1/2	fill	1	glass	aqua tint	bottle	fragment	rim
8-10	1	1	A/Fill	1	glass	colorless	bottle	fragment	
8-10	1	1	A/Fill	1	glass	white	bottle	fragment	
8-11	1	1	Fill	1	glass	olive	bottle	fragment	
8-11	1	1	Fill	1	metal	iron	pipe fitting	complete	T joint
8-12	1	1	A	4	glass	colorless	bottle	fragment	
8-12	1	1	A	2	glass	brown	bottle	fragment	base, machine made
8-12	1	1	A	2	plastic	blue	unidentified	fragment	

APPENDIX B

CATALOG OF RECOVERED ARTIFACTS

BRONX RIVER GREENWAY PHASE 1B

Trenc	Section	Level	Horizon	Area	Qty	Functional Group	Class	Material	Type	Object	Part	Description
A	NE quad	All	fill	4	1	Architectural	Metal	Iron	Hand Forged	Spike	Complete	
A	NE quad	All	fill	4	1	Food Related	Ceramic	Porcelain		Plate	Fragment	Green transfer print
A	NE quad	All	fill	4	1	Food Related	Ceramic	Earthenware	Whiteware	Vessel	Fragment	Gold painted rim around the outside of the vessel
A	NE quad	All	fill	4	1	Food Related	Ceramic	Earthenware	Whiteware	Plate	Fragment	No dec
A	NE quad	All	fill	4	1	Food Related	Ceramic	Earthenware	Whiteware	Vessel	Fragment	Annular dec, blue w/black and white lines
A	NE quad	All	fill	4	1	Food Related	Ceramic	Earthenware	Ironstone	Vessel	Fragment	Red crackled look
A	NE quad	All	fill	4	1	Food Related	Glass	Colorless		Vessel	Fragment	Possibly a drinking glass or serving vessel
A	NE quad	All	fill	4	1	Food Related	Glass	Green	Mold made	Bottle	Fragment	Bottle rim & neck, down-tooled rim
A	NE quad	All	fill	4	1	Unaffiliated	Metal	Iron		Unidentified	Fragment	
A	NW quad	All	fill	4	1	Architectural	Clay			Brick	Fragment	
A	NW quad	All	fill	4	1	Architectural	Concrete				Fragment	
A	NW quad	All	fill	4	1	Food Related	Ceramic	Earthenware	Ironstone	Vessel	Fragment	No dec
A	NW quad	All	fill	4	1	Food Related	Ceramic	Earthenware	Whiteware	Plate	Fragment	No dec
A	NW quad	All	fill	4	1	Food Related	Glass	Colorless		Bottle	Fragment	
A	NW quad	All	fill	4	1	Food Related	Glass	Green	Mold made	Bottle	Fragment	
A	NW quad	All	fill	4	1	Food Related	Glass	Tinted		Bottle	Fragment	
A	NW quad	All	fill	4	2	Food Remains	Organic	Shell		Oyster	Fragment	
A	NW quad	All	fill	4	4	Labor	Clay			Flower Pot	Fragment	
A	NW quad	All	fill	4	1	Lighting	Glass	Colorless		Lantern Cap	Fragment	
A	SE quad	All	fill	4	1	Architectural	Metal	Alloy		Handle	Complete	Possibly from a large door or porch/stoop
A	SE quad	All	fill	4	2	Food Related	Glass	Colorless	Machine made	Bottle	Complete	"854, 3" embossed, similar to vinegar bottle
A	SE quad	All	fill	4	1	Food Related	Glass	Green	Mold made	Bottle	Fragment	embossed base "B, I" possible wine bottle
A	SE quad	All	fill	4	1	Food Related	Glass	Colorless	Machine made	Bottle	Fragment	Screw top
A	SE quad	All	fill	4	1	Lighting	Glass	Striated		Lamp Shade	Fragment	Beige & white, Tiffany style
A	SE quad	All	fill	4	1	Unaffiliated	Organic			Anthracite	Fragment	
A	SE quad	All	fill	4	1	Food Related	Ceramic	Earthenware	Whiteware	Plate	Fragment	No dec
A	SE quad	All	fill	4	1	Food Related	Ceramic	Porcelain		Plate	Fragment	edge, no dec
A	SE quad	All	fill	4	1	Food Related	Ceramic	Stoneware	Buff Body	Vessel	Fragment	White glaze, no dec
A	SE quad	All	fill	4	1	Food Related	Ceramic	Stoneware	Buff Body	Crock	Fragment	Brown glaze on outside, white glaze on inside, base
A	SE quad	All	fill	4	1	Food Related	Glass	Tinted	Blown	Bottle	Fragment	Smooth pontil mark
A	SE quad	All	fill	4	1	Food Related	Glass	Red/Brown		Bottle	Fragment	
A	SW quad	All	fill	4	1	Architectural	Clay	Yellow		Brick	Fragment	"RD" embossed
A	SW quad	All	fill	4	1	Architectural	Metal	Iron		Handle	Complete	3in diameter

APPENDIX B

CATALOG OF RECOVERED ARTIFACTS

BRONX RIVER GREENWAY PHASE 1B

Trenc	Section	Level	Horizon	Area	Qty	Functional Group	Class	Material	Type	Object	Part	Description
A	SW quad	All	fill	4	1	Architectural	Metal	Iron	Machine cut	Nail	Complete	Square
A	SW quad	All	fill	4	3	Architectural	Ceramic	Redware		Piping	Fragment	Sewer pipe
A	SW quad	All	fill	4	1	Architectural	Ceramic	Redware		Piping	Fragment	Sewer pipe, glazed
A	SW quad	All	fill	4	1	Architectural	Clay	Red		Brick	Fragment	
A	SW quad	All	fill	4	2	Unaffiliated	Ceramic	Red		Flower Pot	Fragment	
A	SW quad	All	fill	4	1	Architectural	Glass	Tinted		Window	Fragment	Melted
A	SW quad	All	fill	4	1	Architectural	Glass	Colorless		Window	Fragment	
A	SW quad	All	fill	4	1	Food Related	Glass	Tinted		Bottle	Fragment	
A	SW quad	All	fill	4	1	Food Related	Glass	Colorless		Vessel	Fragment	Ridged design on exterior
A	SW quad	All	fill	4	1	Food Related	Ceramic	Porcelain		Vessel	Fragment	Green leaf & red flower design
A	SW quad	All	fill	4	1	Food Related	Ceramic	Porcelain		Vessel	Fragment	No dec
A	SW quad	All	fill	4	3	Food Related	Ceramic	Earthenware	Whiteware	Plate	Fragment	No dec, base
A	SW quad	All	fill	4	1	Food Remains	Organic	Shell		Oyster	Fragment	
A	SW quad	All	fill	4	1	Food Remains	Organic	Shell		Clam	Fragment	
B	S half	All	fill	2	4	Food Related	Glass	Dark Green		Bottle	Fragment	High pontil, base embossed "HNERS"
B	S half	All	fill	2	1	Food Related	Glass	Dark Brown		Bottle	Fragment	Thick
B	S half	All	fill	2	2	Food Related	Glass	Brown		Bottle	Fragment	Angular, flat-sided, embossed "B, R
B	S half	All	fill	2	5	Food Related	Glass	Brown		Bottle	Fragment	Neck & lip mold blown, base embossed "DIOXOG"
B	S half	All	fill	2	1	Food Related	Glass	Colorless	Machine made	Bottle	Fragment	Milk, ribbing on the outside
B	S half	All	fill	2	1	Food Related	Glass	Colorless		Bottle	Fragment	lip hand applied, flaired
B	S half	All	fill	2	1	Food Related	Glass	Colorless	Mold made	Bottle	Fragment	Hand applied lip, label residue around neck
B	S half	All	fill	2	1	Food Related	Glass	Colorless	Machine made	Bottle	Fragment	lip & neck
B	S half	All	fill	2	1	Food Related	Glass	Colorless	Machine made	Bottle	Fragment	
B	S half	All	fill	2	1	Food Related	Glass	Colorless	Machine made	Bottle	Fragment	Base, embossed "116" in a circle
B	S half	All	fill	2	1	Food Related	Glass	Colorless	Machine made	Bottle	Fragment	Base, "3" in a circle
B	S half	All	fill	2	1	Food Related	Glass	Colorless	Machine made	Bottle	Fragment	Base, "1718" embossed on bottom
B	S half	All	fill	2	1	Food Related	Glass	Colorless	Machine made	Bottle	Fragment	Base, "10" embossed on bottom
B	S half	All	fill	2	1	Pharmaceutical	Glass	Colorless	Mold made	Bottle	Fragment	Square, "356" in a diamond on the bottom, # "9" on the side

APPENDIX B

CATALOG OF RECOVERED ARTIFACTS

BRONX RIVER GREENWAY PHASE 1B

Trenc	Section	Level	Horizon	Area	Qty	Functional Group	Class	Material	Type	Object	Part	Description
B	S half	All	fill	2	1	Food Related	Glass	Colorless		Bottle	Fragment	Simi flat side
B	S half	All	fill	2	1	Food Related	Glass	Colorless		Bottle	Fragment	Facetted sides "BO,F or P"
B	S half	All	fill	2	4	Food Related	Glass	Colorless		Bottle	Fragment	
B	S half	All	fill	2	1	Food Related	Glass	Colorless		Bottle	Fragment	Ribbed design
B	S half	All	fill	2	1	Food Related	Glass	Colorless		Bottle	Fragment	Basket weave design embossed
B	S half	All	fill	2	1	Food Related	Glass	Colorless		Bottle	Fragment	Textured w/white paint design
B	S half	All	fill	2	1	Pharmaceutical	Glass	Cobalt		Bottle	Fragment	Lip
B	S half	All	fill	2	1	Pharmaceutical	Glass	Tinted		Bottle	Fragment	Embossed, "OF Magne..." in a circle
B	S half	All	fill	2	1	Food Related	Glass	Light Green		Bottle	Fragment	"BONN" embossed
B	S half	All	fill	2	1	Food Related	Glass	Light Green		Bottle	Fragment	Base, embossed "1032, C.S & Co. LD"
B	S half	All	fill	2	5	Food Related	Glass	Aqua	Machine made	Bottle	Fragment	Base & neck, bas has "24" embossed, neck appears to have been melted
B	S half	All	fill	2	6	Food Related	Glass	Light Green	Machine made	Bottle	Fragment	Base fragments included
B	S half	All	fill	2	1	Food Related	Glass	Colorless		Bottle	Fragment	Embossed "LASK", brown piece of glass melted on it & another clear piece melted on it
B	S half	All	fill	2	4	Unaffiliated	Glass	Tinted		Unidentified	Fragment	Melted
B	S half	All	fill	2	1	Unaffiliated	Glass	Colorless		Unidentified	Fragment	Melted
B	S half	All	fill	2	1	Unaffiliated	Glass	Blue tint		Unidentified	Fragment	Melted, thick
B	S half	All	fill	2	14	Architectural	Glass	Tinted	Flat	Window	Fragment	
B	S half	All	fill	2	3	Architectural	Glass	Colorless	Flat	Window	Fragment	
B	S half	All	fill	2	1	Architectural	Glass	Colorless	Flat	Window	Fragment	Wire reinforced
B	S half	All	fill	2	1	Architectural	Glass	Colorless	Flat	Window	Fragment	Ribbed design
B	S half	All	fill	2	2	Unaffiliated	Organic			Anthracite	Fragment	
B	S half	All	fill	2	1	Unaffiliated		Blue		Unidentified	Fragment	Composite material
B	S half	All	fill	2	1	Food Related	Glass	Colorless	Machine made	Bottle	Fragment	Milk
B	S half	All	fill	2	1	Food Related	Glass	Colorless	Machine made	Bottle	Fragment	
B	S half	All	fill	2	1	Food Related	Glass	Olive Green		Bottle	Fragment	Base, embossed "AWSON"
B	S half	All	fill	2	1	Food Related	Glass	Dark Green	Mold made	Bottle	Fragment	Lip
B	S half	All	fill	2	1	Food Related	Glass	Red		Bottle	Fragment	
B	S half	All	fill	2	1	Food Related	Glass	Brown	Mold Blown	Bottle	Fragment	Neck & lip, applied lip
B	S half	All	fill	2	1	Food Related	Glass	Colorless	Mold Blown	Bottle	Fragment	Neck & lip, applied lip
B	S half	All	fill	2	1	Food Related	Glass	Colorless		Bottle	Fragment	Screw top
B	S half	All	fill	2	1	Food Related	Glass	Light Green	Mold Blown	Bottle	Fragment	Neck & lip

APPENDIX B

CATALOG OF RECOVERED ARTIFACTS

BRONX RIVER GREENWAY PHASE 1B

Trenc	Section	Level	Horizon	Area	Qty	Functional Group	Class	Material	Type	Object	Part	Description
B	S half	All	fill	2	1	Food Related	Glass	Colorless	Mold Blown	Bottle	Fragment	Lip
B	S half	All	fill	2	2	Food Related	Glass	Colorless	Mold Blown	Bottle	Fragment	
B	S half	All	fill	2	1	Food Related	Glass	Colorless		Bottle	Fragment	Embossed with "...T"
B	S half	All	fill	2	1	Food Related	Glass	Light Green		Bottle	Fragment	Embossed "STILLE"
B	S half	All	fill	2	1	Food Related	Glass	Colorless		Bottle	Fragment	Embossed "...ARM, ...TSUP"
B	S half	All	fill	2	1	Food Related	Glass	Colorless		Bottle	Fragment	Embossed "RADE, PER"
B	S half	All	fill	2	1	Food Related	Glass	Colorless		Bottle	Fragment	Embossed "&AH14 6" on base
B	S half	All	fill	2	1	Food Related	Glass	Light Green	Mold Blown	Bottle	Fragment	Neck
B	S half	All	fill	2	2	Food Related	Glass	Dark Green		Bottle	Fragment	
B	S half	All	fill	2	1	Food Related	Glass	Colorless		Bottle	Fragment	Base w/ embossed ribbed pattern
B	S half	All	fill	2	3	Food Related	Glass	Colorless		Bottle	Fragment	
B	S half	All	fill	2	1	Food Related	Glass	Colorless		Bottle	Fragment	Flat sided
B	S half	All	fill	2	1	Food Related	Glass	Light Green		Bottle	Fragment	Flat sided, unreadable embossed letter
B	S half	All	fill	2	1	Food Related	Glass	Aqua		Bottle	Fragment	Base
B	S half	All	fill	2	1	Food Related	Glass	Light Green		Bottle	Fragment	
B	S half	All	fill	2	1	Food Related	Glass	Colorless		Vessel	Fragment	Pressed, squared
B	S half	All	fill	2	1	Architectural	Glass	Light Green		Window	Fragment	Fine ribbing on one side & large ribbing on the other
B	S half	All	fill	2	1	Architectural	Glass	Light Green		Window	Fragment	Reinforced
B	S half	All	fill	2	8	Architectural	Glass	Light Green		Window	Fragment	
B	S half	All	fill	2	6	Unaffiliated	Glass	Colorless		Unidentified	Fragment	Melted
B	S half	All	fill	2	3	Unaffiliated	Glass	Light Green		Unidentified	Fragment	Melted
B	S half	All	fill	2	3	Food Remains	Organic	Shell		Oyster	Fragment	
B	S half	All	fill	2	2	Architectural	Ceramic	Forest Green		Door Knob	Fragment	
B	S half	All	fill	2	3	Architectural	Ceramic	White		Door Knob	Fragment	
B	S half	All	fill	2	3	Unaffiliated	Ceramic			Unidentified	Fragment	Screw thread
B	S half	All	fill	2	1	Unaffiliated	Ceramic	Green		Vessel	Fragment	Frog on the front-3 dimensional
B	S half	All	fill	2	2	Unaffiliated	Ceramic	Earthenware	Redware	Flower Pot	Fragment	
B	S half	All	fill	2	2	Food Related	Glass	White		Bottle	Fragment	Milk Glass
B	S half	All	fill	2	1	Food Related	Ceramic	Earthenware	Whiteware	Vessel	Fragment	transferware pattern w/ pink flowers & leaves, gilt along rim
B	S half	All	fill	2	1	Food Related	Ceramic	Earthenware	Whiteware	Vessel	Fragment	Rim, hand applied cobalt on exterior
B	S half	All	fill	2	1	Food Related	Ceramic	Earthenware	Whiteware	Vessel	Fragment	Embossed pattern painted blue

APPENDIX B

CATALOG OF RECOVERED ARTIFACTS

BRONX RIVER GREENWAY PHASE 1B

Trench	Section	Level	Horizon	Area	Qty	Functional Group	Class	Material	Type	Object	Part	Description
B	S half	All	fill	2	2	Food Related	Ceramic	Earthenware	Whiteware	Plate	Fragment	Scalloped rim embossed w/dot & ribbon pattern, and applied gilt dec.
B	S half	All	fill	2	2	Food Related	Ceramic	Earthenware	Whiteware	Plate	Fragment	Rim with embossed dot & diamond pattern, green leaves transferware
B	S half	All	fill	2	1	Food Related	Ceramic	Earthenware	Whiteware	Plate	Fragment	Rim, with scalloped edge & applied silver gilt leaf pattern
B	S half	All	fill	2	1	Food Related	Ceramic	Earthenware	Whiteware	Plate	Fragment	Rim with scalloped edge
B	S half	All	fill	2	1	Food Related	Ceramic	Earthenware	Whiteware	Plate	Fragment	Rim w/ scalloped edge and incised line
B	S half	All	fill	2	1	Food Related	Ceramic	Earthenware	Whiteware	Vessel	Fragment	Blue transferware w/leaf pattern
B	S half	All	fill	2	1	Food Related	Ceramic	Earthenware	Yellowware	Plate	Fragment	Base
B	S half	All	fill	2	17	Food Related	Ceramic	Earthenware	Whiteware	Vessel	Fragment	No dec
B	S half	All	fill	2	1	Unaffiliated	Ceramic	Earthenware			Fragment	Oblong 3cm w/cobalt glaze on end and tile like backing
B	S half	All	fill	2	3	Architectural	Ceramic	Earthenware		Tile	Fragment	White glaze, no dec
B	S half	All	fill	2	1	Food Related	Ceramic	Earthenware		Vessel	Fragment	Gray glaze
B	S half	All	fill	2	1	Food Related	Ceramic	Earthenware		Vessel	Fragment	Brown glaze
B	S half	All	fill	2	1	Food Related	Ceramic	Porcelain		Vessel	Fragment	Unglazed
B	S half	All	fill	2	1	Food Remains	Organic	Shell		Oyster	Fragment	
B	S half	All	fill	2	1	Architectural	Stone	Slate		Paver	Fragment	With bolt sticking out of it
B	S half	All	fill	2	1	Architectural	Ceramic	Earthenware		Tile	Fragment	Black glaze & pierced for mounting
B	S half	All	fill	2	1	Architectural	Ceramic	Earthenware		Piping	Fragment	Sewer pipe
B	S half	All	fill	2	1	Food Remains	Organic	Bone		Unidentified	Fragment	Butchered
B	S half	All	fill	2	5	Architectural	Metal	Iron	Wire	Wire	Complete	
B	S half	All	fill	2	2	Architectural	Metal	Iron	Wire	Nail	Fragment	
B	S half	All	fill	2	1	Architectural	Metal	Iron	Machine cut	Nail	Complete	
B	S half	All	fill	2	1	Architectural	Metal	Iron	Machine cut	Nail	Fragment	
B	S half	All	fill	2	1	Architectural	Metal	Iron		Unidentified	Fragment	Stripe of sheet metal
B	S half	All	fill	2	2	Personal	Organic	Leather		Grommets	Fragment	Possibly from shoes or boots
B	S half	All	fill	2	1	Food Related	Glass	Colorless		Bottle	Fragment	
B	S half	All	fill	2	4	Food Related	Glass	Colorless		Vessel	Fragment	Very thin
B	S half	All	fill	2	2	Architectural	Glass	Tinted	Flat	Window	Fragment	
B	S half	All	fill	2	1	Architectural	Clay			Brick	Fragment	
B	S half	All	fill	2	1	Architectural	Ceramic	Earthenware		Tile	Fragment	Dark brown glaze, irregular
B	N half	All	fill	2	2	Food Related	Glass	Cobalt		Bottle	Fragment	"ULEAN OIL Co, MIRA, NY" embossed

APPENDIX B

CATALOG OF RECOVERED ARTIFACTS

BRONX RIVER GREENWAY PHASE 1B

Trenc	Section	Level	Horizon	Area	Qty	Functional Group	Class	Material	Type	Object	Part	Description
B	N half	All	fill	2	1	Personal	Glass	Colorless		Bottle	Complete	Ink bottle "Waterman's Ink" emboss on the bottom
B	N half	All	fill	2	1	Pharmaceutical	Glass	Colorless		Bottle	Complete	Screw top "trade mark, Vaseline, Chesebrough, NY" on side, "178" on bottom
B	N half	All	fill	2	1	Food Related	Glass	Colorless		Bottle	Fragment	Lip & body embossed "Durkee & Co."
B	N half	All	fill	2	1	Food Related	Glass	Dark Green		Bottle	Fragment	Embossed "4" on bottom, base
B	N half	All	fill	2	1	Food Related	Glass	Tinted		Bottle	Fragment	Embossed "New York" on side, "... & Co., 519"
B	N half	All	fill	2	1	Food Related	Glass	Tinted	Mold Blown	Bottle	Fragment	Screw top
B	N half	All	fill	2	1	Food Related	Glass	Tinted		Bottle	Fragment	Base "40" embossed on the bottom
B	N half	All	fill	2	1	Food Related	Glass	Tinted	Mold Blown	Bottle	Fragment	Base & Body, possible condiment bottle
B	N half	All	fill	2	4	Food Related	Glass	Dark Green		Bottle	Fragment	High pontil, lip & neck
B	N half	All	fill	2	1	Food Related	Glass	Colorless		Bottle	Fragment	Base
B	N half	All	fill	2	1	Food Related	Glass	Colorless		Bottle	Fragment	Embossed "...ATSUP"
B	N half	All	fill	2	1	Food Related	Glass	Colorless		Bottle	Fragment	Flat sided
B	N half	All	fill	2	1	Food Related	Glass	Colorless		Bottle	Fragment	"O" embossed
B	N half	All	fill	2	1	Food Related	Glass	Tinted		Bottle	Fragment	
B	N half	All	fill	2	1	Food Related	Organic			Cork	Fragment	
B	N half	All	fill	2	1	Unaffiliated	Glass	Tinted		Unidentified	Fragment	Melted
B	N half	All	fill	2	3	Food Remains	Organic	Shell		Oyster	Fragment	
B	N half	All	fill	2	1	Unaffiliated	Ceramic			Unidentified	Fragment	Possible electric spool w/ wire wrapped around it
B	N half	All	fill	2	1	Architectural	Ceramic	White		Door Knob	Complete	
B	N half	All	fill	2	2	Food Related	Ceramic	Earthenware	Redware	Vessel	Fragment	Glazed red on the outside, white on the inside
B	N half	All	fill	2	4	Food Related	Ceramic	Earthenware	Whiteware	Vessel	Fragment	No dec
B	N half	All	fill	2	1	Food Related	Ceramic	Earthenware	Whiteware	Vessel	Fragment	Transfer print of pink flowers & green leaves
B	N half	All	fill	2	1	Architectural	Ceramic	Earthenware		Tile	Fragment	White glaze & mortar
B	N half	All	fill	2	1	Unaffiliated	Rubber			Unidentified	Fragment	4 cm wide by 1cm disk w/ metal attached
B	N half	All	fill	2	1	Unaffiliated				Unidentified	Fragment	Possibly Bakelite
B	N half	All	fill	2	1	Unaffiliated	Plastic			Unidentified	Fragment	Translucent gray
B	N half	All	fill	2	1	Architectural	Ceramic	White		Door Knob	Fragment	
B	N half	All	fill	2	2	Food Remains	Organic	Shell		Clam	Fragment	
B	N half	All	fill	2	2	Unaffiliated	Ceramic			Unidentified	Fragment	Screw thread
B	N half	All	fill	2	3	Unaffiliated	Ceramic	Earthenware	Redware	Flower Pot	Fragment	

APPENDIX B

CATALOG OF RECOVERED ARTIFACTS

BRONX RIVER GREENWAY PHASE 1B

Trenc	Section	Level	Horizon	Area	Qty	Functional Group	Class	Material	Type	Object	Part	Description
B	N half	All	fill	2	1	Food Related	Ceramic	Earthenware	Yellowware	Vessel	Fragment	Blue glaze w/ fish & hook symbol embossed
B	N half	All	fill	2	2	Food Related	Ceramic	Porcelain		Vessel	Fragment	One is a rim fragment, no dec
B	N half	All	fill	2	1	Food Related	Ceramic	Earthenware	Redware	Vessel	Fragment	Glazed redware
B	N half	All	fill	2	22	Food Related	Ceramic	Earthenware	Whiteware	Vessel	Fragment	No dec
B	N half	All	fill	2	3	Architectural	Ceramic	Earthenware		Tile	Fragment	One is hexagonal
B	N half	All	fill	2	3	Architectural	Ceramic	Porcelain		Unidentified	Fragment	Possibly bathroom related
B	N half	All	fill	2	1	Architectural	Ceramic	Porcelain		Unidentified	Fragment	"Meteor" embossed
B	N half	All	fill	2	1	Architectural	Metal	Lead		Unidentified	Fragment	Electrical component w/wires
B	N half	All	fill	2	1	Unaffiliated				Unidentified	Fragment	Rubber on the inside and wire
B	N half	All	fill	2	1	Architectural	Ceramic	Earthenware		Unidentified	Fragment	
B	N half	All	fill	2	1	Architectural	Metal	Iron		Wire Mesh	Fragment	
B	N half	All	fill	2	1	Unaffiliated	Metal	Lead		Unidentified	Fragment	Strip
B	N half	All	fill	2	1	Architectural	Metal	Iron		Unidentified	Fragment	Strip of sheet metal
B	N half	All	fill	2	1	Unaffiliated	Metal	Iron		Wire	Fragment	
B	N half	All	fill	2	1	Unaffiliated	Metal	Iron		Unidentified	Fragment	Strip
B	N half	All	fill	2	2	Architectural	Metal	Iron	Wire	Nail	Complete	
B	N half	All	fill	2	1	Architectural	Metal	Iron	Wire	Nail	Fragment	
B	N half	All	fill	2	2	Unaffiliated	Glass	Cobalt		Unidentified	Fragment	
B	N half	All	fill	2	1	Pharmaceutical	Glass	Tinted	Mold Blown	Bottle	Complete	
B	N half	All	fill	2	9	Food Related	Glass	Dark Green	Mold Blown	Bottle	Fragment	Base, pontil, lip, and neck, high pontil
B	N half	All	fill	2	3	Food Related	Glass	Colorless		Bottle	Fragment	Milk, ribbing on the outside, melting on one
B	N half	All	fill	2	1	Food Related	Glass	Colorless	Mold Blown	Bottle	Fragment	Lip & Neck
B	N half	All	fill	2	1	Food Related	Glass	Colorless	Mold Blown	Bottle	Fragment	Screw top
B	N half	All	fill	2	1	Pharmaceutical	Glass	Colorless	Mold Blown	Bottle	Fragment	Lip & neck, applied neck
B	N half	All	fill	2	1	Food Related	Glass	Colorless		Bottle	Fragment	Base
B	N half	All	fill	2	1	Food Related	Glass	Colorless	Machine made	Bottle	Fragment	Base, "1 N" embossed
B	N half	All	fill	2	1	Food Related	Glass	Colorless		Bottle	Fragment	Base, "WT Co." embossed
B	N half	All	fill	2	1	Food Related	Glass	Colorless		Bottle	Fragment	Base
B	N half	All	fill	2	1	Food Related	Glass	Colorless		Bottle	Fragment	Facetted side
B	N half	All	fill	2	1	Food Related	Glass	Colorless		Jar	Fragment	Lip, Screw top
B	N half	All	fill	2	1	Food Related	Glass	Colorless		Bottle	Fragment	Rounded diamond embossed
B	N half	All	fill	2	1	Food Related	Glass	Colorless		Bottle	Fragment	"Trade" w/ embossed design
B	N half	All	fill	2	9	Food Related	Glass	Colorless		Bottle	Fragment	

APPENDIX B

CATALOG OF RECOVERED ARTIFACTS

BRONX RIVER GREENWAY PHASE 1B

Trench	Section	Level	Horizon	Area	Qty	Functional Group	Class	Material	Type	Object	Part	Description
B	N half	All	fill	2	1	Food Related	Glass	Colorless		Bottle	Fragment	Melted, embossing distorted, illegible
B	N half	All	fill	2	1	Food Related	Glass	Tinted		Bottle	Fragment	Lip
B	N half	All	fill	2	1	Food Related	Glass	Tinted	Mold Blown	Bottle	Fragment	Applied lip
B	N half	All	fill	2	1	Food Related	Glass	Tinted		Bottle	Fragment	"...ERED, E.M" embossed
B	N half	All	fill	2	1	Food Related	Glass	Colorless		Bottle	Fragment	Base, pontil mark, oval
B	N half	All	fill	2	10	Food Related	Glass	Tinted		Bottle	Fragment	
B	N half	All	fill	2	1	Food Related	Glass	Brown		Bottle	Fragment	Base, rectangular w/ pontil mark
B	N half	All	fill	2	1	Food Related	Glass	Brown		Bottle	Fragment	Base
B	N half	All	fill	2	1	Food Related	Glass	Brown		Bottle	Fragment	Base "...TIL, ORU, E" embossed, melted
B	N half	All	fill	2	5	Food Related	Glass	Brown		Bottle	Fragment	
B	N half	All	fill	2	1	Food Related	Organic			Cork	Fragment	
B	N half	All	fill	2	6	Architectural	Glass	Tinted	Flat	Window	Fragment	
B	N half	All	fill	2	1	Architectural	Glass	Tinted	Flat	Window	Fragment	Wire reinforced
B	N half	All	fill	2	1	Architectural	Glass	Colorless		Window	Fragment	Pressed floral design
B	N half	All	fill	2	1	Unaffiliated	Ceramic	Porcelain		Unidentified	Fragment	Possible figurine
B	N half	All	fill	2	2	Architectural	Ceramic	Porcelain		Tile	Fragment	
C	S 6 meters		5 ash fill	1	1	Food Related	Glass	Colorless		Bottle	Fragment	ONE PL..., ...ISTE, embossed
C	S 6 meters		5 ash fill	1	1	Food Related	Glass	Colorless		Bottle	Fragment	...E &, embossed
C	S 6 meters		5 ash fill	1	1	Food Related	Glass	Colorless		Bottle	Fragment	Labeled Co.
C	S 6 meters		5 ash fill	1	1	Food Related	Glass	Colorless		Bottle	Fragment	"...ED", embossed
C	S 6 meters		5 ash fill	1	1	Food Related	Glass	Colorless		Bottle	Fragment	"O" in a square
C	S 6 meters		5 ash fill	1	3	Food Related	Glass	Colorless		Bottle	Fragment	Illegible embossing
C	S 6 meters		5 ash fill	1	1	Food Related	Glass	Colorless		Bottle	Fragment	Base, "B" large
C	S 6 meters		5 ash fill	1	1	Food Related	Glass	Colorless		Bottle	Fragment	Base, "B" large, inside the B is the letter E 14/15
C	S 6 meters		5 ash fill	1	2	Food Related	Glass	Colorless		Bottle	Fragment	Base, pontil mark
C	S 6 meters		5 ash fill	1	1	Food Related	Glass	Colorless		Bottle	Fragment	Base, "M", Pontil mark
C	S 6 meters		5 ash fill	1	1	Food Related	Glass	Colorless		Bottle	Fragment	Base, rectangular
C	S 6 meters		5 ash fill	1	13	Food Related	Glass	Colorless		Bottle	Fragment	
C	S 6 meters		5 ash fill	1	1	Food Related	Glass	Colorless	Mold Blown	Bottle	Fragment	Lip & neck, applied lip
C	S 6 meters		5 ash fill	1	1	Food Related	Glass	Colorless		Bottle	Fragment	Lip
C	S 6 meters		5 ash fill	1	1	Food Related	Glass	Colorless		Bottle	Fragment	Shoulder, faceted
C	S 6 meters		5 ash fill	1	1	Food Related	Glass	Colorless		Bottle	Fragment	Lip
C	S 6 meters		5 ash fill	1	2	Food Related	Glass	Green		Bottle	Fragment	Lip
C	S 6 meters		5 ash fill	1	1	Food Related	Glass	Dark Green		Bottle	Fragment	
C	S 6 meters		5 ash fill	1	1	Food Related	Glass	Tinted	Machine made	Bottle	Fragment	Lip

APPENDIX B

CATALOG OF RECOVERED ARTIFACTS

BRONX RIVER GREENWAY PHASE 1B

Trenc	Section	Level	Horizon	Area	Qty	Functional Group	Class	Material	Type	Object	Part	Description
C	S 6 meters	5	ash fill	1	4	Food Related	Glass	Tinted	Machine made	Bottle	Fragment	Lip
C	S 6 meters	5	ash fill	1	1	Food Related	Glass	Brown		Bottle	Fragment	
C	S 6 meters	5	ash fill	1	13	Architectural	Glass	Tinted	Flat	Window	Fragment	
C	S 6 meters	5	ash fill	1	1	Food Related	Glass	Colorless		Vessel	Fragment	Pressed design, scalloped edge
C	S 6 meters	5	ash fill	1	2	Unaffiliated	Glass	Green		Unidentified	Fragment	Striated, possible lamp shade
C	S 6 meters	5	ash fill	1	1	Food Related	Metal	Alloy		Fork	Complete	Handle is wooden
C	S 6 meters	5	ash fill	1	1	Food Remains	Organic	Bone		Mammal	Complete	Tibia, small mammal
C	S 6 meters	5	ash fill	1	1	Food Remains	Organic	Bone		Mammal	Fragment	Rib, butchered
C	S 6 meters	5	ash fill	1	1	Unaffiliated	Organic	coal		anthracite	Fragment	
C	S 6 meters	5	ash fill	1	1	Personal	Glass	White		Button	Complete	4 hole
C	S 6 meters	5	ash fill	1	1	Food Related	Glass	White		Vessel	Fragment	No dec
C	S 6 meters	5	ash fill	1	2	Food Related	Ceramic	Porcelain		Vessel	Fragment	Hand painted flower design on blue background
C	S 6 meters	5	ash fill	1	3	Food Related	Ceramic	Porcelain		Vessel	Fragment	Hand painted blue design w/ gilt decoration
C	S 6 meters	5	ash fill	1	1	Food Related	Ceramic	Porcelain		Vessel	Fragment	Cobalt blue decoration
C	S 6 meters	5	ash fill	1	1	Food Related	Ceramic	Earthenware	Whiteware	Vessel	Fragment	Hand painted blue decoration
C	S 6 meters	5	ash fill	1	1	Food Related	Ceramic	Earthenware	Whiteware	Vessel	Fragment	Gilt transferware design, rim piece
C	S 6 meters	5	ash fill	1	1	Food Related	Ceramic	Porcelain		Plate	Fragment	Base, stamped Silesia- mark used between 1914-1922, , Poland
C	S 6 meters	5	ash fill	1	2	Food Related	Ceramic	Earthenware	Whiteware	Plate	Fragment	Rim w embossed circle & dot decoration
C	S 6 meters	5	ash fill	1	1	Food Related	Ceramic	Earthenware	Whiteware	Plate	Fragment	Base, embossed dot
C	S 6 meters	5	ash fill	1	4	Food Related	Ceramic	Porcelain		Plate	Fragment	Base
C	S 6 meters	5	ash fill	1	6	Food Related	Ceramic	Porcelain		Vessel	Fragment	
C	S 6 meters	5	ash fill	1	6	Food Related	Ceramic	Earthenware	Whiteware	Plate	Fragment	Base
C	S 6 meters	5	ash fill	1	17	Food Related	Ceramic	Earthenware	Whiteware	Vessel	Fragment	
C	S 6 meters	5	ash fill	1	6	Food Related	Ceramic	Earthenware	Whiteware	Vessel	Fragment	Rim pieces
C	S 6 meters	5	ash fill	1	1	Food Related	Ceramic	Porcelain		Plate	Fragment	Scalloped rim edged w green
C	S 6 meters	5	ash fill	1	1	Food Related	Ceramic	Earthenware	Whiteware	Plate	Fragment	Scalloped rim
C	S 6 meters	5	ash fill	1	1	Food Related	Ceramic	Earthenware	Whiteware	Plate	Fragment	Scalloped rim, dot & scroll embossed decoration
C	S 6 meters	5	ash fill	1	1	Food Related	Ceramic	Earthenware	Whiteware	Plate	Fragment	Dot & 3 line embossed decoration
C	S 6 meters	5	ash fill	1	1	Food Related	Ceramic	Earthenware	Whiteware	Plate	Fragment	Scroll decoration
C	S 6 meters	5	ash fill	1	1	Food Related	Ceramic	Earthenware	Whiteware	Vessel	Fragment	Base, blue flowers w green leaves

APPENDIX B

CATALOG OF RECOVERED ARTIFACTS

BRONX RIVER GREENWAY PHASE 1B

Trench	Section	Level	Horizon	Area	Qty	Functional Group	Class	Material	Type	Object	Part	Description
C	S 6 meters	5	ash fill	1	1	Food Related	Ceramic	Earthenware	Whiteware	Plate	Fragment	Base, pink roses transfer print
C	S 6 meters	5	ash fill	1	4	Food Related	Ceramic	Earthenware	Whiteware	Plate	Fragment	Pink flowers & green leaves
C	S 6 meters	5	ash fill	1	1	Food Related	Ceramic	Earthenware	Whiteware	Plate	Fragment	
C	S 6 meters	5	ash fill	1	2	Food Related	Ceramic	Stoneware	Buff Body	Crock	Fragment	Brown glaze on outside, white glaze on inside
C	S 6 meters	5	ash fill	1	8	Food Remains	Organic	Shell		Oyster	Fragment	
C	S 6 meters	5	ash fill	1	1	Food Remains	Organic	Shell		Scallop	Fragment	
C	S 6 meters	5	ash fill	1	4	Food Remains	Organic	Shell		Clam	Fragment	
C	S 6 meters	5	ash fill	1	2	Unaffiliated	Slag			Slag	Fragment	
C	S 6 meters	5	ash fill	1	2	Architectural	Clay			Brick	Fragment	
C	S 6 meters	5	ash fill	1	1	Architectural	Ceramic	Porcelain		Unidentified	Fragment	Possible electrical part
C	S 6 meters	5	ash fill	1	1	Unaffiliated	Ceramic	Earthenware	Redware	Flower Pot	Fragment	
C	S 6 meters	5	ash fill	1	1	Unaffiliated	Metal	Alloy		Unidentified	Fragment	Possible key hole or lingerie hook
C	S 6 meters	5	ash fill	1	2	Food Related	Ceramic	Earthenware	Whiteware	Plate	Complete	small condiment dish, one is incised "INTERNATIONAL CHINA/TRENTON N.J." (pre1936)
C	S 6 meters	5	ash fill	1	9	Personal	Organic	leather		shoe	Fragment	shoe (boot) and heel
C	S 6 meters	5	ash fill	1	1	Architectural	Clay			Brick	Complete	embossed "RICHMOND"
C	S 6 meters	5	ash fill	1	1	Food Related	Ceramic	Earthenware	Whiteware	handle	Fragment	ornate, gilt decoration
C	S 6 meters	5	ash fill	1	1	Food Related	Ceramic	Earthenware	Whiteware	bowl	Fragment	rim, green annular ware with red stenciled design
C	S 6 meters	5	ash fill	1	2	Food Related	Ceramic	Earthenware	Whiteware	crock	Fragment	rim and base, blue striped decoration
C	S 6 meters	5	ash fill	1	1	Food Related	Ceramic	Earthenware	Whiteware	handle	Fragment	plain, mug handle
C	S 6 meters	5	ash fill	1	1	Food Related	Ceramic	Earthenware	porcelain	Vessel	Fragment	base and body, embossed flower with pink and gilt hand painting on outside
C	S 6 meters	5	ash fill	1	1	Personal	Glass	cobalt	Machine made	ink bottle	Complete	"77" in circle on base
C	S 6 meters	5	ash fill	1	1	Personal	Glass	Light green tint	Mold Blown, applied lip	medicine bottle	Complete	Embossed "Chas. H. Fletcher's" in script on one narrow side, "CASTORIA" on the other, "S.35" on bottom
C	S 6 meters	5	ash fill	1	1	Food Related	Glass	Colorless	Machine made	sauce bottle	Complete	illegible embossing on bottom
C	N 4 meters	5	fill	1	1	architectural	ceramic	earthenware		tile	fragment	hexagonal floor tile with mortar

APPENDIX B

CATALOG OF RECOVERED ARTIFACTS

BRONX RIVER GREENWAY PHASE 1B

Trenc	Section	Level	Horizon	Area	Qty	Functional Group	Class	Material	Type	Object	Part	Description
C	N 4 meters	5 fill		1	3	food related	ceramic	earthenware	whiteware	plate	fragment	rim, flow blue with embossed dots along rim, scorch marks
C	N 4 meters	5 fill		1	1	food related	glass	brown		bottle	fragment	base
C	N 4 meters	5 fill		1	1	food related	glass	colorless		vessel	fragment	pressed with hexagons and flowers, possibly decorative
C	N 4 meters	5 fill		1	2	personal	glass	light green tint		medicine bottle	fragment	rectangular, embossed "WT & Co/USA" on base ca.1875-1901 (Whitall Tatum glass co)
C	N 4 meters	5 fill		1	1	architectural	ceramic	earthenware	porcelain	doorknob	fragment	white
C	N 4 meters	5 fill		1	1	architectural	ceramic	earthenware		tile	fragment	brown glaze, possible roofing or gutter tile
C	N 4 meters	5 fill		1	1	architectural	ceramic	earthenware	redware	tile	fragment	coarse
C	N 4 meters	5 fill		1	2	architectural	ceramic	earthenware	porcelain	tile	complete	hexagonal floor tile
C	N 4 meters	5 fill		1	2	architectural	stone	granite		tile	fragment	polished on one side, possibly lintel
C	N 4 meters	5 fill		1	2	architectural	ceramic	earthenware	redware	tile	fragment	
C	N 4 meters	5 fill		1	1	unaffiliated	glass	white		unknown	fragment	flat with ribbing
C	N 4 meters	5 fill		1	1	food related	ceramic	earthenware	whiteware	bowl	fragment	scalloped rim and embossed scroll design
C	N 4 meters	5 fill		1	1	food related	ceramic	earthenware	whiteware	handle	fragment	
C	N 4 meters	5 fill		1	11	food related	ceramic	earthenware	whiteware	plate	fragment	
C	N 4 meters	5 fill		1	2	food related	ceramic	earthenware	porcelain	plate	fragment	
C	N 4 meters	5 fill		1	1	food related	ceramic	earthenware	whiteware	plate	fragment	scalloped rim and embossed link design
C	N 4 meters	5 fill		1	1	food related	ceramic	earthenware	whiteware	plate	fragment	scalloped rim
C	N 4 meters	5 fill		1	1	food related	ceramic	earthenware	whiteware	vessel	fragment	possibly decorative
C	N 4 meters	5 fill		1	1	food related	glass	colorless		bottle	fragment	embossed "...7834"
C	N 4 meters	5 fill		1	7	food related	glass	colorless		bottle	fragment	
C	N 4 meters	5 fill		1	1	food related	glass	colorless		bottle	fragment	embossed "EAGLE" in scroll, and "TR..."
C	N 4 meters	7 fill		1	1	Food Related	Glass	Green	Machine made	soda bottle	Fragment	body and base, ACL label "CANADA DRY", base embossed "C-94/Duraglas/3 (circle/diamond: Owens-Illinois mark) 49/26" (ca.1949)
C	N 4 meters	7 fill		1	1	Food Related	Ceramic	Earthenware	Whiteware	Plate	Fragment	red flower with green leaf decal
C	N 4 meters	7 fill		1	1	Food Related	Ceramic	Stoneware	Buff Body	Vessel	Fragment	brown slip
C	N 4 meters	7 fill		1	1	Food Related	Glass	Brown		Bottle	Fragment	

APPENDIX B

CATALOG OF RECOVERED ARTIFACTS

BRONX RIVER GREENWAY PHASE 1B

Trenc	Section	Level	Horizon	Area	Qty	Functional Group	Class	Material	Type	Object	Part	Description
D	all	all	fill	8	1	architectural	concrete			unidentified	complete	7cm diam disk with raised center portion
D	all	all	fill	8	1	architectural	stone	granite		tile	fragment	polished top
D	all	all	fill	8	8	architectural	ceramic	earthenware		tile	fragment	white glazed
D	all	all	fill	8	1	architectural	ceramic	porcelain		tile	complete	small hexagonal
D	all	all	fill	8	2	architectural	ceramic	earthenware		tile	fragment	light brown, buff body
D	all	all	fill	8	1	architectural	glass	light green tint		tile	complete	square, 1cm thick
D	all	all	fill	8	1	metal	iron	unidentified			fragment	possibly nail
D	all	all	fill	8	1	food related	glass	green		bottle	fragment	
D	all	all	fill	8	1	food related	glass	brown		bottle	fragment	
D	all	all	fill	8	2	food related	glass	clear		bottle	fragment	
D	all	all	fill	8	1	architectural	ceramic	redware		pipng	fragment	sewer pipe
D	all	all	fill	8	1	automobile	?	rubber/wire		electrical wire	fragment	labeled "Motorcraft SIPCON"
D	all	all	fill	8	1	unaffiliated	?	rubber		?	fragment	sheet rubber
D	all	all	fill	8	1	unaffiliated	?	plastic		unidentified	fragment	possible gasket
D	all	all	fill	8	1	architectural	ceramic	earthenware		tile	fragment	buff body
D	all	all	fill	8	1	architectural	clay			brick	complete	embossed "OPBW"
D	all	all	fill	8	1	unknown	ceramic	earthenware	whiteware	unidentified	fragment	large handle or top of bollard? 6cm diam with hole through center
D	all	all	fill	8	1	architectural	ceramic	earthenware		tile	fragment	
D	all	all	fill	8	1	unaffiliated	plastic	black		unidentified	fragment	sheet
D	all	all	fill	8	1	architectural	stone	granite		intel	fragment	white, polished surface
D	all	all	fill	8	1	architectural	stone	marble		intel	fragment	black, polished surface
D	all	all	fill	8	1	architectural	ceramic	earthenware	redware	tile	fragment	with mortar
E	pocket, W	5 fill		1	2	food remains	organic	oyster		shell	complete	
E	pocket, W	5 fill		1	3	food remains	organic	clam		shell	complete	
E	pocket, W	5 fill		1	12	food remains	organic	clam		shell	fragments	
E	pocket, W side near	5 fill		1	4	food remains	organic	mammal		bone	fragments	butchered, long bones, cow/pig
E	pocket, W	5 fill		1	22	food remains	organic	mammal		bone	fragments	
E	pocket, W	5 fill		1	4	food remains	organic	bird		bone	fragments	
E	pocket, W	5 fill		1	8	food remains	organic	mammal		bone	fragments	
E	pocket, W	5 fill		1	2	food remains	organic	mammal		bone	fragments	butchered, rib
E	pocket, W side near	5 fill		1	2	food related	glass	colorless		wine glass	fragment	base, stem and bottom of bowl, blown
E	pocket, W	5 fill		1	1	architectural	glass	colorless		window	fragment	wire reinforced
E	pocket, W	5 fill		1	1	architectural	glass	colorless		window	fragment	pressed patter, swirled stars
E	pocket, W side near	5 fill		1	1	food related	glass	colorless		bottle	fragment	base, smooth pontil mark, "5" embossed

APPENDIX B

CATALOG OF RECOVERED ARTIFACTS

BRONX RIVER GREENWAY PHASE 1B

Trenc	Section	Level	Horizon	Area	Qty	Functional Group	Class	Material	Type	Object	Part	Description
E	pocket, W side near	5 fill		1	1	food related	glass	light green tint		jar	fragment	lip and shoulder, screw top, ground lip
E	pocket, W side near	5 fill		1	1	food related	glass	colorless		bottle	fragment	mold blown, applied lip with sheared top
E	pocket, W	5 fill		1	1	personal	glass	colorless		eyeglass lens	complete	oval
E	pocket, W	5 fill		1	1	food related	ceramic	earthenware		vessel	fragment	whiteware
E	pocket, W	5 fill		1	1	architectural	ceramic	porcelain		tile	complete	small, round
E	pocket, W	5 fill		1	1	food related	glass	white		vessel	fragment	
E	pocket, W side near center	5 fill		1	1	food related	glass	light green tint		bottle	fragment	base, seam mark, embossed "...RK/...TO BE SOLD" around lower side
E	pocket, W side near center	5 fill		1	1	food related	glass	light green tint		bottle	fragment	base, seam mark, embossed "...K CITY REGISTERED LION BRAND" around lower side
E	pocket, W	5 fill		1	1	food related	glass	colorless		bottle	fragment	base, embossed "M"
E	pocket, W side near center	5 fill		1	2	food related	glass	colorless		bottle	complete	embossed "ALBERT KRUMENAKER/REGISTERED/ KA (logo style)/TRADE MARK/512 & ...4 W 168TH ST/NY" in elaborate wheat scroll design
E	pocket, W	5 fill		1	1	food related	glass	green tint		bottle	fragment	lip and neck, applied lip
E	pocket, W side near	5 fill		1	1	food related	glass	dark green		bottle	fragment	base, polished pontil, turn mold
E	pocket, W side near	5 fill		1	1	food related	glass	green		vessel	fragment	wavy rim with pressed scroll and wheat stalk design
E	pocket, W side near center	5 fill		1	1	food related	glass	colorless		bottle	fragment	faceted sides, embossed "BRA..." in scroll, "...DE MARK/...TY"
E	pocket, W	5 fill		1	1	food related	glass	blue (cobalt)		bottle	fragment	
E	pocket, W	5 fill		1	1	food related	glass	colorless		bottle	fragment	embossed "...EG..."
E	pocket, W	5 fill		1	1	food related	glass	colorless		bottle	fragment	embossed "...S" and "...M..."
E	pocket, W	5 fill		1	2	architectural	glass	colorless		window	fragment	
E	pocket, W	5 fill		1	5	architectural	glass	light green tint		window	fragment	
E	pocket, W side near	5 fill		1	8	food related	glass	light green tint		bottle	fragment	includes 1 neck and shoulder piece
E	pocket, W side near	5 fill		1	29	food related	glass	colorless		bottle	fragment	includes 2 base portions, and 1 neck and shoulder
E	pocket, W side near	5 fill		1	1	food related	ceramic	stoneware		crock	fragment	gray body, clear exterior and brown interior glaze
E	pocket, W	5 fill		1	1	food related	glass	bright green		bottle	fragment	

APPENDIX B

CATALOG OF RECOVERED ARTIFACTS

BRONX RIVER GREENWAY PHASE 1B

Trench	Section	Level	Horizon	Area	Qty	Functional Group	Class	Material	Type	Object	Part	Description
E	pocket, W side near	5	fill	1	7	food related	glass	dark green		bottle	fragment	included one base, mold blown
E	pocket, W side near center	5	fill	1	1	food related	glass	red		vessel	fragment	possibly lamp globe, shear lip, red applied inside layer of glass
E	pocket, W side near	5	fill	1	1	food related	glass	colorless		vessel	fragment	faceted sides, one possibly leaded glass?
E	pocket, W	5	fill	1	1	food related	glass	light green tint		bottle	fragment	embossed "LIC..."
E	pocket, W	5	fill	1	1	food related	glass	light green tint		bottle	fragment	flat sided, embossed "200"
E	pocket, W side near center	5	fill	1	1	food related	glass	colorless		bottle	fragment	embossed "...AR.../...SON.../R (or P) CO"
E	pocket, W side near	5	fill	1	1	food related	glass	light green tint		bottle	fragment	embossed "ROAD/...ARMS/...TORE"
E	pocket, W side near	5	fill	1	1	food related	glass	colorless		bottle	fragment	lip and neck, applied lip, long narrow neck
E	pocket, W side near center	5	fill	1	5	food related	glass	brown		bottle	fragment	mendable, includes base and body, embossed "Eli..." in script, "NEW YORK US/REGISTERED"
E	pocket, W side near	5	fill	1	1	food related	glass	brown		bottle	fragment	lip and neck, applied crude lip, mold blown
E	pocket, W	5	fill	1	5	food related	glass	brown		bottle	fragment	
E	pocket, W side near center	5	fill	1	1	food related	glass	brown		bottle	complete	medicine, embossed "A.C.B./CO./8" on base, mold blown
E	pocket, W side near center	5	fill	1	1	food related	glass	colorless		bottle	complete	screw top, machine made, 8-sided, embossed "W.B. DEYO/NEW YORK" on sides
E	pocket, W side near center	5	fill	1	16	food related	ceramic	earthenware	porcelain	vessel	fragment	mendable, cake plate or compote dish (footed), swirl shape on outer portions
E	pocket, W side near	5	fill	1	13	food related	ceramic	earthenware	whiteware	plate	fragment	undecorated
E	pocket, W side near	5	fill	1	1	food related	ceramic	earthenware	whiteware	vessel	fragment	faceted sides
E	pocket, W side near	5	fill	1	2	food related	ceramic	earthenware	ironstone	vessel	fragment	mendable, gilt lettering "...ry/...stmas"
E	pocket, W side near center	5	fill	1	5	food related	ceramic	earthenware	whiteware	plate	fragment	mendable, flow blue scroll and flower decoration with gilt banding on embossed scroll and flower

Trench	Section	Level	Horizon	Area	Qty	Functional Group	Class	Material	Type	Object	Part	Description
E	pocket, W side near center	5	fill	1	4	food related	ceramic	earthenware	whiteware	plate	fragment	mendable, dark blue transferware leaf and bud pattern
E	pocket, W	5	fill	1	4	food related	ceramic	earthenware	graniteware	cup	fragment	mendable, rim, undecorated
E	pocket, W side near	5	fill	1	7	food related	ceramic	earthenware	whiteware	lid	fragment	mendable, possibly tureen lid, blue scroll decoration
E	pocket, W	5	fill	1	2	unaffiliated	ceramic	earthenware	blisque	unidentified	fragment	
E	pocket, W	5	fill	1	5	food related	ceramic	earthenware	whiteware	vessel	fragment	rim, undecorated
E	pocket, W side near center	5	fill	1	3	food related	ceramic	earthenware	whiteware	plate	fragment	mendable, pink flower with green leaves decal and gilt banding
E	pocket, W side near center	5	fill	1	3	food related	ceramic	earthenware	whiteware	plate	fragment	mendable, rim, wide gilt band on scroll and dot embossed edge
E	pocket, W side near center	5	fill	1	2	food related	ceramic	earthenware	whiteware	plate	fragment	mendable, rim, thin gilt banding on single scroll embossing
E	pocket, W	5	fill	1	7	food related	ceramic	earthenware	graniteware	plate	fragment	mendable, undecorated
E	pocket, W	5	fill	1	1	food related	ceramic	stoneware	salt glazed	vessel	fragment	
E	pocket, W	5	fill	1	1	food related	ceramic	earthenware	slipware	vessel	fragment	
E	pocket, W	5	fill	1	1	food related	ceramic	earthenware	buff body	vessel	fragment	
E	pocket, W	5	fill	1	1	food related	ceramic	earthenware	graniteware	vessel	fragment	
E	pocket, W	5	fill	1	8	food related	ceramic	earthenware	whiteware	plate	fragment	undecorated
E	pocket, W side near	5	fill	1	1	personal	ceramic	earthenware	porcelain	plate	fragment	toy china plate, ~4cm diam, undecorated
E	pocket, W side near	5	fill	1	1	food related	ceramic	earthenware	porcelain	plate	fragment	base, stamped "JAPA..." in red
E	pocket, W side near center	5	fill	1	2	food related	ceramic	earthenware	porcelain	vessel	fragment	rim and body, hand painted with red banding, green and brown design on outside
E	pocket, W	5	fill	1	1	food related	ceramic	earthenware	whiteware	plate	fragment	red transferware pattern
E	pocket, W side near center	5	fill	1	1	food related	ceramic	earthenware	whiteware	vessel	fragment	decal of pink flowers with green leaves on outside, embossed dot pattern
E	pocket, W side near	5	fill	1	1	food related	ceramic	earthenware	whiteware	plate	fragment	pink rose decal with gilt banding along rim
E	pocket, W	5	fill	1	1	food related	ceramic	earthenware	whiteware	plate	fragment	gilt banding
E	pocket, W	5	fill	1	1	food related	ceramic	earthenware	porcelain	plate	fragment	brown hen and flower decal
E	pocket, W side near	5	fill	1	1	food related	ceramic	earthenware	porcelain	plate	fragment	rim, purple bud and yellow leaf decal
E	pocket, W	5	fill	1	1	food related	ceramic	earthenware	whiteware	plate	fragment	gilt decoration
E	pocket, W	5	fill	1	1	food related	ceramic	earthenware	whiteware	plate	fragment	light blue flower decal

APPENDIX B

CATALOG OF RECOVERED ARTIFACTS

BRONX RIVER GREENWAY PHASE 1B

Trench	Section	Level	Horizon	Area	Qty	Functional Group	Class	Material	Type	Object	Part	Description
E	pocket, W side near	5	fill	1	1	food related	ceramic	earthenware	whiteware	plate	fragment	lavender garland and blue flower transfer
E	pocket, W	5	fill	1	1	food related	ceramic	earthenware	whiteware	plate	fragment	cobalt decoration
E	S half	2 and 3	fill	1	1	unaffiliated	plastic	red		wrapper	fragment	with UPC code
E	S half	2 and 3	fill	1	1	architectural	metal	iron		wire	fragment	embedded into concrete
E	S half	2 and 3	fill	1	1	architectural	ceramic	stoneware		tile	fragment	
E	S half	2 and 3	fill	1	4	architectural	stone	granite		tile	fragment	
E	S half	2 and 3	fill	1	1	food related	ceramic	stoneware		crook	fragment	salt glazed
E	S half	2 and 3	fill	1	1	architectural	metal	iron		nail	complete	round/wire
E	S half	2 and 3	fill	1	1	unaffiliated	plastic	blue		unidentified	fragment	curved
E	S half	2 and 3	fill	1	2	architectural	glass	light green tint	flat	window	fragment	
E	S half	2 and 3	fill	1	1	food related	glass	colorless		bottle	fragment	
E	S half	2 and 3	fill	1	1	food related	ceramic	earthenware		vessel	fragment	base, possibly decorative (lamp?), porcelain, scalloped edge with embossed gilt dots
E	S half	2 and 3	fill	1	2	food related	ceramic	earthenware	whiteware	vessel	fragment	whiteware
E	S half	2 and 3	fill	1	3	food related	ceramic	porcelain		vessel	fragment	
E	S half	2 and 3	fill	1	1	food related	ceramic	earthenware	whiteware	vessel	fragment	lid, whiteware, scalloped edge with embossed gilt dots