

5370K

AKA 5369

Bergoffen

2004

ARCHAEOLOGICAL ASSESSMENT REPORT - PHASE IA

GREENPOINT-WILLIAMSBURG REZONING

PART III

PLATES - GREENPOINT



DEPT OF CITY PLANNING
 RECEIVED
 2001 MAY 20 AM 8:44
 ENVIRONMENTAL REVIEW DIV.

Lead Agency: New York City Department of City Planning

Prepared by: Celia J. Bergoffen, Ph.D., R.P.A.,
for Philip Habib & Associates

April 2004

RECEIVED
ENVIRONMENTAL REVIEW

MAY 21 2004

LANDMARKS PRESERVATION
COMMISSION

1148

PART III

PLATES - GREENPOINT

LIST OF PLATES

- Pl. 1 1999 U.S.G.S. map showing the project area
- Pls. 2A, 2B, 2C, 2D Greenpoint-Williamsburg Rezoning - Tax maps showing the location of the project area
- Pl. 3 1844-45 U.S.G.S. map Greenpoint and Williamsburg
- Pl. 4 1855 Perris map showing the original shoreline, Greenpoint
- Pl. 5 1855 Perris map showing the original shoreline, Greenpoint and North Williamsburg
- Pl. 6 Views of BLOCK 2472 SITE 1 - lot 410 (above) and SITE 2 - lot 425 (below)
- Pl. 7 Tax map (above) and 2000 Sanborn map (below) of SITE 1 (lot 410) - BLOCK 2472
- Pl. 8 Tax map (above) and 2000 Sanborn map (below) of SITE 2, lot 425 - BLOCK 2472
- Pl. 9 Views of SITE 3 - lot 100, BLOCK 2472 looking southwest (above) and looking northwest (below)
- Pl. 10 Views of SITE 3 BLOCK 2472, lot 32 looking west / southwest (above), and BLOCK 2502 (below)
- Pl. 11 Views of SITE 3 - BLOCK 2510 (above) and BLOCK 2494 (below), from the northeast corner of Dupont and Franklin Streets
- Pl. 12 Views of SITE 3 - BLOCK 2520 lots 57 and 1 looking southwest from West Street (above), lot 1 looking northwest along Huron Street (below)
- Pl. 13 Tax maps showing the location of SITE 3 (lots 100, 32, 3) - BLOCK 2472
- Pl. 14 2000 Sanborn map showing the location of SITE 3 (lot 100) - BLOCK 2472
- Pl. 15 2000 Sanborn map showing the location of SITE 3 (lots 32, 2) - BLOCK 2472

- Pl. 16 Tax maps showing the location of SITE 3 - block 2494 (lot 1) and BLOCK 2502 (lot 1)
- Pl. 17 2000 Sanborn map showing the location of SITE 3 - BLOCK 2494 (lot 1) and BLOCK 2502 (lot 1)
- Pl. 18 Tax map showing the location of SITE 3 - BLOCK 2510 (lot 1) and BLOCK 2520 (lot 57) and SITE 24 - BLOCK 2520 (lot 1)
- Pl. 19 2000 Sanborn map showing the location of SITE 3 - BLOCK 2510 (lot 1) and BLOCK 2520 (lot 57) and SITE 24 - BLOCK 2520 (lot 1)
- Pl. 20 SITE 3 - BLOCK 2502 - 1868 Higginson map (above) BLOCK 2510 - 1868 Higginson map (below) showing the location of the project site
- Pl. 21 SITE 3 - BLOCK 2494 1868 Higginson map showing the location of the project site
- Pl. 22 Views of SITE 4 (above) and SITE 8 (below) - BLOCK 2482
- Pl. 23 Tax map (above) and 2000 Sanborn map (below) showing the location of SITES 4 (lot 1) and 8 (lot 39) BLOCK 2482
- Pl. 24 SITE 4 (lot 1) and SITE 8 (lot 39) - BLOCK 2482, 1868 Higginson map (above), 1898 Hyde map (below), showing the location of the project sites
- Pl. 25 Views of SITE 9 - lots 61, 62 (above) and SITE 10 - lots 11, 12 (below) BLOCK 2483
- Pl. 26 Views of SITE 11 - lot 14 (above) and SITE 12 - lot 20 (below) BLOCK 2483
- Pl. 27 View of SITE 13 - lot 59 (above) and SITE 15 - lot 25 (below) BLOCK 2483
- Pl. 28 Tax map and 2000 Sanborn map of BLOCK 2483 SITES 9 (lots 61, 62), 10 (lots 11, 12), 11 (lot 14) and 13 (lot 59) showing the location of the project sites
- Pl. 29 Tax map and 2000 Sanborn map of SITE 12 (lot 20) and SITE 15 (lot 25) BLOCK 2483
- Pl. 30 SITES 9, 10, 11, 12, 13 AND 15 - BLOCK 2483, 1868 Higginson map (above), 1912 Hyde map (below) showing the location of the project sites
- Pl. 31 View of SITE 20 - BLOCK 2411
- Pl. 32 Tax map and 2000 Sanborn map, SITE 20 (lot 14) - BLOCK 2511 showing the location of the project site

- Pl. 33 SITE 20 - BLOCK 2411, 1868 Higginson map (top), 1898 Hyde map (bottom left) and 1912 Hyde map (bottom right) showing the location of the project site
- Pl. 34 Views of SITE 22 from Green Street looking west (above), and SITE 23 (below) - BLOCK 2512
- Pl. 35 Tax map and 2000 Sanborn map of SITES 22 (lot 60) and 23 (lot 54) - BLOCK 2512 showing the location of the project sites
- Pl. 36 SITES 22 and 23 - BLOCK 2512, 1868 Higginson map (above), 1912 Hyde map (below) showing the location of the project sites
- Pl. 37 Views of SITES 25 (above) and 26 (below) - BLOCK 2521
- Pl. 38 Views of SITE 27 - lot 11, above and SITE 29 - lot 19, below - BLOCK 2521
- Pl. 39 Tax map and 2000 Sanborn map of SITE 25 (lot 1), 26 (lots 5, 6, 7), 27 (lot 11) and 29 (lot 10) - BLOCK 2521, showing the location of the project sites
- Pl. 40 SITES 25, 26, 27, and 29 - BLOCK 2521 1868 Higginson map (above), 1912 Hyde map (below) showing the location of the project sites
- Pl. 41 Views of SITE 30 - BLOCK 2522 (above), SITE 34 - BLOCK 2530 (below) from the corner of Huron and West Streets
- Pl. 42 Tax map and 2000 Sanborn map of SITE 30 (lot 10) - BLOCK 2522 showing the location of the project site
- Pl. 43 SITE 30 - BLOCK 2522, 1898 Hyde map (top), 1912 Hyde map (middle), 1929 Hyde map (bottom) showing the location of the project site
- Pl. 44 Tax map and Sanborn map of SITE 34 (lots 1, 55, 56) - BLOCK 2530 showing the location of the project site
- Pl. 45 SITE 34 - BLOCK 2530, 1868 Higginson map showing the location of the project site
- Pl. 46 Views of SITE 35 (above) and SITE 36 (below) - BLOCK 2531
- Pl. 47 Views of SITE 35 (above) and SITE 39 (below) - BLOCK 2531
- Pl. 48 Tax map and 2000 Sanborn map of SITES 35 (lots 1, 2, 3), 36 (lots 9, 10), 38 (lots 36, 35) and 39 (lot 20) - BLOCK 2531 showing the location of the project sites

- Pl. 49 SITES 35, 36, 38 and 39 - BLOCK 2531, 1868 Higginson map (top), 1912 Hyde map (middle), SITE 35 - 1989 Sanborn map (bottom) showing the location of the project sites
- Pl. 50 View of SITE 40 - BLOCK 2532
- Pl. 51 Tax map and Sanborn map of SITE 40 (lot 1) - BLOCK 2538 showing the location of the project site
- Pl. 52 Views of SITE 41 - BLOCK 2538, looking southwest along India Street (above) and looking south along West Street (below)
- Pl. 53 Tax map and Sanborn map of SITE 41 (lot 1) - BLOCK 2538 showing the location of the project site
- Pl. 54 View of SITE 42 (above) and SITE 43 (below) - BLOCK 2539
- Pl. 55 Tax map and 2000 Sanborn map of SITE 42 (lot 8) and SITE 43 (lot 29) - BLOCK 2539 showing the location of the project sites
- Pl. 56 SITES 42 and 43 - BLOCK 2539, 1868 Higginson map (above), 1912 Hyde map (below) showing the location of the project sites
- Pl. 57 Views of SITE 44 - BLOCK 2543, from the corner of Java and West Streets looking west (above) and looking southwest (below)
- Pl. 58 Tax map and 2000 Sanborn map of SITE 44 (lot 1) - BLOCK 2543 showing the location of the project site
- Pl. 59 View of SITE 46 - BLOCK 2549
- Pl. 60 Tax map and 2000 Sanborn map of SITE 46 (lot 10) - BLOCK 2549 showing the location of the project site
- Pl. 61 SITE 46 - BLOCK 2549, 1868 Higginson map showing the location of the project site
- Pl. 62 View of SITE 62 - BLOCK 2556
- Pl. 63 Tax map and 2000 Sanborn map of SITE 52 (lots 55, 57) - BLOCK 2556 showing the location of the project site
- Pl. 64 SITE 52 - BLOCK 2556, 1868 Higginson map (top left), 1898 Hyde map (top right), 1929 Hyde map (below) showing the location of the project site

- Pl. 65 Views of SITE 56 - BLOCK 2556B, looking south along Greenpoint Avenue (above), looking south along West Street (below)
- Pl. 66 Tax map and 2000 Sanborn map of SITE 56 (lot 1) - BLOCK 2556 showing the location of the project site
- Pl. 67 View of SITE 62 - BLOCK 2570, from Oak and West Streets looking southwest (above), and from the corner of Calyer and West Streets looking northwest (below) showing the location of the project site
- Pl. 68 Tax map and 2000 Sanborn map of SITE 62 (lot 1) - BLOCK 2570 showing the location of the project site
- Pl. 69 SITE 62 - BLOCK 2570, 1868 Higginson map showing the location of the project site
- Pl. 70 View of SITE 63 - BLOCK 2571
- Pl. 71 Tax map and 2000 Sanborn map of SITE 63 (lots 1, 9) - BLOCK 2571 showing the location of the project site
- Pl. 72 SITE 63 - BLOCK 2571, 1868 Higginson map (top left), 19192 Hyde map (top right), 1951 Sanborn map (bottom) showing the location of the project site
- Pl. 73 View of SITES 68 (above) and 211 (below) - BLOCK 2590
- Pl. 74 Tax map and 2000 Sanborn map of SITES 68 (lot 210) and 211 (lot 100)- BLOCK 2590 showing the location of the project site
- Pl. 75 SITES 68 and 211 - BLOCK 2590, 1912 Hyde map showing the location of the project site (above and below)
- Pl. 76 Views of SITE 93 (above) and SITE 103 (below) - BLOCK 2724
- Pl. 77 Tax map and 2000 Sanborn map of SITE 93 (lots 31, 32) - BLOCK 2724 showing the location of the project site
- Pl. 78 SITE 93 (lots 31, 30) - BLOCK 2724, 1868 Higginson map (above), 1912 Hyde map (below) showing the location of the project site
- Pl. 79 Tax map and 2000 Sanborn map of SITE 103 (lot 11) - BLOCK 2292 showing the location of the project site

- Pl. 80 SITE 103 (lot 11) - BLOCK 2292, 1868 Higginson map (top), 1929 Hyde map (bottom) showing the location of the project site
- Pl. 81 View of SITE 106 - BLOCK 2272
- Pl. 82 Tax map and 2000 Sanborn map of SITE 106 (lot 106) - BLOCK 2722 showing the location of the project site
- Pl. 83 Views of SITES 131 (above) and 132 (below) - BLOCK 2731
- Pl. 84 View of SITE 133 - BLOCK 2731
- Pl. 85 Tax map and 2000 Sanborn map of SITE 131 (lot 44), SITE 132 (lots 41, 38), SITE 133 showing the location of the project site (lots 35, 36) - BLOCK 2731
- Pl. 86 SITES 131, 132, and 133 - BLOCK 27231, 1868 Higginson map (above), 1912 Hyde map (below) showing the location of the project sites
- Pl. 87 View of SITE 134 - BLOCK 2732
- Pl. 88 Tax map and 2000 Sanborn map of SITE 134 (lot 33) - BLOCK 2732 showing the location of the project site
- Pl. 89 SITE 134 (lot 33) - BLOCK 2732, 1912 Hyde map (above), 1951 Sanborn map (below) showing the location of the project site
- Pl. 90 View of SITE 137 - BLOCK 2733, from Leonard Street (above), and from Meeker Avenue (below)
- Pl. 91 Tax map and 2000 Sanborn map of SITE 137 (lot 6) - BLOCK 2733 showing the location of the project site
- Pl. 92 SITE 137 - BLOCK 2733, 1868 Higginson map (above), 1912 Hyde map (below) showing the location of the project site
- Pl. 93 Views of SITE 138 (above) and SITE 139 (below) - BLOCK 2734
- Pl. 94 Tax map and 2000 Sanborn map of SITE 138 (lot 3), SITE 139 (lot 13) - BLOCK 2734 showing the location of the project site
- Pl. 95 SITE 138 and 139 - BLOCK 2734, 1898 Hyde map showing the location of the project sites

- Pl. 96 View of SITE 141 - BLOCK 2304
- Pl. 97 Tax map and 2000 Sanborn map of SITE 141 (lots 36, 37) - BLOCK 2304 showing the location of the project site
- Pl. 98 Views of SITES 144 (above) and 145 (below) - BLOCK 2305
- Pl. 99 Tax map and 2000 Sanborn map of SITE 144 (lots 15, 16, 17) and SITE 145 (lot 18) - BLOCK 2305 showing the location of the project site
- Pl. 100 SITES 144 and 145 - BLOCK 2305, 1868 Higginson map (top), 1898 Hyde map (middle), 1912 Hyde map (bottom), 1929 Hyde map (right) showing the location of the project sites
- Pl. 101 Views of SITE 149 (above) and 152 (below) - BLOCK 2307
- Pl. 102 Tax map and 2000 Sanborn map of SITE 149 (lot 31) and SITE 152 (lot 25) - BLOCK 2307 showing the location of the project sites
- Pl. 103 SITES 149 and 152 - BLOCK 2307, 1868 Higginson map (top) 1898 Hyde map (middle), 1912 Hyde map (bottom) showing the location of the project sites
- Pl. 104 Views of SITE 159 - BLOCK 2738 (above), and SITE 162 - BLOCK 2310 (below)
- Pl. 105 Tax map and 2000 Sanborn map of SITE 159 (lot 24) - BLOCK 2738 showing the location of the project site
- Pl. 106 SITE 159 - BLOCK 2738, 1868 Higginson map (above), 1898 Hyde map (below) showing the location of the project site
- Pl. 107 Tax map and 2000 Sanborn map of SITE 162 (lots 9, 10, 11) - BLOCK 2310 showing the location of the project site
- Pl. 108 SITE 162 - BLOCK 2310, 1868 Higginson map showing the location of the project site
- Pl. 109 Views of SITES 166 (above) and 169 (below) - BLOCK 2313
- Pl. 110 Tax map and 2000 Sanborn map of SITE 166 (lot 22) and SITE 169 (lot 28) - BLOCK 2313 showing the location of the project sites
- Pl. 111 SITES 166 and 169 - BLOCK 2313, 1868 Higginson map (above), 1912 Hyde map (below) showing the location of the project sites

- Pl. 112 View of SITE 174 - BLOCK 2741
- Pl. 113 SITES 176 - BLOCK 2741, view from Skillman Street (above) and view from Meeker Avenue (below)
- Pl. 114 Tax map and 2000 Sanborn map of SITE 174 (lot 8) and SITE 176 (lot 13) - BLOCK 2741 showing the location of the project sites
- Pl. 115 SITES 174 and 176 - BLOCK 2741, 1868 Higginson map (above), 1912 Hyde map (below) showing the location of the project sites
- Pl. 116 Views of SITES 183 and 184 - BLOCK 2741, view from Skillman Street (above) and view from Meeker Avenue (below)
- Pl. 117 Tax map and 2000 Sanborn map of SITE 183 (lots 41, 40) and SITE 184 (lot 39) - BLOCK 2746 showing the location of the project sites
- Pl. 118 SITES 183 and 184 - BLOCK 2746 1868 Higginson map (above), 1912 Hyde map (below), 1929 Hyde map (bottom right) showing the location of the project sites
- Pl. 119 View of SITES 185 (above) and 186 (below) - BLOCK 2317
- Pl. 120 Views of SITE 187 - BLOCK 2317 (above), and SITE 192 - BLOCK 2321 (below)
- Pl. 121 Tax map and 2000 Sanborn map of SITE 185 (lots 5, 6, 7, 8), SITE 186 (lots 12, 13) and SITE 187 (lots 16, 17) - BLOCK 2317, showing the location of the project sites
- Pl. 122 SITES 185, 186 and 187 - BLOCK 2317, 1868 Higginson map (above) and 1951 Sanborn map (below) showing the location of the project sites
- Pl. 123 Tax map and 2000 Sanborn map of SITE 192 (lot 13) - BLOCK 2321 showing the location of the project site
- Pl. 124 SITE 192 - BLOCK 2321, 1912 Hyde map showing the location of the project site
- Pl. 125 View of SITE 198 - BLOCK 2323
- Pl. 126 Tax map and 2000 Sanborn map of SITE 198 - BLOCK 2323 showing the location of the project site
- Pl. 127 SITE 198 - BLOCK 2323, 1929 Sanborn map showing the location of the project site

1999 U.S.G.S. map showing the project area



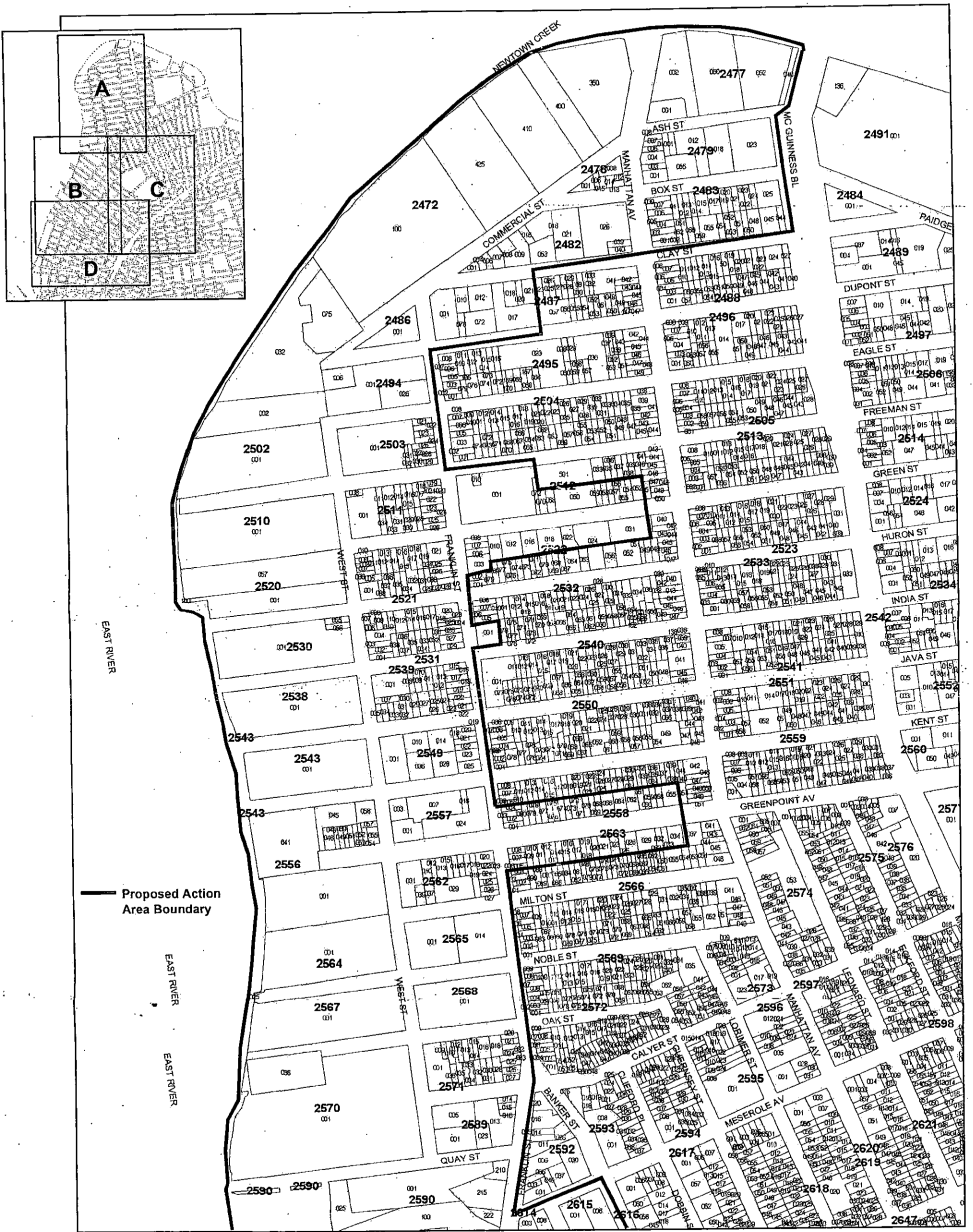

Greenpoint-Williamsburg Rezoning

Tax map showing the location of the project area

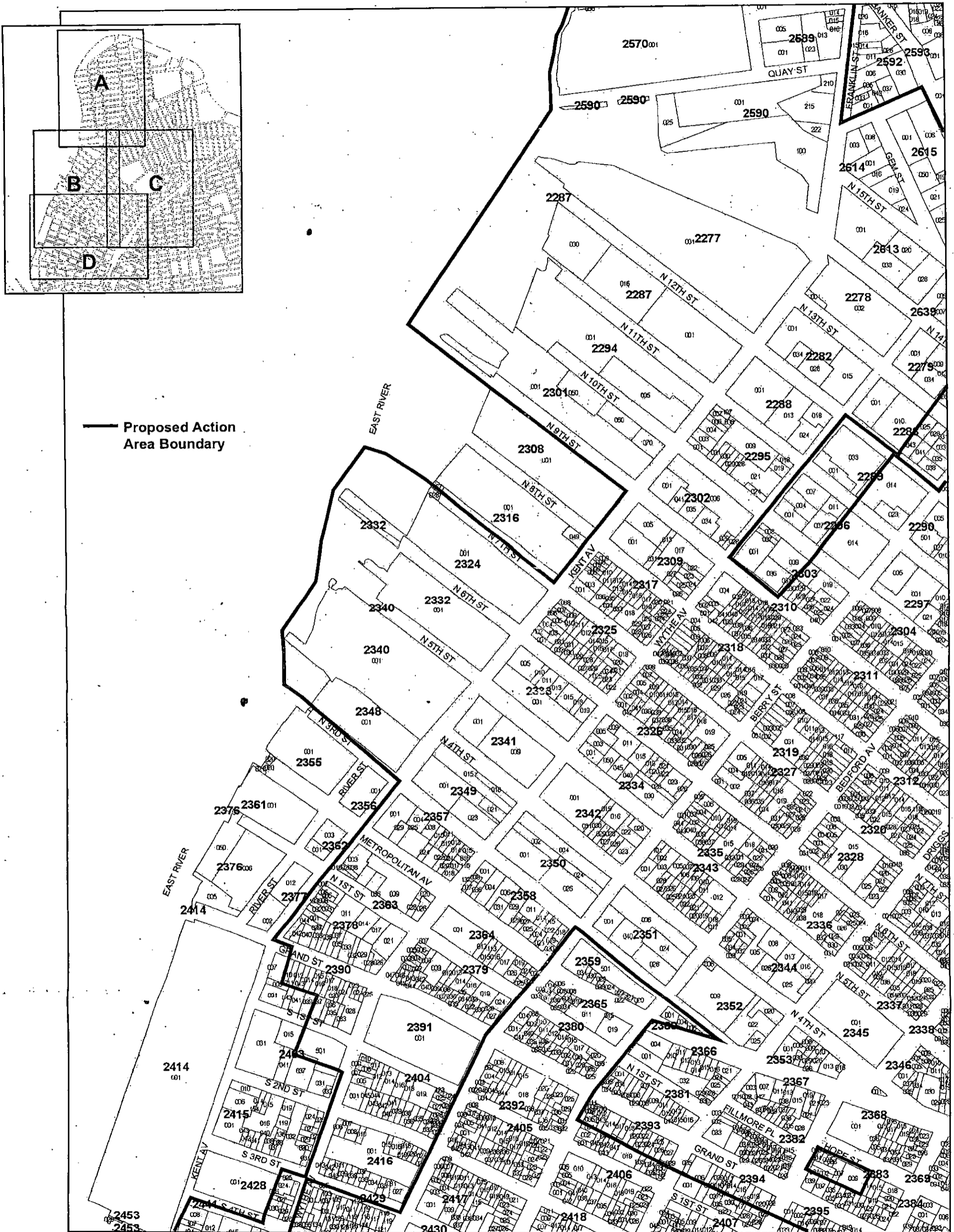

Greenpoint-Williamsburg Rezoning

Tax map showing the location of the project area

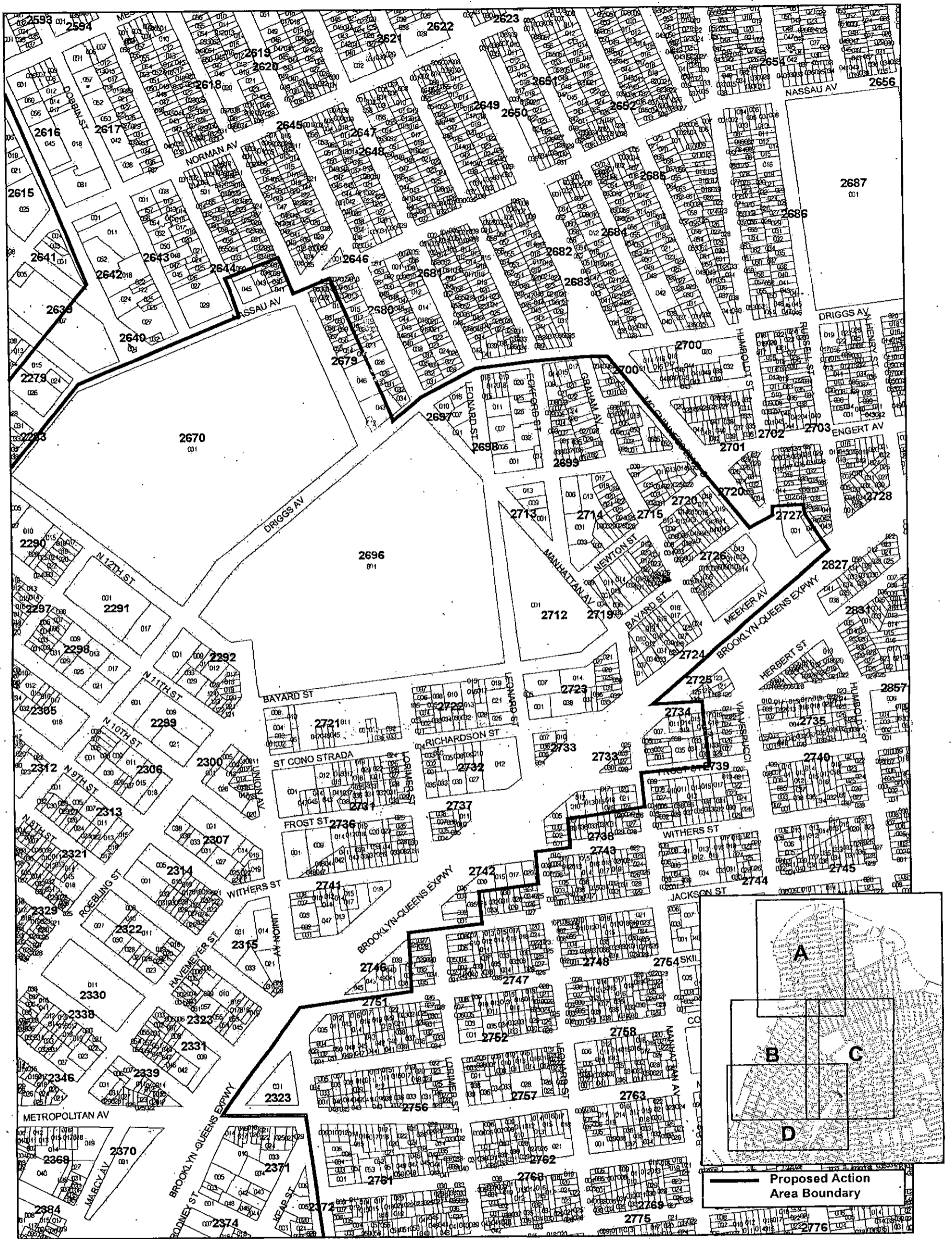

Greenpoint-Williamsburg Rezoning

Tax map showing the location of the project area

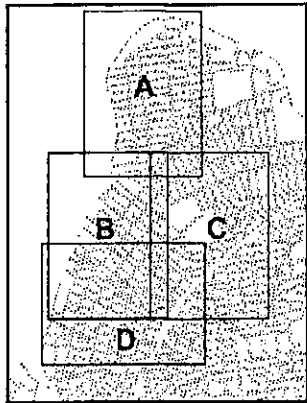

Proposed Action Area Boundary

1844-45 U.S.G.S. map
Greenpoint and Williamsburg

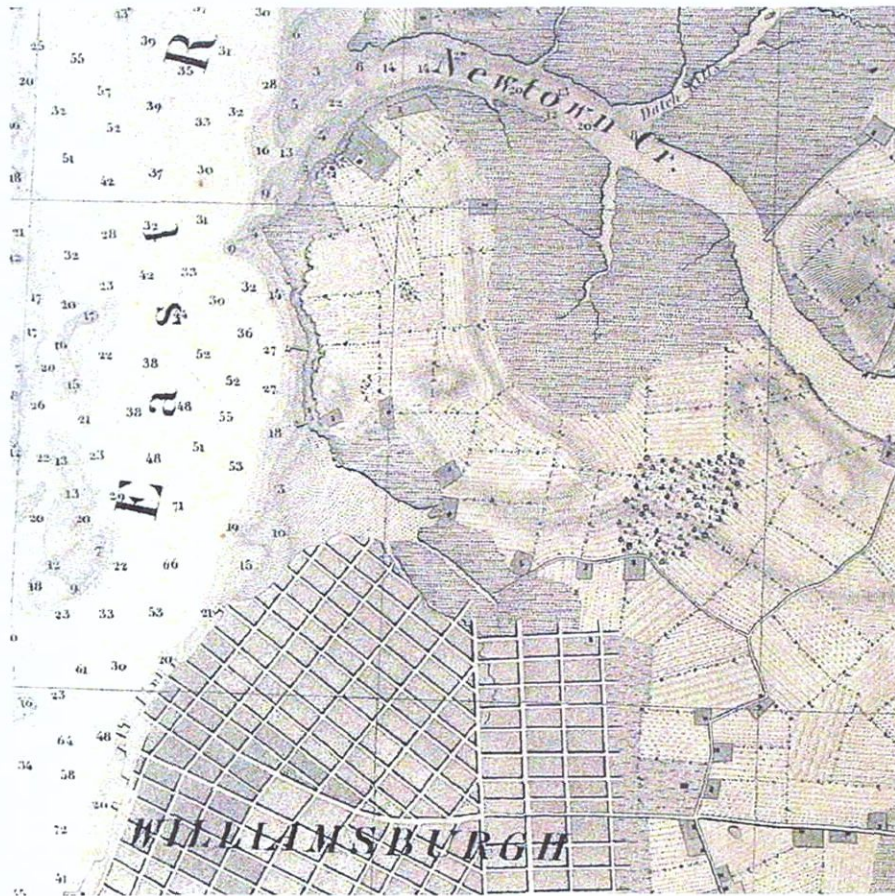

1855 Perris map showing the original shoreline, Greenpoint



1855 Perris map showing the original shoreline, Greenpoint and North Williamsburg



BLOCK 2472

SITE 1 - lot 410 (above) and SITE 2 - lot 425 (below)



SITE 1 (lot 410) - BLOCK 2472

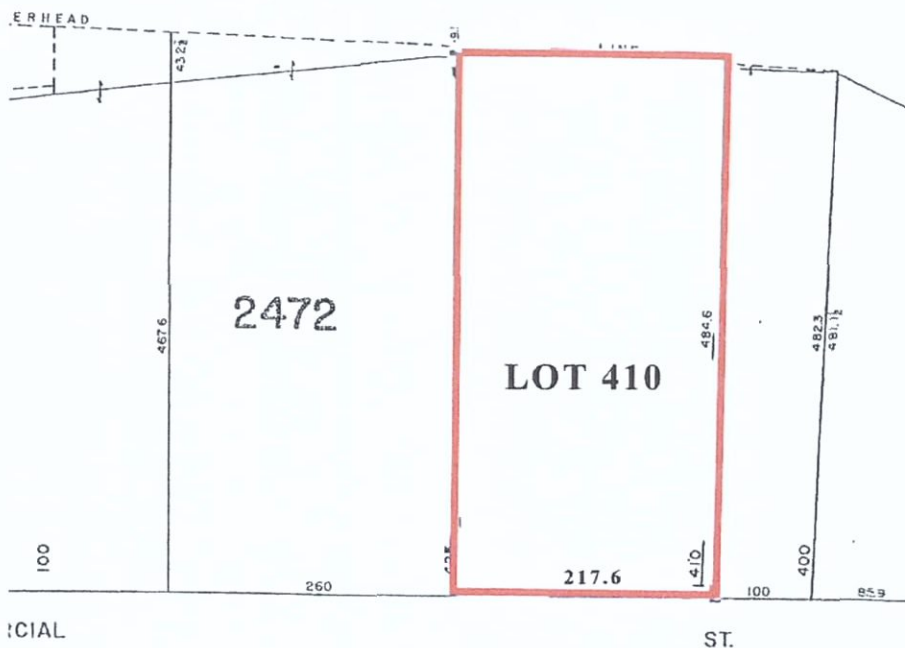

ICIAL

ST.

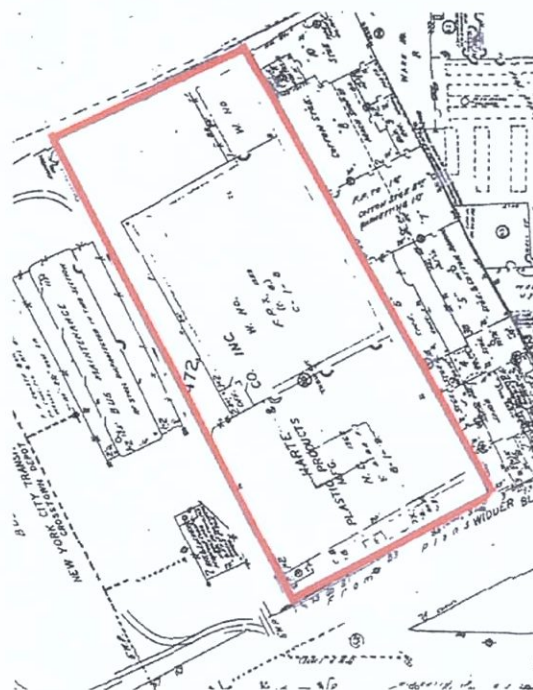

SITE 2, lot 425 - BLOCK 2472

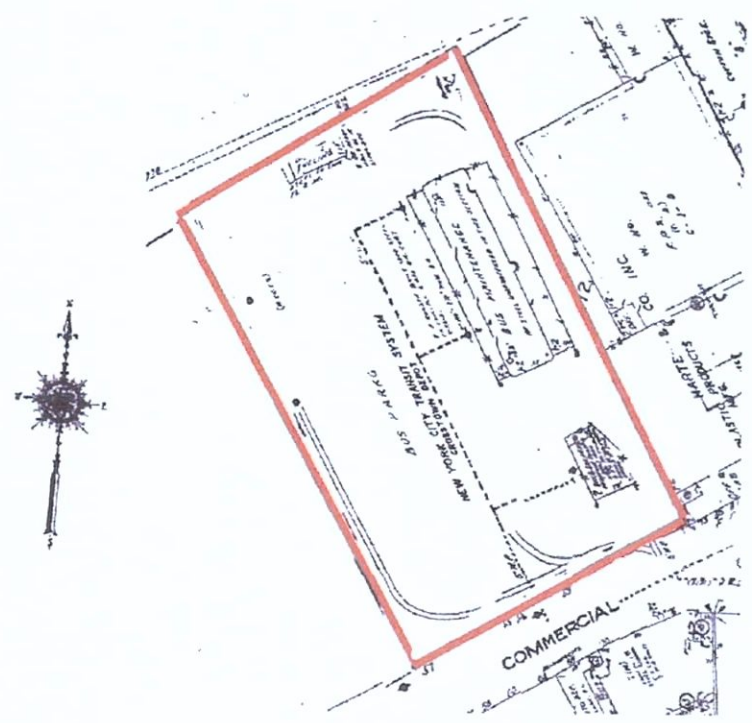
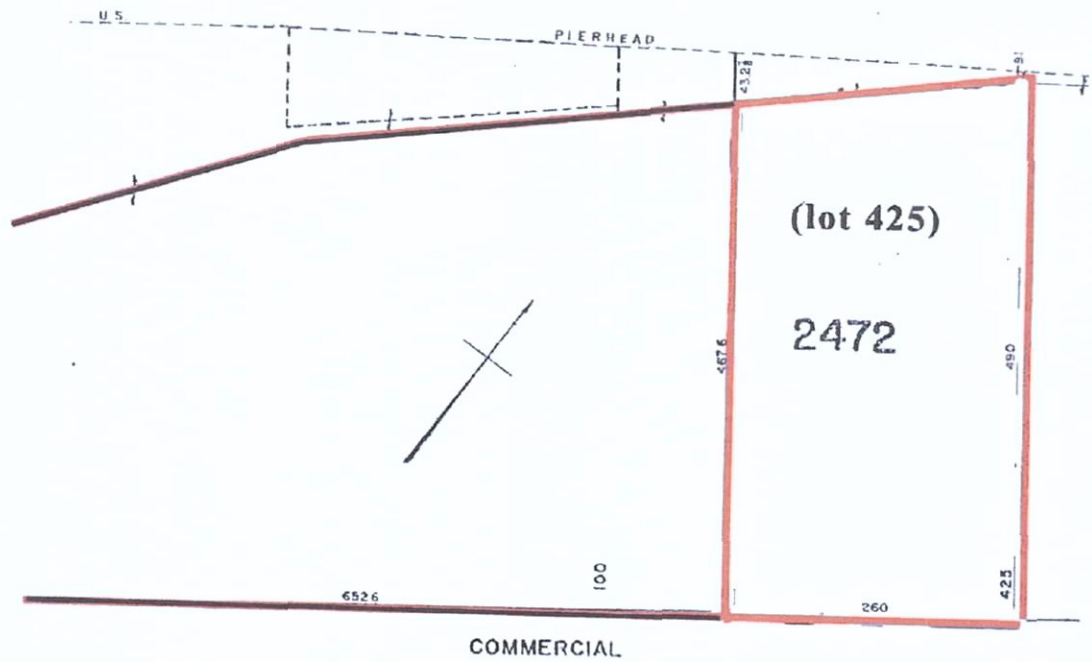

SITE 3 - lot 100, BLOCK 2472
looking southwest (above) and looking northwest (below)



SITE 3

**BLOCK 2472, lot 32 looking west / southwest (above), and
BLOCK 2502 (below)**



**SITE 3 - BLOCK 2510 (above) and BLOCK 2494 (below),
from the northeast corner of Dupont and Franklin Streets**



SITE 3 - BLOCK 2520

lots 57 and 1 looking southwest from West Street (above)

lot 1 looking northwest along Huron Street (below)



SITE 3 (lots 100, 32, 2) - BLOCK 2472

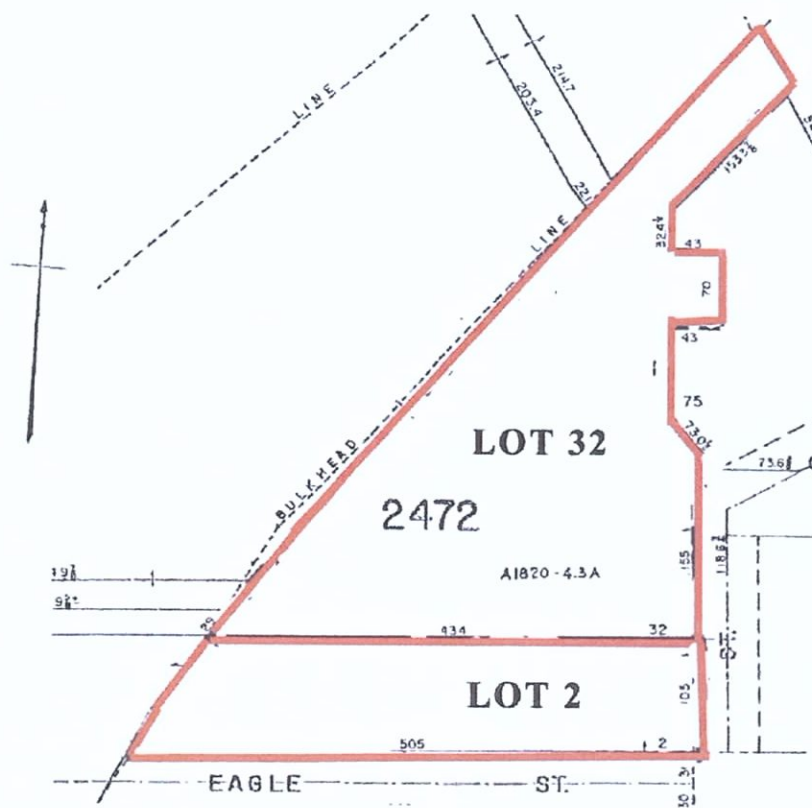
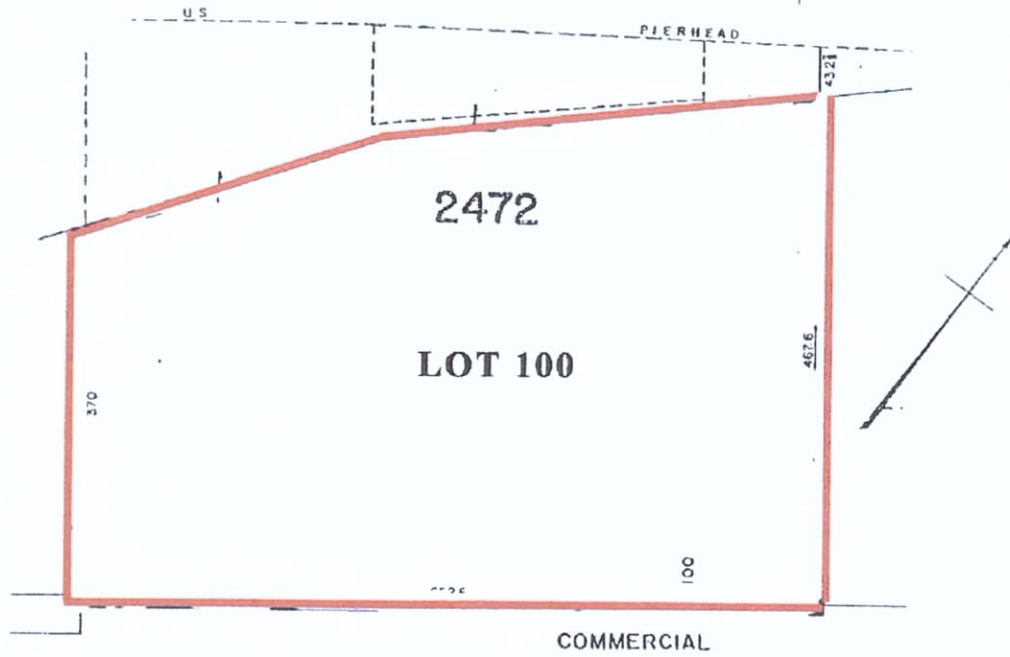

SITE 3 (lot 100) - BLOCK 2472
(2000 Sanborn map)

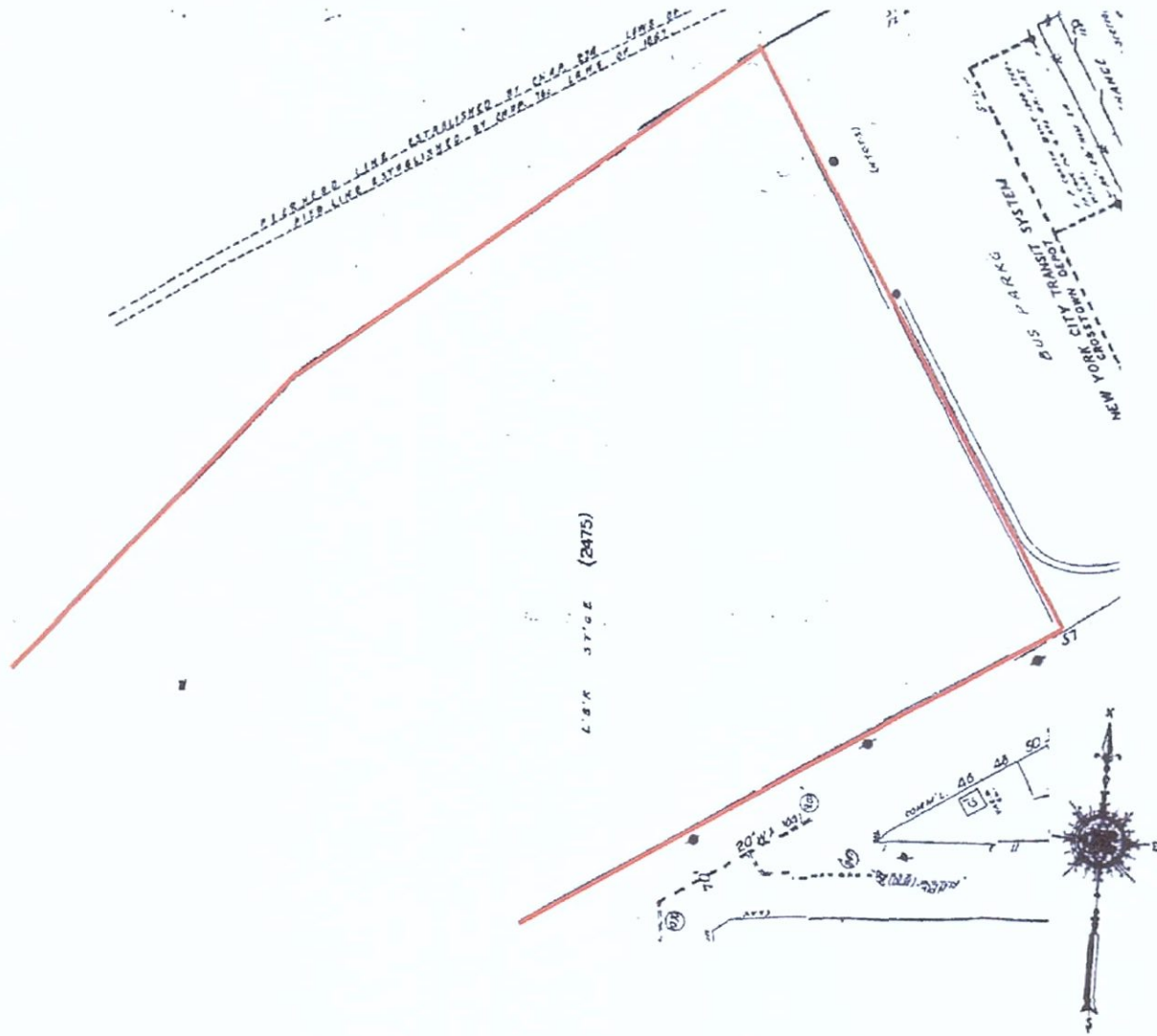

SITE 3 (lots 32, 2) - BLOCK 2472
2000 Sanborn map

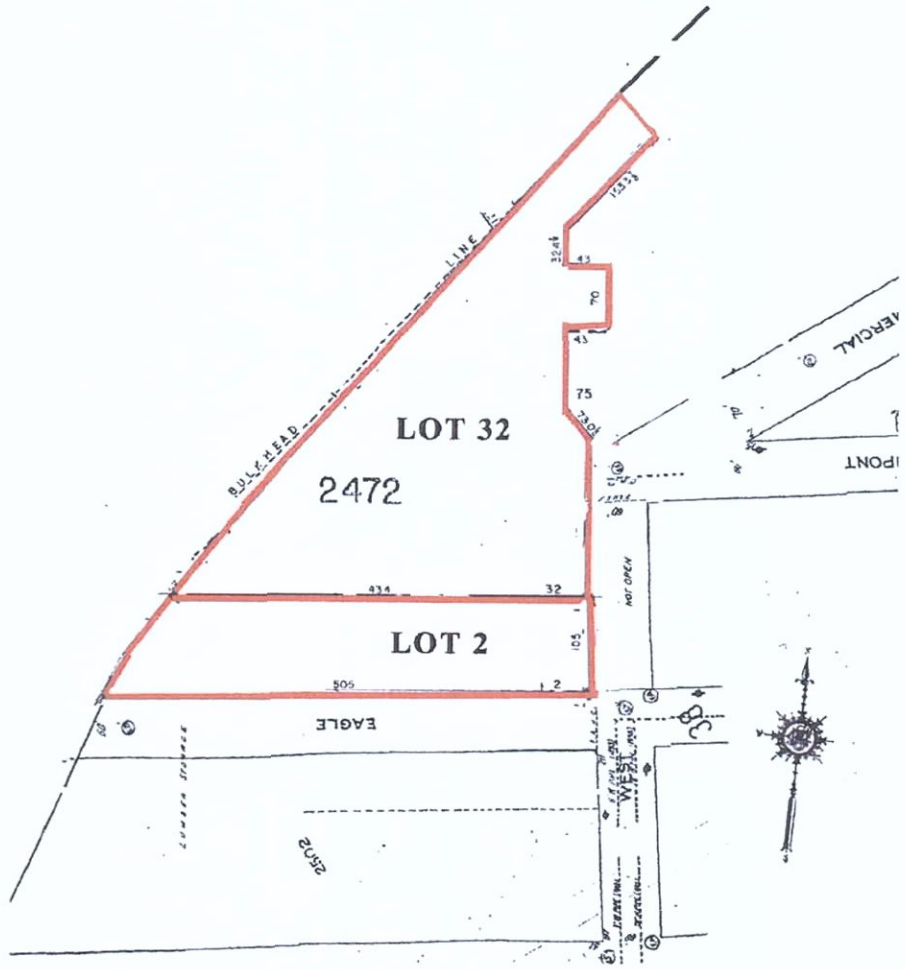

SITE 3 - BLOCK 2494 (lot 1) and BLOCK 2502 (lot 1)

DUPONT ST.

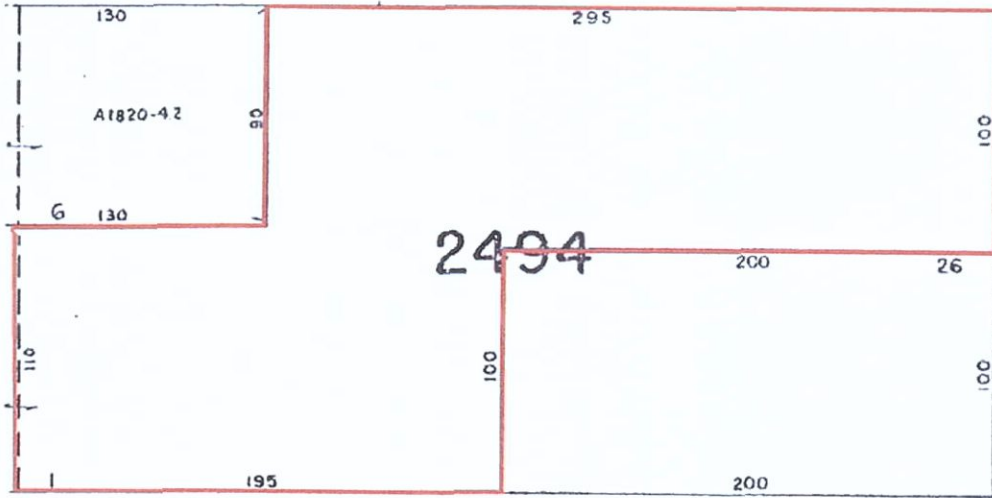

SITE 3 - BLOCK 2494 (lot 1) and BLOCK 2502 (lot 1)
2000 Sanborn map

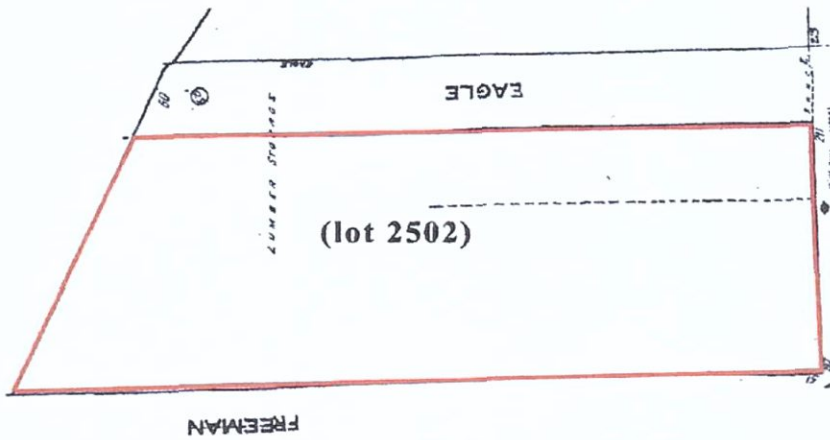
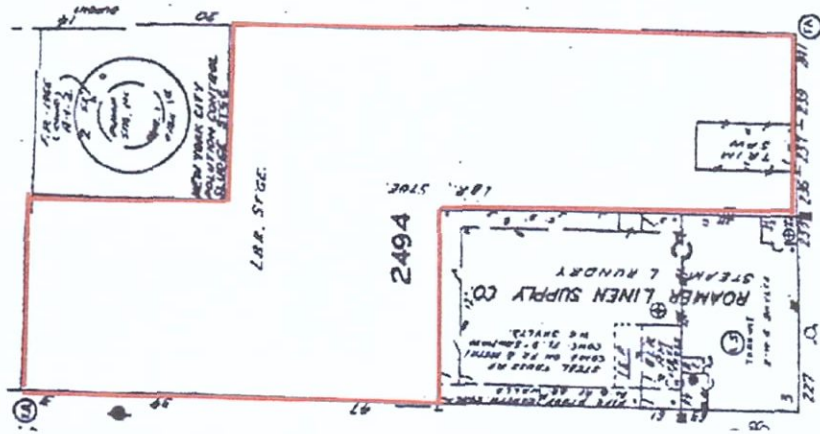

SITE 3 - BLOCK 2510 (lot 1) and BLOCK 2520 (lot 57)
SITE 24 - BLOCK 2520 (lot 1)

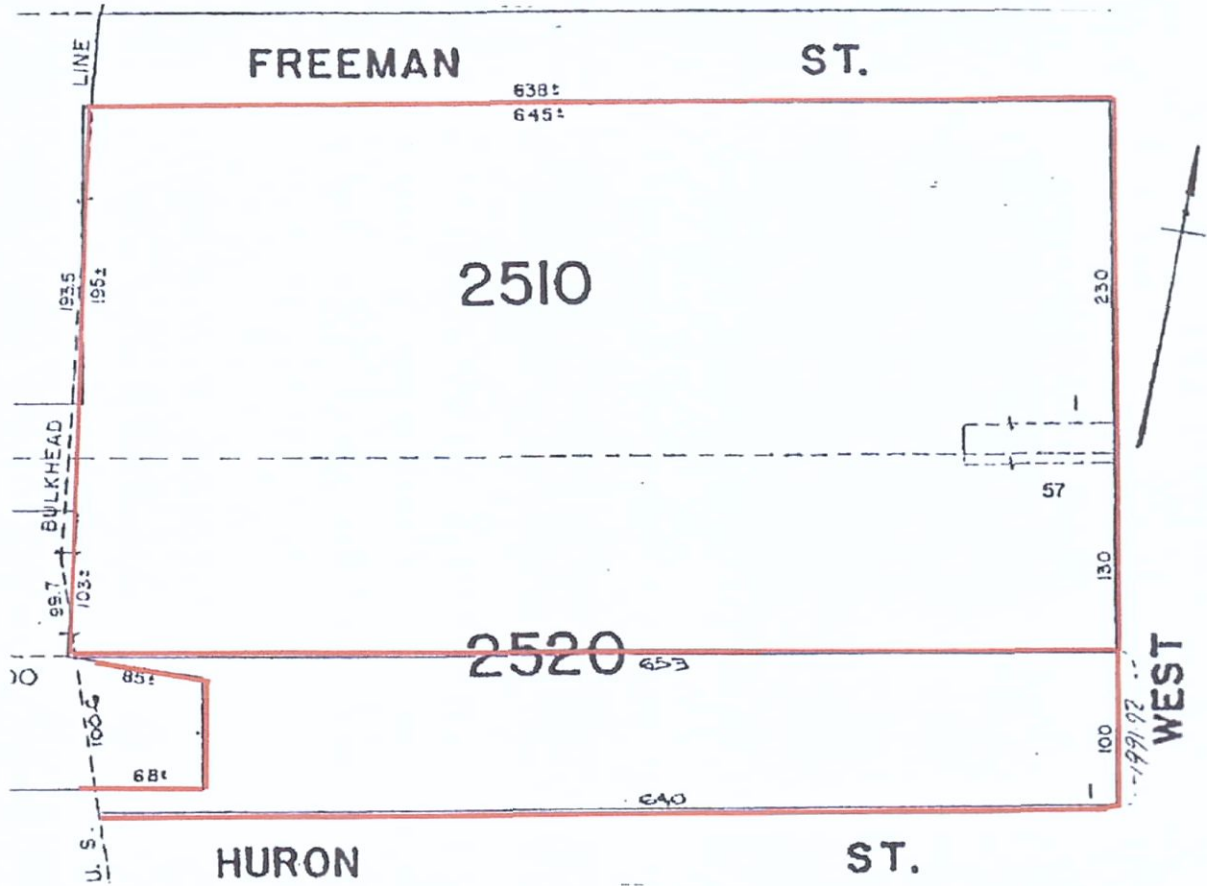

SITE 3 - BLOCK 2510 (lot 1) and BLOCK 2520 (lot 57)
SITE 24 - BLOCK 2520 (lot 1)

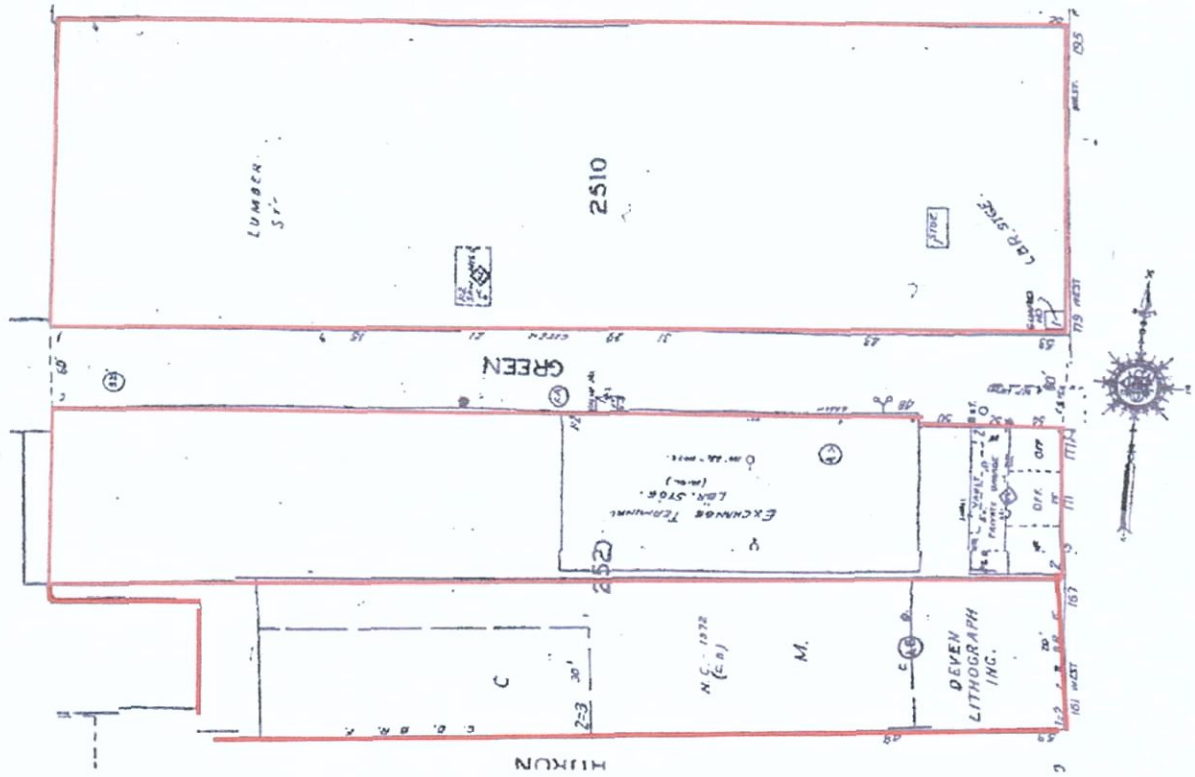

SITE 3

BLOCK 2502 - 1868 Higginson map (above)

BLOCK 2510 - 1868 Higginson map (below)

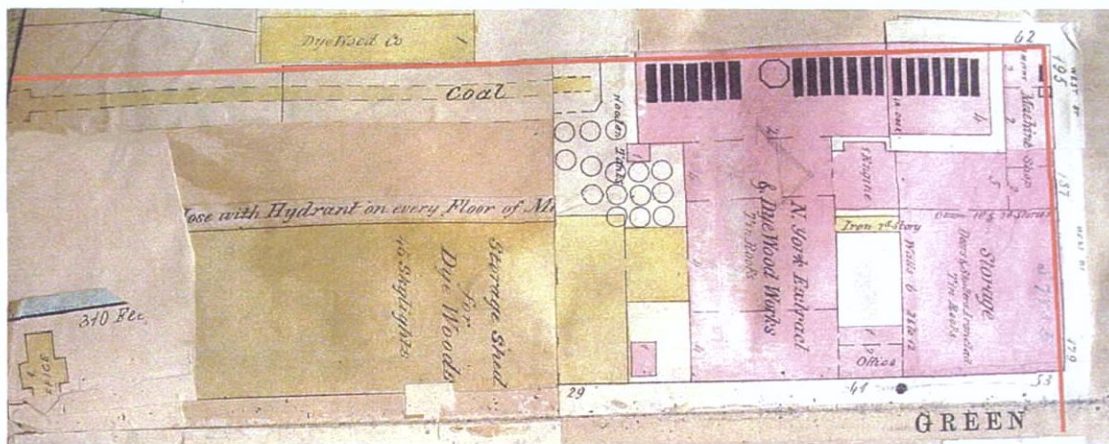
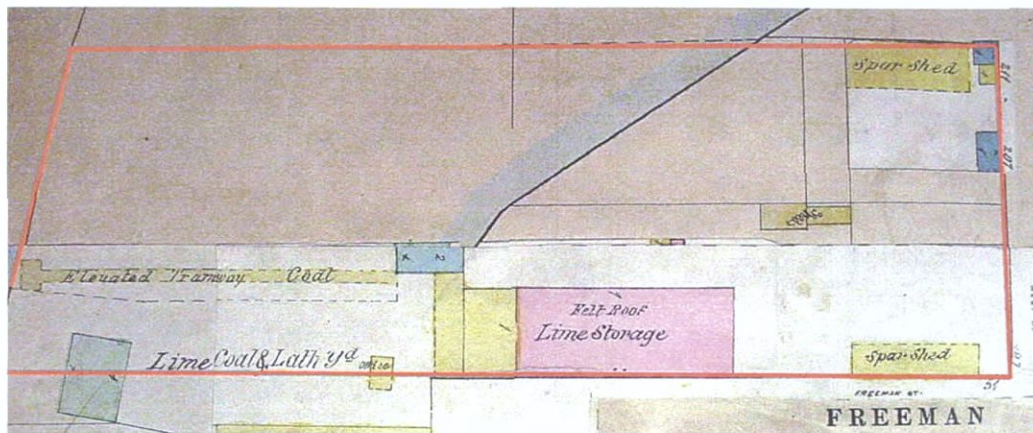

SITE 3 - BLOCK 2494
1868 Higginson map

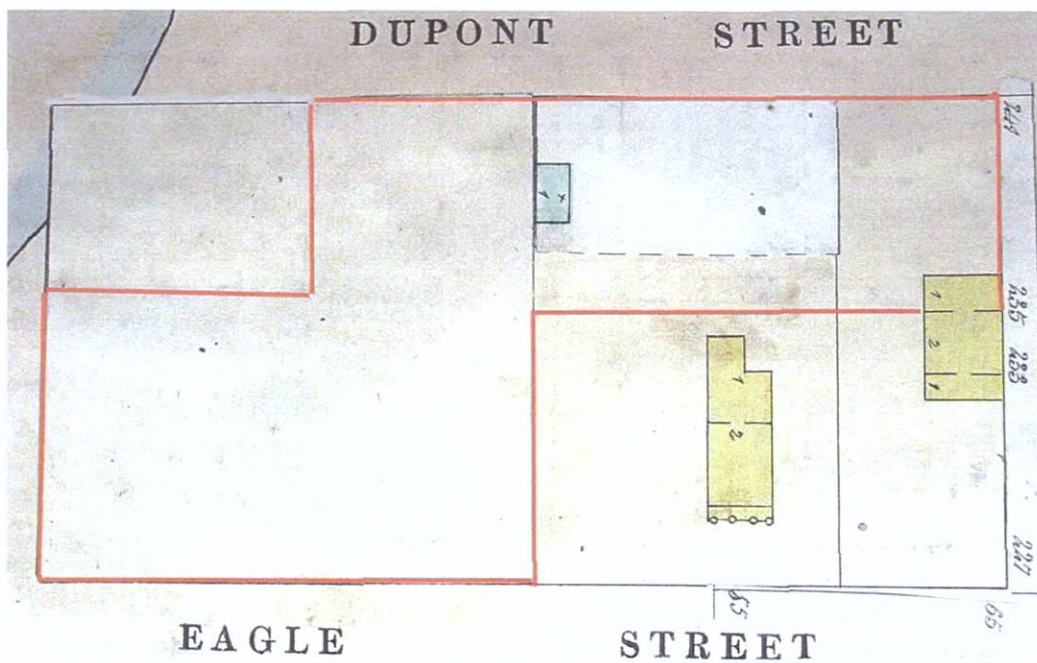

SITE 4 (above) and SITE 8 (below) - BLOCK 2482



SITES 4 (lot 1) and 8 (lot 39) BLOCK 2482

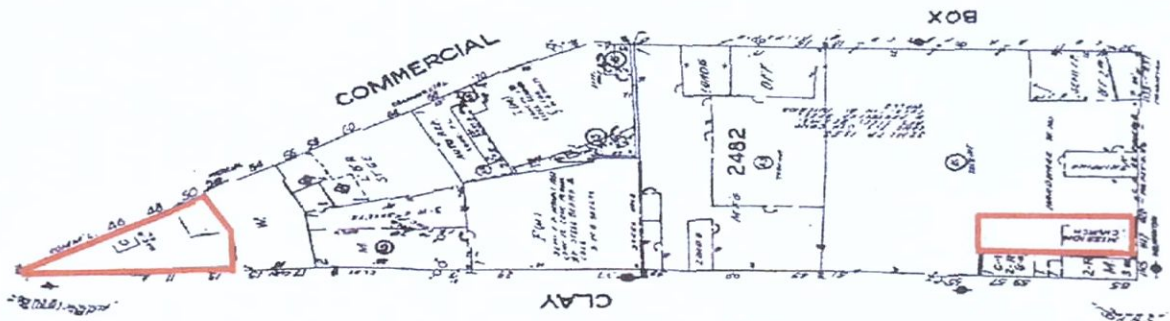
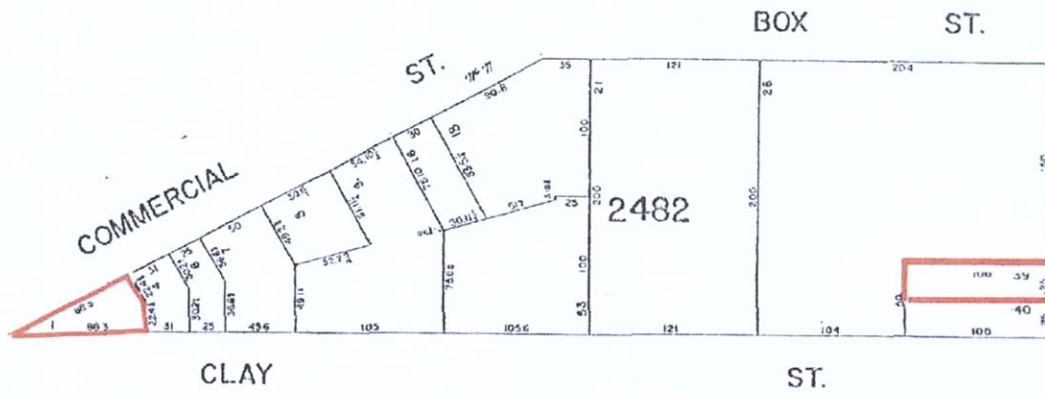

SITE 4 (lot 1) and SITE 8 (lot 39) - BLOCK 2482
1868 Higginson map (above)
1898 Hyde map (below)

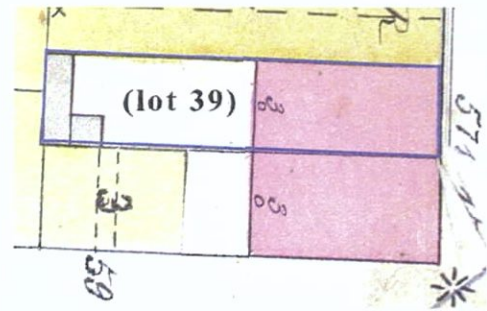
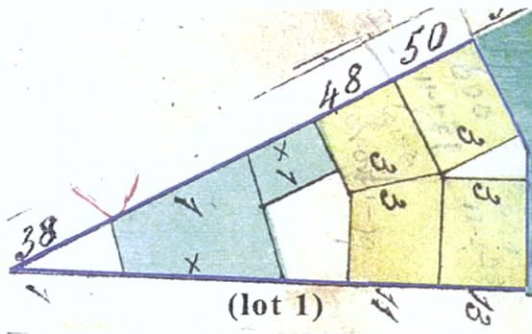

(lot 1)

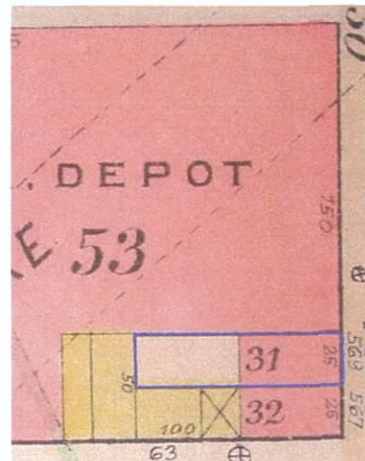

**SITE 9 - lots 61, 62 (above) and SITE 10 - lots 11, 12 (below)
BLOCK 2483**



SITE 11 - lot 14 (above) and SITE 12 - lot 20 (below)
BLOCK 2483



**SITE 13 - lot 59 (above) and SITE 15 - lot 25 (below)
BLOCK 2483**



BLOCK 2483

**SITES 9 (lots 61, 62), 10 (lots 11, 12),
11 (lot 14) and 13 (lot 59)**

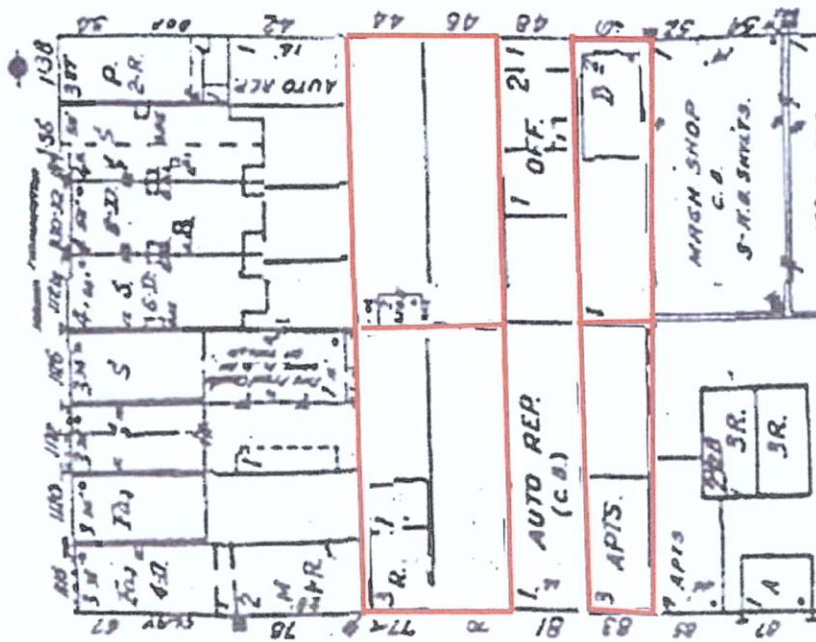
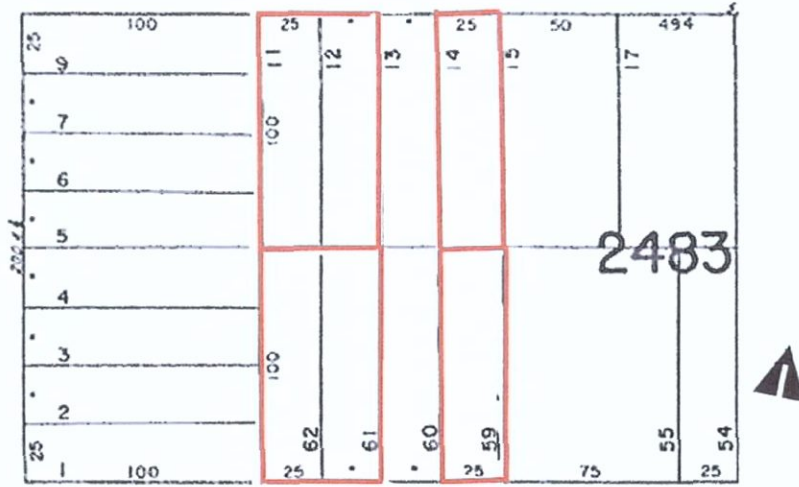

SITE 12 (lot 20) and SITE 15 (lot 25)
BLOCK 2483

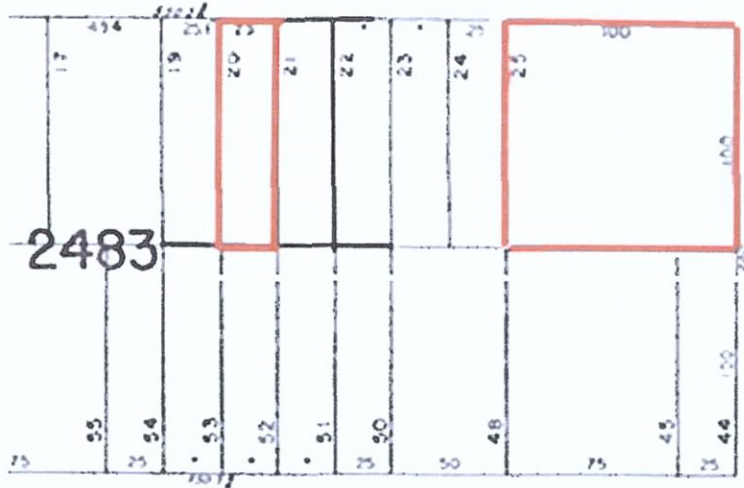

SITES 9, 10, 11, 12, 13 and 15 - BLOCK 2483
1868 Higginson map (above)
1912 Hyde map (below)

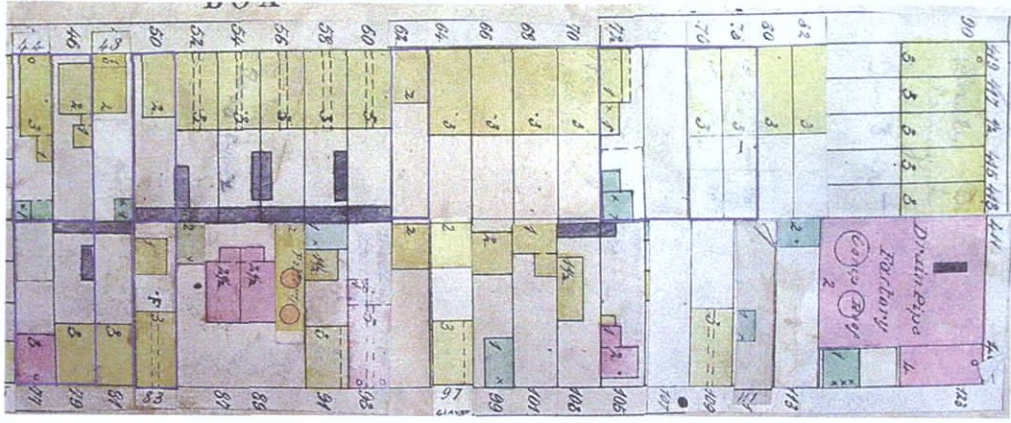

SITE 20 - BLOCK 2411



SITE 20 (lot 14) - BLOCK 2511

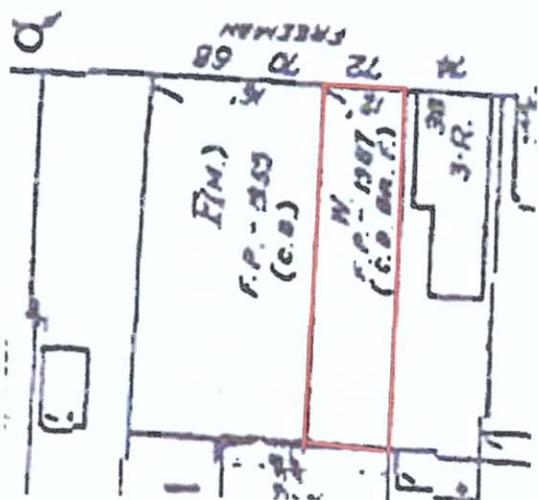
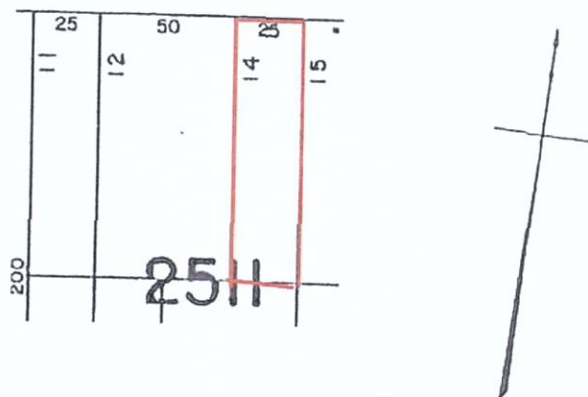

SITE 20 - BLOCK 2411

1868 Higginson map (above)

1898 Hyde map (bottom left)

1912 Hyde map (bottom right)

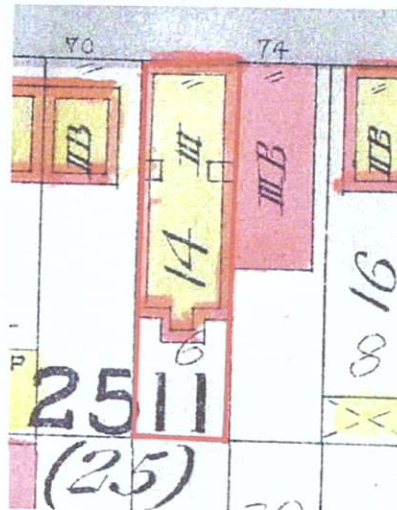
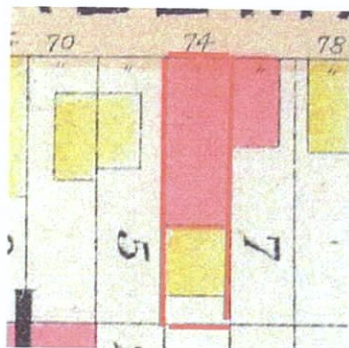
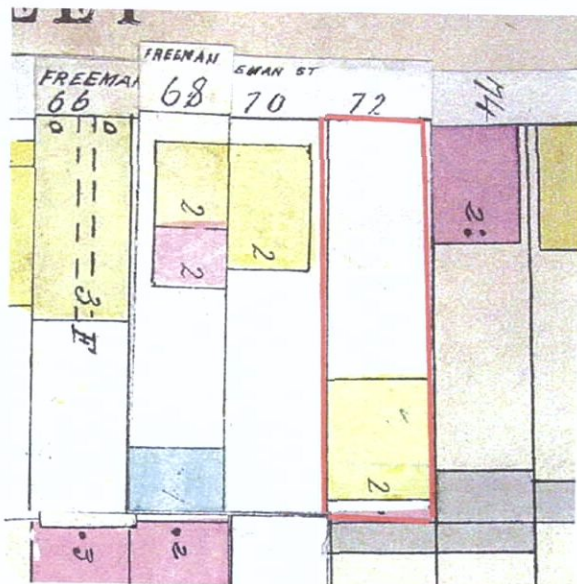

**SITE 22 from Green Street looking west (above), and
SITE 23 (below) - BLOCK 2512**



SITES 22 (lot 60) and 23 (lot 54) - BLOCK 2512

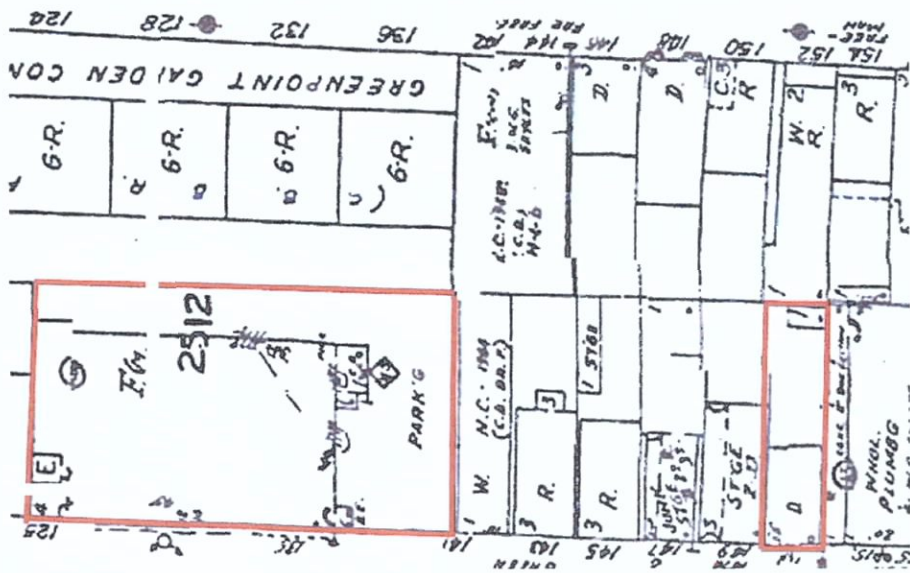
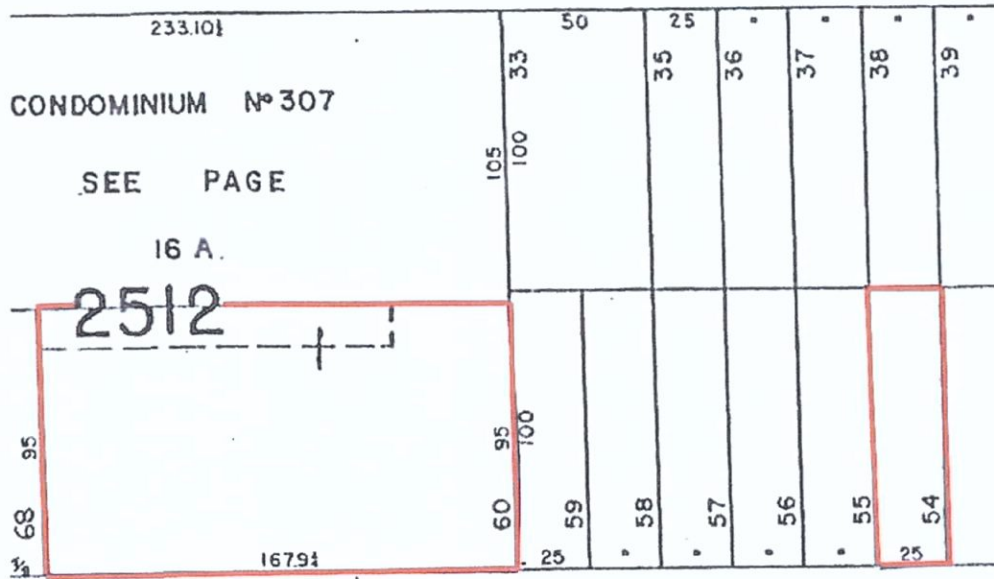

SITES 22 and 23 - BLOCK 2512
1868 Higginson map (above)
1912 Hyde map (below)

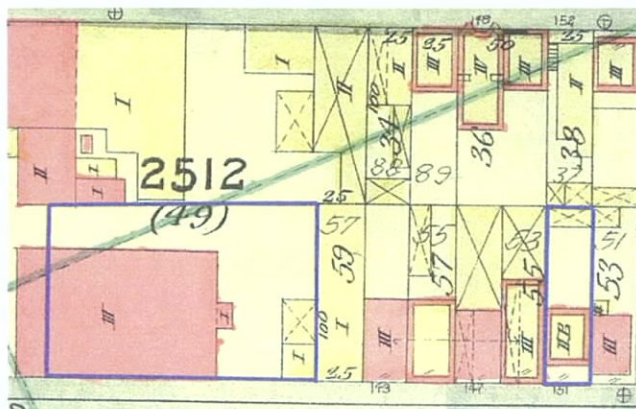
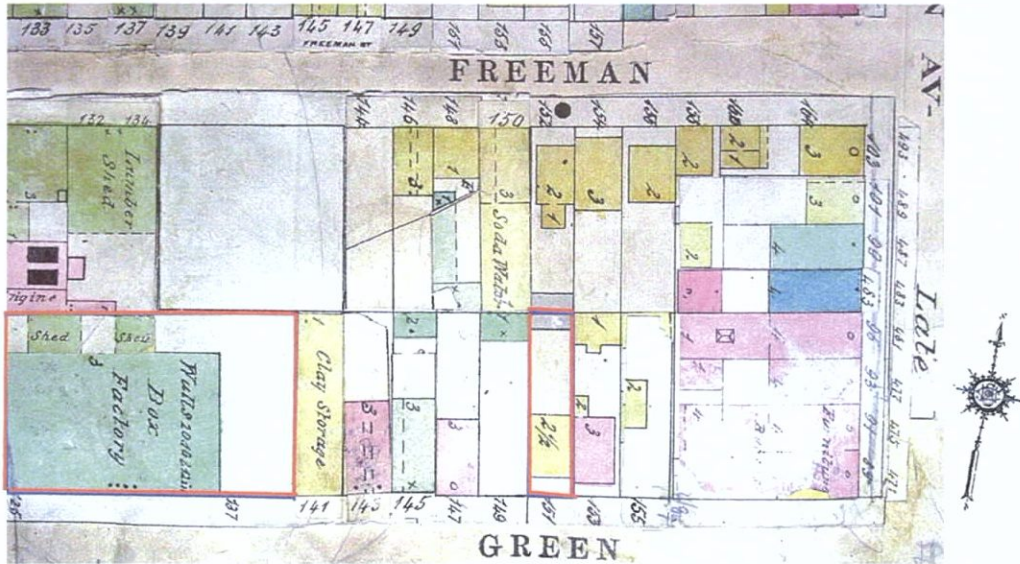

SITES 25 (above) and 26 (below) - BLOCK 2521



**SITE 27 - lot 11, above and SITE 29 - lot 19, below
BLOCK 2521**



SITES 25 (lot 1), 26 (lots 5, 6, 7), 27 (lot 11) and 29 (lot 19)
BLOCK 2521

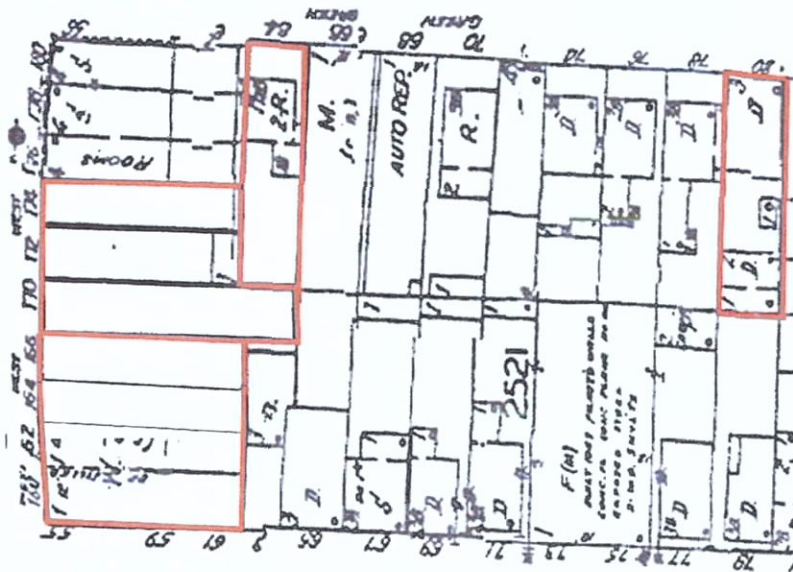
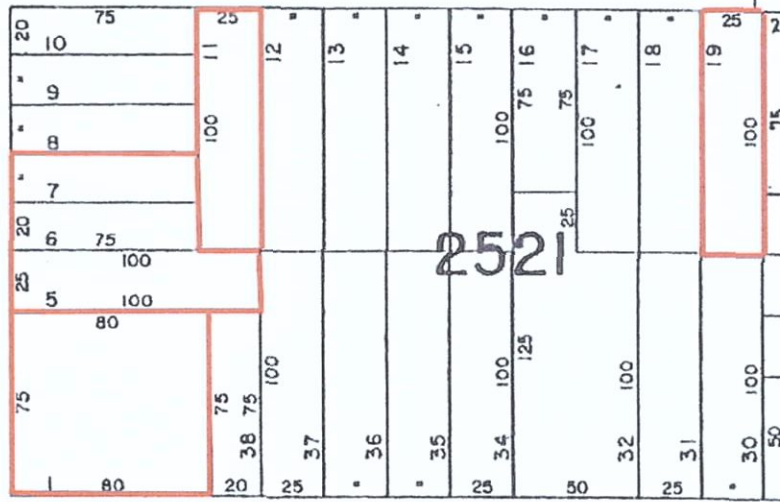

SITES 25, 26, 27 and 29 - BLOCK 2521
1868 Higginson map (above)
1912 Hyde map (below)

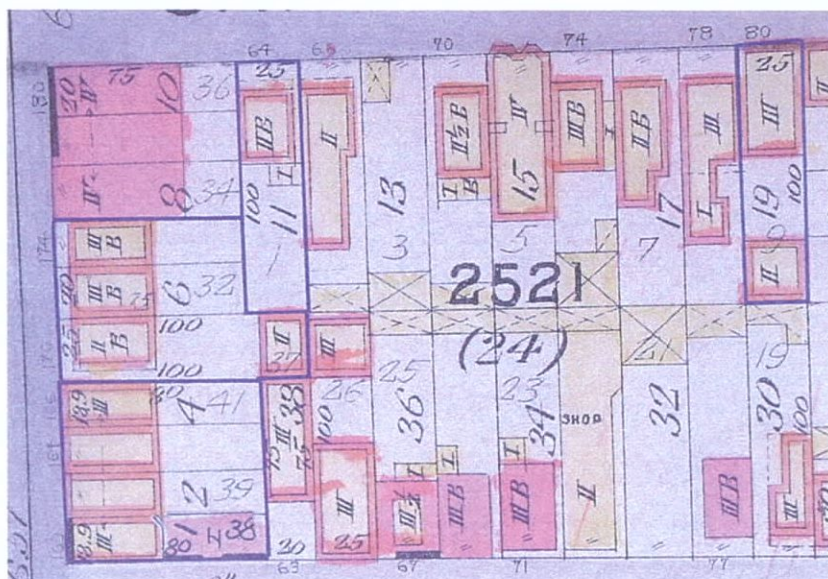
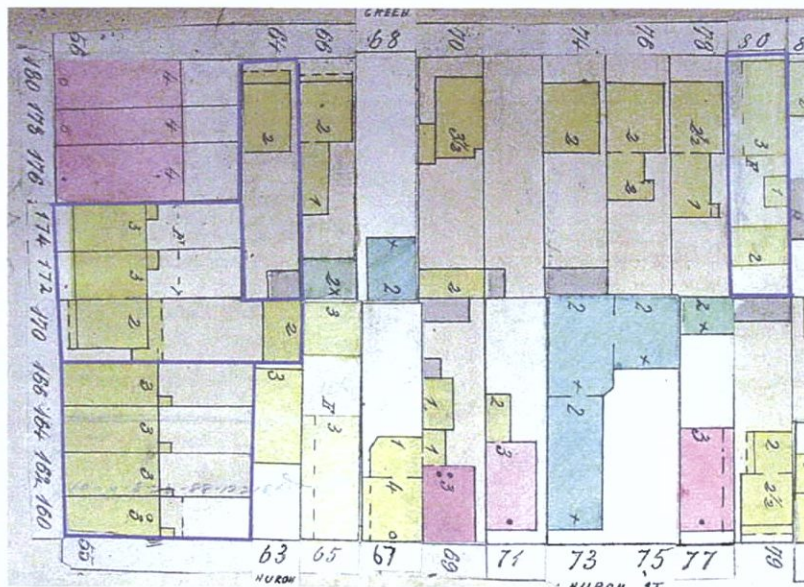

SITE 30 - BLOCK 2522 (above)
SITE 34 - BLOCK 2530 (below) from the corner of Huron
and West Streets



SITE 30 (lot 10) - BLOCK 2522

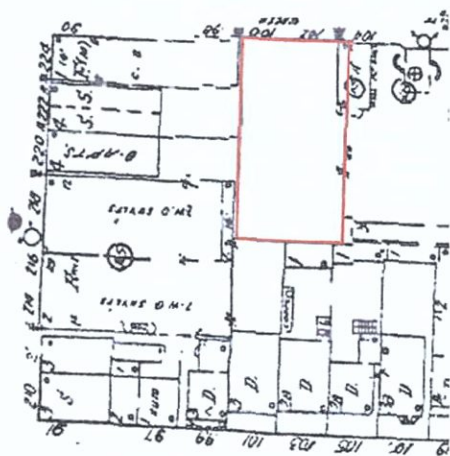
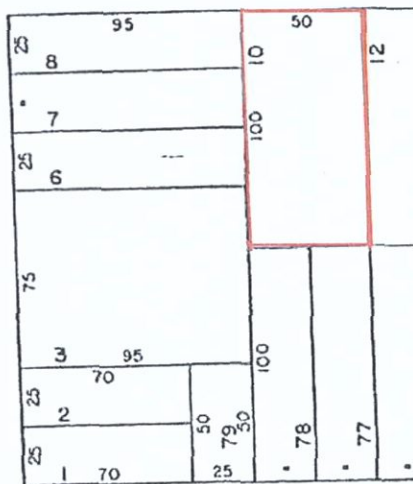

SITE 30 - BLOCK 2522
1898 Hyde map (top)
1912 Hyde map (middle)
1929 Hyde map (bottom)

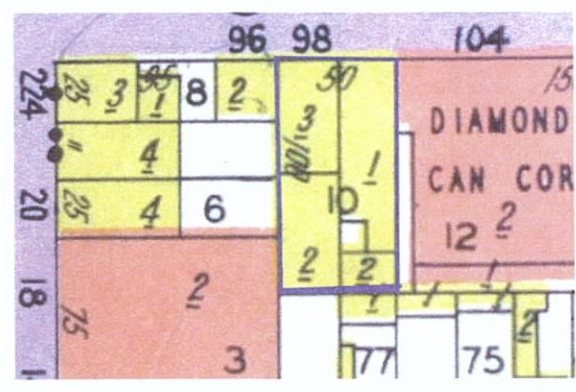
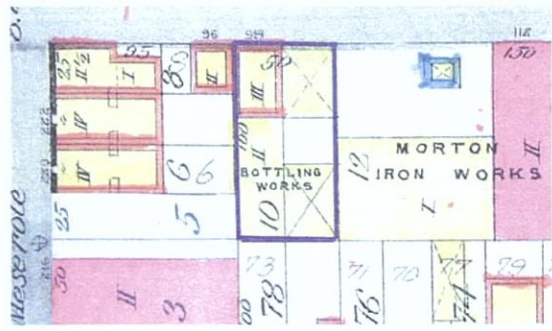
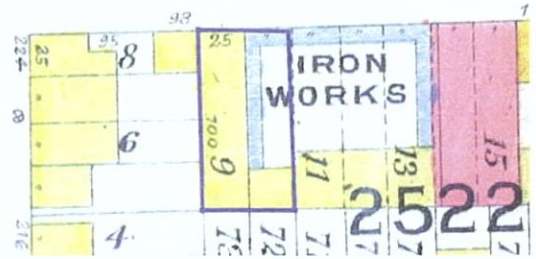

SITE 34 (lots 1, 55, 56)
Block 2530

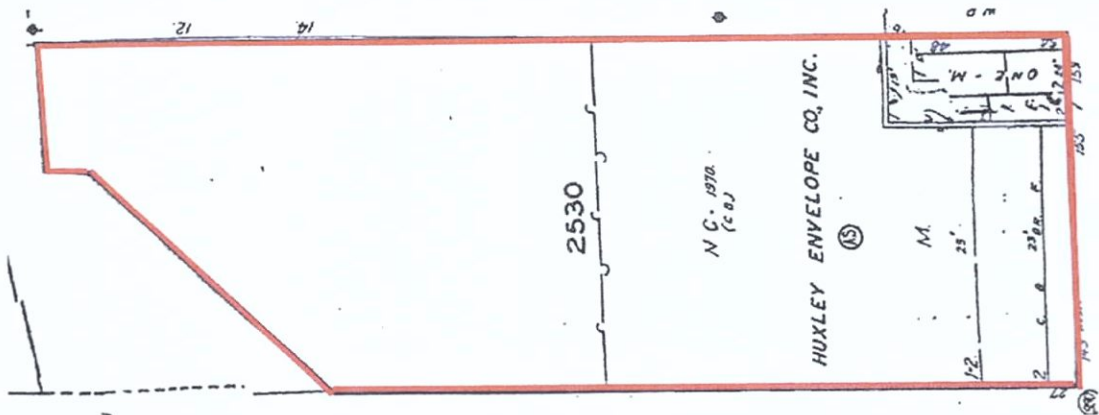
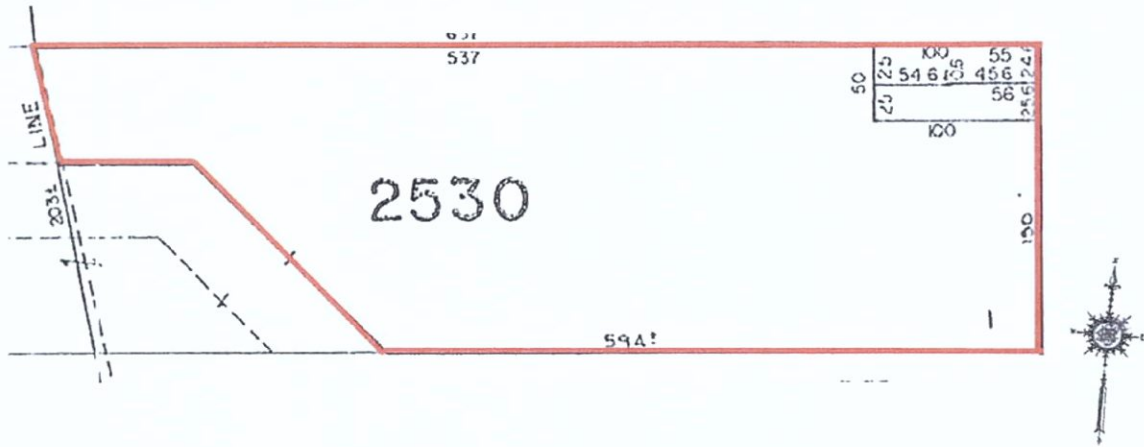

SITE 34 - BLOCK 2530
1868 Higginson map

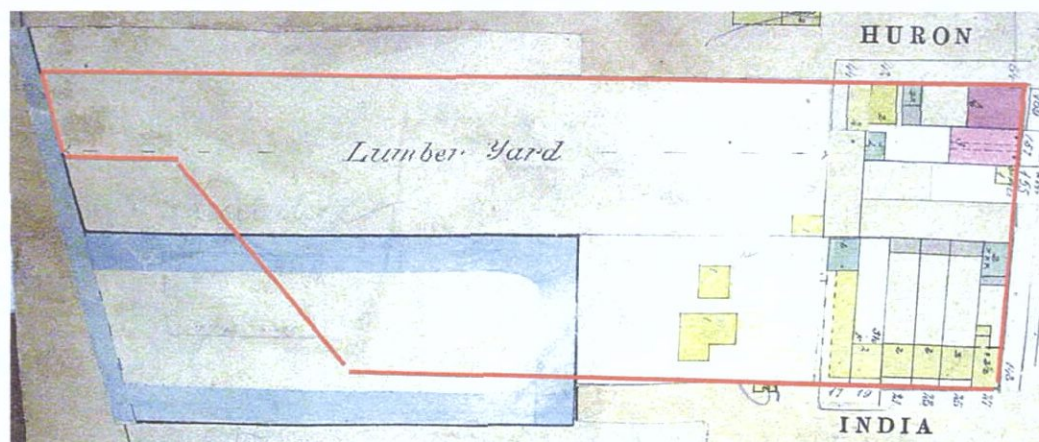

SITE 35 (above) and SITE 36 (below) - BLOCK 2531



SITE 38 (above) and SITE 39 (below) - BLOCK 2531



SITES 35 (lots 1, 2, 3), 36 (lots 9, 10), 38 (lots 36, 35) and 39 (lot 20)
 BLOCK 2531

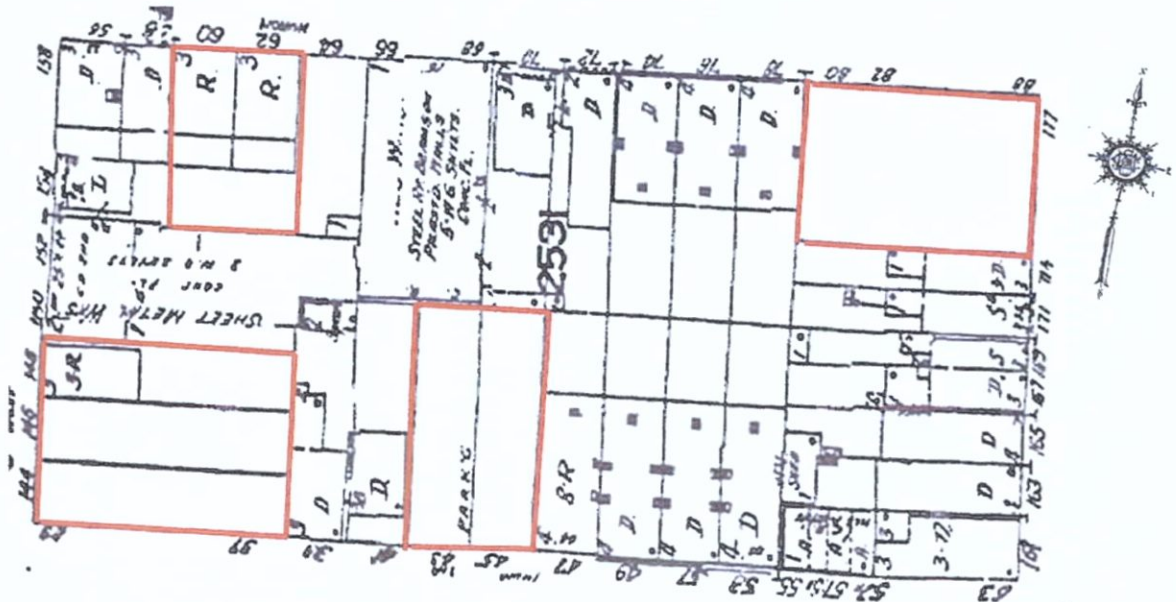
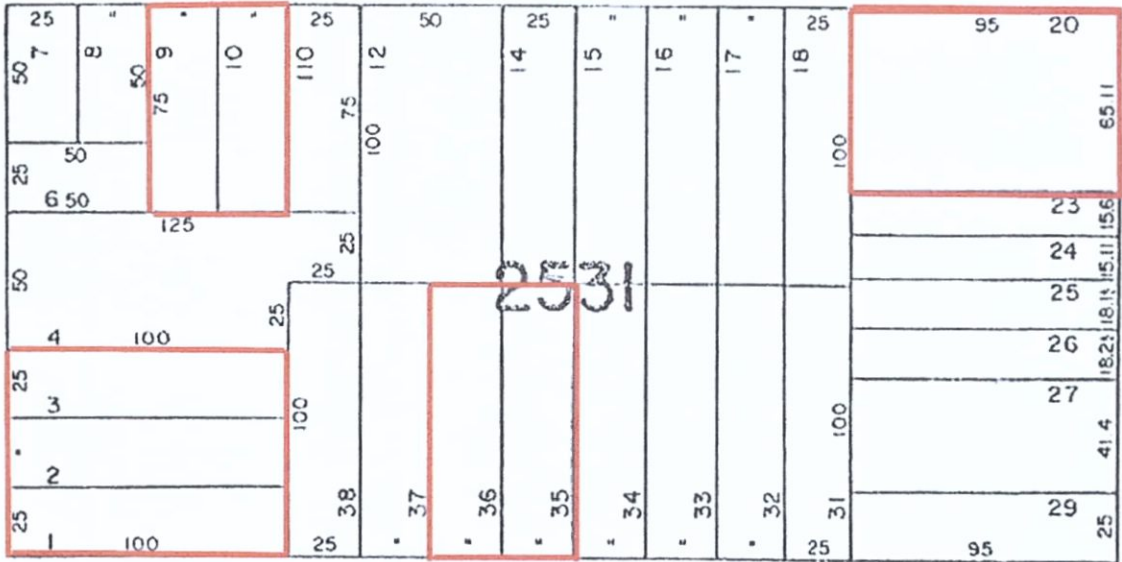

SITES 35, 36, 38 and 39 - BLOCK 2531
1868 Higginson map (top)
1912 Hyde map (middle)
SITE 35 - 1989 Sanborn map (bottom)

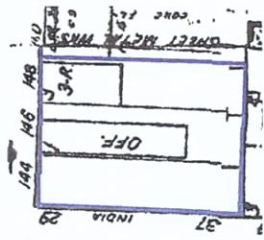
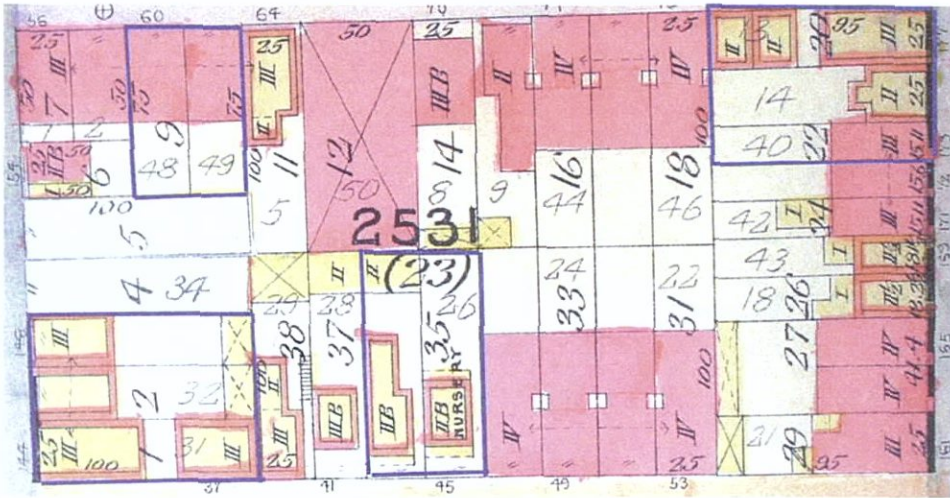
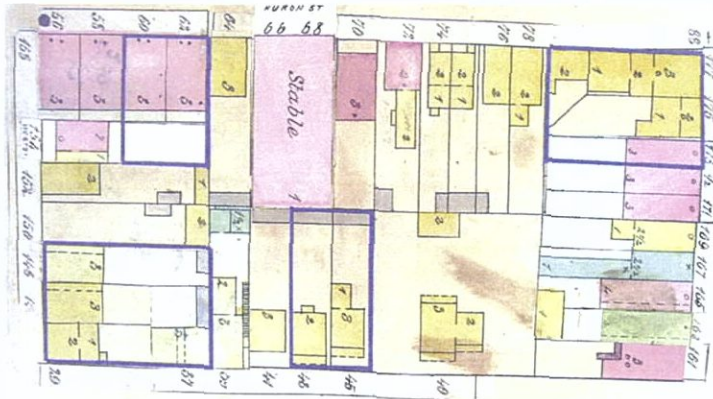

SITE 40 - BLOCK 2532



SITE 40 (lot 1) - BLOCK 2538

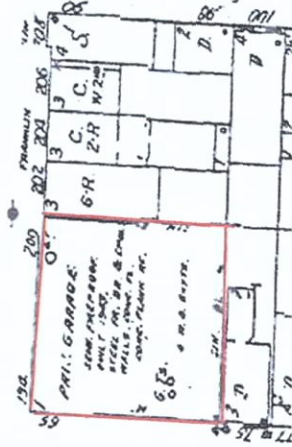
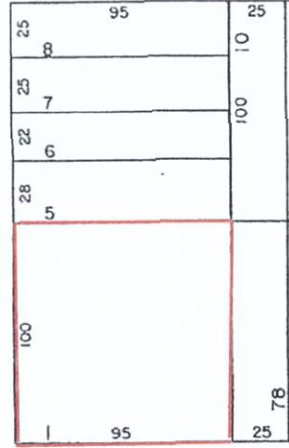

SITE 41 - BLOCK 2538
looking southwest along India Street (above) and
looking south along West Street (below)



SITE 41 (lot 1) - BLOCK 2538

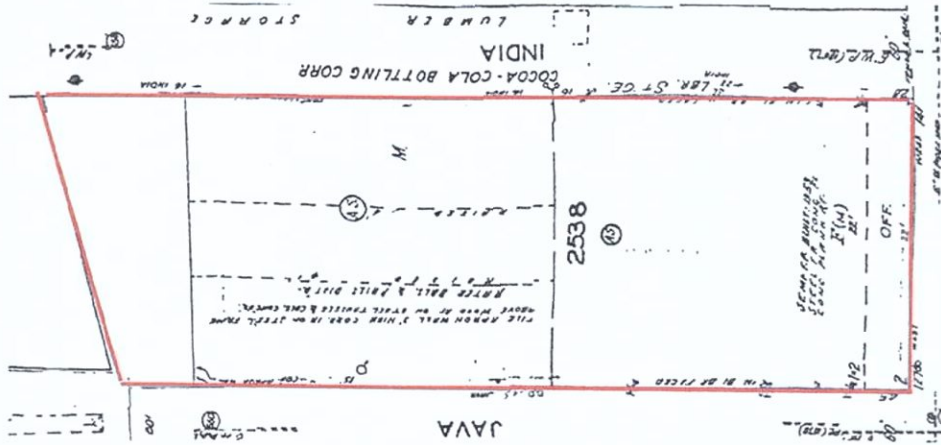
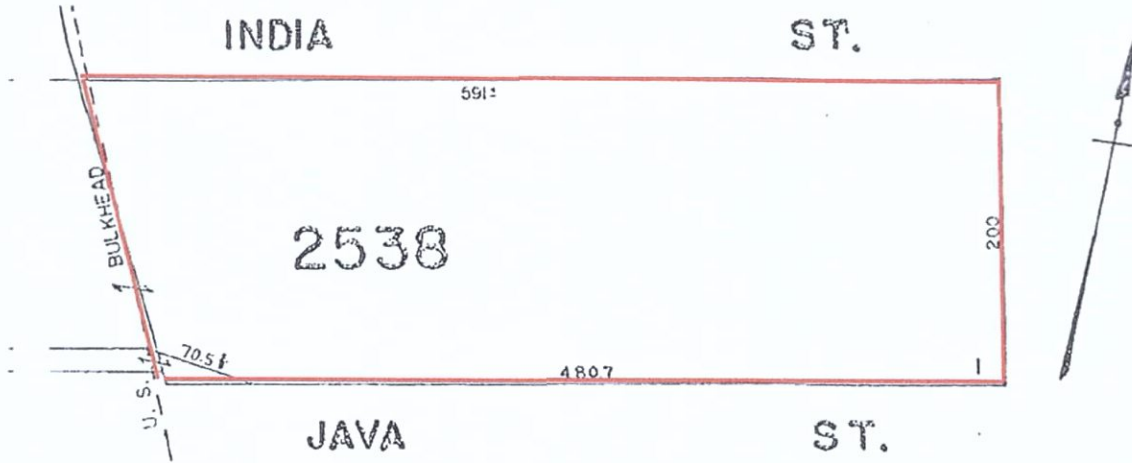

SITE 42 (above) and SITE 43 (below) - BLOCK 2539



SITES 42 and 43 - BLOCK 2539
1868 Higginson map (above)
1912 Hyde map (below)

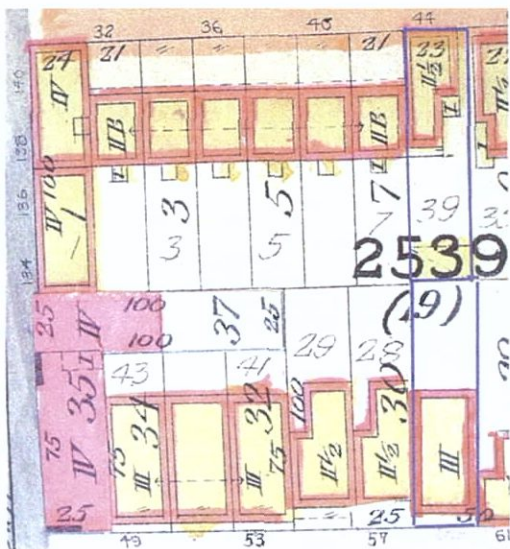
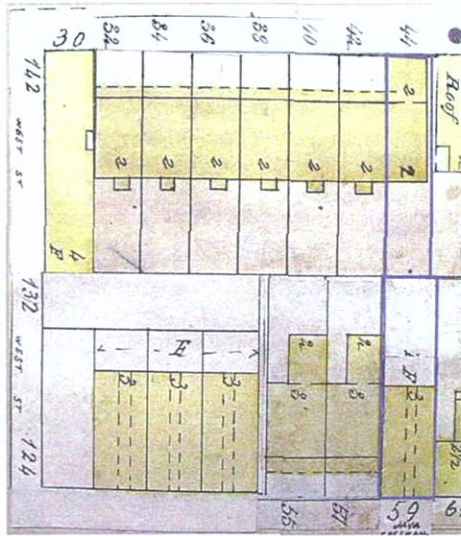

SITE 44 - BLOCK 2543
from the corner of Java and West Streets
looking west (above) and looking southwest (below)



SITE 44 (lot 1)
Block 2543

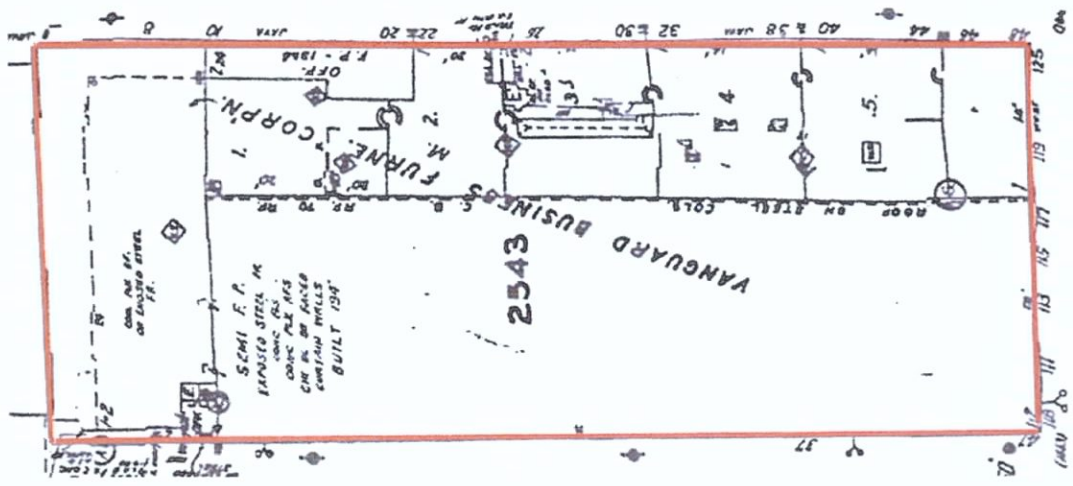
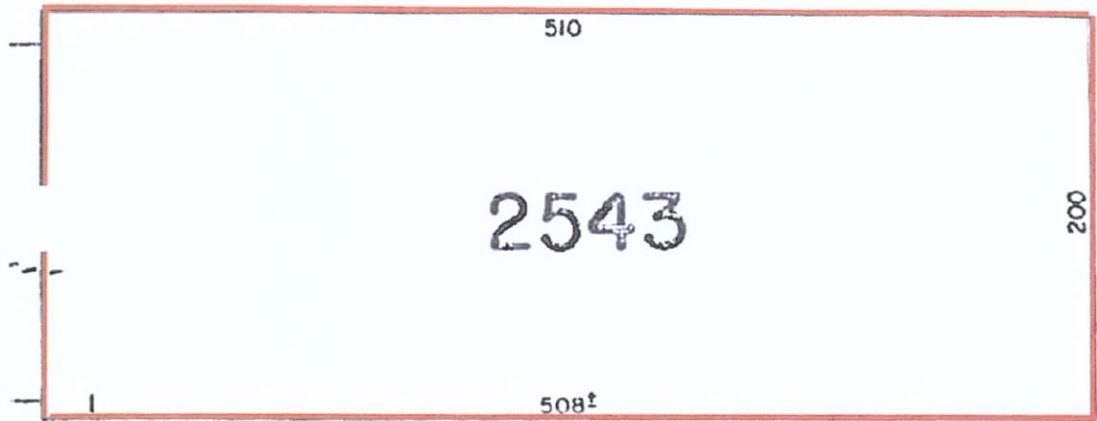

SITE 46 - BLOCK 2549



SITE 46 (lot 10) - BLOCK 2549

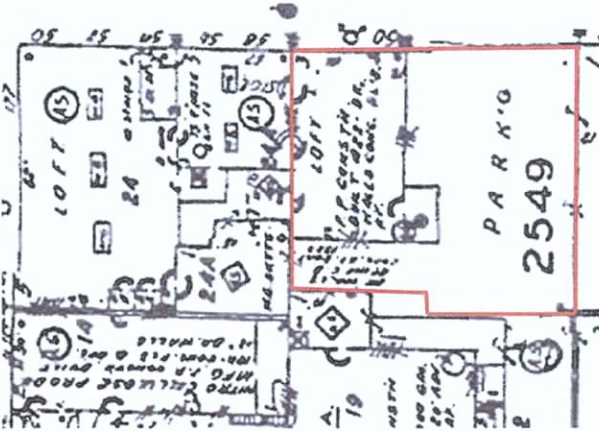
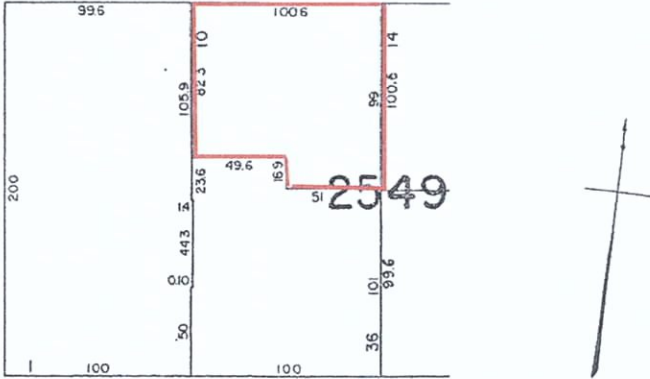

SITE 46 - BLOCK 2549
1868 Higginson map



SITE 52 - BLOCK 2556



SITE 52 - BLOCK 2556
 1868 Higginson map (top left)
 1898 Hyde map (top right)
 1929 Hyde map (below)

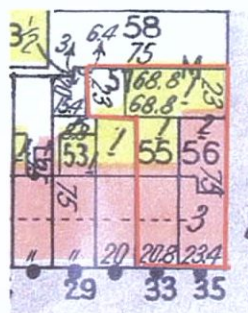
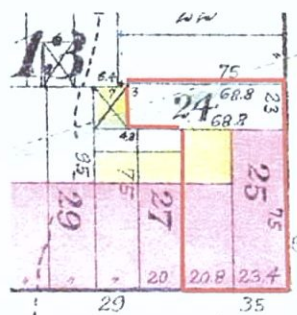
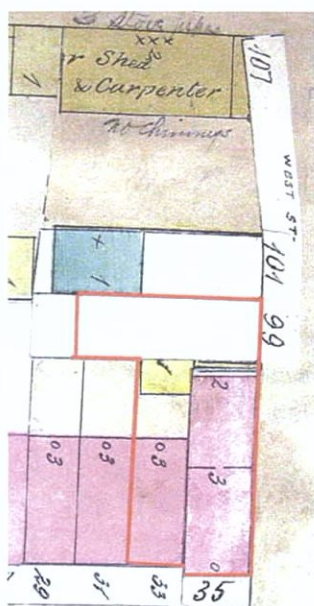

SITE 56 - BLOCK 2556B
looking along Greenpoint Avenue (above)
looking south along West Street (below)



SITE 56 (lot 1) - BLOCK 2556B

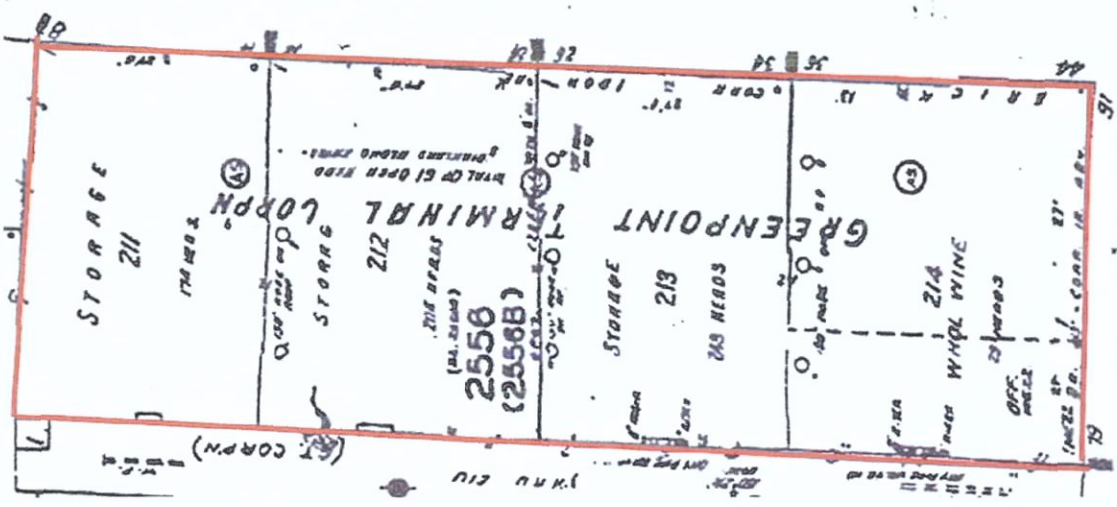
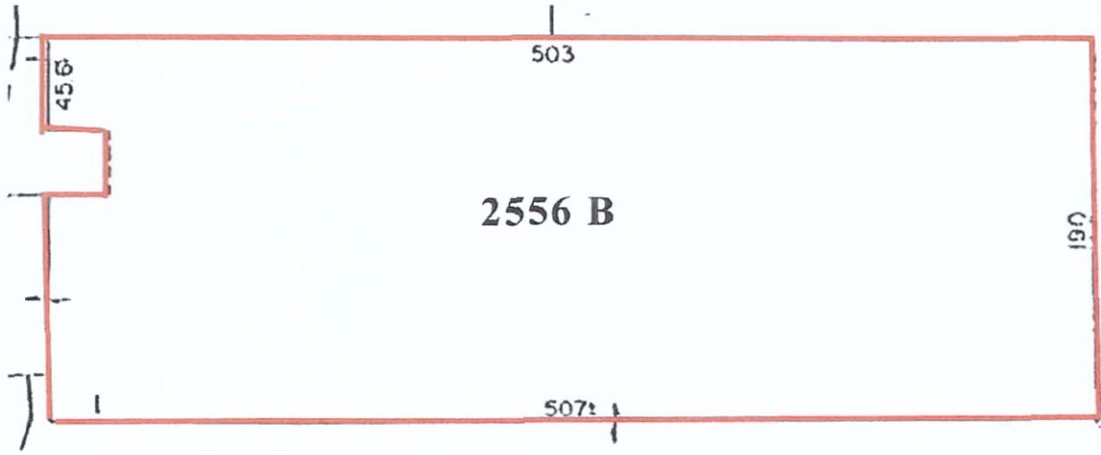

SITE 62 - BLOCK 2570

**from Oak and West Streets looking southwest (above), and
from the corner of Calyer and West Streets looking northwest (below)**



SITE 62 (lot 1)
Block 2570

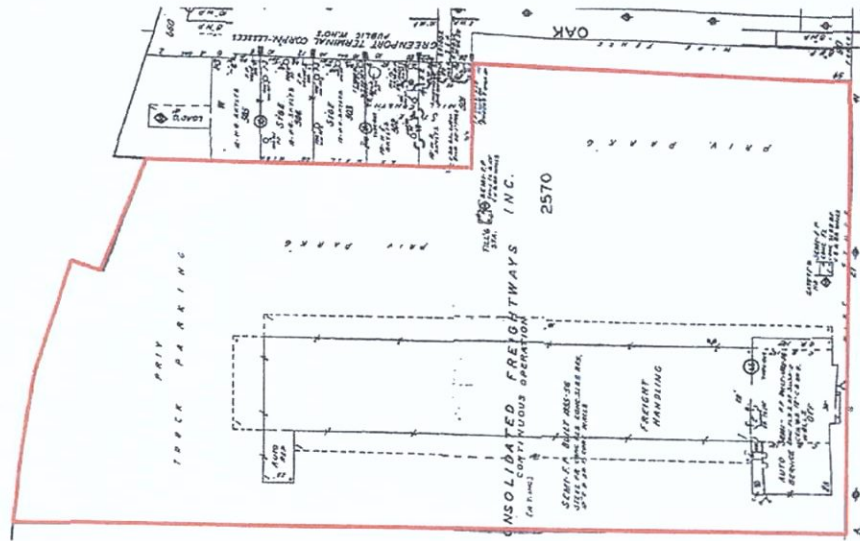
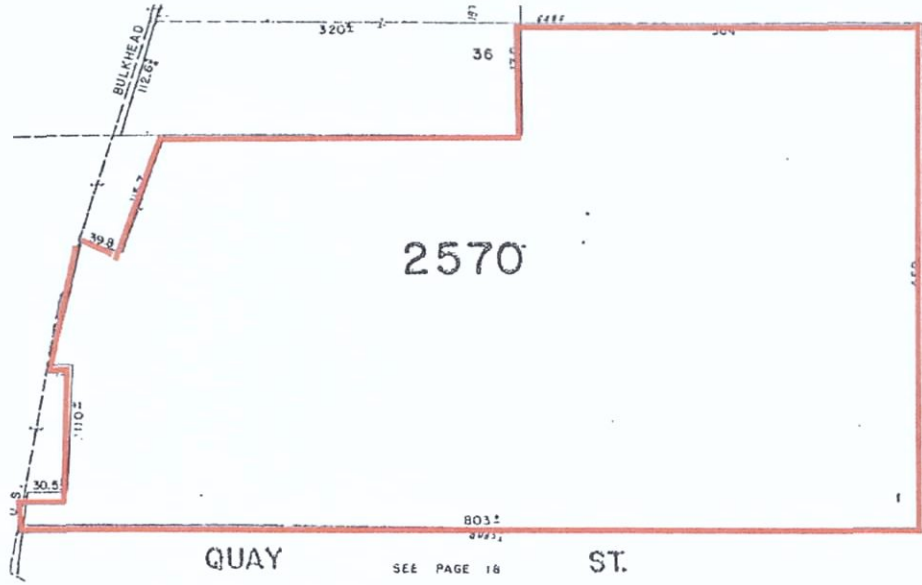

SITE 63 - BLOCK 2571



SITE 63 (lots 1, 9) - BLOCK 2571

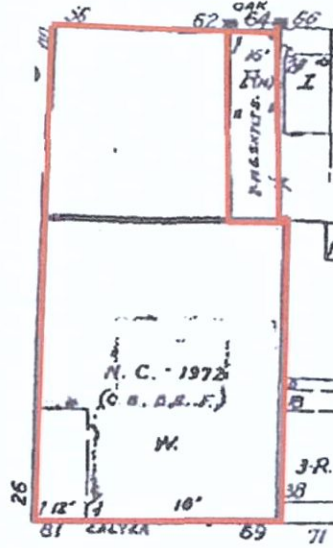
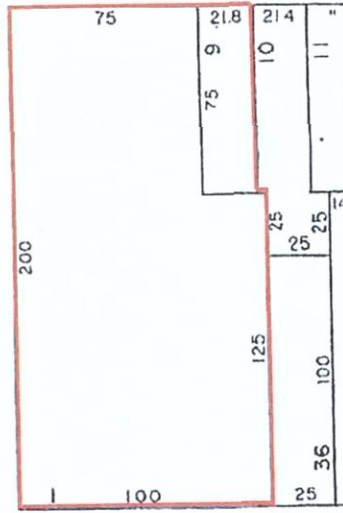

SITE 63 - BLOCK 2571

1868 Higginson map (top left)

1912 Hyde map (top right)

1951 Sanborn map (bottom)

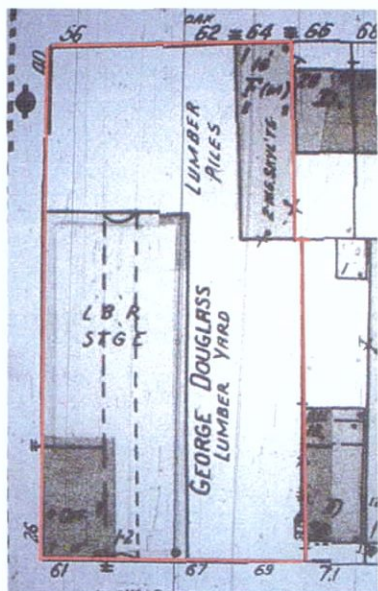
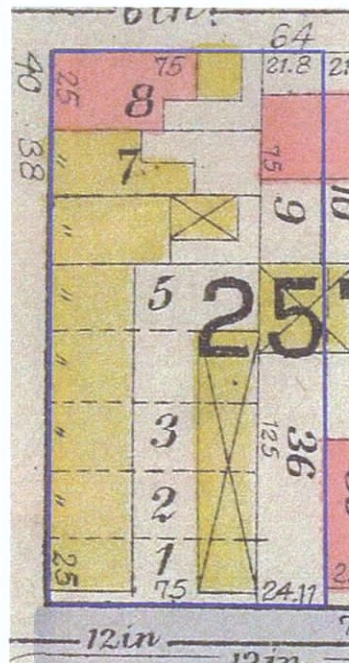
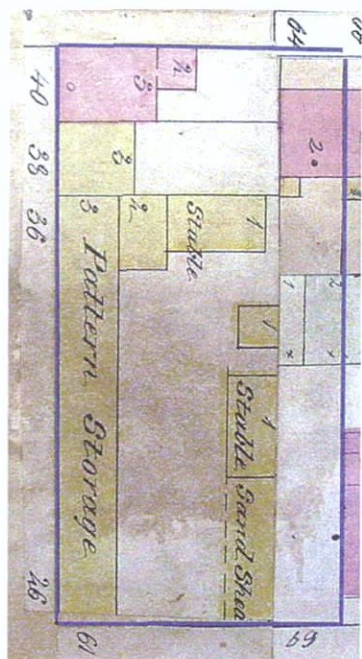

SITES 68 (above) and 211 (below) - BLOCK 2590



SITES 68 (lot 210) and 211 (lot 100)
BLOCK 2590

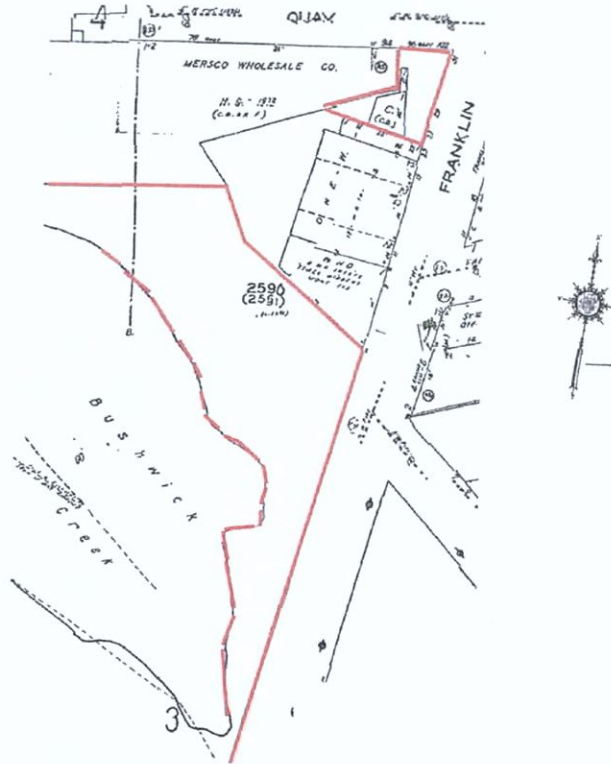

SEE SEC. 8, VOL. 5

SITES 68 and 211 - BLOCK 2590
1912 Hyde map (above and below)

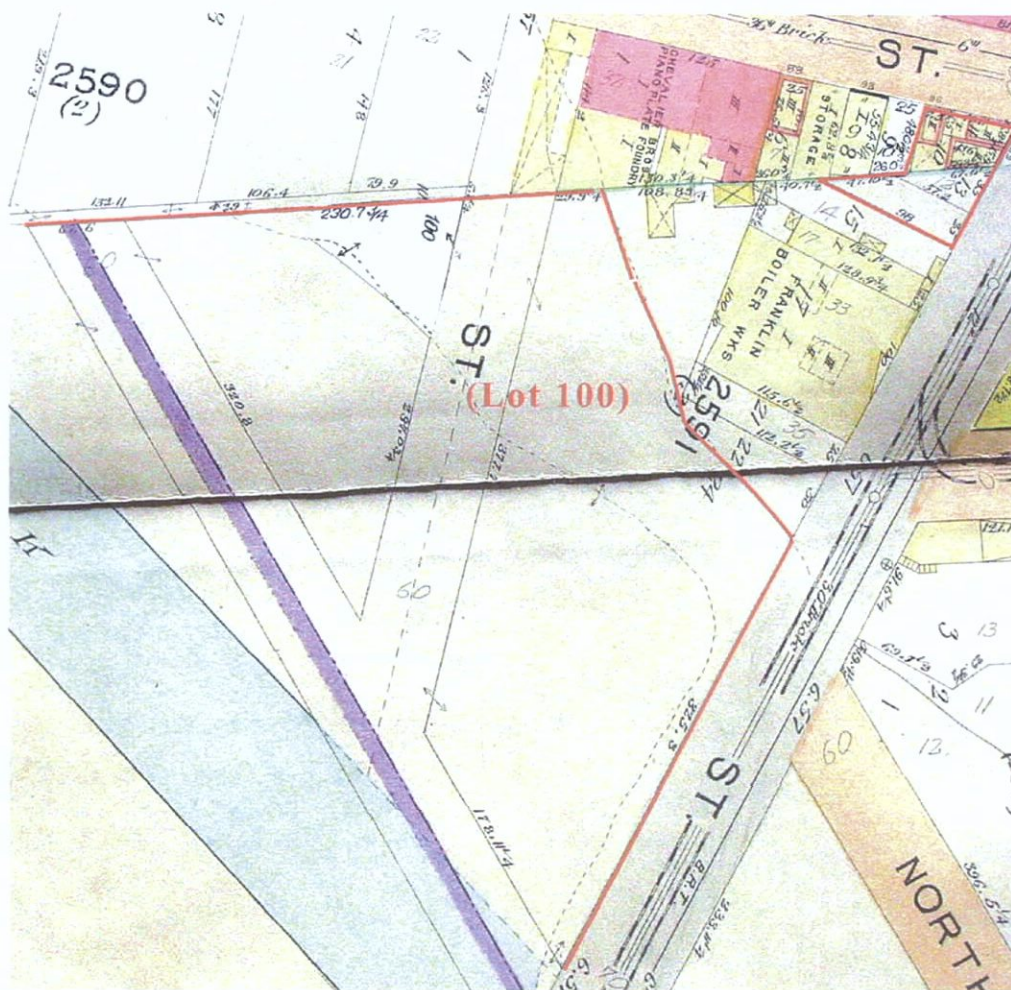
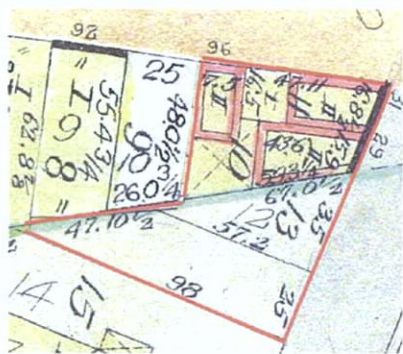

SITE 93 (above) and SITE 103 (below) - BLOCK 2724



SITE 93 (lots 31, 30) - Block 2724

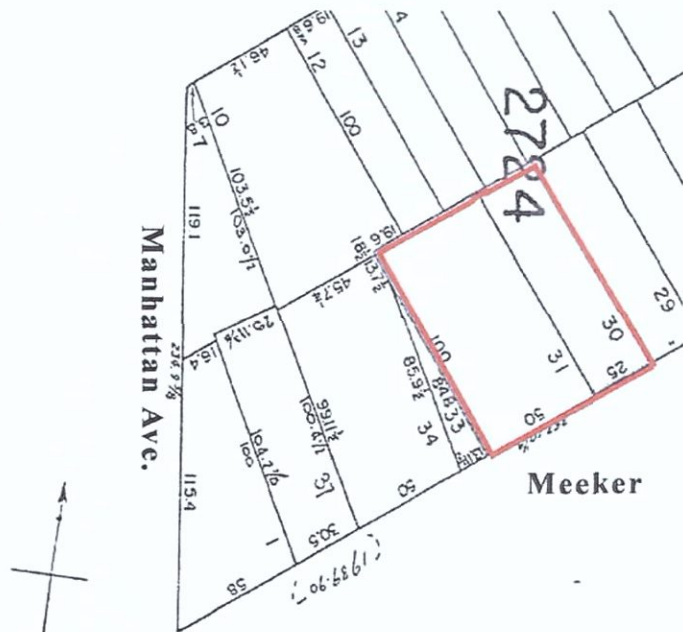

SITE 93 (lots 31, 30) - BLOCK 2724
1868 Higginson map (above)
1912 Hyde map (below)

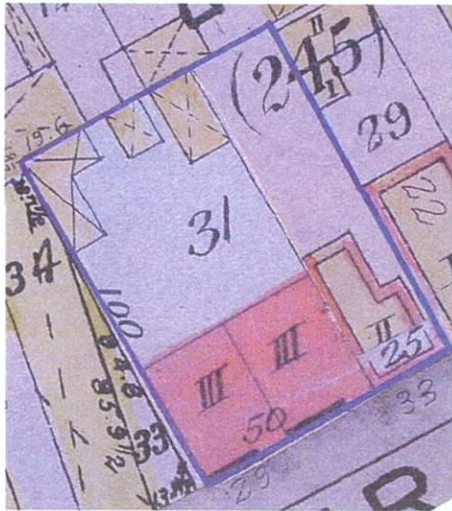
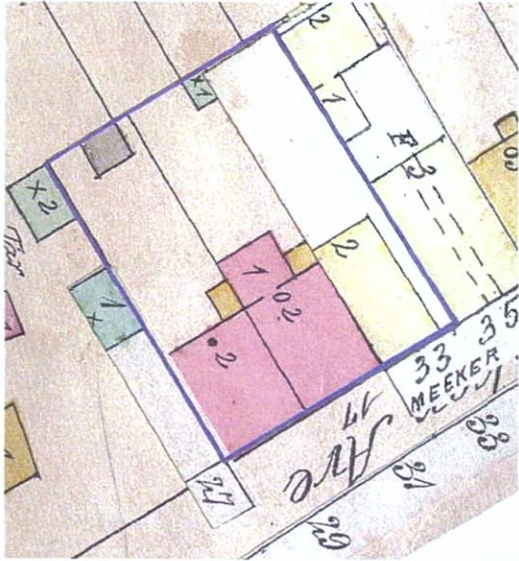

SITE 103 (lot 11) - Block 2292

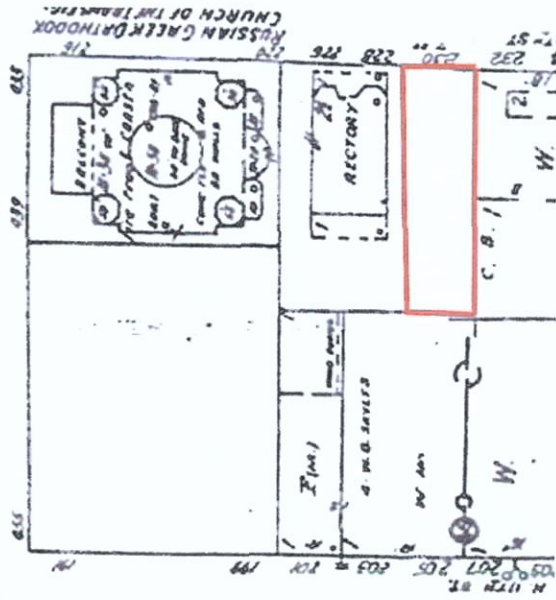
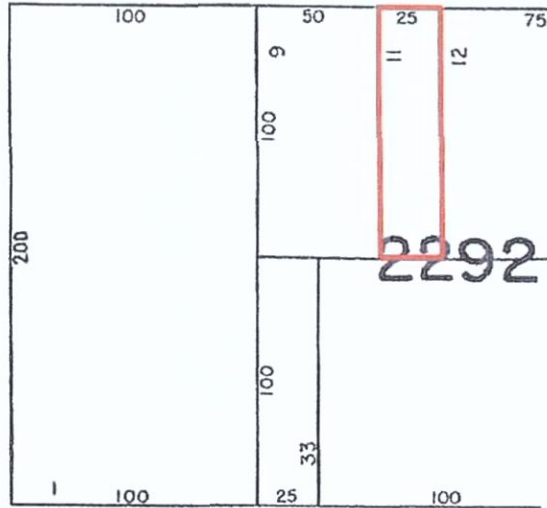

SITE 103 (lot 11) - BLOCK 2292
1868 Higginson map (top)
1929 Hyde map (bottom)

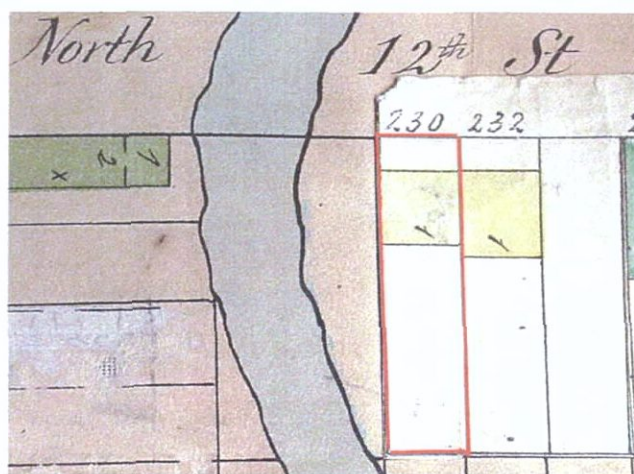

SITE 106 - BLOCK 2722



SITE 106 (lot 106) - Block 2722
Bayard Street

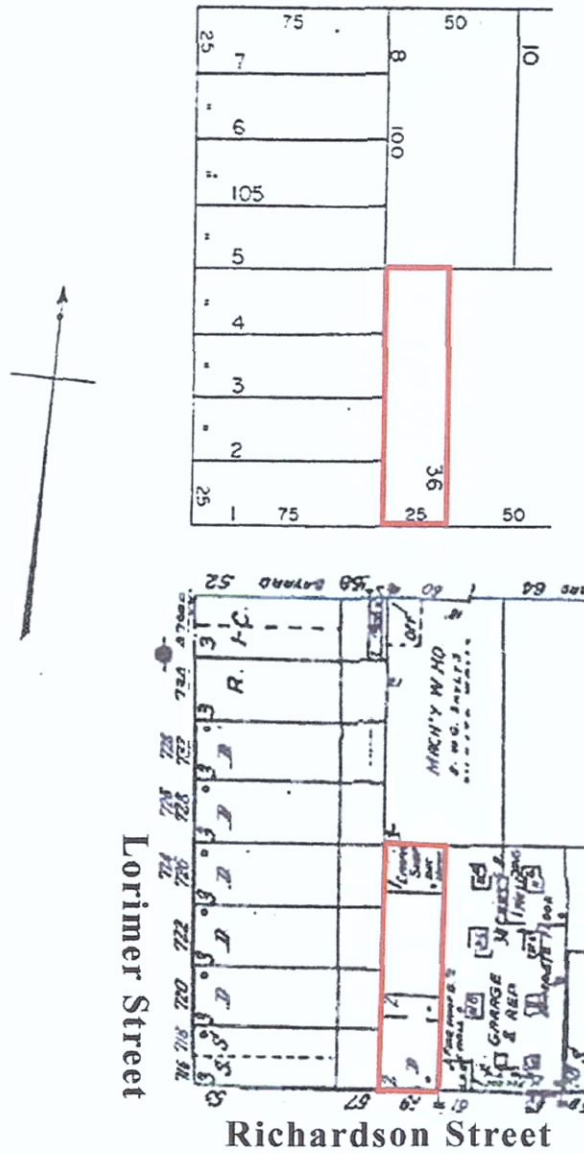

SITES 131 (above) and 132 (below) - BLOCK 2731

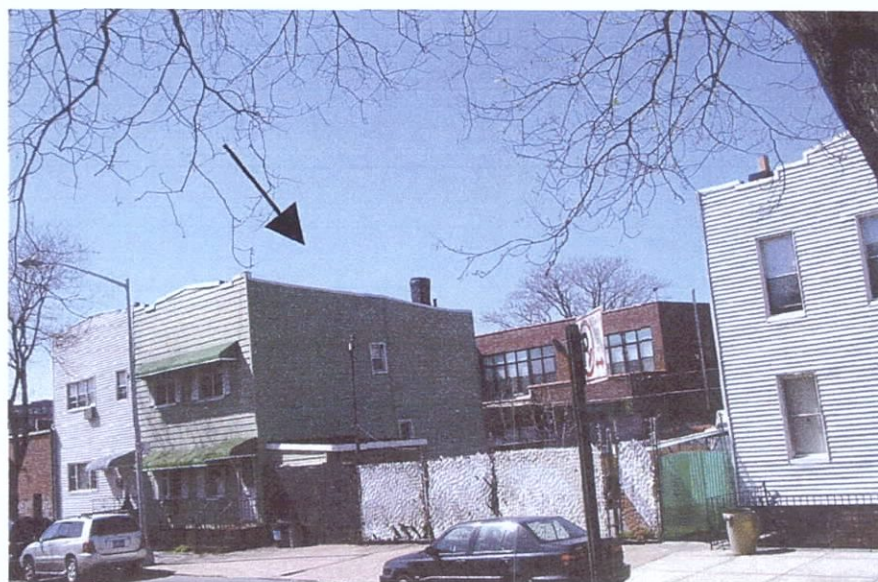

SITE 133 - BLOCK 2731



SITE 131 (lot 44), SITE 132 (lots 41, 38), SITE 133 (lots 35, 36)
Block 2731

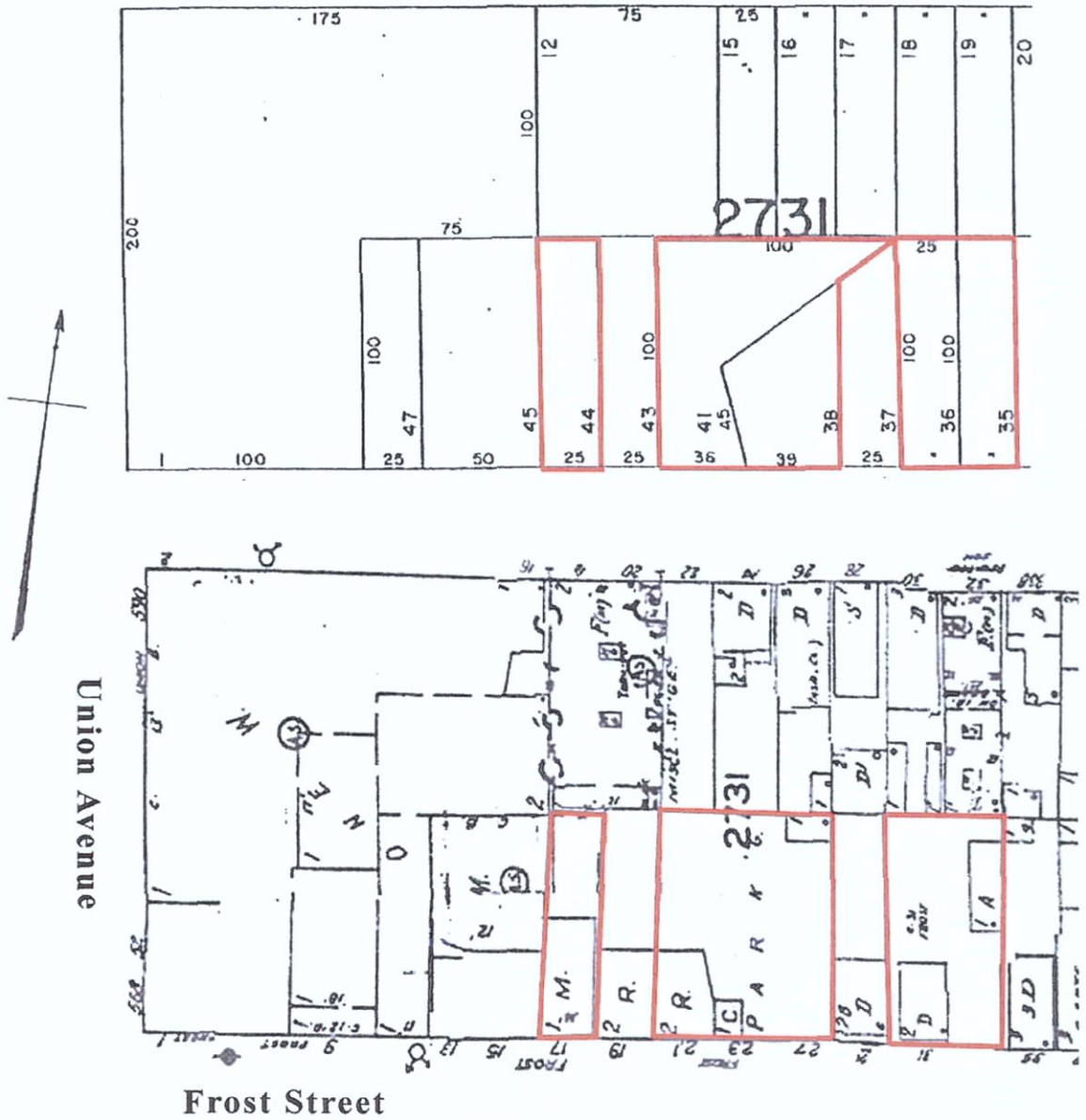

SITES 131, 132 and 133 - BLOCK 2731
1868 Higginson map (above)
1912 Hyde map (below)

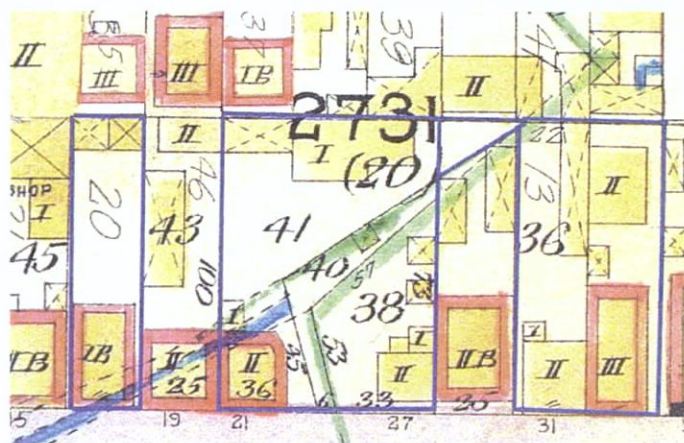

SITE 134 - BLOCK 2732



SITE 134 (lot 33) - BLOCK 2732
1912 Hyde map (above)
1951 Sanborn map (below)

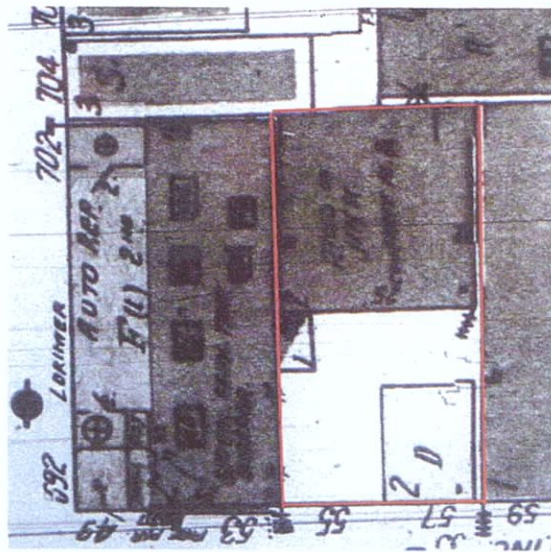
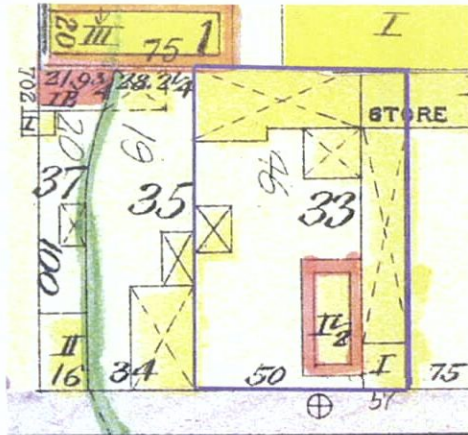

SITE 137 - BLOCK 2733
from Leonard Street (above), and from Meeker Avenue (below)



SITE 137 (lot 6) - Block 2733

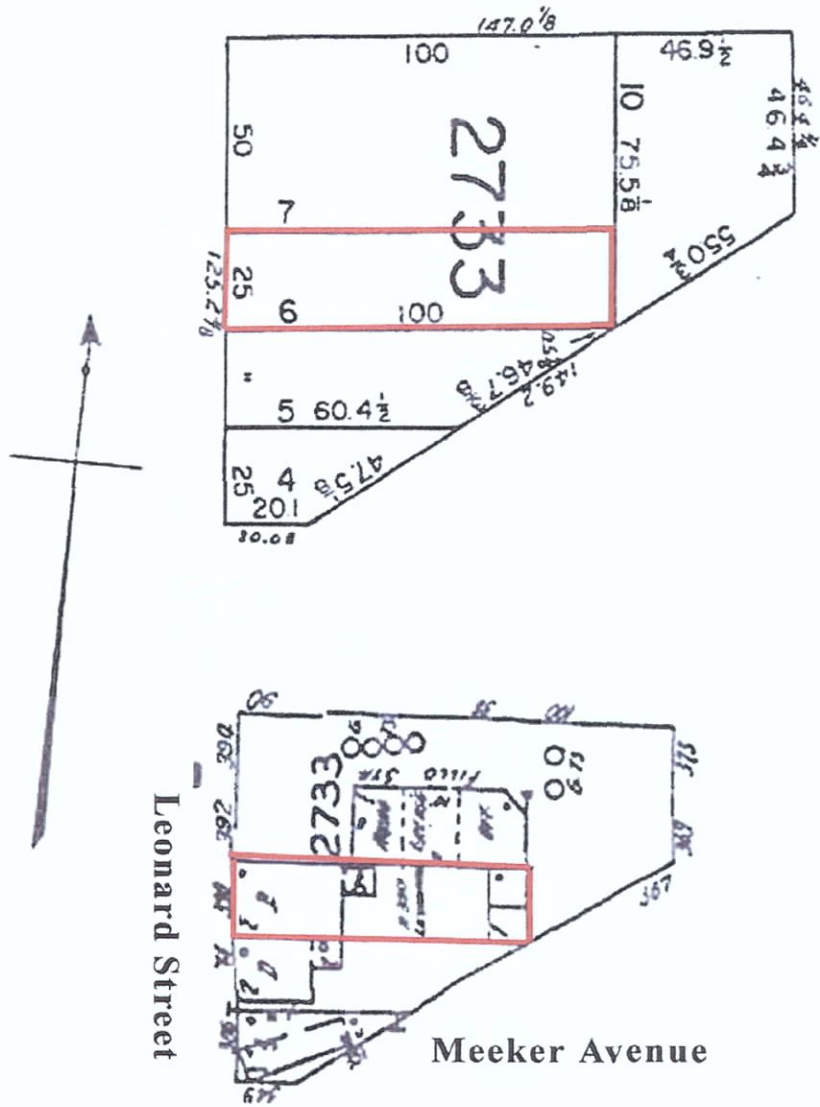

SITE 137 - BLOCK 2733
 1868 Higginson map (above)
 1912 Hyde map (below)

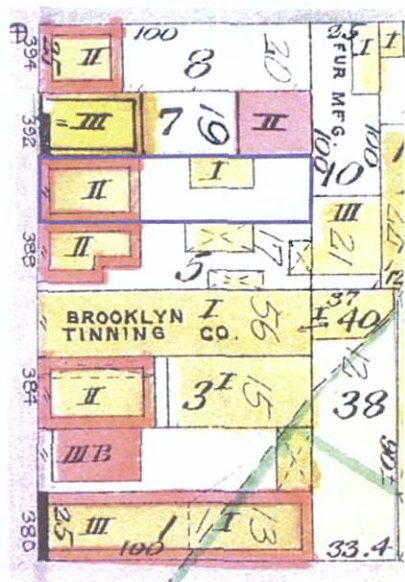
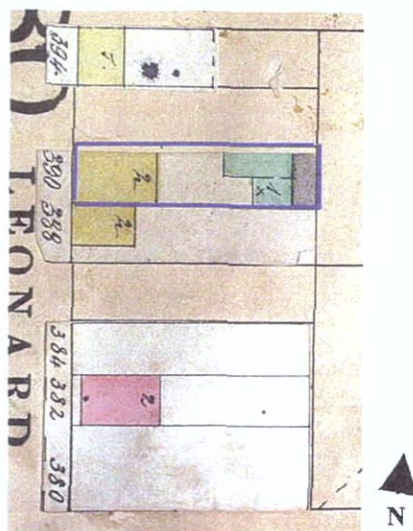

SITE 138 (above) and SITE 139 (below) - BLOCK 2734



SITE 138 (lot 3), SITE 139 (lot 13)
Block 2734

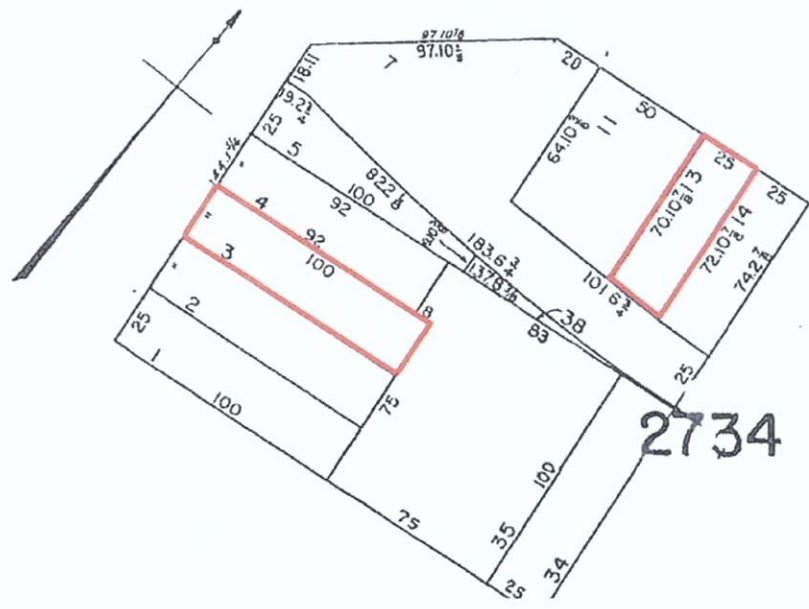

2734

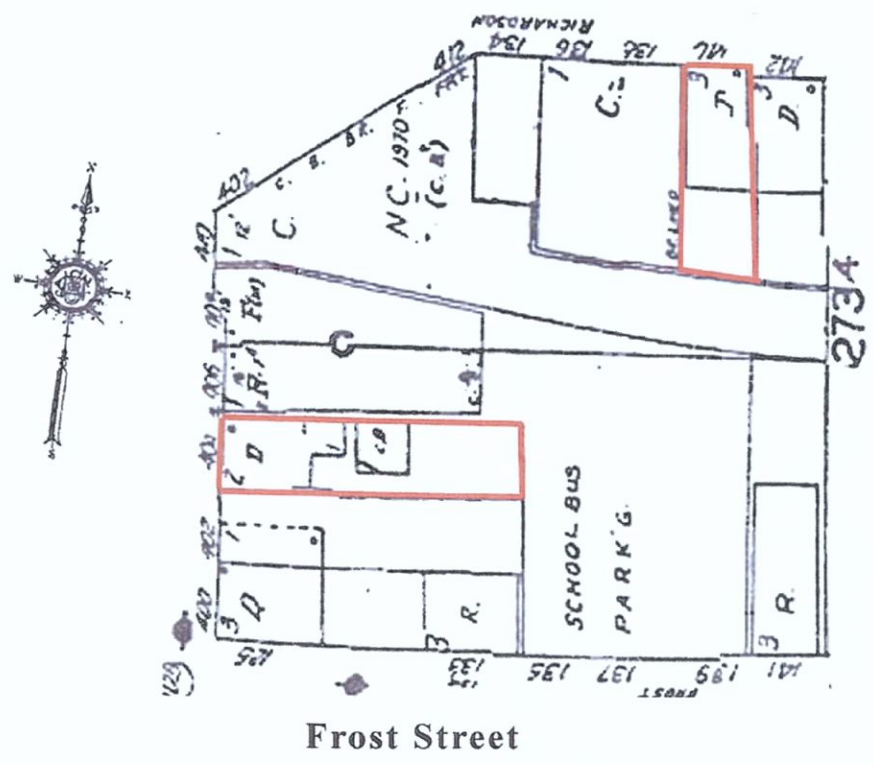

Frost Street

SITES 138 and 139 - BLOCK 2734
1898 Hyde map

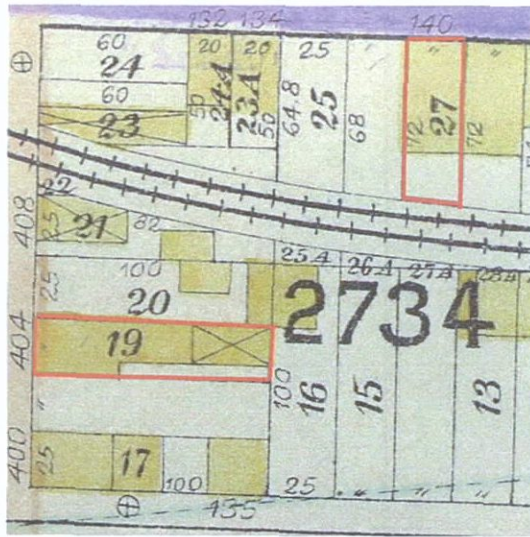

SITE 141 - BLOCK 2304



SITE 141 (lots 36, 37) - Block 2304

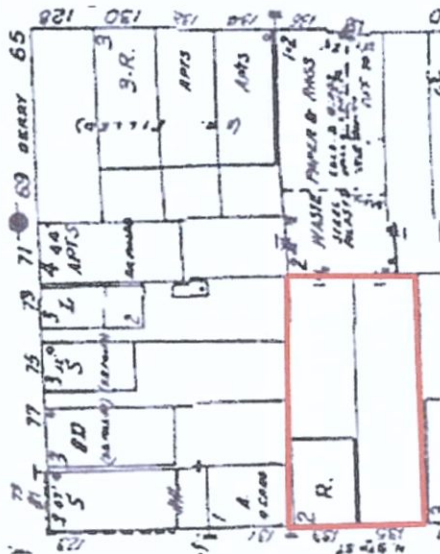
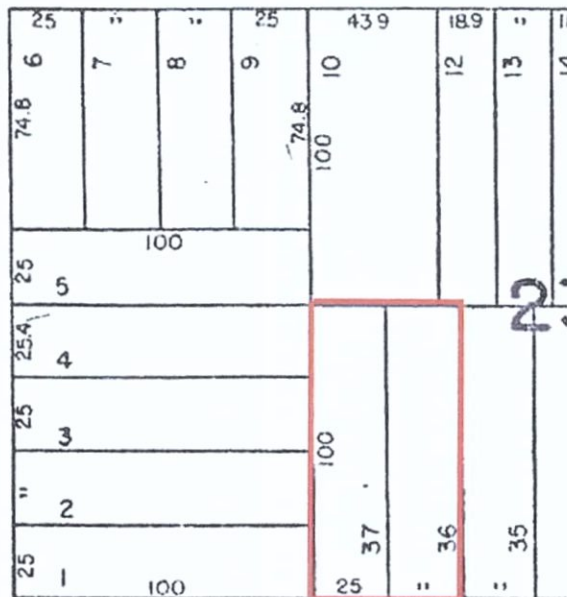

SITES 144 (above) and 145 (below) - BLOCK 2305



SITE 144 (lots 15, 16, 17) and SITE 145 (lot 18)
Block 2305

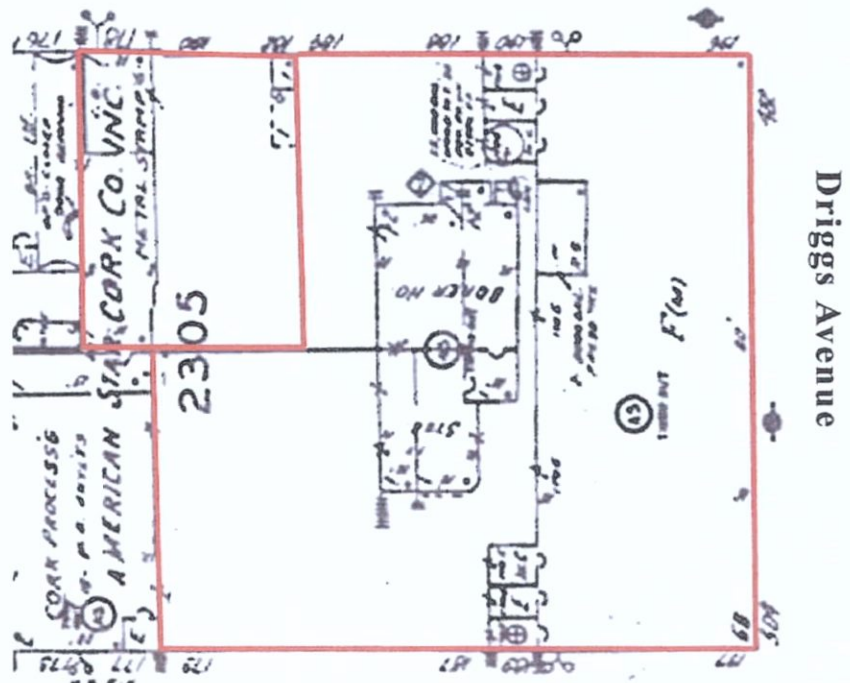
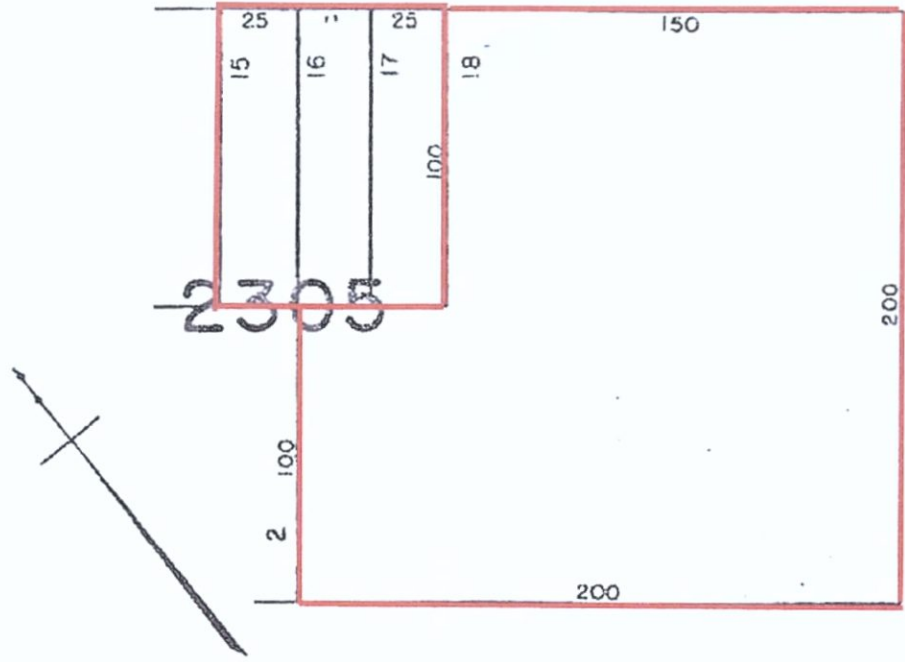

North 9th Street

Driggs Avenue

SITES 144 and 145 - BLOCK 2305

1868 Higginson map (top)

1898 Hyde map (middle)

1912 Hyde map (bottom)

1929 Hyde map (right)

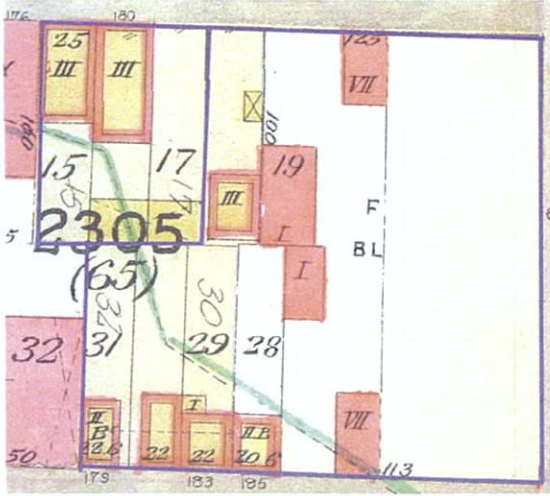
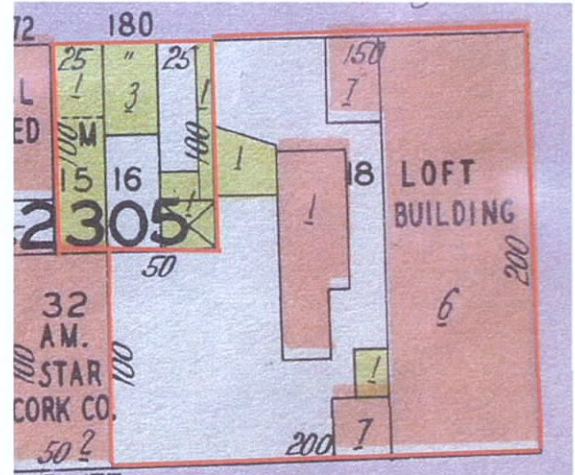
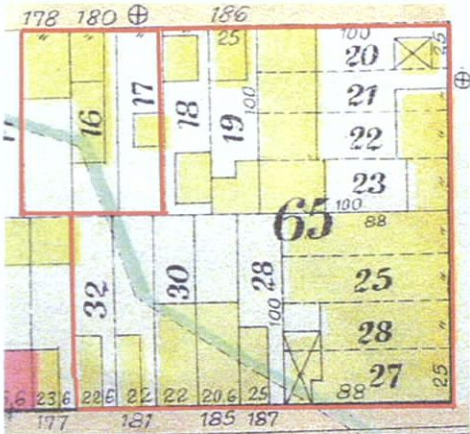
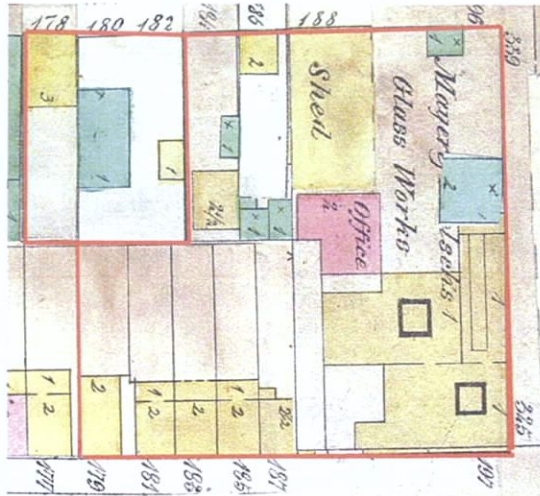

SITES 149 (above) and 152 (below) - BLOCK 2307



SITE 149 (lot 31) and SITE 152 (lot 25)
Block 2307

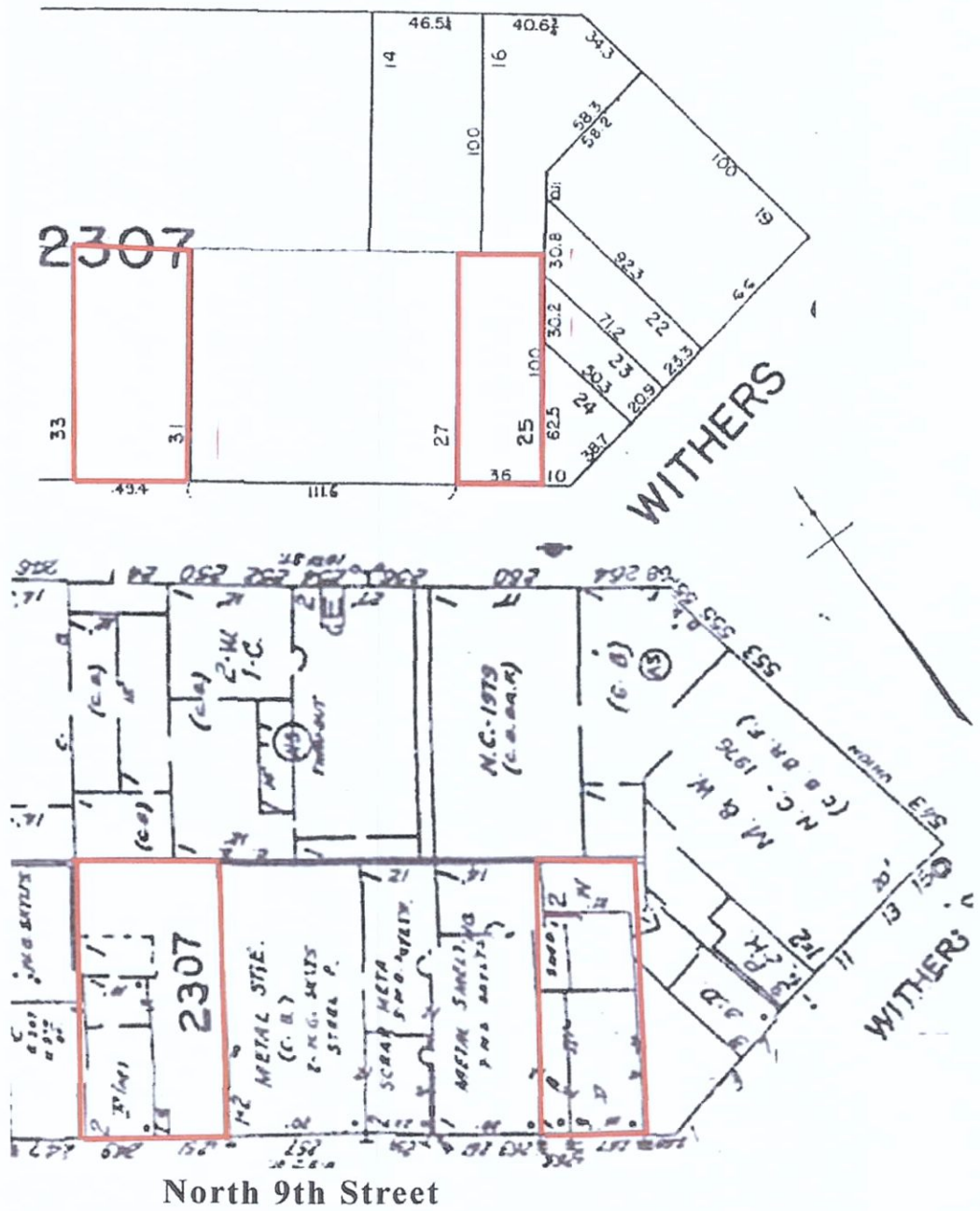

SITES 149 and 152 - BLOCK 2307
1868 Higginson map (top)
1898 Hyde map (middle)
1912 Hyde (bottom)

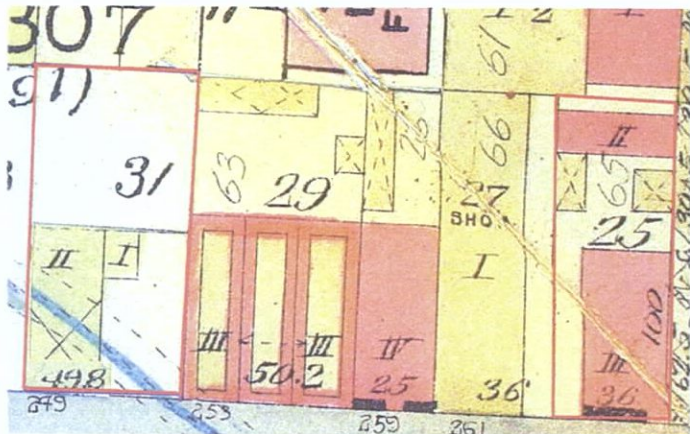
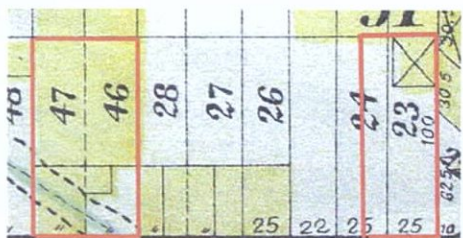
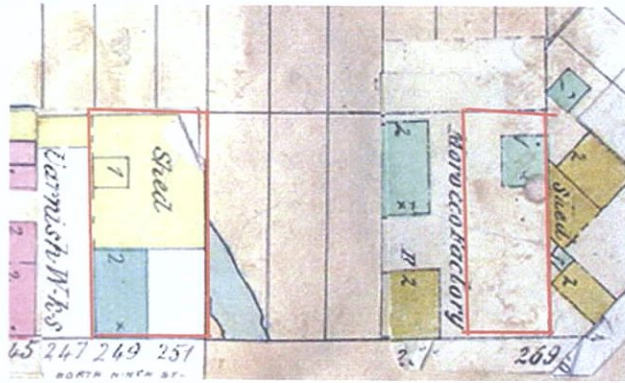

SITE 159 - BLOCK 2738 (above), and
SITE 162 - BLOCK 2310 (below)



SITE 159 (lot 24) - Block 2738

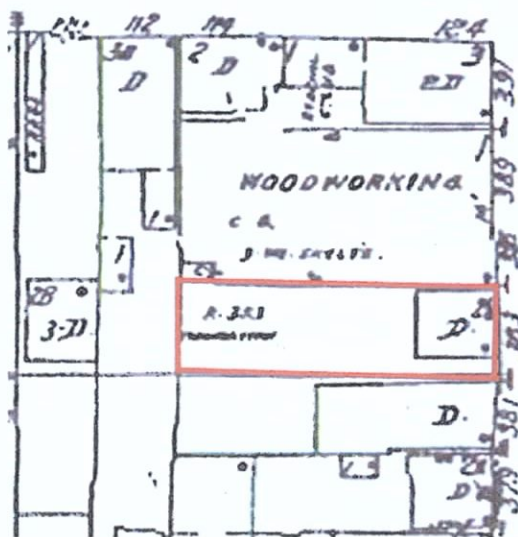
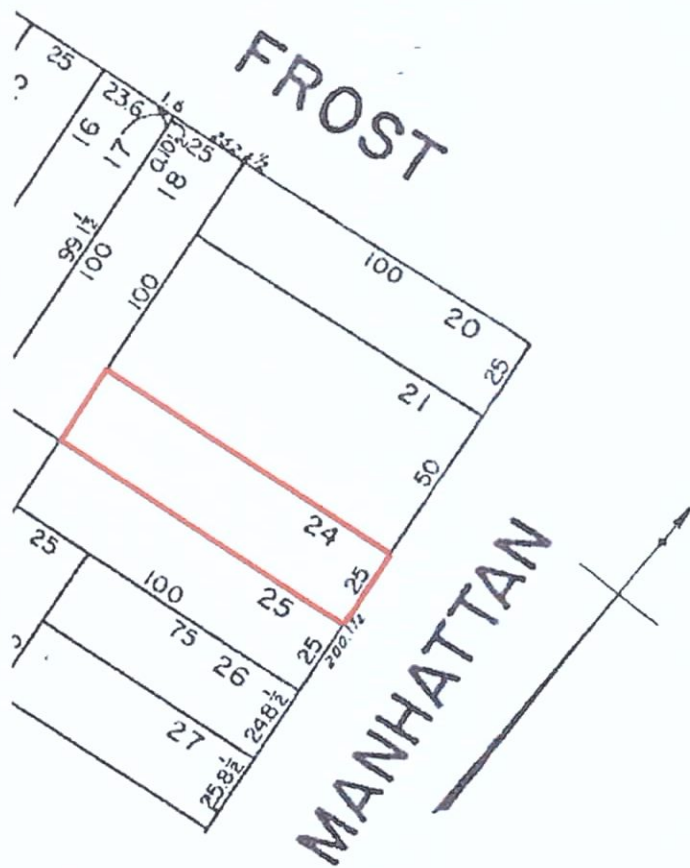

SITE 159 - BLOCK 2738
1868 Higginson map (above)
1898 Hyde map (below)

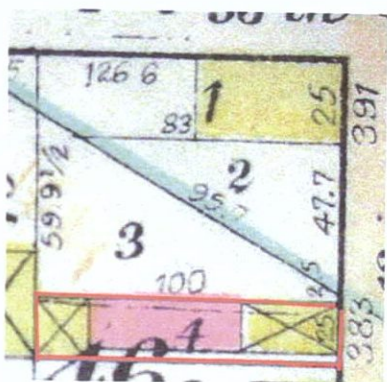
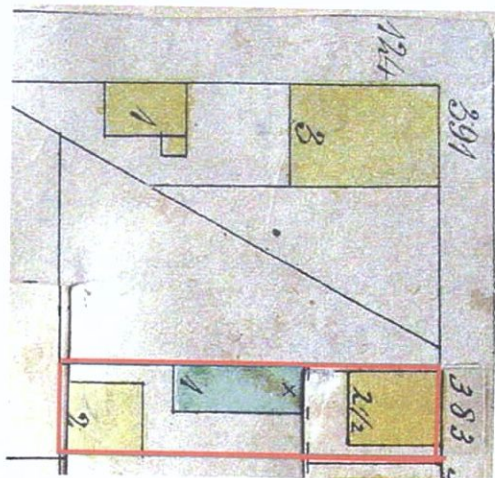

SITE 162 (lots 9, 10, 11)
Block 2310

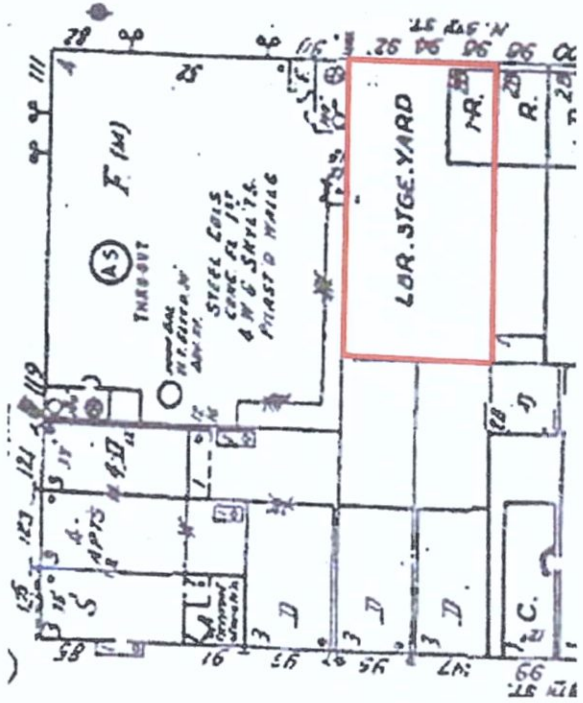
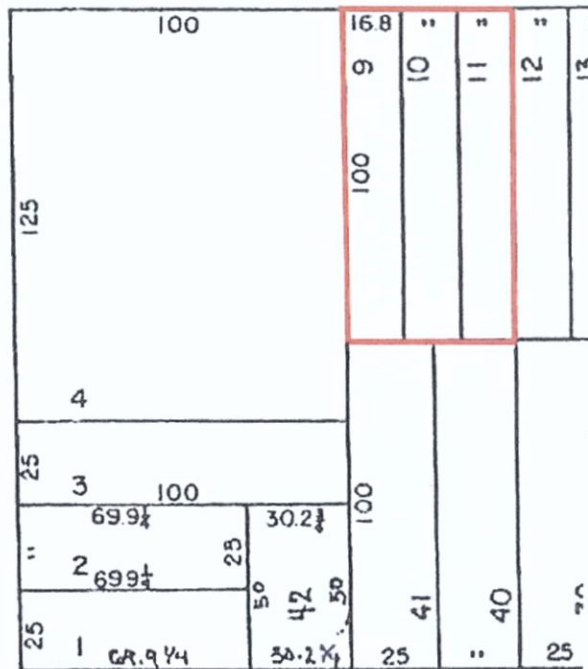

SITE 162 - BLOCK 2310
1868 Higginson map

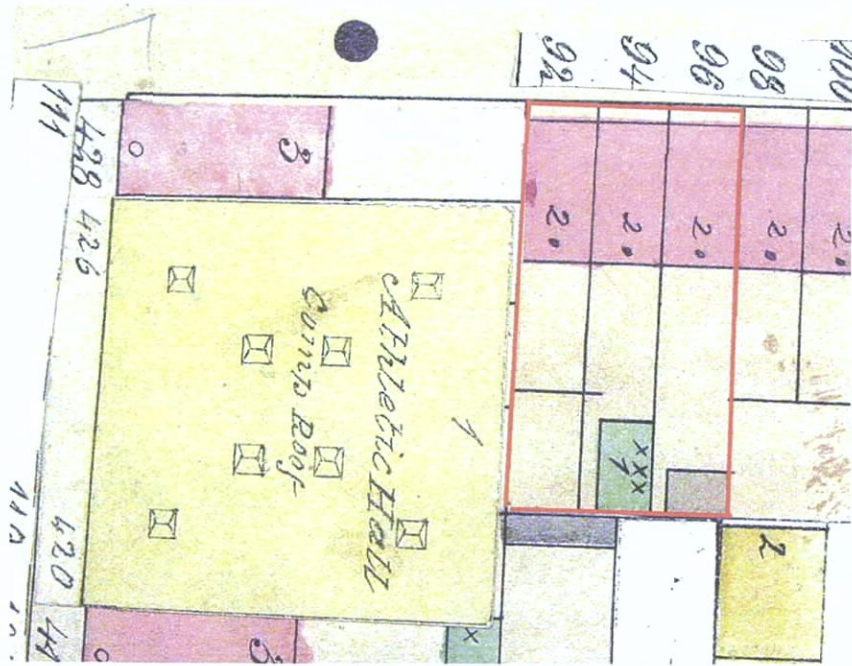

SITES 166 (above) and 169 (below) - BLOCK 2313



SITE 166 (lot 22) and SITE 169 (lot 28)
Block 2313

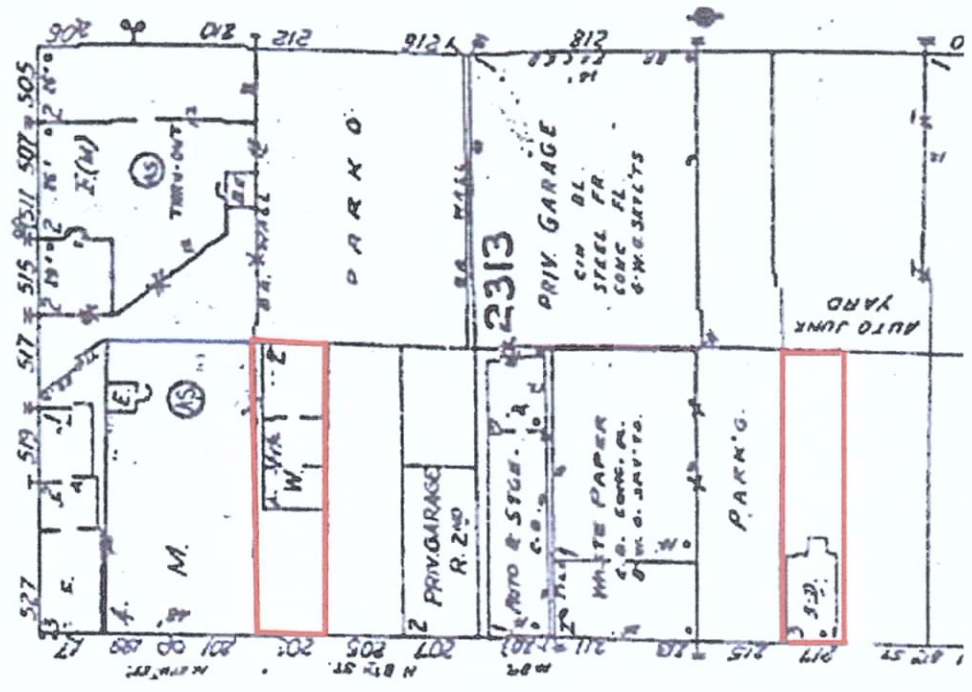
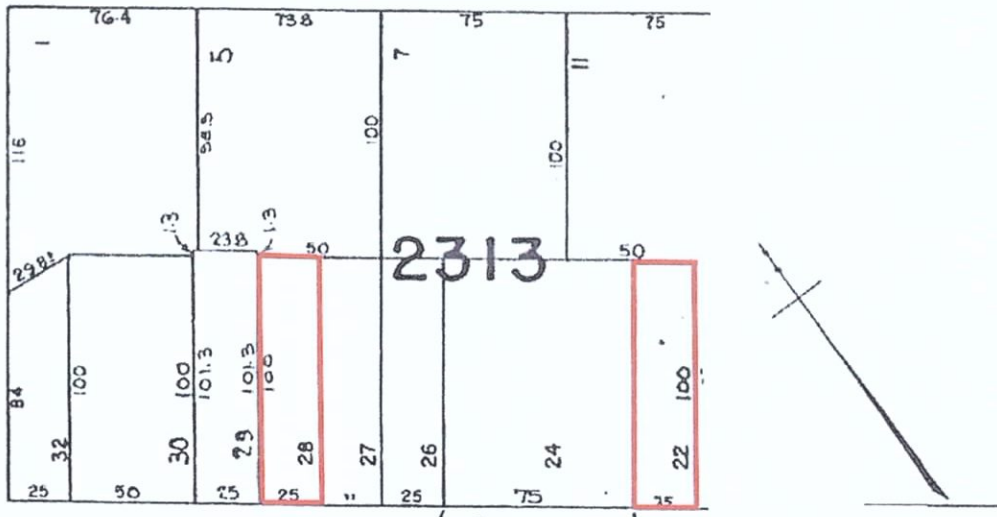

SITES 166 and 169 - BLOCK 2313

1868 Higginson map (above)

1912 Hyde map (below)

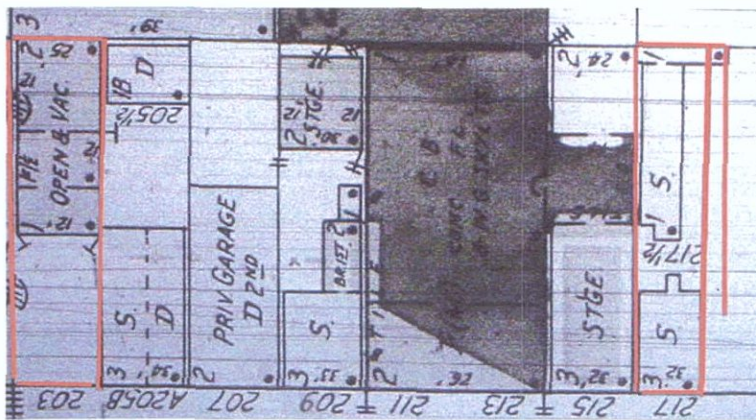
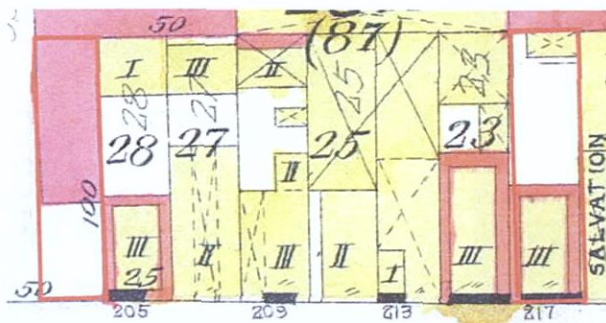
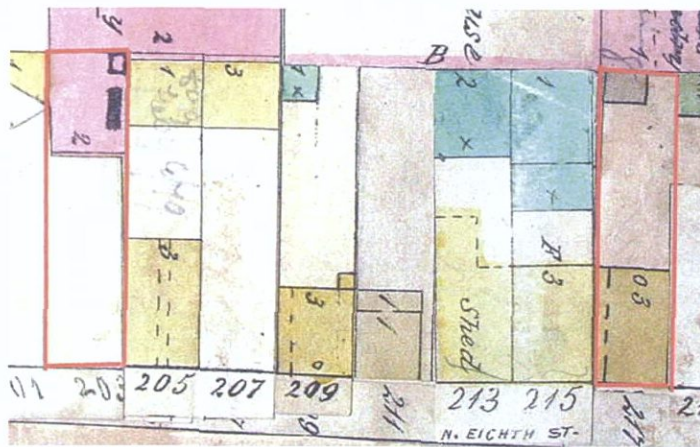

SITE 174 - BLOCK 2741



SITES 176 - BLOCK 2741
view from Skillman Street (above) and
view from Meeker Avenue (below)



SITE 174 (lot 8) and SITE 176 (lot 13)
Block 2741

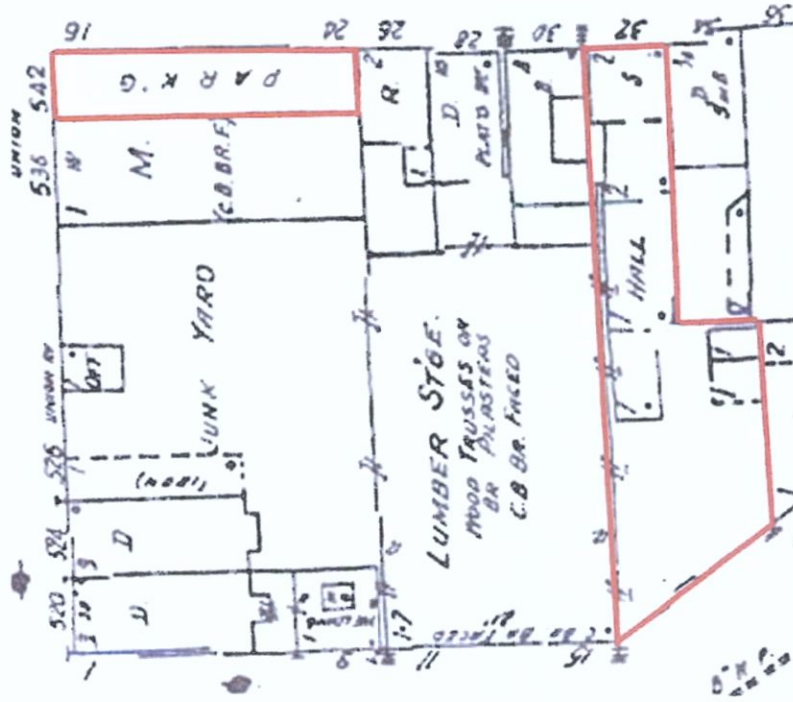
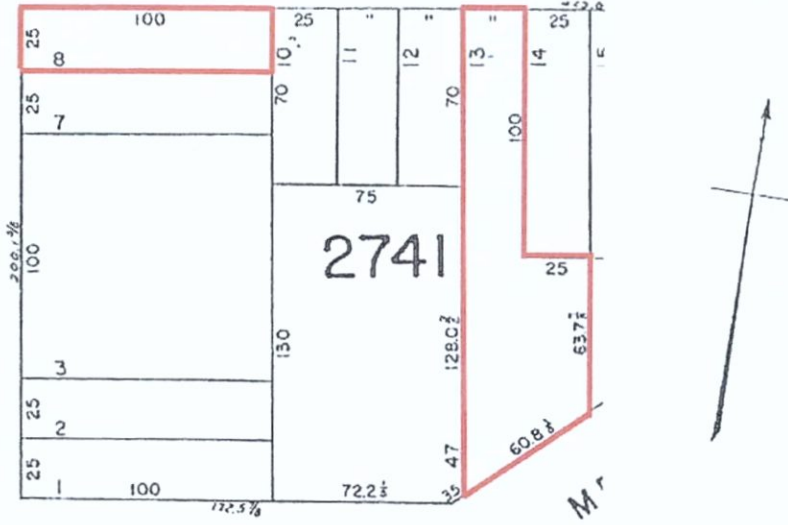

SITES 174 and 176 - BLOCK 2741
 1868 Higginson map (top)
 1912 Hyde map (middle)
 1929 Hyde map (bottom)

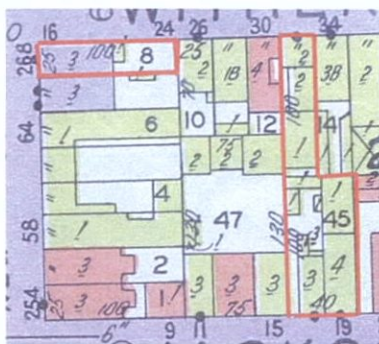
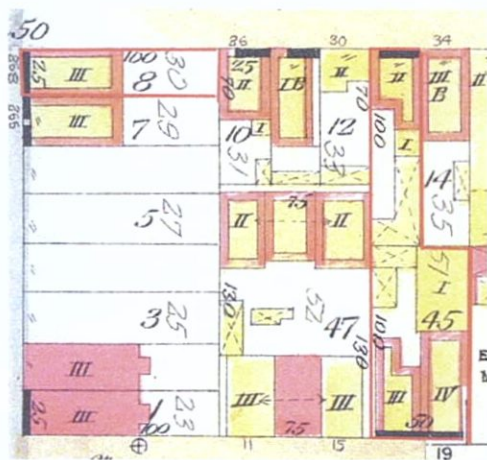

SITES 183 and 184 - BLOCK 2741
view from Skillman Street (above) and
view from Meeker Avenue (below)



SITE 183 (lots 41, 40) and SITE 184 (lot 39)
Block 2746

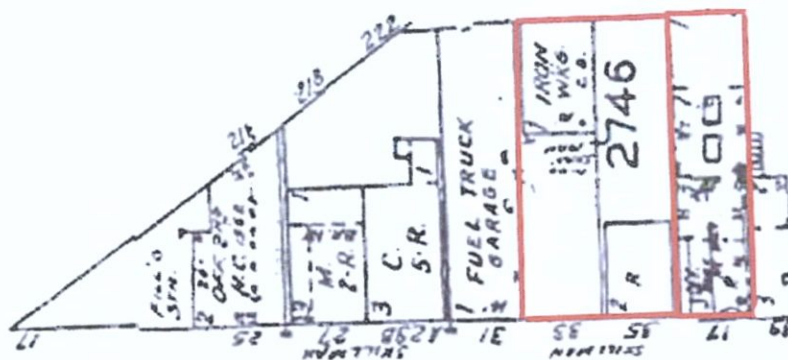
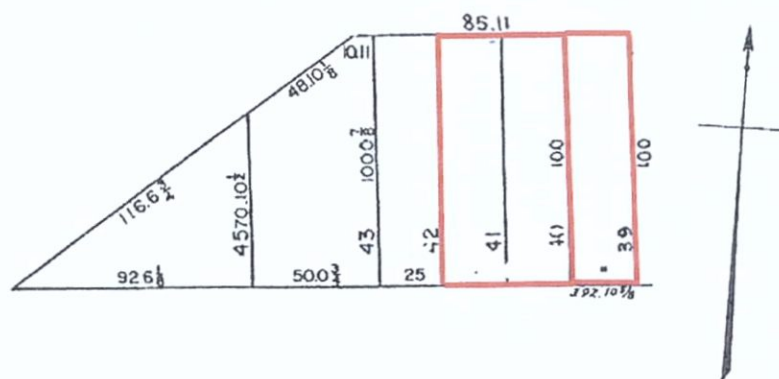

SITES 183 and 184 - BLOCK 2746
1868 Higginson map (above)
1912 Hyde map (below)
1929 Hyde map (bottom right)

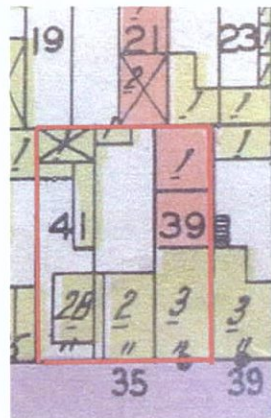
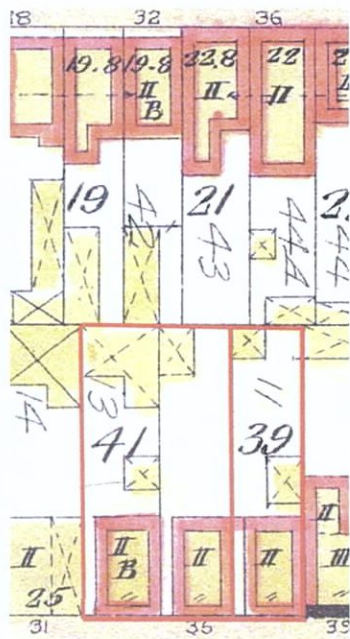
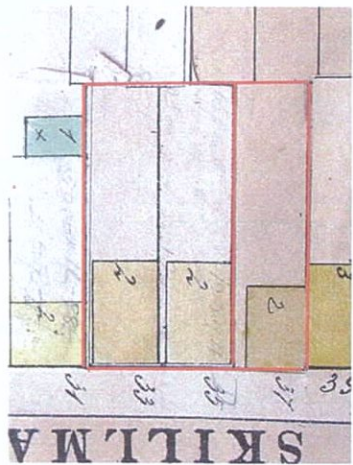

SITES 185 (above) and 186 (below) - BLOCK 2317



SITE 187 - BLOCK 2317 (above)
SITE 192 - BLOCK 2321 (below)



SITE 185 (lots 5, 6, 7, 8), SITE 186 (lots 12, 13)
and SITE 187 (lots 16, 17)
Block 2317

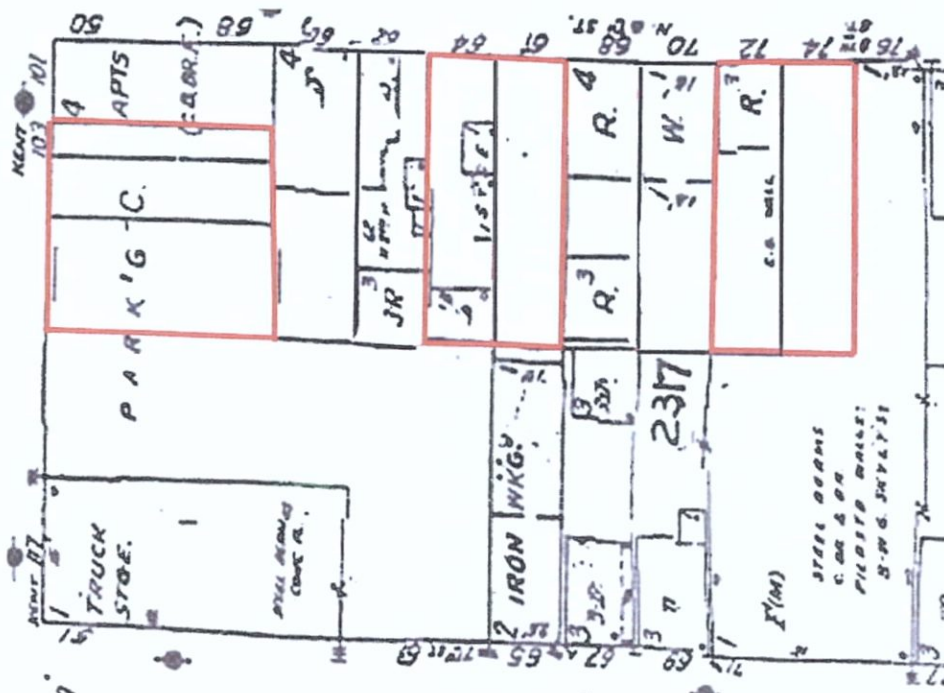
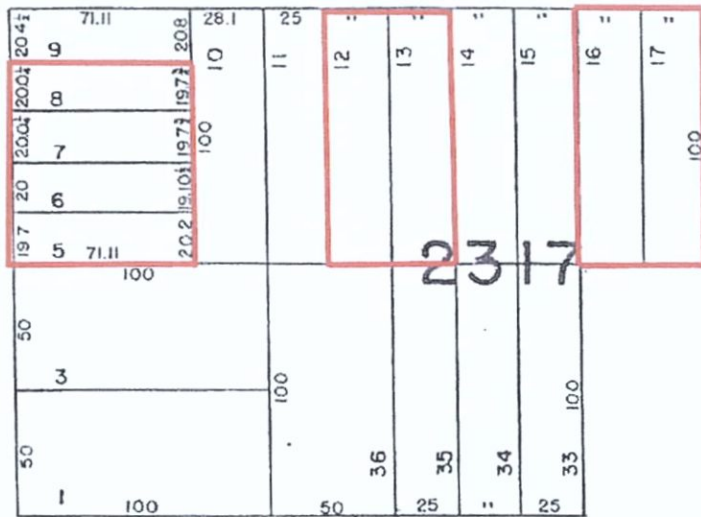

SITES 185, 186 and 187 - BLOCK 2317
1868 Higginson map (above)
1951 Sanborn map (below)

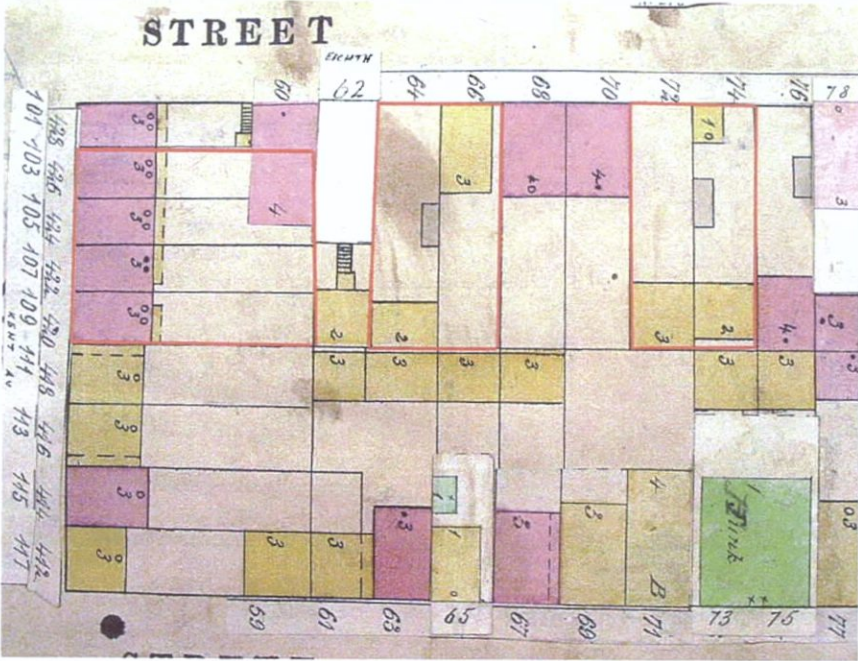

SITE 192 - BLOCK 2321
1912 Hyde map

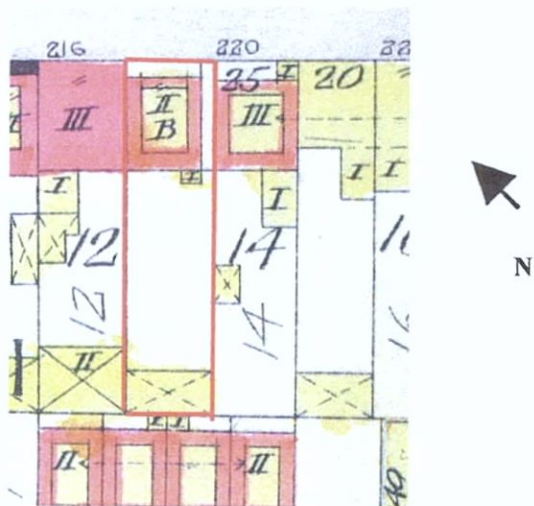

SITE 198 - BLOCK 2323



SITE 198 - BLOCK 2323

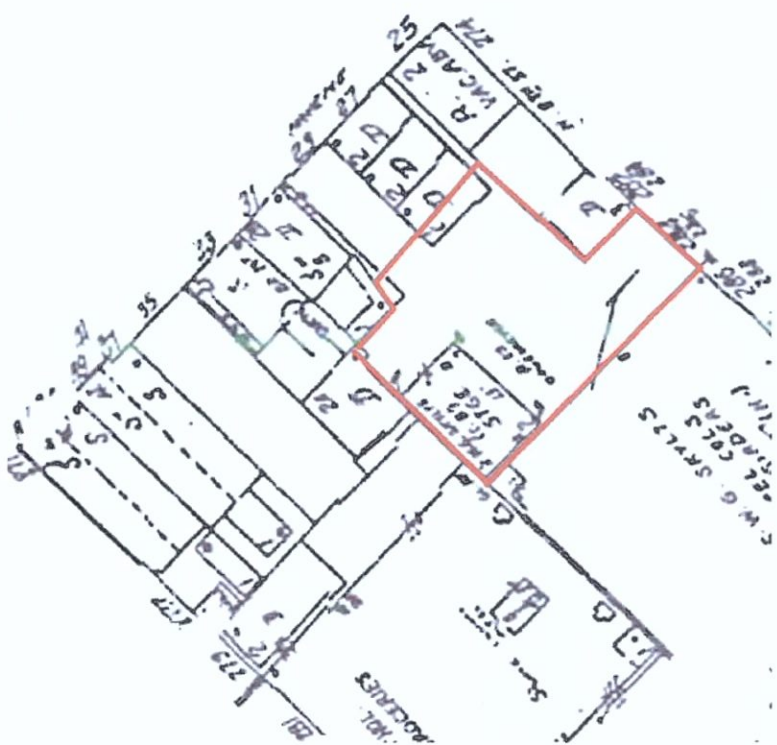
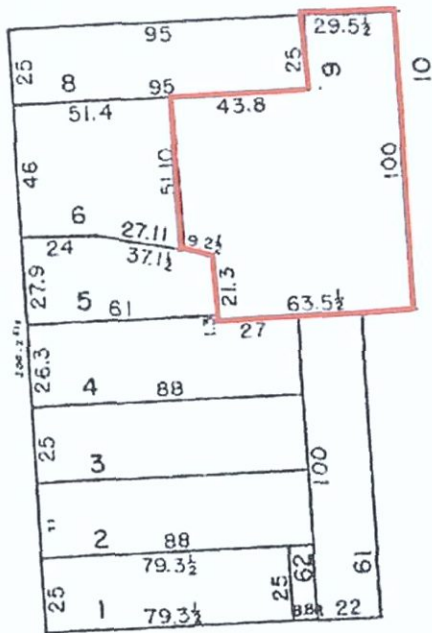

SITE 198 - BLOCK 2323
1929 Sanborn

