

March 7, 1997

Chris Nolan
Central Park Conservancy
#1 East 104th Street, 2nd Floor
New York, NY 10029

DRAFT

Re: Seneca Village, Central Park, New York
Archaeological Testing in Advance of Landscaping and Drainage Improvements
Letter Report

Dear Mr. Nolan:

Please accept the following as a report on the results of our firm's recent archaeological explorations in the Seneca Village vicinity of Central Park in advance of the Conservancy's planned drainage and irrigation improvements in an area roughly bounded by the West Drive, the 86th Street Transverse, the western edge of the former reservoir (now the Pinetum) and 83rd Street.

Archaeological field investigations involved the excavation of 36 shovel tests along the lines of proposed drainage and irrigation improvements where construction-related ground disturbance in excess of six to 12 inches is anticipated (Figure 1). Although originally proposed as part of the archaeological testing program, testing was not undertaken in the area of planned gutter improvements as construction of the existing gutters in these areas has previously disturbed the ground to a depth reaching or exceeding that of the intended improvement actions. Similarly, testing was not carried out north of the 86th Street Transverse area, which, based on visual examination of the ground surface, can be seen as having been extensively cut and filled.

Each test was excavated into culturally sterile soils to a depth where cultural materials were no longer (and would not be expected to be) present. Soil stratigraphy was recorded on pre-printed standardized forms and the beginning elevation of each test was related to mean sea level. All soils, except for concrete debris and obviously modern deposits, were screened through 1/4-inch hardware mesh. All shovel tests were backfilled to existing grade.

Shovel tests 1 through 5 were located along a proposed water line at the intersection of two footpaths. This area corresponds approximately to where the intersection of 7th Avenue and 84th Street would have been located prior to construction of the Park. In all five tests, fill extended to depths ranging from 2.30 feet to 3.50 feet. Bedrock was encountered directly beneath the fill. Mid-19th century artifacts, such as sherds of whiteware and vessel glass, were recovered from the fill in all five shovel tests. The fill material is considered to have been laid down in this area at the time of the Park construction in the mid- to late 1850s.

Shovel tests 6 through 16 were located within the area of the Pinetum. Shovel tests 6-11 were excavated along a proposed water line that will follow the western perimeter of the Pinetum. In these tests, mid-19th-century fill was encountered and ranged in depth from 1.60 to 2.30 feet. The fill overlay an impenetrable layer of mica schist and probably represents a construction backfill deposit laid up against the west side of the Croton receiving reservoir that was constructed in the early 1840s in the area between 6th and 7th Avenues and 79th and 86th Streets. Shovel tests 12-16 were excavated along a proposed irrigation line that bisects the western portion of the Pinetum. In tests 12 and 13, mid-19th-century fill extending to an average depth of 1.90 feet was again found to overlie mica schist. Shovel test 14, however, at a depth of 1.80 feet, revealed a possible wall or spread of rubble consisting of mortar, schist and brick. Two additional shovel tests (ST 15 and 16) were excavated to clarify the width of this possible wall. Both tests again encountered the mortar and schist beneath the fill. Probing indicated the feature extended east for a distance of at least 50 feet. Notable artifacts recovered from the fill in this area include a squat square ink bottle made from a multi-piece mold and exhibiting raised lettering "CAW'S INK, NEW YORK" (Shovel Test 11, Context 2), and sherds of whiteware and vessel glass.

The wall-like feature found in Shovel Tests 14-16 and the subsequent probing appeared to have a level surface, suggesting it was deliberately laid and not just randomly distributed rubble. This material is interpreted as the remains of buttressing or an offset foundation for the reservoir. Based on the conclusion that the mica schist found in Shovel Tests 14-16 is part of the foundation construction for the reservoir, it is believed that the mica schist encountered in Shovel Tests 6-13 probably also represents a part of the footings for the west side of the Croton Receiving Reservoir. Alternatively, the schist in these latter tests may represent undisturbed bedrock, although in our opinion, this is less likely because tests further west did not encounter schist (see below, Shovel Test 36).

Shovel tests 17-19 were excavated along a proposed irrigation line on the south side of the 86th Street Transverse. In these tests, mid-19th-century Park-construction fill extended to a depth of 4.00 feet. Decomposed mica schist, probably weathered bedrock, was encountered directly beneath the fill. Characteristic mid-19th-century artifacts, such as sherds of ironstone and whiteware, were recovered from these tests.

Shovel tests 20-22 were located along a proposed drainage line along the south side of the 86th Street Transverse. Shovel test 20 contained fill to a depth of 4.00 feet overlying compact gravel. This area appears heavily disturbed by the construction of 86th Street. Shovel tests 21 and 22 contained fill to a depth of 2.40 feet. The fill directly overlaid silty clay subsoil. Mid- to late 19th-century cultural materials, such as sherds of pearlware, whiteware, ironstone and porcelain, along with flat and vessel glass, were recovered from these tests.

Shovel tests 23-31 were excavated along a proposed water line near the intersection of the bridle path and the alignment of 85th Street. In Shovel tests 23-25, fill was encountered to a depth of 2.50 feet. The fill overlaid clayey silt subsoil and bedrock. Shovel tests 26-29 exhibited fill to an average depth of 1.00 feet. The fill directly overlaid clayey silt subsoil. The shallow depth of subsoil in these shovel tests suggests this area may have been a natural knoll in the pre-Park landscape. Fill extended to an average depth of 3.10 feet in Shovel tests 30 and 31. Silty clay

subsoil was encountered directly beneath the fill. Early-to-mid 19th century artifacts were recovered from the fill in this area, possibly indicating some mixing of pre-Park, Seneca Village materials with the fill laid down at the time of the Park construction. These artifacts include sherds of creamware, pearlware, whiteware and stoneware, and fragments of flat and vessel glass.

Shovel tests 32-34 were located within the fenced-in construction yard compound. A concrete pad extends over the entire area. In these shovel tests, very compact silt, clay and schist fill extended to a depth of 1.50 feet. Impenetrable gravel and schist was encountered directly beneath the fill.

Additional shovel tests (ST 35 and 36) were excavated along an alternate alignment of the irrigation line originally proposed to traverse the Pinetum. Shovel test 35 contained fill to a depth of 2.30 feet. Very compact gravels were encountered directly beneath the fill in this area and may relate to a former road surface associated with a pre-Park alignment of 7th Avenue. In Shovel Test 36, fill extended to a depth of 1.60 feet and overlay clayey silt subsoil. No significant artifacts were recovered from these shovel tests. Mica schist was not encountered in ST 36, suggesting that the reservoir foundation material encountered in Shovel Tests 6-16 did not extend as far west at this location.

In summary, archaeological testing within the area defined by the West Drive, 86th Street, the reservoir and 83rd Street has found no evidence for intact remains reflecting domestic occupation of Seneca Village. Such deposits are presumed to have been mostly removed as a result of the creation of the Park. The extensive fill deposits that were encountered are therefore linked primarily to the construction of the Park in the mid- to late 1850s, and for the most part directly overlie schist bedrock or a clayey silt subsoil.

Towards the eastern end of the area investigated, in the vicinity of the Pinetum, substantial remains of what appear to be the mica schist footings for the west side of the Croton receiving reservoir were noted. The reservoir was constructed in the early 1840s and fill laid up against its western edge may therefore contain materials of a slightly earlier date than fill placed adjacent to the west at the time of the Park's construction. Such a fine distinction of some 15 years is not likely to be recognizable in the artifacts recovered.

It should be noted that slightly earlier artifacts, in the form of sherds of early 19th-century creamware and pearlware, were recovered from tests nearer to the western edge of the area under study. This suggests that occupation deposits associated with Seneca Village may have become partially mixed with Park-construction fill deposits. More important, they hint that the area to the west of the pathway that lies immediately east of the Bridle Path may still hold some potential for yielding intact remains of the Seneca Village settlement. This suspicion is strengthened by an examination of the Viele map of Central Park in 1856 (Figure 2) and a page from the "Greensward Plan" of 1857 (Figure 3), which show the same bedrock outcrops that exist today and imply a less intrusive modification of the pre-Park land surface. While no further archaeological testing is considered necessary in conjunction with the current phase of landscaping, drainage and irrigation work to the east of the West Drive, it is recommended that future ground disturbance further to the west be preceded by systematic exploratory testing.

Please feel free to contact either me or Michael Tomkins, if you have any questions about our conclusions.

Yours sincerely,



Richard W. Hunter
President

copy: Michael Tomkins

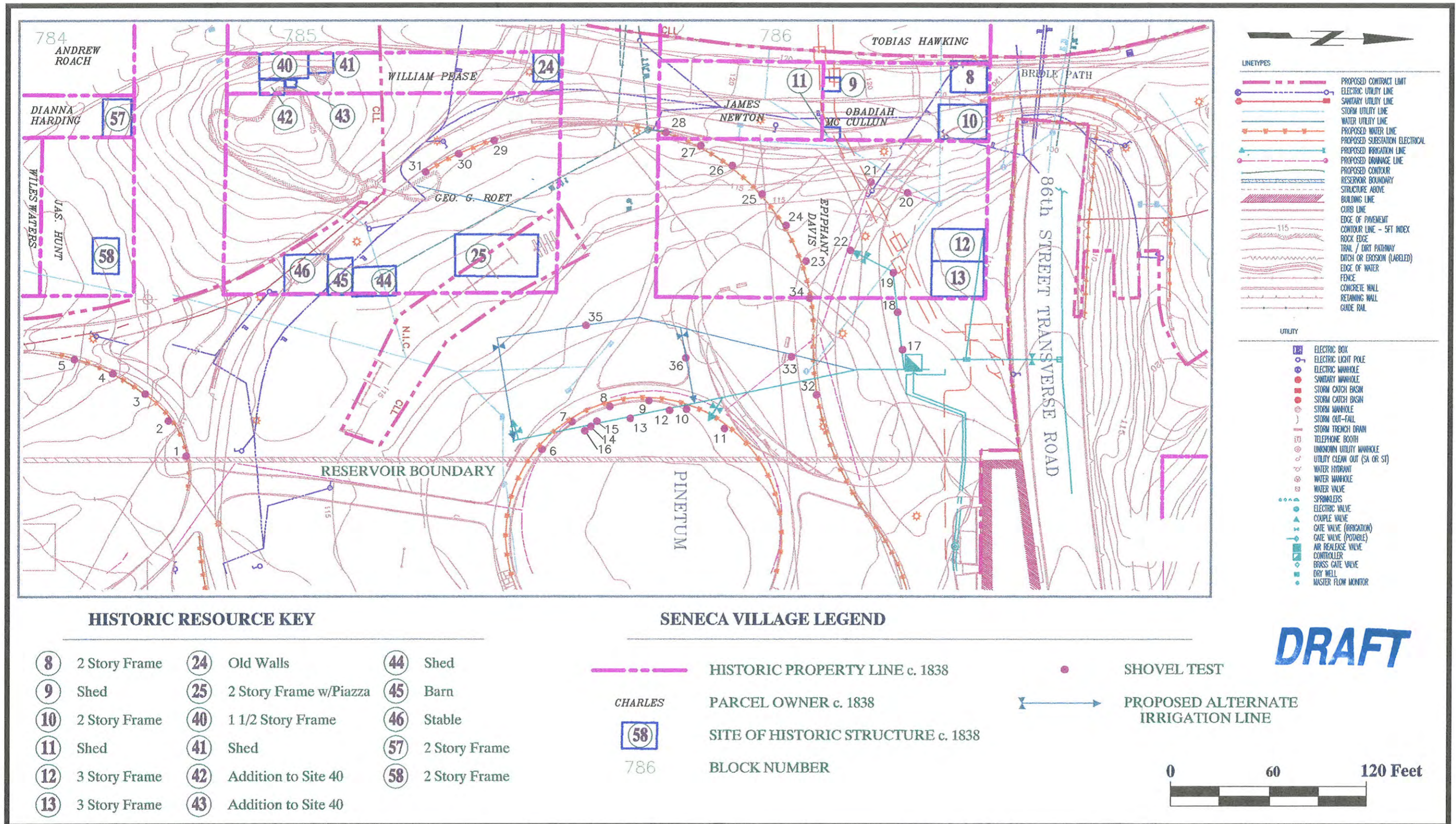

Figure 1. Project Plans Showing Location of Subsurface Tests and Historic Resources.

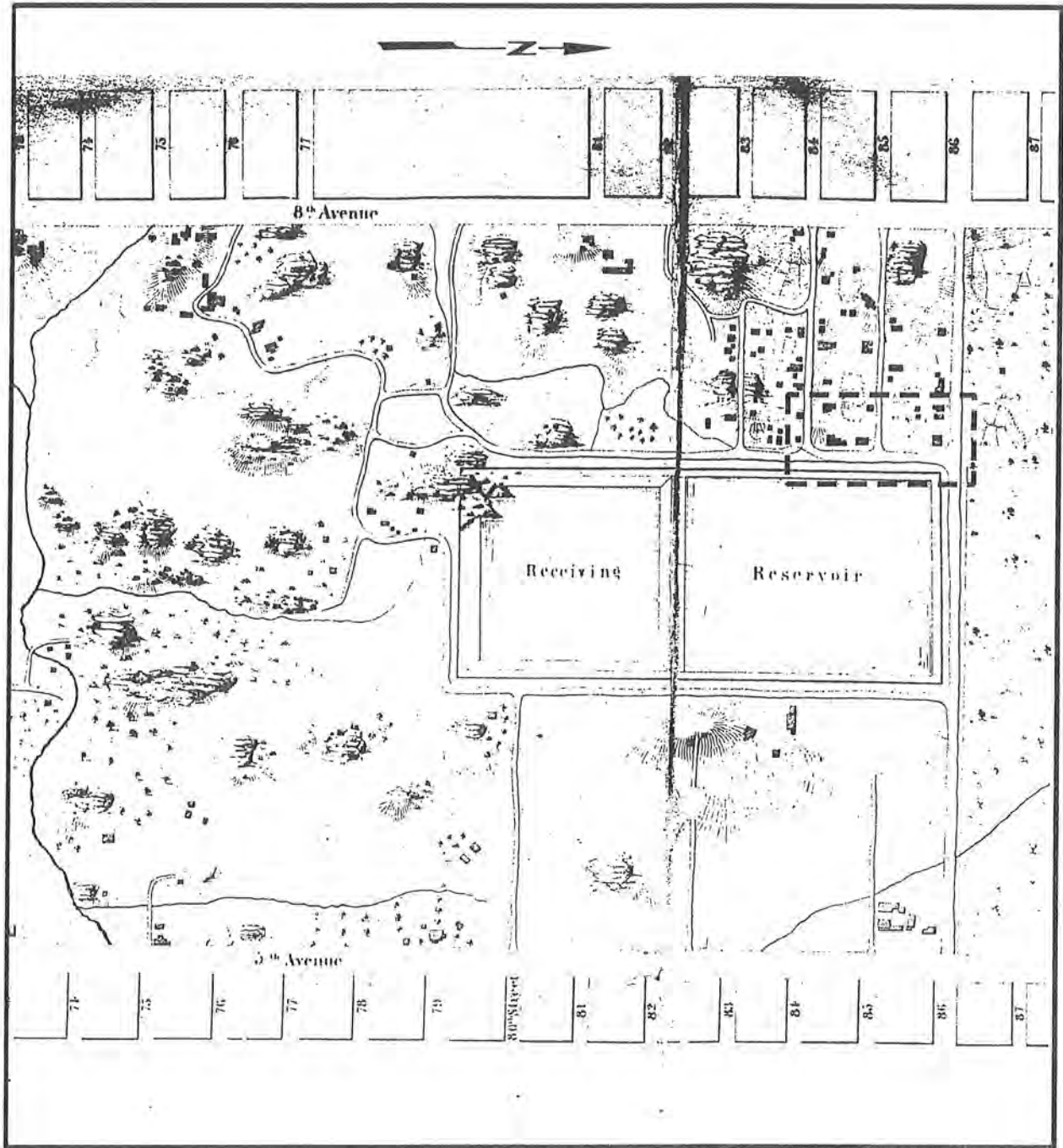

Figure 2. Viele, Egbert. Map of the Lands in The Central Park. 1856. Scale 1 inch: 650 feet (approximately). Study Area Outlined with Dashed Line.



Figure 3. Olmsted, F.L. and Calvert Vaux. Page from Greensward Plan of Central Park. Top: historic view looking southwest towards 72nd Street, standing just south of the old reservoir, about in line with 78th Street. 1857. Bottom: oil painting of same area showing proposed landscaping following construction of Central Park. Source: Kouwenhoven 1953:296.

APPENDIX A
SUMMARY OF SUBSURFACE TESTING

APPENDIX A

SUMMARY OF SUBSURFACE TESTING: SHOVEL TESTS

ST#	Surface Elevation ASL	Layer #	Depth From to	Soil Description	Munsell Color	Cultural Materials
1	114.91'	1	0.00-0.70'	silty loam	2.5Y 2.5/1	glass, metal, building materials*
		2	0.70-2.30'	silty loam with gravel	10YR 4/3	building materials*, historic ceramics, glass
			2.30'	rock impasse		
2	114.38'	1	0.00-0.70'	silty loam	2.5Y 2.5/1	glass, energy*
		2	0.70-2.30'	silty loam with gravel	7.5YR 4/4	glass, historic ceramics
			2.30'	rock impasse		
3	113.64'	1	0.00-0.40'	silty loam	2.5Y 2.5/1	-
		2	0.40-2.60'	silty loam with gravel	10YR 4/4	building materials*, energy*
			2.60'	rock impasse		
4	112.81'	1	0.00-0.60'	silty loam	2.5Y 2.5/1	glass, historic ceramics, energy*
		2	0.60-1.90'	silty loam	7.5YR 4/4	historic ceramics, metal
		3	1.90-3.50'	mottled silty loam/clayey	7.5YR 4/4 7.5YR 5/6	historic ceramics, glass, building materials*, metal
5	111.56'	1	0.00-0.30'	silty loam	2.5Y 2.5/1	-
		2	0.30-2.20'	silty loam with gravel	10YR 4/3	glass
		3	2.20-2.60'	silty loam	2.5Y 2.5/1	energy*
		4	2.60-3.60'	mottled silty with mica	10YR 4/4 10YR 5/4	-
6	113.67'	1	0.00-0.90'	silty loam	2.5Y 2.5/1	-
		2	0.90-2.30'	silt with decomposing schist	7.5YR 4/4	-
			2.30'	rock impasse		

APPENDIX A (Cont.)

SUMMARY OF SUBSURFACE TESTING: SHOVEL TESTS

ST#	Surface Elevation ASL	Layer #	Depth From to	Soil Description	Munsell Color	Cultural Materials
7	113.69'	1	0.00-0.60'	silty loam	2.5Y 2.5/1	-
		2	0.60-0.90'	mottled silty loam	7.5YR 4/4 7.5YR 5/8	-
		3	0.90-2.30'	silt with decomposing schist	7.5YR 4/4	building materials*, energy*, inorganic*
8	113.67'	1	0.00-1.00'	silty loam	2.5Y 2.5/1	-
		2	1.00-1.90'	silty loam	7.5YR 4/4	-
			1.90'	rock impasse		
9	113.71'	1	0.00-0.50'	silty loam	10YR 3/2	glass*, inorganic*
		2	0.50-1.60'	silty loam with decomposing schist	7.5YR 4/4	-
			1.60'	rock impasse		
10	113.76'	1	0.00-0.90'	silty loam	2.5Y 2.5/1	glass*, energy*
		2	0.90-2.00'	silty loam with micaceous schist	7.5YR 4/4	glass
		3	2.00-2.60'	mottled silty loam	10YR 3/3 2.5YR 6/4	-
		4	2.60-2.90'	clayey silt	7.5YR 5/6	-
11	113.85'	1	0.00-1.10'	silty loam	2.5Y 2.5/1	energy*, historic ceramics, glass*
		2	1.10-2.40'	mottled silty loam	10YR 3/3 2.5Y 6/4	fauna*, historic ceramics, glass, building materials*
		3	2.40-3.30'	silty loam	7.5YR 4/4	-
		4	3.30-3.70'	clay	10YR 5/6	-
12	113.79'	1	0.00-0.90'	silty loam	10YR 3/2	-
		2	0.90-1.60'	mottled silty loam	10YR 3/2 2.5YR 4/6	building materials* glass*, metal*, inorganic*
			1.60'	rock impasse		

APPENDIX A (Cont.)

SUMMARY OF SUBSURFACE TESTING: SHOVEL TESTS

ST#	Surface Elevation ASL	Layer #	Depth From to	Soil Description	Munsell Color	Cultural Materials
13	113.84'	1	0.00-0.90'	silty loam	10YR 3/2	energy*, glass*
		2	0.90-2.10'	silty/sandy loam with decaying schist	10YR 4/4	energy*, building materials*, historic ceramics
			2.10'	rock impasse		
14	113.67'	1	0.00-0.70'	silty loam	10YR 3/1	fauna*, historic ceramics*, building materials*
		2	0.70-1.80'	mottled silty loam	10YR 3/1 10YR 4/6 10YR 4/6	glass*, building materials*
		3	1.80'	mortar/brick/schist		
15	113.67'	1	0.00-0.70'	silty loam	10YR 3/1	inorganic*
		2	0.70-1.10'	mottled silty loam	10YR 3/1 10YR 4/4	building materials*
		3	1.10'	mortar/brick/schist		
16	113.67'	1	0.00-0.90'	silty loam	10YR 3/1	fauna*
		2	0.90-1.50'	mottled silty loam	10YR 3/1 10YR 4/4 10YR 6/8	glass, building materials*, energy*
		3	1.50'	mortar/brick/schist		
17	114.20'	1	0.00-1.40'	mottled silty loam	10YR 3/1 10YR 4/4 7.5YR 5/6	historic ceramics
		2	1.40-2.60'	silty loam	10YR 5/8	-
		3	2.60-3.90'	mottled silty loam	10YR 2/1 10YR 4/4 10YR 5/2	glass, historic ceramics
18	114.07'	1	0.00-1.10'	silty loam	10YR 3/1	glass, historic ceramics
		2	1.10-1.90'	mottled silty loam	10YR 3/1 10YR 4/4 7.5YR 5/6	glass, building materials*
		3	1.90-4.00'	silty loam	10YR 5/8	-

APPENDIX A (Cont.)

SUMMARY OF SUBSURFACE TESTING: SHOVEL TESTS

ST#	Surface Elevation ASL	Layer #	Depth From to	Soil Description	Munsell Color	Cultural Materials
19	113.78'	1	0.00-0.60'	silty loam	10YR 3/1	glass, energy*
		2	0.60-2.10'	silty loam	10YR 4/4	historic ceramics, energy*
		3	2.10-3.10'	mottled silty loam	10YR 4/4 7.5YR 4/6	historic ceramics, glass
20	115.26'	1	0.00-0.80'	silty loam	10YR 3/1	energy*, inorganic*, building materials*, historic ceramics, building materials
		2	0.80-4.00'	mottled silty loam	10YR 4/4 7.5YR 4/6	building materials*, energy* glass, metal, historic ceramics
21	115.79'	1	0.00-0.40'	silty loam	10YR 3/1	glass
		2	0.40-1.20'	silty loam	10YR 5/8	historic ceramics, building materials*
		3	1.20-2.30'	silty loam with decaying schist	10YR 3/2	building materials*
		4	2.30-3.20'	clayey silty loam	7.5YR 4/4	building materials*
22	114.51'	1	0.00-0.60'	silty loam	10YR 3/1	energy*, glass*, inorganic*
		2	0.60-2.60'	silty loam	10YR 4/4	glass, historic ceramics, inorganic*, energy*
		3	2.60-3.10'	silty loam	10YR 5/8	-
23	114.21'	1	0.00-0.60'	silty loam	10YR 3/1	inorganic*, building materials*
		2	0.60-1.70'	mottled silty loam	10YR 5/8 10YR 3/3	-
		3	1.70-2.50'	silty loam	10YR 4/3	-
			2.50'	rock impasse		

APPENDIX A (Cont.)

SUMMARY OF SUBSURFACE TESTING: SHOVEL TESTS

ST#	Surface Elevation ASL	Layer #	Depth From to	Soil Description	Munsell Color	Cultural Materials
24	115.02'	1	0.00-0.30'	silty loam	10YR 3/1	glass *
		2	0.30-2.00'	mottled silty loam	10YR 5/8 10YR 3/3	historic ceramics
		3	2.00-4.00'	silty loam	10YR 4/3	glass *
			4.00'	mottled clayey silt	10YR 5/8 10YR 4/3	-
25	115.56'	1	0.00-0.70'	silty loam	10YR 3/1	glass *
		2	0.70-2.40'	silty loam	10YR 3/3	historic ceramics, energy *
		3	2.40-3.00'	clayey silty loam	10YR 5/8	-
26	117.30'	1	0.00-0.50'	silty loam	10YR 3/1	-
		2	0.50-2.40'	silty loam	7.5YR 4/4	-
27	117.73'	1	0.00-0.90'	silty loam	10YR 5/8 10YR 3/2	historic ceramics, metal, inorganic *
		2	0.90-2.70'	clayey silty loam	7.5YR 4/4	-
28	118.47'	1	0.00-0.70'	silty loam	10YR 3/1	historic ceramics, glass
		2	0.70-1.60'	silty loam	7.5YR 4/4	-
29	120.51'	1	0.00-0.35'	silty loam	10YR 3/2	-
		2	0.35-1.40'	silty loam with gravel	10YR 4/4	historic ceramics, energy *, building materials *
		3	1.40-3.00'	silty loam	7.5YR 4/6	historic ceramics
30	119.57'	1	0.00-0.20'	silty loam	10YR 3/2	-
		2	0.20-2.50'	silty loam	10YR 4/4	historic ceramics, building materials *
		3	2.50-3.40'	silty loam	7.5YR 4/6	historic ceramics, building materials *
		4	3.40-5.20'	silty clay	10YR 4/3	-

APPENDIX A (Cont.)

SUMMARY OF SUBSURFACE TESTING: SHOVEL TESTS

ST#	Surface Elevation ASL	Layer #	Depth From to	Soil Description	Munsell Color	Cultural Materials
31	118.40'	1	0.00-0.20'	silty loam	10YR 3/2	-
		2	0.20-2.80'	mottled silty loam	10YR 4/4 7.5YR 5/8	historic ceramics*, glass
		3	2.80-3.50'	clayey silt	7.5YR 4/6	-
32	113.20'	1	0.00-1.50'	silt/clay/schist	-	-
			1.50'	rubble impasse		
33	113.20'	1	0.00-1.50'	silt/clay/schist	-	-
			1.50'	rubble impasse		
34	113.20'	1	0.00-1.50'	silt/clay/schist	-	-
			1.50'	rubble impasse		
35	113.93'	1	0.00-0.40'	silty loam	10YR 3/2	-
		2	0.40-1.20'	silty loam with gravel	7.5YR 5/8	-
		3	1.20-2.30'	silty loam	10YR 4/4	glass*, metal*, inorganic*, building materials*
			2.30'	gravel impasse		
36	113.72'	1	0.00-0.50'	silty loam	10YR 3/2	-
		2	0.50-1.60'	silty loam with gravel	10YR 4/4	-
		3	1.60-2.30'	clayey silty loam	10YR 6/4	-
*Discarded in field						

APPENDIX B
ARTIFACT INVENTORY

**APPENDIX B
ARTIFACT INVENTORY**

Shovel Test: 1

Context: 1

GLASS

Recreational

1 frag

Marble

clear/uncolored with milky band, exhibits many air bubbles, machine-made

Vessel

1 frag

Indeterminate

curved, clear/uncolored, exterior surface exhibits orange peel texture

1 frag

Indeterminate

curved, clear/uncolored

METAL

Aluminum

1 frag

Closure

pull tab

Total Artifacts in Context: 4

Context: 2

BUILDING MATERIALS

Brick

1 frag

Indeterminate

dark red with black interior, with adhered cement, two measurable dimensions

Width: 3.00in

Thickness: 2.00in

2 frags

Indeterminate

orange

Width: 3.00in

Thickness: 2.00in

Iron

1 frag

Nail

shank only, corroded

FAUNA

Shell

1 frag

Indeterminate

clam or oyster

GLASS

Vessel

1 frag

Bottle

finish/neck fragment, clear/uncolored, finishing tooled prescription lip

1 frag

Indeterminate

curved, clear/uncolored

Total Artifacts in Context: 7

APPENDIX B (CONT.)

Shovel Test: 1

Context: 2

GLASS

Vessel

Total Artifacts in Unit: 11

Shovel Test: 2

Context: 1

GLASS

Vessel

3	frags	<i>Indeterminate</i> curved, green
1	frag	<i>Indeterminate</i> curved, brown

Total Artifacts in Context: 4

Context: 2

CERAMICS

Whiteware

1	sherd	<i>Indeterminate</i> undecorated
---	-------	-------------------------------------

Total Artifacts in Context: 1

Total Artifacts in Unit: 5

Shovel Test: 3

Context: 2

BUILDING MATERIALS

Brick

3	frags	<i>Indeterminate</i> orange, tiny fragments
---	-------	--

Total Artifacts in Context: 3

Total Artifacts in Unit: 3

APPENDIX B (CONT.)

Shovel Test: 4

Context: 1

CERAMICS

Whiteware

1	sherd	<i>Indeterminate</i> undecorated
---	-------	-------------------------------------

GLASS

Flat

1	frag	<i>Window</i> pale aqua
---	------	----------------------------

Total Artifacts in Context: 2

Context: 2

BUILDING MATERIALS

Iron

1	frag	<i>Nail</i> square body, headless, corroded
---	------	--

CERAMICS

Whiteware

1	sherd	<i>Flatware</i> interior exhibits blue applied/molded shell edge decoration
1	sherd	<i>Indeterminate, Rim</i> undecorated
1	sherd	<i>Indeterminate</i> undecorated

Total Artifacts in Context: 4

Context: 3

CERAMICS

Earthenware

1	sherd	<i>Hollowware</i> refined white body, exterior exhibits light blue underglaze ground decoration, interior exhibits dark blue underglaze ground decoration
---	-------	--

Pearlware

1	sherd	<i>Indeterminate</i> undecorated
---	-------	-------------------------------------

Redware

1	sherd	<i>Indeterminate</i> interior/exterior clear lead glaze
---	-------	--

Whiteware

1	sherd	<i>Indeterminate</i> undecorated
3	sherds	<i>Indeterminate</i> undecorated, opposite surface missing

APPENDIX B (CONT.)

GLASS

Vessel

1	frag	<i>Bottle</i> polygonal shaped vessel, pale green
1	frag	<i>Bottle/Jar</i> pale green, exhibits raised lettering "E..."
1	frag	<i>Indeterminate</i> curved, sky blue

METAL

Iron

1	frag	<i>Hardware</i> indeterminate, corroded
---	------	--

Total Artifacts in Context: 11

Total Artifacts in Unit: 17

Shovel Test: 5

Context: 2

GLASS

Vessel

1	frag	<i>Bottle</i> curved, clear/uncolored
1	frag	<i>Bottle</i> curved, clear/uncolored, exhibits raised lettering "RE..." and orange peel texture

Total Artifacts in Context: 2

Total Artifacts in Unit: 2

Shovel Test: 6

Context: 1

GLASS

Vessel

1	frag	<i>Table Glass</i> pressed glass, starburst and diamond design, clear/uncolored
---	------	--

Total Artifacts in Context: 1

Total Artifacts in Unit: 1

APPENDIX B (CONT.)

Shovel Test: 10

Context: 2

GLASS

Flat

1 frag

Window
clear/uncolored

Total Artifacts in Context: 1

Total Artifacts in Unit: 1

Shovel Test: 11

Context: 1

GLASS

Vessel

2 frags

Bottle/Jar
curved, clear/uncolored

Total Artifacts in Context: 2

Context: 2

GLASS

Vessel

1 frag

Indeterminate
curved, clear/uncolored
Length: 4.70cm

Width: 4.70cm

Height: 5.70cm

3 frags

Ink Bottle
almost complete squat square ink bottle, pale green, multi-piece mold, exhibits raised lettering "CAW'S INK, NEW YORK", three mend as one
Length: 4.70cm

Width: 4.70cm

Height: 5.70cm

METAL

Iron

1 frag

Hardware
indeterminate, corroded

Total Artifacts in Context: 5

Context: 3

CERAMICS

Whiteware

1 sherd

Indeterminate
exterior surface missing, interior exhibits underglaze transfer printed blue floral decoration

APPENDIX B (CONT.)

FAUNA

Shell

1 frag

Indeterminate
probably clam

GLASS

Flat

1 frag

Window
pale aqua

Total Artifacts in Context: 3

Total Artifacts in Unit: 10

Shovel Test: 12

Context: 1

CERAMICS

Whiteware

1 sherd

Hollowware
exterior exhibits dipped/annular earth tones common cable decoration

1 sherd

Indeterminate
undecorated

GLASS

Vessel

1 frag

Jar
finish/neck/body fragment, clear/uncolored, possibly barrel shaped

INORGANIC

Rubber

1

Toy
black toy wheel with remnant iron axle

Total Artifacts in Context: 4

Context: 2

BUILDING MATERIALS

iron

1 frag

Nail
shank only, corroded, indeterminate

Total Artifacts in Context: 1

Total Artifacts in Unit: 5

APPENDIX B (CONT.)

Shovel Test: 13

Context: 1

GLASS

Flat

1 frag

Indeterminate

clear/uncolored flat glass fragment laminated on one surface with thin layer of red glass

Total Artifacts in Context: 1

Context: 2

CERAMICS

Whiteware

1 sherd

Indeterminate

undecorated

Total Artifacts in Context: 1

Total Artifacts in Unit: 2

Shovel Test: 14

Context: 1

CERAMICS

Pearlware

1 sherd

Hollowware

undecorated, lid fragment

FAUNA

Shell

1

Oyster

complete

Total Artifacts in Context: 2

Context: 2

BUILDING MATERIALS

Ceramic

1 frag

Drainage Pipe

red earthenware, unglazed

APPENDIX B (CONT.)

GLASS

Vessel

1 frag

Indeterminate

pale green, exterior surface exhibits subtle texturing to appear old

Total Artifacts in Context: 2

Total Artifacts in Unit: 4

Shovel Test: 16

Context: 2

GLASS

Flat

1 frag

Window

pale aqua

Vessel

1 frag

Indeterminate

curved, clear/uncolored

Total Artifacts in Context: 2

Total Artifacts in Unit: 2

Shovel Test: 17

Context: 1

BUILDING MATERIALS

Brick

2 frags

Indeterminate

pale red

Ceramic

1 frag

Indeterminate

dark red, refined body, possibly tile fragment

CERAMICS

Ironstone

1 sherd

Indeterminate

undecorated

1 sherd

Indeterminate

one surface missing, opposite surface exhibits printed black maker's mark "B..." under other words

Pearlware

2 sherds

Hollowware

undecorated

APPENDIX B (CONT.)

METAL

Copper Alloy

1

Coin

United States wheat back penny, dated 1940

Total Artifacts in Context: 8

Context: 3

CERAMICS

Ironstone

1

sherd

Indeterminate, Base

undecorated

GLASS

Vessel

2

frags

Indeterminate

curved, manganese solarized

1

frag

Indeterminate

curved, clear/uncolored

Total Artifacts in Context: 4

Total Artifacts in Unit: 12

Shovel Test: 18

Context: 1

CERAMICS

Whiteware

1

sherd

Indeterminate

undecorated

GLASS

Vessel

2

frags

Bottle

neck fragments, clear/uncolored

1

frag

Indeterminate

curved, clear/uncolored

Total Artifacts in Context: 4

APPENDIX B (CONT.)

Context: 2

GLASS

Vessel

2 frags

Indeterminate
curved, manganese solarized

Total Artifacts in Context: 2

Total Artifacts in Unit: 6

Shovel Test: 19

Context: 1

GLASS

Vessel

1 frag

Bottle
base fragment, dark green, machine-made, exhibits Owen's scar, raised lettering "GALLO ...GUARD"

1 frag

Indeterminate
curved, clear/uncolored, exhibits red and white color applied label

Total Artifacts in Context: 2

Context: 2

CERAMICS

Stoneware

1 sherd

Hollowware
grey body, interior exhibits iron oxide wash under salt glaze appearing brown, exterior exhibits iron oxide wash under salt glaze appearing brown speckled

GLASS

Vessel

1 frag

Bottle
curved, aqua

Total Artifacts in Context: 2

Context: 3

CERAMICS

Ironstone

1 sherd

Indeterminate
undecorated

APPENDIX B (CONT.)

GLASS

Vessel

1 frag

Indeterminate
curved, manganese solarized

Total Artifacts in Context: 2

Total Artifacts in Unit: 6

Shovel Test: 20

Context: 1

BUILDING MATERIALS

Iron

1 frag

Nail
square body, corroded, head missing

CERAMICS

Whiteware

1 sherd

Indeterminate, Base
undecorated

Total Artifacts in Context: 2

Context: 2

BUILDING MATERIALS

Brick

1 frag

Indeterminate
red

Ceramic

1 frag

Tile
thin layer of white highly vitrified porcelain adhered to mortar

Iron

1 frag

Nail
indeterminate, corroded, head missing

CERAMICS

Ironstone

1 sherd

Hollowware, Base
footring/body fragment, exterior undecorated, interior exhibits possibly remnant
overglaze pink lustre decoration

1 sherd

Indeterminate
undecorated

Porcelain

1 sherd

Hollowware
possibly Bone China, burned

1 sherd

Indeterminate
hard paste, undecorated

APPENDIX B (CONT.)

GLASS

Vessel

1	frag	<i>Indeterminate</i> curved, clear/uncolored, exterior exhibits orange peel texture
3	frags	<i>Indeterminate</i> curved, clear/uncolored, exterior exhibits fake crackled texture
2	frags	<i>Indeterminate</i> curved, clear/uncolored
1	frag	<i>Indeterminate</i> curved, brown
1	frag	<i>Indeterminate</i> curved, amber
1	frag	<i>Indeterminate</i> curved, pale aqua

METAL

Iron

6	frags	<i>Indeterminate</i> some are layers of sheet metal
1	frag	<i>Wire</i>

Total Artifacts in Context: 23

Total Artifacts in Unit: 25

Shovel Test: 21

Context: 1

GLASS

Vessel

1	frag	<i>Indeterminate</i> curved, clear/uncolored, part of surface exhibits orange peel texture
---	------	---

Total Artifacts in Context: 1

Context: 2

BUILDING MATERIALS

Ceramic

1	frag	<i>Drainage Pipe</i> red earthenware, unglazed
---	------	---

Total Artifacts in Context: 1

Total Artifacts in Unit: 2

APPENDIX B (CONT.)

Shovel Test: 22

Context: 2

BUILDING MATERIALS

Ceramic

1 frag

Tile
white earthenware, glazed surface

GLASS

Vessel

1 frag

Bottle
cobalt blue, finish fragment

Total Artifacts in Context: 2

Total Artifacts in Unit: 2

Shovel Test: 24

Context: 2

CERAMICS

Whiteware

1 sherd

Hollowware
exterior exhibits dipped/annular green and blue bands

Total Artifacts in Context: 1

Total Artifacts in Unit: 1

Shovel Test: 25

Context: 2

CERAMICS

Recreational

1 frag

Tobacco Pipe
white ball clay stem fragment, undecorated

Whiteware

1 sherd

Indeterminate
undecorated

APPENDIX B (CONT.)

GLASS

Vessel

1 frag

Indeterminate

curved, amber, exterior exhibits raised partial design, dot on point

Total Artifacts in Context: 3

Total Artifacts in Unit: 3

Shovel Test: 27

Context: 1

BUILDING MATERIALS

Iron

1

Nail

cut

CERAMICS

Recreational

1

Other

small tile, possibly gaming piece, white, obverse exhibits skull

Stoneware

4

sherds

Hollowware

tan body, interior exhibits Bristol glaze with severe pock marks, exterior exhibits brown, white and grey bands with dark brown line decoration

Whiteware

1

sherd

Indeterminate

undecorated, opposite surface missing

Total Artifacts in Context: 7

Total Artifacts in Unit: 7

Shovel Test: 28

Context: 1

CERAMICS

Whiteware

1

sherd

Indeterminate

undecorated

GLASS

Vessel

1

frag

Bottle

curved, clear/uncolored, exhibits raised lettering "...OPERLY" (Please Dispose of Properly)

APPENDIX B (CONT.)

Shovel Test: 28

Context: 1

GLASS

Vessel

1	frag	<i>Indeterminate</i> curved, clear/uncolored
---	------	---

Total Artifacts in Context: 3

Total Artifacts in Unit: 3

Shovel Test: 29

Context: 2

CERAMICS

Pearlware

1	sherd	<i>Indeterminate</i> exterior exhibits dark blue applied underglaze indeterminate decoration
---	-------	---

Total Artifacts in Context: 1

Context: 3

CERAMICS

Recreational

1	frag	<i>Tabacco Pipe</i> white ball clay bowl fragment, undecorated
---	------	---

Total Artifacts in Context: 1

Total Artifacts in Unit: 2

Shovel Test: 30

Context: 2

CERAMICS

Creamware

1	sherd	<i>Indeterminate</i> one surface undecorated, opposite surface missing
---	-------	---

Pearlware

1	sherd	<i>Flatware, Rim</i> interior exhibits underglaze hand painted blue band decoration
---	-------	--

1	sherd	<i>Indeterminate</i> undecorated
---	-------	-------------------------------------

1	sherd	<i>Indeterminate</i> one surface missing, opposite surface exhibits remnant underglaze blue and molded decoration
---	-------	--

APPENDIX B (CONT.)

Shovel Test: 30

Context: 2

CERAMICS

Pearlware

1	sherd	<i>Indeterminate</i> interior exhibits underglaze transfer printed blue indeterminate decoration
---	-------	---

Redware

1	sherd	<i>Indeterminate</i> exterior unglazed, interior clear lead glaze
---	-------	--

Whiteware

1	sherd	<i>Flatware</i> exterior exhibits remnant underglaze blue edge decoration, interior surface missing
2	sherds	<i>Flatware, Rim</i> scalloped rim, interior exhibits underglaze blue applied decoration on molded beads
1	sherd	<i>Hollowware, Rim</i> undecorated
1	sherd	<i>Hollowware</i> exterior exhibits underglaze hand painted blue and red sprig decoration
1	sherd	<i>Indeterminate</i> undecorated, opposite surface missing
1	sherd	<i>Indeterminate, Base</i> undecorated

Total Artifacts in Context: 13

Context: 3

CERAMICS

Pearlware

2	sherds	<i>Indeterminate, Base</i> exterior undecorated, interior surface missing
1	sherd	<i>Indeterminate</i> interior exhibits hand painted underglaze green leaf decoration
1	sherd	<i>Indeterminate</i> exterior surface missing, interior exhibits transfer printed underglaze dark blue indeterminate decoration

Redware

1	sherd	<i>Indeterminate</i> exterior surface missing, interior clear lead glaze
---	-------	---

APPENDIX B (CONT.)

Stoneware
1 sherd

Hollowware
grey body, interior/exterior exhibit iron oxide wash under salt glaze

Total Artifacts in Context: 6

Total Artifacts in Unit: 19

Shovel Test: 31

Context: 2

CERAMICS

Creamware
1 sherd

Indeterminate
undecorated, opposite surface missing

Pearlware
1 sherd

Indeterminate
undecorated

1 sherd

Indeterminate, Rim
undecorated

Whiteware
1 sherd

Hollowware
undecorated

Total Artifacts in Context: 4

Total Artifacts in Unit: 4

TOTAL ARTIFACTS: 155

* Item Discarded in Lab