

7205a

Loorya
2006

Rufus King Manor, Rufus King Park
Tree Placement Monitoring Project, Queens, New York



Prepared for:

B 96 82 L 1

Submitted to:

City of New York - Department of Parks and Recreation
Olmstead Center; Queens, New York

Mathews/Nielsen Landscape
184 Duane Street
New York, NY 10013-3609

City of New York - Landmarks Preservation Commission
New York, New York

and

The Historic House Trust -
City of New York - Department of Parks and Recreation
New York, New York

Prepared by:

Alyssa Loorya, M.A., R.P.A., Principal Investigator
and Christopher Ricciardi, Ph.D., R.P.A.
April 2006

927

Rufus King Manor, Rufus King Park
Tree Placement Monitoring Project, Queens, New York

Prepared for:

City of New York - Department of Parks and Recreation
Olmstead Center; Queens, New York

City of New York - Landmarks Preservation Commission
New York, New York

and

The Historic House Trust –
City of New York - Department of Parks and Recreation
New York, New York

Prepared by:

Alyssa Loorya, M.A., R.P.A., Principal Investigator
and Christopher Ricciardi, Ph.D., R.P.A.
April 2006

Submitted to:

Mathews/Nielsen Landscape
184 Duane Street
New York, NY 10013-3609

MANAGEMENT SUMMARY

On Monday, April 10, 2006 Chrysalis Archaeological Consultants undertook the monitoring of tree installation at Rufus King Manor (RKM), Rufus King Park, Queens, New York on behalf of the City of New York Department of Parks and Recreation. Mathews/Nielsen Landscape (MNL) was retained for the installation of trees around the historic, landmarked structure. The Cultural Resource Request for Proposal called for archaeological monitoring of all subsurface excavation work prior to the installation of the trees due, in part, to the historic nature of the property and the sensitivity of the area based upon previous archaeological excavation.

For several years, RKM has been the subject of archaeological research by Dr. Christopher Matthews of Hofstra University. Over the course of several field seasons Dr. Matthews has demonstrated the archaeological significance of this site. It was due to his absence that CAC was asked to undertake monitoring. MNL subcontracted the excavation and installation of the trees to Urban Arborists under the direction of Bill Logan.

Prior to work three areas were determined for tree planting and noted for their potential sensitivity. Two areas were located within the confines of the fence surrounding RKM and the third was located approximately five meters outside the northern gate of the house. The trees being planted were four inch trees and required four by four foot circular pits to be excavated to a depth of approximately thirty inches to accommodate the root balls.

Two of the three excavated areas (T02 and T03) proved to be devoid of material remains. However, during the excavation for T01, what appeared to be a late nineteenth century/early twentieth century refuse deposit was uncovered in the southern portion of the excavation pit. Below this layer of debris, mostly brick building materials was a layer of three mortared wide bricks in association with two broken green blown wine/liquor bottles with a typical mid to late eighteenth century "blob" top.

Upon uncovering the in situ layer, excavation was halted and the pit for the tree was moved approximately one meter to the north. The original excavation pit was backfilled with the hopes that further excavation would be undertaken by Dr. Matthews during his upcoming field season.

It is the recommendation of this report that future excavations in the area around RKM continue to be monitored for its cultural sensitivity. Although no material remains were uncovered in two of the three excavation trenches, this was due, in part, to the previous work by Dr. Matthews in those areas. Future plans should consult with the field maps created by Dr. Matthews as well as continued to be the subject of monitoring.

TALBE OF CONTENTS

	<i>Page:</i>
Management Summary	i
Table of Contents	ii
List of Images	iii
Acknowledgements	iv
I. Introduction	1
II. Archaeological Monitoring	2
III. Summary and Recommendations	12
Appendices	
A – Site Map	13
B – Material (Artifact) Remains	15
C – Other Images	17
D – C.V.	21

LIST OF IMAGES AND MAPS

<i>Title:</i>	<i>Page:</i>
Figure 01. Rufus King Manor	01
Figure 02. Site Map	02
Figure 03. What would become known as T01A's location	03
Figure 04. T01A - Brick fragments	04
Figure 05. T01A - Hand scraping of the excavation pit	04
Figure 06. T01A - Possible in situ eighteenth to nineteenth century feature	05
Figure 07. T01B - Excavation completed	06
Figure 08. T02 Location in relation to RKM	07
Figure 09. T02 Excavation	08
Figure 10. T03A: Location	09
Figure 11. T03A: gas pipe encountered	09
Figure 12. T03B: utility pipe encountered	10
Figure 13. T03C: Location	11
Figure 14. T03C: Completed Excavation	11
Appendix C - Other Images:	
Figure 15. T01A - Green Blow Bottle remains	18
Figure 16. Figure 16: T01A - Ceramic and Bone fragments	18
Figure 17. Figure 17: T01A - Excavation	19
Figure 18. Figure 18: T01A - Trowel excavation	19
Figure 19. Figure 19: T02A - Completed	20
Figure 20. Figure 20: T03C - Completed	20

** NOTE: All images were taken by Christopher Ricciardi

ACKNOWLEDGEMENTS

The authors wish to thank Jake Woland and Mathews/Nielsen Landscape, the New York City Department of Parks and Recreation, especially Rachel Kramer, and the Historic House Trust, especially Meredith Sorin, for the chance to work on this project. Mary Anne Mrozinski from the Rufus King House and Dr. Christopher Matthews provided great assistance with regard to what work had previously occurred on site. Finally, we would like to thank Amanda Sutphin, Director of Archaeology at the New York City Landmarks Preservation Commission for advice, comments and consultation during this project.

I. Introduction:

On Monday, April 10, 2006 Chrysalis Archaeological Consultants (CAC) undertook the monitoring of tree installation at Rufus King Manor (RKM), Rufus King Park, Queens, New York (Figure 01) on behalf of the City of New York Department of Parks and Recreation (Parks). Mathews/Nielsen Landscape (MNL) was retained for the installation of trees around the historic, landmarked structure. MNL subcontracted the excavation and installation of the trees to Urban Arborists under the direction of Bill Logan. CAC staff on site included Alyssa Loorya, M.A., R.P.A. (Principle Investigator) and Christopher Ricciardi, Ph.D., R.P.A..

The Cultural Resource Request for Proposal called for archaeological monitoring of all subsurface excavation work prior to the installation of the trees due, in part, to the historic nature of the property and the sensitivity of the area based, in part, upon previous archaeological excavation. The house is listed on the National Register of Historic Places.



Figure 01: Rufus King Manor

For several years, RKM has been the subject of archaeological research by Dr. Christopher Matthews of Hofstra University, as well as other archaeological undertakings. Over the course of several field seasons Dr. Matthews has demonstrated the archaeological significance of this site. It was due to his absence that CAC was asked to undertake monitoring.

A documentary study was not required as part of this specific project. As part of Dr. Matthews long term archaeological study of Rufus King Park, documentary information is being gathered and will be reported on.

II. Archaeological Monitoring:

Prior to the positioning of the three excavation areas for the trees, Dr. Matthews was consulted with by Parks. This was done to ensure placement in areas that had either been previously tested or were least likely to contain significant deposits.

The three areas excavated by hand, with the assistance of a mechanical bob-cat, were staked out (Figure 02 and Appendix A). The excavation pits were classified as Tree 01 (T01), Tree 02 (T02) and Tree 03 (T03).

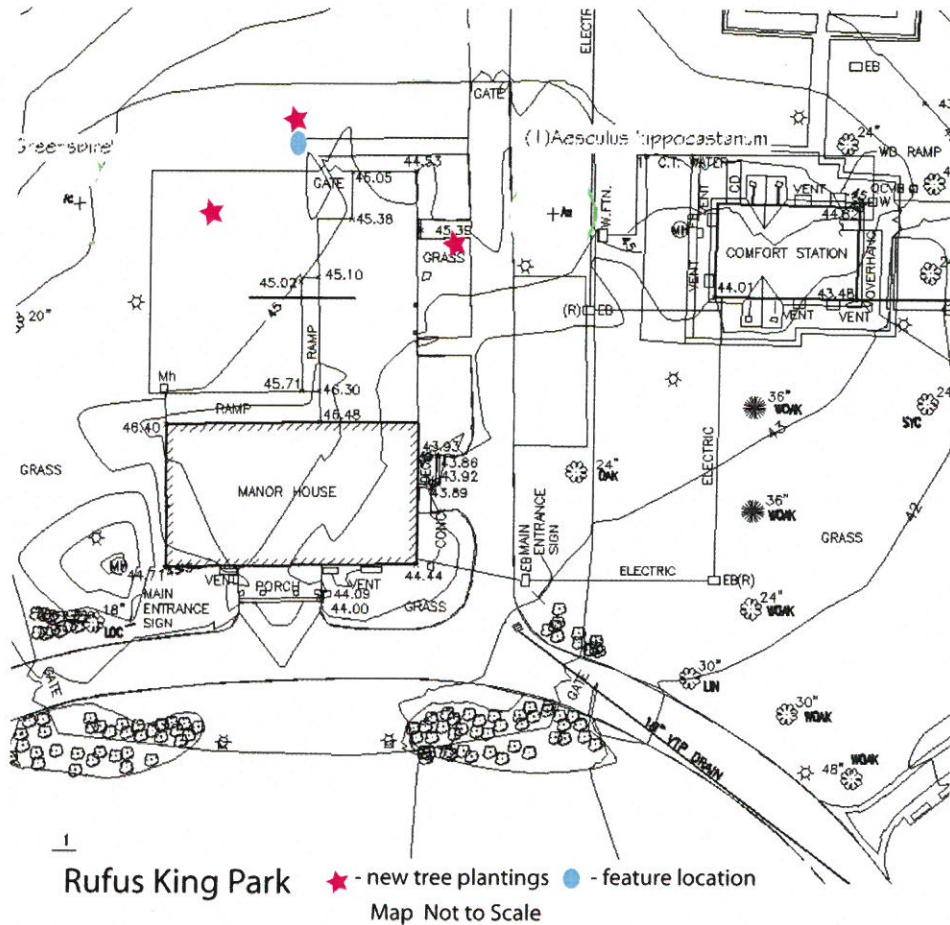

Figure 02 - Rufus King Manor/Park - rough site map, based upon MNL site plan -
 Note - site map is not to scale

Excavation Area Tree 01:

Situated approximately four (4) meters east and five (5) meters north of the wrought iron fence opening (Figure 02), this excavation pit was the only one outside of the house's property within Rufus King Park (Figure 03). The pit was to be excavated to a diameter and depth of one and a quarter (1.25) meters by one (1) meter.



Figure 03: What would become known as T01A's location

Excavation work immediately revealed two distinct soil sections. The southern half of the pit was a mixture of moist dark loamy soil, while the northern half was comprised of sand and reddish clay. Broken fragments of red brick were scattered throughout the dark loamy soil (Figure 04). Approximately thirty (.30) centimeters below surface larger pieces of red brick fragments were exposed along with a piece of whiteware ceramic. Excavation was halted and scraping using trowels began to determine if the pieces were scattered fill, or part of a larger deposit and/or feature (Figure 05). It was the working assumption, at that stage, that the fragments were refuse materials deposited in that area and the excavation was allowed to continue.



Figure 04: T01A - Brick fragments



Figure 05: T01A - Hand scraping of the excavation pit

At approximately one (1) meter below surface, and just at a point where the excavation pit was almost completed, a series of three mortared red bricks were uncovered. Adjacent to them were the remains of at least two green blown wine/liquor bottles, a piece of transfer-printed blue pearlware, a blue painted porcelain ceramic fragment and a fragment of an animal's rib (Figure 06)¹. It was determined that this may be an in situ feature that could date from the late eighteenth to the early nineteenth century. After consultation with all parties, it was decided not to plant the tree in this pit, but rather move approximately one (1) meter north to avoid the uncovered material remains. This excavation pit was then relabeled as T01A and the new excavation pit would be called T01B.



Figure 06: T01A - Possible in situ eighteenth to nineteenth century brick feature

T01B was located along the same north-south point, but one (1) meter further into the park (Figure 02). Unlike T01A, just below the surface, the soil was comprised almost completely of the sandy, red clay soil and was devoid of all material remains (Figure 07). The excavation pit, upon completion was the required one and a quarter (1.25) meters in diameter by one (1) meter in depth.

¹ For a listing of the material remains recovered in T01A see Appendix B.



Figure 07: T01B - Excavation completed

Excavation Area Tree 02:

Located in the north western corner of the house's property (Figure 02), within the confines of the house's perimeter fence (Figure 08), T02 was located near the area that previous excavations uncovered a stone-lined shaft feature. The proposed excavation pit for the tree installation in this area was slightly larger than the others at approximately one hundred fifty (1.50) centimeters in diameter.



Figure 08: T02 Location in relation to RKM and previously excavated stone lined shaft feature - the dark, barren soil area just to the southwest of the stake.

Excavation for T02 was undertaken both manually and with some mechanical assistance (Figure 09). The pit contained a layer of topsoil, approximately thirty (.30) centimeters in depth, followed by a light reddish brown subsoil layer, which extended to the bottom of the excavated pit. This unit was excavated to a depth of approximately sixty (.60) centimeters below surface. No artifact remains were uncovered during this excavation.



Figure 09: T02 Excavation

Excavation Area Tree 03:

This excavation area was located east of the house, Figure 04, in the northeastern half of the property (Figure 02). This location was selected due to a previous tree that was recently removed and because the area was previously excavated by Dr. Matthews in 2005. The proposed diameter and depth for this pit was to be approximately one and a quarter (1.25) meters by one (1) meter.

An initial excavation attempted to place the excavation pit exactly within the area of a previously excavated archaeological test pit (Figure 10). As the excavation neared the projected depth, a metal gas pipe was encountered (Figure 11). It was determined that this area should not be used for the tree because future growth could damage the pipe. The excavation was halted and for designation purposes this pit was labeled T03A.

A decision was made to move the pit approximately one (1) meter to the north and slightly east of this previously excavated pit T03A. It was the hope of the arborists that this new placement would avoid the gas line that was running east-west towards the house. This pit was identified as T03B.



Figure 10: T03A: Location



Figure 11: T03A: gas pipe encountered

However, at approximately thirty (.30) centimeters below surface, another metal utility pipe was encountered (Figure 12). As with T03A, this pipe was also running in an east-west orientation. It was determined to abandon this pit for the same reasons as T03A was abandoned and move further north and east, closer to the existing wrought iron fence.



Figure 12: T03B: utility pipe encountered

T03C was located approximately one hundred and twenty-five (1.25) centimeters, northeast of the previous two pits in the north east corner of the property within the perimeter fence (Figure 13).

Shortly after excavation began another metal utility pipe was encountered. However, this pipe was cut and no longer in use. The crew removed and discarded the pipe. The soil in this area was similar to the disturbed soils in the other two attempted pits, a topsoil layer followed by a dark brown disturbed layer. In this pit however, the bottom was beginning to reveal a reddish brown layer and single broken paving stone was revealed. This pit was excavated to a depth of approximately one (1) meter below surface and approximately one hundred twenty-five (1.25) centimeters wide (Figure 14).



Figure 13: T03C: Location



Figure 14: T03C: Completed Excavation

III. Summary and Recommendations

Previous excavations around RKM have shown the site to contain significant, in situ, stratigraphic layers, material remains and features. Although monitoring of the installation of three trees around the property only revealed an in situ feature and material remain, in one excavation pit, it is recommended that continued archaeological monitoring be undertaken for any future subsurface work.

It is hoped that future excavation in the area of T01A will be undertaken to determine what the feature is. It has been determined that the upper portion of the test pit was used as a refuse deposit area, but the laid mortared bricks in association with at least two partially intact green blown bottles provide hints of a possible eighteenth or early nineteenth century deposit. Work has been limited in the areas north of house, outside of the perimeter fence. Uncovering this potential feature once again reveals that areas such as these should be considered for further testing.

**Appendix A:
Site Map**

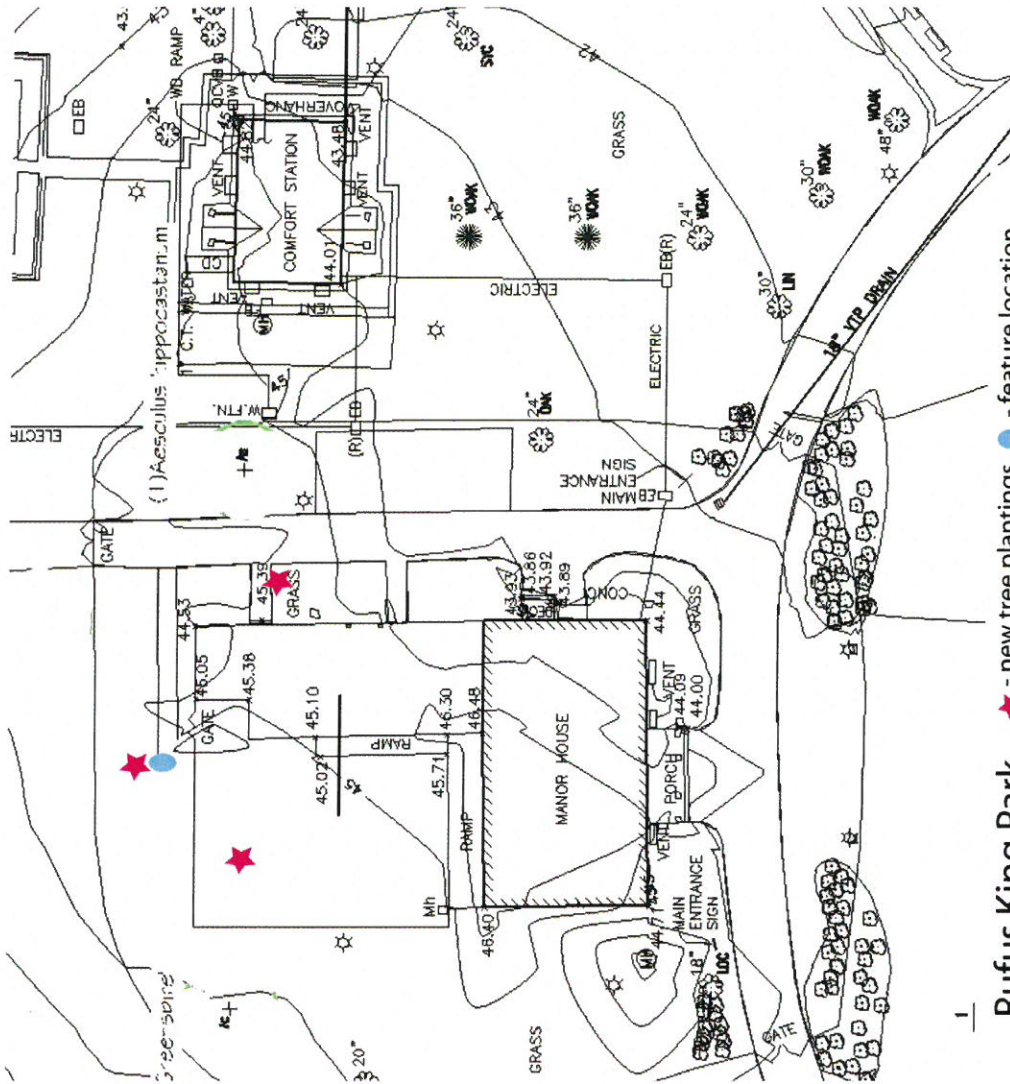

Rufus King Park ★ - new tree plantings ● - feature location
 Map Not to Scale

Appendix B:
Material (Artifact) Remains Catalogue

From T01A:

Mixed into the upper half/refuse deposit level:

Brick: 2 earthenware red bricks

Ceramic: 1 earthenware, whiteware, body shard (post 1850)

Mixed into the lower half/in situ brick layer level:

Bone: 1 fragment - rib

Ceramic: 1 earthenware, pearlware, transfer-printed blue body shard (c. 1790-1840)
1 porcelain, blue painted, body shard (post 1780- approx. 1840s)

Glass: (all blown green "liquor" bottle)
2 bases
1 neck/rim, blown (blob) top
1 neck
13 body shards

Total Artifact Count: 23 pieces

**Appendix C:
Other Images**



Figure 15: T01A - Green Blow Bottle remains



Figure 16: T01A - Ceramic and Bone fragments



Figure 17: T01A - Excavation



Figure 18: T01A - Trowel excavation



Figure 19: T02A - Completed



Figure 20: T03C - Completed

**Appendix D:
Curriculum Vitae's**

Alyssa Loorya, M.A., M.Phil., R.P.A.
4110 Quentin Road
Brooklyn, New York 11234-4322
Phone/Fax: (718) 645-3962 or Cell: (347) 922-5581
E-mail: Loorya@worldnet.att.net

EDUCATION:

CITY UNIVERSITY OF NEW YORK GRADUATE SCHOOL AND UNIVERSITY CENTER;
New York, New York.
Ph.D. Candidate in Anthropology/Historical Archaeology,
expected graduation: Fall 2007.

HUNTER COLLEGE; New York, New York.
M.A. in Anthropology, June 1998.

BROOKLYN COLLEGE; Brooklyn, New York.
B.A. in Anthropology, History and Education, Magne Cum Laude and Departmental Honors, January 1995.

PROFESSIONAL LICENSES:

Register of Professional Archaeologists
New York City Department of Education, Per Diem Substitute Teaching Certificate Number: 775621

Fully Insured, Incorporated as Chrysalis Archaeological Consultants, Incorporated, June 2005.

EMPLOYMENT - ARCHAEOLOGY:

BROOKLYN COLLEGE, CITY UNIVERSITY OF NEW YORK RESEARCH FOUNDATION
Laboratory Director, September 2001 to present
City Hall Park Project
Project Director and Graphic Artist, January 2004 to present
Revolutionary War Heritage Tourism Trail project.

BROOKLYN COLLEGE ARCHAEOLOGICAL RESEARCH CENTER
Teacher Assistant, June 2001 to present
Hendrick I. Lott House, Brooklyn, NY, New Utrecht Church, Brooklyn, NY, Van Cortlandt Park,
Bronx, NY, Marine Park, Brooklyn, NY, Erasmus High School, Brooklyn, NY

MATHEWS/NIELSEN LANDSCAPE
Principal Investigator, Rufus King Park Project, April 2006

A. A. H. CONSTRUCTION CORPORATION
Principal Investigator, Columbus Park Restoration, September 2005 to present

WILLIAM A. GROSS CONSTRUCTION
Principal Investigator, Martin's Field Phase II Project, September 2005 to present

PHILIP HABIB AND ASSOCIATES
Principal Investigator, 311 Broadway Project, February 2005 to June 2005

UA CONSTRUCTION CORPORATION

Principal Investigator, Martin's Field Phase I Project, September 2004 to present

BAY PROPERTIES, INCORPORATED

Principal Investigator, Block 7792 Staten Island Project, December 2004 to October 2005

DELL-TECH ENTERPRISES

Principal Investigator, Pieter Claesen Wyckoff House Project, May 2004 to December 2004

Principal Investigator, Roger Morris Park Project, January 2005 to March 2005

GAMLA ENTERPRISES, N.A. INCORPORATED

Principal Investigator, 63/65 Columbia Street Project, October 2004 to February 2005

TRC ENVIRONMENTAL CORPORATION

Archaeologist, Greenpoint Project, Brooklyn, NY October 2004

MONDOL CONSTRUCTION CORPORATION

Principal Investigator, Queens County Farm Museum Project, July 2004 to December 2004

QUIGG DEVELOPMENT CORPORATION

Principal Investigator, Wayanda Park Project, August 2003

A.J. CONTRACTING INCORPORATED

Principal Investigator, Gravesend Cemetery Project, January-March 2002

AUDUBON SOCIETY OF CONNECTICUT

Project Archaeologist and Educational Consultant, May 2001 – May 2002

SAYVILLE HISTORICAL SOCIETY

Co-Director, Edwards Homestead Archaeological Project October 2000, May 2001

CITY UNIVERSITY OF NEW YORK GRADUATE SCHOOL AND UNIVERSITY CENTER

Teacher Assistant, September 1998 to December 2001

John Bowne House, Queens, NY and Hendrick I. Lott House, Brooklyn, NY

NEW YORK CITY LANDMARKS PRESERVATION COMMISSION

Assistant Site Supervisor, October 1998 to December 1998

Chambers Street Project, New York, NY

EMPLOYMENT – ARCHAEOLOGY-EDUCATION:

CITY UNIVERSITY OF NEW YORK'S – RESEARCH FOUNDATION/GOTHAM CENTER

Educational Consultant - Archaeology and Historic Preservation - City Hall Academy September 2003 – June 2004 and November 2004 to present

BROOKLYN COLLEGE AND DEPARTMENT OF EDUCATION, STAR HIGH SCHOOL

Archaeological-Education Consultant, July 2004 to present

Teaching special content classes and grant writing.

PIETER CLAESEN WYCKOFF HOUSE MUSEUM

Archaeological-Educator – Curriculum Development Consultant, 2003 to present

Responsibilities include the creation and implementation of Teacher Workshops throughout the school year.

DIG MAGAZINE

Archaeological-Education Consultant and Contributor, 2000 to present

SOUTH STREET SEAPORT MUSEUM

Archaeological Educator, September 1999 to June 2001

INSTITUTE FOR ARCHAEOLOGICAL EDUCATION AT MANHATTANVILLE COLLEGE

Curriculum Developer and Archaeological Educator, September 1997 to December 1998

PS 134, New York, NY, Scarsdale Elementary School, Scarsdale, NY, Congregation Emmanuel of Harrison, NY, Temple Israel of New Rochelle, NY

EMPLOYMENT – EDUCATION-PRESERVATION-CONSULTATION:

NEW JERSEY INSTITUTE OF TECHNOLOGY

Educational Consultant, March 2001 to December 2004

Developing special content curriculum for NYC Department of Education to meet national and state standards using primary resource historic preservation material. Teacher development and classroom teaching.

HENDRICK I. LOTT HOUSE PRESERVATION ASSOCIATION, INC.

Program Development, January 2005 to August 2005

Developed the Interpretive-Educational-Curriculum Plan for the Hendrick I. Lott House.

COMPUTER CONSULTANT

1999 to present

Independent consultant teaching private clients in all aspects of basic computer skills and software, including Microsoft Windows 95/98/Me/XP, Microsoft Office, Microsoft Internet Explorer and Outlook, Corel Word Perfect, Netscape, Adobe Suite of Products.

VOLUNTEER EXPERIENCE:

NEW YORK CITY DEPARTMENT OF EDUCATION, BRONX EXPEDITIONARY HIGH SCHOOL

Educational and Curriculum Consultant, August 2004 to December 2004

NEW YORK CITY BOARD OF EDUCATION, DISTRICT 22

Grant writer and consultant, May 2002 to September 2002

NEW YORK CITY LANDMARKS PRESERVATION COMMISSION

Laboratory Assistant, October 1997 to December 1997

Stone Street Historical District Project

BROOKLYN COLLEGE ARCHAEOLOGICAL RESEARCH CENTER - FIELD SCHOOL

Co-Director, August 1999

147 Hicks Street Cistern Excavation Project

Site Supervisor, August 1997, June 1995 and June 1996, May 1996 and October 1997

Marine Park, Brooklyn, NY; Pieter Claesen Wyckoff House, Brooklyn, NY; Timothy Knapp House, Rye, NY

Excavator, May 1995 and June 1994

Pieter Claesen Wyckoff House, Brooklyn, NY; Timothy Knapp House, Rye, NY

BROOKLYN COLLEGE – DEPARTMENT OF ANTHROPOLOGY AND ARCHAEOLOGY
Teacher Assistant, September 1996 to June 1998
Introduction to Archaeological Laboratory Methods

WEB & MEDIA DESIGN:

BROOKLYN COLLEGE ARCHAEOLOGICAL RESEARCH CENTER

Created press and field school promotional material and packets.
Developed and maintains web site for the Department's archaeology program.
<http://depthome.brooklyn.cuny.edu/anthro/dept>

HENDRICK I. LOTT HOUSE PRESERVATION ASSOCIATION

Created press and promotional material and packets. Newsletter designer and editor.
Developed and maintains web site for the organization. <http://www.lotthouse.org>

PIETER CLAESEN WYCKOFF HOUSE MUSEUM AND ASSOCIATION

Created 350th Anniversary Flyer and Conference Information.

AWARDS:

Brooklyn Borough President's Historians Award (through the Brooklyn College Archaeological Research Center) - 1998

CUNY-PSE Grant (through the Brooklyn College Archaeological Research Center) - 1998, 1999, 2000

Conference Travel Grant – CUNY Graduate Center, New York, New York 2001

PROFESSIONAL SERVICES:

1999 to present	Board of Trustees – The Hendrick I. Lott House Preservation Association
2003 to present	Member – Historic House Trust Educators Alliance
2002 to present	Advisory Board – Pieter Claesen Wyckoff House Museum
2002 to present	Advisory Board - Brooklyn Heritage Inc.
2005 to present	Board of Trustees - Salt Marsh Alliance

PUBLICATION(S):

Loorya, Alyssa.

2002 The Gravesend Cemetery Project. Report on file with the New York City Landmarks Preservation Commission. New York, New York.

1998 *Stewardship in Practice: Integrating Archaeology Into The Grade School Curriculum.*
Masters Thesis on file with the Department of Anthropology; Hunter College, New York, New York.

Loorya, Alyssa and Christopher Ricciardi.

2005a Phase IA Archaeological Documentary Study for the proposed development of 63-65, Columbia Street. (Block 299, Lots 7 and 8), Brooklyn (Kings County), New York – BSA 04BSA005K. Report on file with the New York City Landmarks Preservation Commission. New York, New York.

2005b Phase 1 Archaeological Report for Block 7792 – Staten Island (Richmond County), New York. Report on file with the New York State Office of Parks, Recreation and Historic Preservation. Albany, New York.

- 1998d "Excavating Historic Brooklyn". *De Boerenwoning*, 1(1):3-6.
- 1997 The History and Archaeology of the Wyckoff Homestead. Report on file with the New York City Department of Parks and Recreation's Historic House Trust Division, New York, New York.

Ricciardi, Christopher and Alyssa Loorya.

- 2001 Report of the Public Archaeological Dig Program at The Edwards Homestead, Sayville, New York. Report on file with the Sayville Historical Society, Sayville, New York.
- 1999 "127 Hicks Street Cistern Report". Report on file with the Brooklyn College Archaeological Research Center, Brooklyn, New York.

Ricciardi, Christopher, Alyssa Loorya and Dr. H. Arthur Bankoff.

- 2002 "A forgotten story comes to light", *Footsteps Magazine*, May-June:41-45.
- 2000 "Not Your Typical New Yorkers: Uncovering Brooklyn's Historic Past at the Hendrick I. Lott House." *This Side Up Magazine*, 12(Winter):15-16.

Membership In Professional Organizations:

The Council for Northeast Historical Archaeology (CNEHA)
 New York Archaeological Council (NYAC)
 The Professional Archaeologists of New York City (PANYC)
 The Register of Professional Archaeologists (ROPA)
 The Society for Historical Archaeology (SHA)

Computer skills:

Windows 95/98/ME/XP
 MS Office, Publisher and FrontPage
 Adobe Acrobat, Illustrator, Page Maker and Photoshop
 Macromedia Dreamweaver and Fireworks
 Quark XExpress

Conference Papers/Lectures/Teacher Workshops:

- 01-09-97 Society for Historical Archaeology Conference; Corpus Christi, Texas
 "Archaeology and Education: An Example from Rye, New York"
- 03-09-97 Middle Atlantic Archaeological Conference; Ocean City, Maryland
 "Archaeology and Education: An Example from Rye, New York"
- 01-08-97 Society for Historical Archaeology Conference; Atlanta, Georgia
 "Education and Archaeology: Getting Grade Schools Involved"
- 01-27-98 The Science Activity Exchange - Dig Into Archaeology; Greenwich, Connecticut
 "Integrating Archaeology Into The Grade School"
- 06-12-98 I.S. 211; Brooklyn, New York: "Archaeology at the Lott House"
- 04-10-99 Middle Atlantic Archaeological Conference; Harrisburg, Pennsylvania
 "Excavating Brooklyn Farmsteads: Urban Archaeology Meets Rural Sites"
- 07 & 08-99 South Street Seaport - Dig Camp at the Hendrick I. Lott
- 07-19-99 92nd Street YM-YWHA Dig Day at the Hendrick I. Lott
- 07-21-99 Brooklyn Center for the Urban Environment; Brooklyn, New York
 "Excavating The Lott House"

10-16-99 New York State Archives, New York, New York
 "Teaching Into the Millennium: Integrating Archaeology into the Curriculum"

11-16-99 Marine Park Civic Association; Brooklyn, New York: "Excavating the Lott House"

01-08-00 Society for Historical Archaeology Conference; Quebec City, Canada
 "Excavating Brooklyn, NY's Rural Past: The Hendrick I. Lott Farmstead Project"

05-23-00 I.S. 68; Brooklyn, New York: "Digging at the Lott House"

05-28-00 92nd Street YM-YWHA Dig Day at the Hendrick I. Lott House in Brooklyn, NY

06-01-00 Millennial Stews: Food and Food Systems in the Global City, Brooklyn, NY

06-12-00 Dyker Heights Middle School: Dig Camp at the Lott House

06-13-00 I.S. 68: Dig Camp at the Lott House

07 & 08-00 South Street Seaport - Dig Camp at the Hendrick I. Lott House in Brooklyn, NY

07-10-00 Salt Marsh Environmental Center; Brooklyn, NY: "Discover Brooklyn's Cultural
 Landscape Through Archaeology at the Lott House and Marine Park"

08-02-00 Brooklyn Historical Society: Dig Camp at the Lott House

08-00 South Street Seaport - Dig Camp at the Hendrick I. Lott House in Brooklyn, NY

04-19-01 Society for American Archaeology Conference, New Orleans, Louisiana
 "Beyond Community Involvement: The Hendrick I. Lott House
 Archaeological Project and its Impact in the Surrounding Community"

10-19-01 Council for Northeast Historical Archaeology Conference, Niagara, Canada
 "Unearthing 19th Century Farm Life in New York: The Lott House Project"

01-17-03 Society for Historical Archaeology Conference, Providence, Rhode Island.
 "The City Hall Park Project Poster Session"

04-19-03 Professional Archaeologists of New York City Conference, New York, NY
 "Archaeology and Historic Preservation as Educational Learning Tools"

10-00-03 Hendrick I. Lott House; Brooklyn, New York: "Teacher Workshop-Archaeology"

01-22-04 Bartow-Pell Society; Bronx, NY: "Archaeology and Education"

09-21-04 Pieter Claesen Wyckoff House, Brooklyn, NY. "Archaeology, Historic Preservation and
 Education: Bringing the Past to the Present"

11-13-04 Hendrick I. Lott House; Brooklyn, New York: "Teacher Workshop - Archaeology"

11-20-04 Pieter Claesen Wyckoff House; Brooklyn, New York: "Teacher Workshop - Archaeology"

12-02-04 City Hall Academy; New York, NY: "On Being An Archaeologist"

01-12-05 City Hall Academy; New York, NY: "NYC Archaeology and the Revolutionary War"

01-13-05 City Hall Academy; New York, NY: "NYC Archaeology and the Revolutionary War"

02-20-05 Salt Marsh Nature Center; Brooklyn, NY: "Archaeology In Your Backyard"

02-28-05 City Hall Academy; New York, NY: "NYC Archaeology and the Revolutionary War"

03-03-05 City Hall Academy; New York, NY: "NYC Archaeology and the Revolutionary War"

05-23-05 Brooklyn College; Brooklyn, New York: "Archaeology and the Parks Department"

02-01-06 City Hall Academy; New York, NY: "NYC Archaeology and the Revolutionary War"

02-27-06 City Hall Academy; New York, NY: "NYC Archaeology and the Revolutionary War"

03-06-06 Salt Marsh Nature Center; Brooklyn, NY: "Dutch Brooklyn: Where Is Everyone?"

References:

Academic:

Professor H. Arthur Bankoff
Chairman of Anthropology and Archaeology
Brooklyn College
Bedford Avenue and Avenue H
Brooklyn, New York 11210
Phone: (718) 951-5507
Fax: (718) 951-3169
E-mail: abankoff@brooklyn.cuny.edu

Dr. Sean Sawyer, Executive Director
The Pieter Claesen Wyckoff House Museum
5816 Clarendon Road at Ralph Avenue
Brooklyn, New York 11203
Phone: (718) 629-5400
Fax: (718) 629-3125
Email: seansawyer@wyckoffassociation.org

Cultural Resource Management:

Oded Horodniceanu, P.E., CPSI, Deputy General Manager
UA Construction (An Urbitran Group Company)
71 West 23rd Street
New York, New York 10010
Phone: (212) 414-1708, ext. 1247
Fax: (212) 366-6214
E-mail: odedh@urbitran.com

Mark Gross
William A. Gross Construction Associates
117 South 4th Street
New Hyde Park, New York 11040
Phone: (516) 437-0909
Fax: (516) 437-7768

Igor Gerbor
A.A.H. Construction Corporation
18-55 42nd Street
Astoria, Queens, New York 11105-1025
Phone: (718) 267-1300
Fax: (718) 726-1474

Lou Dellaquila
Dell-Tech Enterprises, Inc.
One Pinnacle Court
Dix Hills, New York 11786
Phone: (631) 864-4660
Fax: (631) 864-4669

Historic Preservation:

Charles Henkels, AIA
President - Hendrick I. Lott House Preservation Association
815 Greenwich Street – Apt. 4A
New York, New York 10014-5191
Phone: (212) 255-3352
Fax: (212) 255-5172
Email: henkels.arch@verizon.net

Dr. Sean Sawyer, Executive Director
The Pieter Claesen Wyckoff House Museum
5816 Clarendon Road at Ralph Avenue
Brooklyn, New York 11203
Phone: (718) 629-5400
Fax: (718) 629-3125
Email: seansawyer@wyckoffassociation.org

Educational:

Mary Delano and Kate Ottavino
Center for Architecture and Building Science Research
New Jersey Institute of Technology
323 Dr. Martin Luther King Boulevard
Campbell Hall, Room 335
Newark, New Jersey 07102
Phone: (973) 596-3097
E-mail: mdelano@njit.edu

CHRISTOPHER RICCIARDI, Ph.D., R.P.A.
4110 Quentin Road
Brooklyn, New York 11234-4322
Phone/Fax: (718) 645-3962 or Cell: (917) 892-2033
E-mail: Ricciardi@worldnet.att.net

EDUCATION:

SYRACUSE UNIVERSITY; Syracuse, New York.
Ph.D in Anthropology/Historical Archaeology, June 2004
M.A. in Anthropology/Historical Archaeology, May 1997
BROOKLYN COLLEGE; Brooklyn, New York.
B.A. in History and Archaeology, minor Secondary Education, Cum Laude, June 1992.

EMPLOYMENT:

UNITED STATES ARMY CORPS OF ENGINEERS
Project Archaeologist, September 2001 to present
Cultural Resource Specialist, NHPA, NEPA, EA, EIS and Environmental Coordinator,
Project Manager – Mattituck Inlet Study, Mud Creek Planning Assistance Study
Project area includes: Long Island and the Hudson Valley.
Projects include Storm Damage Reduction, Ecosystem Restoration, Navigation Control,
NY-NJ Harbor Deepening Legal Team, Independent Technical Review Lead - Louisiana
Coastal Protection and Restoration Project and Alabama Storm Damage and Restoration
Project

CITY UNIVERSITY OF NEW YORK - RESEARCH FOUNDATION/GOTHAM CENTER
Archaeologist, October 2004
Lecturer at the City Hall Academy on archaeology

AUDUBON SOCIETY OF CONNECTICUT
Archaeologist, May 2001

URS-GREINER WOODWARD-CLYDE
Principal Investigator, January to February 2000, February to May 2001
Stone Street, New York, NY, Bronx River Parkway Extension, New York, NY,
Westchester Creek Storage Tank Project, Bronx, NY.

ELLIS ISLAND FOUNDATION
Archaeologist, November – December 2000
Ellis Island Project, New York, NY

SAYVILLE HISTORICAL SOCIETY
Co-Director, Edwards Homestead Archaeological Project October 2000, April-May 2001

NATIONAL PARKS SERVICE
Archaeological Technician, April 2000
Liberty Island Project, New York, NY

NEW YORK COUNCIL FOR THE HUMANITIES

Lecturer - Speakers in the Humanities Program, January 2000 to December 2002, January 2006 to present

NATIONAL ENDOWMENT FOR THE HUMANITIES

Archaeological Educator, November 1999

HENDRICK I. LOTT HOUSE PRESERVATION ASSOCIATION, INC.

Project Director, September 1999 to September 2001

BROOKLYN COLLEGE ARCHAEOLOGICAL RESEARCH CENTER

Co-Director, May 1998 to August 2001

Hendrick I. Lott House Archaeology Project; Brooklyn, NY

BROOKLYN NEW SCHOOL, BROOKLYN, NEW YORK

Archaeology Educator, December 1998

NEW YORK CITY LANDMARKS PRESERVATION COMMISSION

Site Supervisor, October 1998 to December 1998

Chambers Street Project; New York, NY

DEPARTMENT OF SOCIOLOGY AND ANTHROPOLOGY; FORDHAM UNIVERSITY

Adjunct Instructor (Anthropology), January 1998 to May 1998

Introduction to Archaeology

INSTITUTE FOR ARCHAEOLOGICAL EDUCATION AT MANHATTANVILLE COLLEGE

Curriculum Developer and Archaeological Educator, September 1997 to December 1998

PS 134; New York, NY, Parkway School; Greenwich, CT, Congregation Emmanuel of Harrison, NY; Temple Israel of New Rochelle, NY

NEW YORK CITY LANDMARKS PRESERVATION COMMISSION

Intern – Archaeologist, September 1997 to December 1997

Stone Street Project; New York, NY

SYRACUSE UNIVERSITY - DEPARTMENT OF ANTHROPOLOGY

Graduate Assistant, September 1995 to December 1995 and September 1996 to May 1997

WILLIAM AND MARY COLLEGE

Teacher Assistant, August to May 1993-1994

Introduction to Cultural Anthropology

RYE (NEW YORK) HISTORICAL SOCIETY

Co-Director, May 1993, 1994, 1995, 1996, 1997, June and October 1997

Timothy Knapp House; Rye, NY

ARCOPLEX/KEY PERSPECTIVES, ARCHAEOLOGICAL GROUP

Excavator, July 1990, July, August 1991

Sign Road; Staten Island, NY, Bartow-Pell Mansion; Bronx, NY, Elmhurst Park; Queens, NY

VOLUNTEER EXPERIENCE:

CHRYSLIS ARCHAEOLOGICAL CONSULTANTS, INCORPORATED

Field Director and Researcher, January 2002 to present

Rufus King Park, Queens, New York, April 2006

Columbus Park, New York, New York, September 2005 to present

Martin's Field Phase II Project, Queens, New York, September 2005 to present

311 Broadway, New York, New York, February 2005 to June 2005

Roger Morris Park, New York, New York, January 2005 to March 2005

Page Ave - Block 7792, Staten Island, New York, December 2004 to August 2005

Martin's Field Phase I Project, Queens, New York, September 2004 to present

63-65 Columbia Street, Brooklyn, New York, October to December 2004

Queens County Farm Museum; Queens, New York, July 2004 to December 2004

Pieter Claesen Wyckoff House; Brooklyn, New York, May 2004 to December 2004

Wayanda Park, Queens, New York, August 2003

Gravesend Cemetery; Brooklyn, New York, January 2002 to February 2002

CITY UNIVERSITY OF NEW YORK'S RESEARCH FOUNDATION

Archaeologist, November 2004 to present

City Hall Academy Educational Project

HUBBARD HOUSE HISTORY PROGRAM

Archaeological Director, May to June 1998

Elias Hubbard House; Brooklyn, NY

BROOKLYN COLLEGE ARCHAEOLOGICAL RESEARCH CENTER

Co-Director, August 1999

147 Hicks Street Cistern Excavation Project; Brooklyn, NY

Laboratory Assistant – Volunteer Instructor, June 1994 to July 1995; June 1997 to July 2001

Introduction to Archaeological Laboratory Methods

Assistant to the Director - Teacher Assistant, June 1993, 1994, 1995, 1996; August 1997;

Marine Park; Brooklyn, NY, Pieter Claesen Wyckoff House; Brooklyn, NY, Bartow-Pell

Mansion; Bronx, NY

Trench Supervisor, July-August 1994

Kamenska Chuka; Blagoevgrad, Bulgaria

SYRACUSE UNIVERSITY FALL FIELD EXCAVATION

Excavator, September-October 1995

The Erie House; Port Byron, NY

WILLIAM AND MARY FIELD SCHOOL

Surveyor, May 1994

St. Martin; Netherlands Antilles

RESEARCH EXPERIENCE:

NEW YORK CITY LANDMARKS PRESERVATION COMMISSION

Intern – Archaeologist, September 1997

NEW YORK CITY DEPARTMENT OF PARKS: HISTORIC HOUSE TRUST DIVISION

Research Assistant, January 1995 to July 1996

AWARDS/GRANTS:

Brooklyn Borough President's Historians Award (through the Brooklyn College Archaeological Research Center) - 1998
CUNY-PSE Grant (through the Brooklyn College Archaeological Research Center) - 1998, 1999, 2000
Dissertation Grant - The Holland Society, New York, New York - 1998
Conference Travel Grant - Syracuse University, Syracuse, New York – 1997 through 2001
Honorarium - Glenville School, Glenville, Connecticut - May 1997; Norwalk Connecticut Community College - October 1999; Archaeological Society of Staten Island, Staten Island, New York – 2003, 2004; Bartow-Pell Society, Bronx, New York – January 2004, Woodlawn Historic Society, Queens, New York – March 2004
Performance Awards, U.S. Army Corps of Engineers – New York District 2002, 2003, 2004
USACOE District Commander's Award for Scholarly Research 2005

PROFESSIONAL ORGANIZATIONS:

The Council for Northeast Historical Archaeology (CNEHA)
The Friends of New Netherland Society (FNN)
The New York State Archaeological Association (NYSAA)
The New York Archaeological Council (NYAC)
The Professional Archaeologists of New York City (PANYC)
The Register of Professional Archaeologists (ROPA)
The Society for Historical Archaeology (SHA)

PROFESSIONAL SERVICES:

2005 to present	Board of Trustees - Salt Marsh Alliance
2005	CNEHA – Student Paper Judge
2004 to 2005	President – Professional Archaeologists of New York City
2003 to present	President – Brooklyn Heritage, Incorporated
2002	Trustee/Treasurer - Brooklyn Heritage, Incorporated
2002 to 2003	Vice President – Professional Archaeologists of New York City
2001 to present	Advisor - Pieter Claesen Wyckoff House Museum Advisory Board
2001	Advisor - Brooklyn Heritage, Incorporated
1997 to present	Trustee - The Hendrick I. Lott House Preservation Association
1997 to 2001	Secretary - Metropolitan Chapter–NYS Archaeological Association

REPORTS AND PUBLICATIONS:

Ricciardi, Christopher.

- 2005a Phase 1A Documentary Study for the Mattituck Inlet Study, Village of Mattituck, Suffolk County, New York. Report on file with the U.S. Army Corps of Engineers, New York District, New York, New York.
- 2005b Phase 1A Documentary Study for the Lake Montauk Harbor Navigation Project, Lake Montauk, Suffolk County, New York. Report on file with the U.S. Army Corps of Engineers, New York District, New York, New York.
- 2004a *Changing Through The Century: Life on the Lott Family Farm, Town of Flatlands, Kings County (Brooklyn), New York in the Nineteenth Century*. Doctoral Dissertation, Department of Anthropology, Syracuse University, Syracuse, New York.
- 2004b Phase 1A Documentary Study for the Village of Northport, Suffolk County, New York. Report on file with the U.S. Army Corps of Engineers, New York District, New York, New York.

- 2003 Phase 1A Documentary Study for Spring Creek, Kings/Queens County, New York
Report on file with the U.S. Army Corps of Engineers, New York District, New York, New York.
- 2001a Phase 1A Archaeological Survey and Documentary Research Study - East River CSO Facility Planning Project – P.I.N. X027.05 P.C.N. Bronx River Greenway Adjacent To I-895 Bronx, New York. Report on file with U.R.S. Corporation, Florence, New Jersey.
- 2001b Phase 1A Archaeological Survey and Documentary Research Study – Westchester Creek CSO Storage Tank Project, Bronx Psychiatric Center Campus, Bronx, New York. Report on file with U.R.S. Corporation, Florence, New Jersey
- 2001c Report of the Archaeological Monitoring of the Installation of the Electrical Trench Excavation at The Edwards Homestead in Sayville, New York. Report on file with The Sayville Historical Society, Sayville, New York.
- 1998a “Current Research: Brooklyn, New York – Hendrick I. Lott House Project”
Society for Historical Archaeology Newsletter, 31(4):13-14, Winter.
- 1998b “Current Research: Brooklyn, New York – Hendrick I. Lott House Project”
Council for Northeast Historical Archaeology Newsletter, 41:4-5, October.
- 1997a *From Private to Public: The Changing Landscape of Van Cortlandt Park; Bronx, New York in the Nineteenth Century*. Masters Thesis, Department of Anthropology, Syracuse University, Syracuse, New York.
- 1997b Archaeology and Education – A Report of the 1997 Field Excavation.
Report on file with the Rye New York Historical Society; Rye, New York.
- Ricciardi, Christopher and Alyssa Loorya.
- 2001 Report of the Public Archaeological Dig Program at The Edwards Homestead, Sayville, New York. Report on file with the Sayville Historical Society, Sayville, New York.
- 1999 “127 Hicks Street Cistern Report”.
Report on file with the Brooklyn College Archaeological Research Center; Brooklyn, NY.
- Ricciardi, Christopher, Alyssa Loorya and Dr. H. Arthur Bankoff.
- 2002 “A forgotten story comes to light”, *Footsteps Magazine*, May-June:41-45.
- 2000 “Not Your Typical New Yorkers: Uncovering Brooklyn’s Historic Past at the Hendrick I. Lott House.” *This Side Up Magazine*, 12(Winter):15-16.
- Bankoff, H. Arthur and Christopher Ricciardi.
- 1996 Excavations At The Timothy Knapp House; Rye, New York.
Report on file with the Rye New York Historical Society; Rye, New York.
- Bankoff, H. Arthur, Christopher Ricciardi and Alyssa Loorya.
- 2004a “The Secret Room”. *Seaport*, 39(1)Winter-Spring: 32-35.
- 2004b “Field Work at the Lott House” *Seaport*, 39(1)Winter-Spring:40.
- 2001 “Remember African Under The Eaves: A forgotten room in a Brooklyn farmhouse yields evidence of religious ritual among slaves.” *Archaeology Magazine*, 54(3):36-40, May-June.

- 04-05-98 1998 Annual Meeting of The Holland Society; New York, New York
"Rediscovering Brooklyn's Dutch Heritage: The Hendrick I. Lott House Project"
- 04-14-98 New York State Archaeological Association - Metropolitan Chapter; New York, New York
"Excavating the 4th Largest City in America: The Hendrick I. Lott House
Archaeological Project"
- 04-10-99 Middle Atlantic Archaeological Conference; Harrisburg, Pennsylvania
Chairperson – Contributed Papers in Farmstead Archaeology Session
- 04-10-99 Middle Atlantic Archaeological Conference; Harrisburg, Pennsylvania
"Excavating Brooklyn's Farmsteads: Urban Archaeology Meets Traditional Rural
Sites"
- 10-12-99 New York State Archaeological Association - Metropolitan Chapter; New York, New York
"More Questions Than Answers: The Hendrick I. Lott Archaeology Project"
- 10-14-99 Norwalk Community-Technical College, Norwalk, Connecticut Lecture Series
"Historical Archaeology at the Hendrick I. Lott House in Brooklyn, NY"
- 01-08-00 Society for Historical Archaeology Conference; Quebec City, Canada
"Excavating Brooklyn, New York's Rural Past: The Hendrick I. Lott Farmstead
Project"
- 04-16-00 Professional Archaeologists of New York City's Public Program, New York, New York
"Archaeology at the Hendrick I. Lott House in Brooklyn, NY"
- 06-13-00 Suffolk County Archaeological Association, Long Island, New York
"Historical Archaeology at the Hendrick I. Lott House in Brooklyn, NY"
- 06-15-00 New York History Annual Conference; Bronx, New York
"Public Archaeology at the Hendrick I. Lott House in Brooklyn, New York"
- 04-19-01 Society for American Archaeology Conference, New Orleans, Louisiana
"Beyond Community Involvement: The Hendrick I. Lott House Archaeological
Project and its Impact in the Surrounding Community"
- 10-07-01 Gotham Center for New York City History Conference, New York, New York
"Unearthing 19th Century Farm Life in New York: The Lott House Project"
- 10-19-01 Council for Northeast Historical Archaeology Conference, Niagara, Canada
"Unearthing 19th Century Farm Life in New York: The Lott House Project"
- 11-26-01 New York University; New York, NY: "Slavery at the Lott House"
- 10-03-02 The Dutch In New York Conference, Brooklyn College, Brooklyn, New York
Conference Chairman and Organizer
- 04-19-03 Professional Archaeologists of New York City – 23rd Annual Conference, New York, New
York: Conference Chairman and Organizer

LECTURES TO COMMUNITY GROUPS, ORGANIZATIONS, TEACHER WORKSHOPS, GRADE/HIGH SCHOOL CLASSES:

- 04-20-93 John Dewey High School; Brooklyn, New York: "The Archaeology Of New York City"
- 06-05-95 St. Luke's School; New York City, New York: "What It's Like To Be An Archaeologist"
- 04-10-97 Cos Cob Elementary School; Cos Cob, Connecticut: "Archaeology in Your Backyard"
- 05-20-97 Parkway School; Greenwich, Connecticut: "Archaeology and History – What it all Means"
- 05-29-97 Order of Colonial Lords of Manors in America Annual Meeting; New York, New York
"The Archaeology of Van Cortlandt Park; Bronx, NY"
- 06-08-97 Glenville Elementary School; Glenville, CT: "Archaeology and History – What it Means"
- 01-27-98 The Science Activity Exchange - Dig Into Archaeology; Greenwich, Connecticut
"Integrating Archaeology Into The Grade School"
- 03-12-98 John Dewey High School; Brooklyn, New York: "Archaeology in Your Backyard"
- 03-17-98 James Madison High School; Brooklyn, New York: "Archaeology and the Lott Family"
- 04-04-98 James Madison High School; Brooklyn, New York: "The Archaeology of Flatlands"
- 09-08-98 Community Board 13; Brooklyn, New York: "Archaeology and Education in Brooklyn"
- 09-15-98 Marine Park Civic Association; Brooklyn, New York: "Excavating the Lott House"
- 10-25-98 Brooklyn History Day; Brooklyn, New York: "Brooklyn History from the Dirt Up"
- 12-21-98 Brooklyn New School, Brooklyn, New York: "The Archaeology of Brooklyn"

10-00-03 Hendrick I. Lott House; Brooklyn, New York: "Teacher Workshop-Archaeology"
 01-15-04 Bartow-Pell Society; Bronx, NY: "The Lott House Archaeology Project"
 01-30-04 Malloy College; Rockville Center, NY: "The Archaeology of New York City"
 03-09-04 Fraunces Tavern; New York, NY: "The Archaeology of New York City"
 04-13-04 Oyster Bay Historical Society; Oyster Bay, NY: "The Lott House Archaeology Project"
 06-30-04 Woodhaven Historical Society; Queens, NY: "The Lott House Archaeology Project"
 07-12-04 Historic District Council/Architectural Institute of America Conference; New York, NY:
 "Archaeology and Preservation – Working Together"
 08-29-04 Sons of the American Revolution; Brooklyn, NY: "The Revolutionary War Project"
 10-22-04 City Hall Academy; New York, NY: "On Being An Archaeologist"
 11-08-04 BELHS High School; Bronx, NY: "On Being An Archaeologist"
 11-13-04 Hendrick I. Lott House; Brooklyn, New York: "Teacher Workshop-Archaeology"
 11-20-04 The Wyckoff House; Brooklyn, NY: "Teacher Workshop – Archaeology"
 12-02-04 City Hall Academy; New York, NY: "On Being An Archaeologist"
 01-12-05 City Hall Academy; New York, NY: "NYC Archaeology"
 01-20-05 City Hall Academy; New York, NY: "NYC in the Revolutionary War"
 02-20-05 Salt Marsh Nature Center; Brooklyn, NY: "Archaeology In Your Backyard"
 02-28-05 City Hall Academy; New York, NY: "NYC Archaeology and the Revolutionary War"
 05-23-05 Brooklyn College; Brooklyn, New York: "Archaeology and the Parks Department"
 06-11-05 Historic District Council; New York, NY: "Where Have All The Dutch Gone?"
 07-27-05 Hofstra University, New York: "Slavery at the Lott House"
 10-25-05 Fraunces Tavern Museum; New York, New York: "The Lott House"
 02-01-06 City Hall Academy; New York, NY: "NYC Archaeology and the Revolutionary War"
 02-27-06 City Hall Academy; New York, NY: "NYC Archaeology and the Revolutionary War"
 03-06-06 Salt Marsh Nature Center; Brooklyn, NY: "Dutch Brooklyn: Where Is Everyone?"

REFERENCES:

Professor H. Arthur Bankoff
Chairman of Anthropology/Archaeology
Brooklyn College
Bedford Avenue and Avenue H
Brooklyn, New York 11210
(718) 951-5507
abankoff@brooklyn.cuny.edu

Professor Christopher DeCorse
Department of Anthropology/Archaeology
209 Maxwell Hall
Syracuse University
Syracuse, New York 13244-1090
(315) 443-4647
cdecorse@maxwell.syr.edu

Professor Allan Gilbert
Department of Sociology and Anthropology
Rose Hill Campus - Dealy Hall, Room 407
Fordham University
441 East Fordham Road
Bronx, New York 10458
(718) 817-3850
Gilbert@fordham.edu

Charles Henkels, President
Hendrick I. Lott House Preservation Association
815 Greenwich Street – Apt. 4A
New York, New York
(212) 255-3352
henkels.arch@verizon.net

Mr. Leonard Houston, Chief – Environmental Branch
U.S. Army Corps of Engineers - Planning Division
Jacob K. Javits Federal Building
26 Federal Plaza – Room 2151
New York, New York 10278-0090
(212) 264-2122
leonard.houston@usace.army.mil

Dr. Fred Winter
Office of Challenge Grants
National Endowment for the Humanities
1000 Pennsylvania Avenue, NW - Room 420
Washington, DC 20506
(202) 606-8309
fwinter@neh.gov