

Filename: G:\Data3\5649301\Draw\Shoreline Protection A_B AND SECTIONS 1-2 (For Sorath)\5649301-9-Site Removals Plan-B.dwg Date: 12/11/2006 Time: 10:31 User: tfoester Style Table: Langansb Layout: Layout1

NOTES:

1. THE EXISTING INFORMATION ON THIS PLAN IS FROM A SURVEY TITLED "TOPOGRAPHIC SURVEY" BY LANGAN ENGINEERING AND ENVIRONMENTAL SERVICES, DATED NOVEMBER 15, 2005.
2. IT IS THE CONTRACTOR'S RESPONSIBILITY TO VERIFY ALL EXISTING SITE CONDITIONS, BOTH ABOVE AND BELOW THE SURFACE, PRIOR TO COMMENCING WORK. ANY DISCREPANCIES BETWEEN THE INFORMATION SHOWN ON THE DRAWINGS SHALL BE BROUGHT TO THE ATTENTION OF THE RESIDENT ENGINEER AND DPR IN WRITING PRIOR TO COMMENCING WORK.
3. THE CONTRACTOR SHALL COMPLY WITH ALL APPLICABLE CODES AND REGULATIONS GOVERNING THIS WORK. THE CONTRACTOR SHALL COORDINATE DEMOLITION WITH APPLICABLE AGENCIES, UTILITY COMPANIES, AND/OR SUB-CONTRACTORS.
4. IT IS MANDATORY, AS PER NYS INDUSTRIAL CODE RULE 53, FOR THE CONTRACTOR TO NOTIFY NEW YORK CITY/LONG ISLAND ONE-CALL CENTER, 36-35 BELL BOULEVARD, SUITE 202, BAYSIDE, NY 11361, TEL 800.272.4480, FAX 718.631.6723, EMAIL BSCHUETT@1-CALL.COM, IN ADDITION TO ALL UNDERGROUND FACILITY OPERATORS IN THE AREA WHO ARE NOT ONE-CALL MEMBERS, NOT LESS THAN TWO (2) FULL BUSINESS DAYS AND NOT MORE THAN TEN (10) FULL BUSINESS DAYS BEFORE COMMENCING EXCAVATION. THE ONE-CALL CENTER IS ALWAYS OPEN. THE ONE-CALL CENTER WILL THEN NOTIFY MEMBER FIRMS WITH OPERATIONS IN THE SITE AREA OF THE CONTRACTOR'S PENDING EXCAVATION OPERATIONS. THE CONTRACTOR WILL RECEIVE A NOTIFICATION TICKET FROM THE ONE-CALL CENTER WHICH SHOULD BE PRESENTED TO THE RESIDENT ENGINEER AS PROOF OF THE CALL. THERE IS NO CHARGE FOR THIS SERVICE. THIS PROCESS ENSURES THAT UTILITY SERVICE LINES ARE PROPERLY MARKED PRIOR TO EXCAVATION TO MINIMIZE FACILITY DAMAGE, ON THE JOB INJURIES, AND CONTRACTOR'S LIABILITY. MORE INFORMATION ABOUT THE ONE-CALL CENTER IS AVAILABLE ONLINE AT HTTP://WWW.NYCALL.CALLDSI.COM, WHICH INCLUDES A DESCRIPTION OF THE INFORMATION THAT CONTRACTOR WILL NEED WHEN MAKING THE CALL.
5. IT SHALL BE THE CONTRACTOR'S RESPONSIBILITY TO REPAIR ANY DAMAGE AND/OR RESTORE ANY INTERRUPTION TO ANY UTILITY SERVICE THAT MAY BE CAUSED BY THE CONTRACTOR'S CONSTRUCTION OR EQUIPMENT, AT THE CONTRACTOR'S EXPENSE, WITH NO ADDITIONAL EXPENSE TO THE CITY OF NEW YORK.
6. ALL EXISTING SEWER, GAS, WATER, AND ELECTRIC UTILITY LINES, AS WELL AS STRUCTURES WITHIN THE CONTRACT AREA SHALL REMAIN, UNLESS REMOVAL OF SAME IS SPECIFICALLY NOTED. ALL STORM DRAINAGE PIPES TO BE ABANDONED OR REMOVED ARE NOTED ON THE PLANS. IF ABANDONED PIPES ARE ENCOUNTERED DURING EXCAVATION, THEN THE CONTRACTOR SHALL REMOVE PIPE IN AREA OF EXCAVATION AND PLUG AT EACH END OF EXCAVATION. CONTRACTOR SHOULD ENSURE THAT PIPE REALLY IS ABANDONED BEFORE ATTEMPTING THIS OPERATION.
7. THE CONTRACTOR IS TO USE CARE DURING CONSTRUCTION TO AVOID DISTURBING OR DAMAGING ADJACENT ABOVE-GRADE OR SUBGRADE STRUCTURES, FACILITIES, CURBS, PAVEMENTS, AND PERIMETER FENCING. ANY DAMAGE RESULTING FROM THIS WORK WILL BE RESTORED TO THE SATISFACTION OF DPR AT THE CONTRACTOR'S EXPENSE.
8. WHERE NEW CONSTRUCTION ADJUTS EXISTING PAVEMENTS, CURBS, OR WALLS, THE EXISTING MATERIALS SHALL BE CLEANLY SAWCUT TO PROVIDE A CLEAN, NEAT MATCH AND A SMOOTH, FLUSH TRANSITION, AS DIRECTED BY THE RESIDENT ENGINEER. ALL SAWCUTTING SHALL BE DONE TO NEAT, STRAIGHT, AND ACCURATE LINES. CONTRACTOR SHALL PROVIDE EXPANSION JOINTS (TIE ROD AND/OR SLIP JOINT) WHERE OLD AND NEW CURBS MEET.

9. THE CONTRACTOR SHALL REPLACE ANY EXISTING CURBS, FENCING, OR PAVEMENTS THAT WERE INTENDED TO REMAIN BUT ARE DAMAGED OR DISTURBED DURING CONSTRUCTION. IF REPLACEMENT IS NECESSARY, IT SHALL BE DONE AT THE CONTRACTOR'S EXPENSE, TO THE SATISFACTION OF DPR AND THE RESIDENT ENGINEER.
10. THE CONTRACTOR SHALL TAKE EXTREME CARE TO PROTECT THE ROOT SYSTEMS OF EXISTING TREES. BULK MATERIAL, EQUIPMENT, OR VEHICLES SHALL NOT BE STOCKPILED OR PARKED WITHIN THE DRIPLINE OF ANY TREE.
11. SEE TREE PROTECTION AND VEHICLE ACCESS PLAN SHEETS 11 AND 12 FOR ADDITIONAL NOTES REGARDING PROTECTION, PRUNING AND DECOMPACTION OF EXISTING TREES.
12. WHEN NECESSARY, THE CONTRACTOR SHALL ALWAYS EXCAVATE BY HAND WITHIN THE DRIPLINE OF EXISTING TREES, OR AS DIRECTED BY THE RESIDENT ENGINEER.
13. IN AREAS DESIGNATED FOR EXCAVATION, ALL EXISTING PAVEMENTS, CURBS, AND CATCH BASINS SHALL BE REMOVED ACCORDING TO THE PLANS AND SPECIFICATIONS, AND AS DIRECTED BY THE RESIDENT ENGINEER.
14. ALL FOOTINGS AND OTHER BELOW-GRADE STRUCTURES TO BE REMOVED SHALL BE EXCAVATED TO A DEPTH OF 4'-0" BELOW FINISHED GRADE AND BACKFILLED WITH APPROVED SUITABLE FILL MATERIAL.
15. THE CONTRACTOR SHALL DISPOSE OF ALL ITEMS AND MATERIALS REMOVED AND NOT SALVAGED, INCLUDING ALL EXCAVATED MATERIAL, OFF-SITE AND IN A LEGAL MANNER.
16. THE CONTRACTOR IS RESPONSIBLE FOR OBTAINING ALL NECESSARY PERMITS FROM THE APPROPRIATE AGENCIES PRIOR TO COMMENCING WORK.
17. ALL MATERIALS TO BE SALVAGED FOR DPR MAINTENANCE & OPERATIONS (M&O) SHALL BE DELIVERED BY THE CONTRACTOR TO THE APPROPRIATE RECIPIENT. THE CONTRACTOR SHOULD CONTACT JOHN BACHMAN, CHIEF OF OPERATIONS 718-430-1812 PRIOR TO ANY DELIVERY. ALL MATERIALS NOT NEEDED BY M&O SHALL BE REMOVED AS INDICATED IN REMOVALS ITEM.
18. THE CONTRACTOR SHALL REMOVE, EXCAVATE, AND DISPOSE OF ALL MATERIALS ACCORDING TO SPECIFICATION.
19. CONTRACTOR SHALL OBTAIN ALL NECESSARY PERMITS, PAY ALL FEES, ETC. AS REQUIRED TO MAINTAIN AND PROTECT TRAFFIC FOR ON-STREET WORK.
20. CONTRACTOR SHALL VERIFY ALL SITE CONDITIONS ABOVE AND BELOW SURFACE PRIOR TO COMMENCING WORK. ANY DISCREPANCIES BETWEEN INFORMATION SHOWN ON THE DRAWING AND ACTUAL FIELD CONDITIONS SHALL BE BROUGHT TO THE ATTENTION OF THE RESIDENT ENGINEER AND DPR IN WRITING PRIOR TO COMMENCING WORK.
21. EXISTING ART PIECES TO BE REMOVED AND SALVAGED FOR BRONX RIVER ARTS CENTER (BRAC) USE. CONTRACTOR MUST CONTACT GAIL NATHAN OF BRAC AT (718)589-5819 TWO WEEKS IN ADVANCE FOR NECESSARY ARRANGMENTS TO SITE SALVAGED ART PIECES. ART PIECES DESIGNATED TO BE SALVAGED FOR BRAC USE WHICH ARE NOT NEEDED SHALL BE DISPOSED OF BY THE CONTRACTOR. TO BE PAID FOR UNDER REMOVALS.
22. PRIOR TO REMOVING THE ELECTRICAL BOXES, THE CONTRACTOR SHALL VERIFY THAT ALL ELECTRICAL BOXES TO BE REMOVED ARE ONLY FOR SERVICE TO THE LIGHT POLES TO BE REMOVED. IF THE ELECTRICAL BOXES ARE FOUND TO SERVICE ITEMS OTHER THAN THE LIGHT POLES TO BE REMOVED, THEN THE ELECTRICAL BOXES SHALL NOT BE REMOVED AND SHALL BE BROUGHT TO THE ATTENTION OF THE RESIDENT ENGINEER AND DPR IN WRITING.
23. CONTRACTOR TO RELOCATE OVERHEAD BRAC UTILITY SERVICE LINE UNDERGROUND. THE UTILITY LINE COMES OUT OF THE GROUND AT THE EXISTING UTILITY POLE, TRAVELS UP THE POLE, OVERHEAD TO THE CORNER OF THE BRAC BUILDING, ALONG THE OUTSIDE WALL OF THE BRAC BUILDING TO THE LOCATION CALLED OUT AS "APPROXIMATE ENTRY POINT FOR UTILITY CONDUIT," AND TRAVELS DOWN THE OUTSIDE WALL OF THE BRAC BUILDING AND INTO THE GROUND. THE ENTIRE LINE IS TO BE BURIED UNDERGROUND AND THE UTILITY POLE IS TO BE REMOVED. CONTRACTOR AND RESIDENT ENGINEER TO CONFIRM WITH BRAC PRIOR TO CONSTRUCTION AND SHALL COORDINATE WITH LOCAL UTILITY PROVIDER. SERVICES TO BRAC TO BE MAINTAINED THROUGHOUT CONSTRUCTION.
24. THE CONTRACTOR SHALL CONTACT JOHN McTIERNAN FROM THE DOT AT (718) 786-4738 TO ARRANGE FOR TESTING OF THE EXISTING LIGHTING SYSTEM PRIOR TO COMMENCEMENT OF CONSTRUCTION. ALL SUBSEQUENT DAMAGE TO THE DOT SYSTEM SHALL BE CORRECTED BY THE CONTRACTOR AT NO COST TO THE CITY.
25. FORESTER, NRG REPRESENTATIVE, AND RESIDENT ENGINEER SHALL BE ON SITE TO MARK TREES TO BE REMOVED.
26. SEE SHEET 15 FOR REMOVALS SCHEDULE.

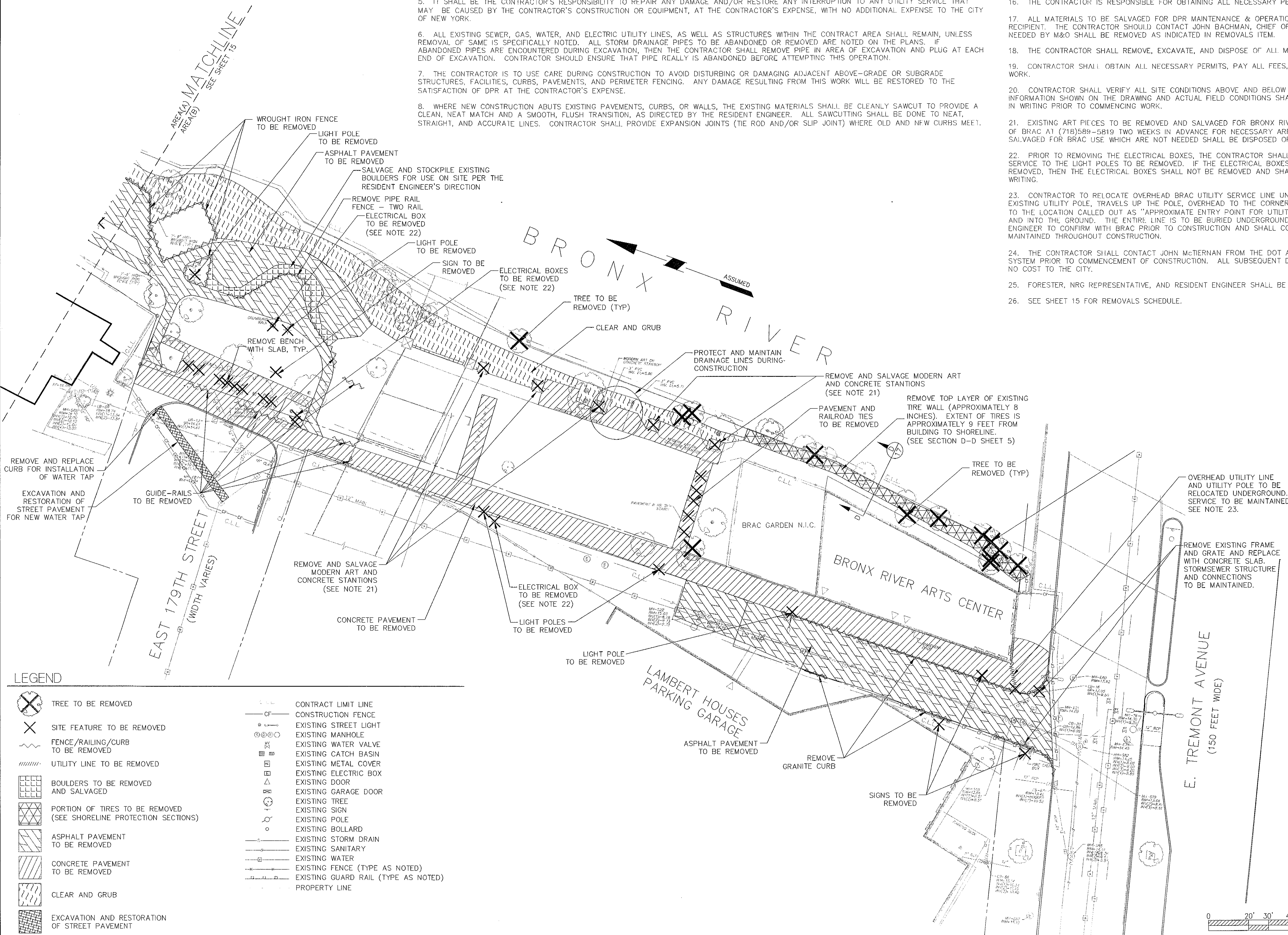

LEGEND

	TREE TO BE REMOVED		CONTRACT LIMIT LINE
	SITE FEATURE TO BE REMOVED		CONSTRUCTION FENCE
	FENCE/RAILING/CURB TO BE REMOVED		EXISTING STREET LIGHT
	UTILITY LINE TO BE REMOVED		EXISTING MANHOLE
	BOULDERS TO BE REMOVED AND SALVAGED		EXISTING WATER VALVE
	PORTION OF TIRES TO BE REMOVED (SEE SHORELINE PROTECTION SECTIONS)		EXISTING CATCH BASIN
	ASPHALT PAVEMENT TO BE REMOVED		EXISTING METAL COVER
	CONCRETE PAVEMENT TO BE REMOVED		EXISTING ELECTRIC BOX
	CLEAR AND GRUB		EXISTING DOOR
	EXCAVATION AND RESTORATION OF STREET PAVEMENT		EXISTING GARAGE DOOR
			EXISTING TREE
			EXISTING SIGN
			EXISTING POLE
			EXISTING BOLLARD
			EXISTING STORM DRAIN
			EXISTING SANITARY
			EXISTING WATER
			EXISTING FENCE (TYPE AS NOTED)
			EXISTING GUARD RAIL (TYPE AS NOTED)
			PROPERTY LINE

NO.	DATE	REVISION / SUBMITTAL
6	12/04/06	PERMITTING PLANS
5	11/10/06	FINAL SUBMISSION
4	08/23/06	100% REVISED SUBMISSION (PLAN CHANGE)
3	03/30/06	100% SUBMISSION
2	02/08/06	50% REVISED SUBMISSION (PLAN CHANGE)
1	12/08/05	50% REVIEW SUBMISSION

MARK K MORRISON ASSOCIATES LTD
 LANDSCAPE ARCHITECTURE
 242 WEST 30TH STREET, SUITE 405
 NEW YORK, NEW YORK, 10001
 212.629.9710 FAX: 212.629.9711
 www.markkmorrison.com

LANGAN
 ENGINEERING & ENVIRONMENTAL SERVICES
 21 Penn Plaza
 360 West 31st Street, 8th Floor
 New York, NY 10001-2727
 P: 212.479.5400 F: 212.479.5444
 www.langan.com
NEW JERSEY PENNSYLVANIA NEW YORK CONNECTICUT FLORIDA

City of New York
 Parks & Recreation

 Olmsted Center
 Flushing Meadows Corona Park
 Flushing, New York 11368

PROJECT TITLE:
THE RECONSTRUCTION OF BRONX RIVER (WEST FARMS) PARK, LOCATED AT EAST 179th STREET BETWEEN EAST 180th STREET AND EAST TREMONT AVENUE, BOROUGH OF BRONX (BLOCK 3141, LOTS 1, 14 & 17)

D.O.T. PIN# X550.45

DRAWING TITLE: **SITE REMOVALS PLAN - AREA (B)**

DESIGNED BY: KGB DRAWN BY: KGB CHECKED BY: DJH, JM, SK
 REVIEWED—TEAM LEADER APPROVED—DIRECTOR APPROVED—CHIEF OF DESIGN
 Raymundo Gomez, RLA David Carlson, RLA Charles McKinney

APPROVED—CHIEF ENGINEER CONTRACT NO. X288-102M
 JOHN J. NATOLI

THE ABOVE SIGNATURES DO NOT IN ANY WAY RELEASE THE CONSULTANTS FROM THEIR DUTY OF PRODUCING AN ACCURATE AND COMPLETE SET OF CONTRACT DOCUMENTS.

DATE: 11/10/06 SCALE: 1"=20' SHEET NO. 16 OF 17 SHEETS

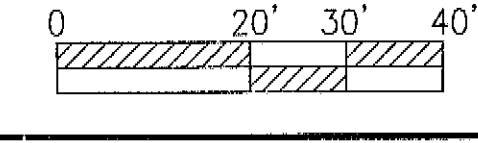

LEGEND

- TREE TO BE REMOVED
- SITE FEATURE TO BE REMOVED
- FENCE/RAILING/CURB TO BE REMOVED
- UTILITY LINE TO BE REMOVED
- ASPHALT PAVEMENT TO BE REMOVED
- CLEAR AND GRUB
- CONTRACT LIMIT LINE
- CONSTRUCTION FENCE
- EXISTING STREET LIGHT
- EXISTING MANHOLE
- EXISTING WATER VALVE
- EXISTING METAL COVER
- EXISTING TREE
- EXISTING SIGN
- EXISTING STORM DRAIN
- EXISTING WATER
- EXISTING FENCE (TYPE AS NOTED)
- PROPERTY LINE

REMOVALS SCHEDULE - AREA A AND AREA B
(QUANTITIES FOR REFERENCE ONLY)

SYMBOL	ITEM	QUANTITY TO BE REMOVED FROM SITE	QUANTITY TO BE SALVAGED FOR RE-USE	COMMENTS (PAID FOR UNDER)
	TREE	23 EA	---	"TREE REMOVAL OVER 6" TO 12" IN DIAMETER"
	TREE STUMP	5 EA	---	"STUMP REMOVAL OVER 6" TO 12" IN DIAMETER"
	LIGHT POLE	9 EA	---	"REMOVALS (N.T.E.)"
	BENCH	8 EA	---	"REMOVE BENCH WITH SLAB"
	MODERN ART AND CONCRETE STANTION	---	5 EA	"REMOVAL AND SALVAGE OF MODERN ART"
	SIGN	4 EA	---	"ITEMIZED REMOVALS (N.T.E.)"
	RAILROAD TIE	5 EA	---	"UNCLASSIFIED EXCAVATION"
	ELECTRICAL BOX	5 EA	---	"UNCLASSIFIED EXCAVATION"
	CATCH BASIN FRAME AND GRATE	2 EA	---	"REMOVALS (N.T.E.)"
	UTILITY POLE	1 EA	---	"REMOVALS (N.T.E.)"
	UTILITY LINE	13 LF	---	"REMOVALS (N.T.E.)"
	CHAIN LINK FENCE	253 SF	---	"REMOVE CHAIN LINK FENCE"
	WROUGHT IRON FENCE	1600 SF	---	"REMOVE STEEL FENCE"
	PIPE RAIL FENCE TWO RAIL	390 LF	---	"REMOVE PIPE RAIL FENCE - TWO RAIL"
	GUIDE-RAIL	84 LF	---	"ITEMIZED REMOVALS (N.T.E.)"
	GRANITE CURB	231 LF	---	"REMOVE CONCRETE CURB"
	BOULDERS	---	530 SF	"UNCLASSIFIED EXCAVATION"
	PORTION OF TIRES	1200 SF	---	"UNCLASSIFIED EXCAVATION" AND "ITEMIZED REMOVALS"
	ASPHALT PAVEMENT	11000 SF	---	"UNCLASSIFIED EXCAVATIONS"
	CONCRETE PAVEMENT	8700 SF	---	"UNCLASSIFIED EXCAVATIONS"
	CLEAR AND GRUB	9100 SF	---	"CLEAR AND GRUB"
	EXCAVATION AND RESTORATION OF STREET PAVEMENT	200 SF	---	"STREET RESTORATION OF STREET PAVEMENT" AND "UNCLASSIFIED EXCAVATIONS"

NOTES:

- THE EXISTING INFORMATION ON THIS PLAN IS FROM A SURVEY TITLED "TOPOGRAPHIC SURVEY" BY LANGAN ENGINEERING AND ENVIRONMENTAL SERVICES, DATED NOVEMBER 15, 2005.
- IT IS THE CONTRACTOR'S RESPONSIBILITY TO VERIFY ALL EXISTING SITE CONDITIONS, BOTH ABOVE AND BELOW THE SURFACE, PRIOR TO COMMENCING WORK. ANY DISCREPANCIES BETWEEN THE INFORMATION SHOWN ON THE DRAWINGS SHALL BE BROUGHT TO THE ATTENTION OF THE RESIDENT ENGINEER AND DPR IN WRITING PRIOR TO COMMENCING WORK.
- THE CONTRACTOR SHALL COMPLY WITH ALL APPLICABLE CODES AND REGULATIONS GOVERNING THIS WORK. THE CONTRACTOR SHALL COORDINATE DEMOLITION WITH APPLICABLE AGENCIES, UTILITY COMPANIES, AND/OR SUB-CONTRACTORS.
- IT IS MANDATORY, AS PER NYS INDUSTRIAL CODE RULE 53, FOR THE CONTRACTOR TO NOTIFY NEW YORK CITY/ONG ISLAND ONE-CALL CENTER, 36-35 BELLI BOULEVARD, SUITE 202, BAYSIDE, NY 11361, TEL 800.272.4480, FAX 718.631.6723, EMAIL BSCHUETT@1-CALL.COM, IN ADDITION TO ALL UNDERGROUND FACILITY OPERATORS IN THE AREA WHO ARE NOT ONE-CALL MEMBERS, NOT LESS THAN TWO (2) FULL BUSINESS DAYS AND NOT MORE THAN TEN (10) FULL BUSINESS DAYS BEFORE COMMENCING EXCAVATION. THE ONE-CALL CENTER IS ALWAYS OPEN. THE ONE-CALL CENTER WILL THEN NOTIFY MEMBER FIRMS WITH OPERATIONS IN THE SITE AREA OF THE CONTRACTOR'S PENDING EXCAVATION OPERATIONS. THE CONTRACTOR WILL RECEIVE A NOTIFICATION TICKET FROM THE ONE-CALL CENTER WHICH SHOULD BE PRESENTED TO THE RESIDENT ENGINEER AS PROOF OF THE CALL. THERE IS NO CHARGE FOR THIS SERVICE. THIS PROCESS ENSURES THAT UTILITY SERVICE LINES ARE PROPERLY MARKED PRIOR TO EXCAVATION TO MINIMIZE FACILITY DAMAGE, ON THE JOB INJURIES, AND CONTRACTOR'S LIABILITY. MORE INFORMATION ABOUT THE ONE-CALL CENTER IS AVAILABLE ONLINE AT HTTP://WWW.NYCALLCALLDSI.COM, WHICH INCLUDES A DESCRIPTION OF THE INFORMATION THAT CONTRACTOR WILL NEED WHEN MAKING THE CALL.
- IT SHALL BE THE CONTRACTOR'S RESPONSIBILITY TO REPAIR ANY DAMAGE AND/OR RESTORE ANY INTERRUPTION TO ANY UTILITY SERVICE THAT MAY BE CAUSED BY THE CONTRACTOR'S CONSTRUCTION OR EQUIPMENT, AT THE CONTRACTOR'S EXPENSE, WITH NO ADDITIONAL EXPENSE TO THE CITY OF NEW YORK.
- ALL EXISTING SEWER, GAS, WATER, AND ELECTRIC UTILITY LINES, AS WELL AS STRUCTURES WITHIN THE CONTRACT AREA SHALL REMAIN, UNLESS REMOVAL OF SAME IS SPECIFICALLY NOTED. ALL STORM DRAINAGE PIPES TO BE ABANDONED OR REMOVED ARE NOTED ON THE PLANS. IF ABANDONED PIPES ARE ENCOUNTERED DURING EXCAVATION, THEN THE CONTRACTOR SHALL REMOVE PIPE IN AREA OF EXCAVATION AND PLUG AT EACH END OF EXCAVATION. CONTRACTOR SHOULD ENSURE THAT PIPE REALLY IS ABANDONED BEFORE ATTEMPTING THIS OPERATION.
- THE CONTRACTOR IS TO USE CARE DURING CONSTRUCTION TO AVOID DISTURBING OR DAMAGING ADJACENT ABOVE-GRADE OR SUBGRADE STRUCTURES, FACILITIES, CURBS, PAVEMENTS, AND PERIMETER FENCING. ANY DAMAGE RESULTING FROM THIS WORK WILL BE RESTORED TO THE SATISFACTION OF DPR AT THE CONTRACTOR'S EXPENSE.
- WHERE NEW CONSTRUCTION ABUTS EXISTING PAVEMENTS, CURBS, OR WALLS, THE EXISTING MATERIALS SHALL BE CLEANLY SAWCUT TO PROVIDE A CLEAN, NEAT MATCH AND A SMOOTH, FLUSH TRANSITION, AS DIRECTED BY THE RESIDENT ENGINEER. ALL SAWCUTTING SHALL BE DONE TO NEAT, STRAIGHT, AND ACCURATE LINES. CONTRACTOR SHALL PROVIDE EXPANSION JOINTS (TIE ROD AND/OR SLIP JOINT) WHERE OLD AND NEW CURBS MEET.
- THE CONTRACTOR SHALL REPLACE ANY EXISTING CURBS, FENCING, OR PAVEMENTS THAT WERE INTENDED TO REMAIN BUT ARE DAMAGED OR DISTURBED DURING CONSTRUCTION. IF REPLACEMENT IS NECESSARY, IT SHALL BE DONE AT THE CONTRACTOR'S EXPENSE, TO THE SATISFACTION OF DPR AND THE RESIDENT ENGINEER.
- THE CONTRACTOR SHALL TAKE EXTREME CARE TO PROTECT THE ROOT SYSTEMS OF EXISTING TREES. BULK MATERIAL, EQUIPMENT, OR VEHICLES SHALL NOT BE STOCKPILED OR PARKED WITHIN THE DRIPLINE OF ANY TREE.
- SEE TREE PROTECTION AND VEHICLE ACCESS PLAN SHEETS 11 AND 12 FOR ADDITIONAL NOTES REGARDING PROTECTION, PRUNING AND DECOMPACTION OF EXISTING TREES.
- WHEN NECESSARY, THE CONTRACTOR SHALL ALWAYS EXCAVATE BY HAND WITHIN THE DRIPLINE OF EXISTING TREES, OR AS DIRECTED BY THE RESIDENT ENGINEER.
- IN AREAS DESIGNATED FOR EXCAVATION, ALL EXISTING PAVEMENTS, CURBS, AND CATCH BASINS SHALL BE REMOVED ACCORDING TO THE PLANS AND SPECIFICATIONS, AND AS DIRECTED BY THE RESIDENT ENGINEER.
- ALL FOOTINGS AND OTHER BELOW-GRADE STRUCTURES TO BE REMOVED SHALL BE EXCAVATED TO A DEPTH OF 4'-0" BELOW FINISHED GRADE AND BACKFILLED WITH APPROVED SUITABLE FILL MATERIAL.
- THE CONTRACTOR SHALL DISPOSE OF ALL ITEMS AND MATERIALS REMOVED AND NOT SALVAGED, INCLUDING ALL EXCAVATED MATERIAL, OFF-SITE AND IN A LEGAL MANNER.
- THE CONTRACTOR IS RESPONSIBLE FOR OBTAINING ALL NECESSARY PERMITS FROM THE APPROPRIATE AGENCIES PRIOR TO COMMENCING WORK.
- ALL MATERIALS TO BE SALVAGED FOR DPR MAINTENANCE & OPERATIONS (M&O) SHALL BE DELIVERED BY THE CONTRACTOR TO THE APPROPRIATE RECIPIENT. THE CONTRACTOR SHOULD CONTACT JOHN BACHMAN, CHIEF OF OPERATIONS 718-430-1812 PRIOR TO ANY DELIVERY. ALL MATERIALS NOT NEEDED BY M&O SHALL BE REMOVED AS INDICATED IN REMOVALS ITEM.
- THE CONTRACTOR SHALL REMOVE, EXCAVATE, AND DISPOSE OF ALL MATERIALS ACCORDING TO SPECIFICATION.
- CONTRACTOR SHALL OBTAIN ALL NECESSARY PERMITS, PAY ALL FEES, ETC. AS REQUIRED TO MAINTAIN AND PROTECT TRAFFIC FOR ON-STREET WORK.
- CONTRACTOR SHALL VERIFY ALL SITE CONDITIONS ABOVE AND BELOW SURFACE PRIOR TO COMMENCING WORK. ANY DISCREPANCIES BETWEEN INFORMATION SHOWN ON THE DRAWING AND ACTUAL FIELD CONDITIONS SHALL BE BROUGHT TO THE ATTENTION OF THE RESIDENT ENGINEER AND DPR IN WRITING PRIOR TO COMMENCING WORK.
- EXISTING ART PIECES TO BE REMOVED AND SALVAGED FOR BRONX RIVER ARTS CENTER (BRAC) USE. CONTRACTOR MUST CONTACT GAIL NATHAN OF BRAC AT (718)589-5819 TWO WEEKS IN ADVANCE FOR NECESSARY ARRANGMENTS TO SITE SALVAGED ART PIECES. ART PIECES DESIGNATED TO BE SALVAGED FOR BRAC USE WHICH ARE NOT NEEDED SHALL BE DISPOSED OF BY THE CONTRACTOR. TO BE PAID FOR UNDER REMOVALS.
- PRIOR TO REMOVING THE ELECTRICAL BOXES, THE CONTRACTOR SHALL VERIFY THAT ALL ELECTRICAL BOXES TO BE REMOVED ARE ONLY FOR SERVICE TO THE LIGHT POLES TO BE REMOVED. IF THE ELECTRICAL BOXES ARE FOUND TO SERVICE ITEMS OTHER THAN THE LIGHT POLES TO BE REMOVED, THEN THE ELECTRICAL BOXES SHALL NOT BE REMOVED AND SHALL BE BROUGHT TO THE ATTENTION OF THE RESIDENT ENGINEER AND DPR IN WRITING.
- CONTRACTOR TO RELOCATE OVERHEAD BRAC UTILITY SERVICE LINE UNDERGROUND. THE UTILITY LINE COMES OUT OF THE GROUND AT THE EXISTING UTILITY POLE, TRAVELS UP THE POLE, OVERHEAD TO THE CORNER OF THE BRAC BUILDING, ALONG THE OUTSIDE WALL OF THE BRAC BUILDING TO THE LOCATION CALLED OUT AS "APPROXIMATE ENTRY POINT FOR UTILITY CONDUIT," AND TRAVELS DOWN THE OUTSIDE WALL OF THE BRAC BUILDING AND INTO THE GROUND. THE ENTIRE LINE IS TO BE BURIED UNDERGROUND AND THE UTILITY POLE IS TO BE REMOVED. CONTRACTOR AND RESIDENT ENGINEER TO CONFIRM WITH BRAC PRIOR TO CONSTRUCTION AND SHALL COORDINATE WITH LOCAL UTILITY PROVIDER. SERVICES TO BRAC TO BE MAINTAINED THROUGHOUT CONSTRUCTION.
- THE CONTRACTOR SHALL CONTACT JOHN McTIERNAN FROM THE DOT AT (718) 786-4738 TO ARRANGE FOR TESTING OF THE EXISTING LIGHTING SYSTEM PRIOR TO COMMENCEMENT OF CONSTRUCTION. ALL SUBSEQUENT DAMAGE TO THE DOT SYSTEM SHALL BE CORRECTED BY THE CONTRACTOR AT NO COST TO THE CITY.
- FORESTER, NRG REPRESENTATIVE, AND RESIDENT ENGINEER SHALL BE ON SITE TO MARK TREES TO BE REMOVED.

NO.	DATE	REVISION / SUBMITTAL
6	12/04/06	PERMITTING PLANS
5	11/10/06	FINAL SUBMISSION
4	08/23/06	100% REVISED SUBMISSION (PLAN CHANGE)
3	03/30/06	100% SUBMISSION
2	02/08/06	50% REVISED SUBMISSION (PLAN CHANGE)
1	12/08/05	50% REVIEW SUBMISSION

MARK K MORRISON ASSOCIATES LTD
LANDSCAPE ARCHITECTURE
242 WEST 30TH STREET SUITE 403
NEW YORK, NEW YORK, 10001
212.629.9710 FAX: 212.629.9711
www.markmorrison.com

LANGAN
ENGINEERING & ENVIRONMENTAL SERVICES
21 Penn Plaza
360 West 31st Street, 8th Floor
New York, NY 10001-2723
P: 212.479.5400 F: 212.479.5444
www.langan.com
NEW JERSEY PENNSYLVANIA NEW YORK CONNECTICUT FLORIDA

City of New York
Parks & Recreation
Olmsted Center
Flushing Meadows Corona Park
Flushing, New York 11368

PROJECT TITLE:
THE RECONSTRUCTION OF BRONX RIVER (WEST FARMS) PARK, LOCATED AT EAST 179th STREET BETWEEN EAST 180th STREET AND EAST TREMONT AVENUE, BOROUGH OF BRONX (BLOCK 3141, LOTS 1, 14 & 17)

D.O.T. PIN# X550.45

DRAWING TITLE: **SITE REMOVALS PLAN - AREA(A)**

DESIGNED BY: KBC DRAWN BY: KBC CHECKED BY: DJH, JM, SK
REVIEWED-TEAM LEADER APPROVED-DIRECTOR APPROVED-CHIEF OF DESIGN
Raymundo Gomez, RLA David Carlson, RLA Charles McKinney

APPROVED-CHIEF ENGINEER CONTRACT NO. X288-102M
JOHN J. NATOLI

THE ABOVE SIGNATURES DO NOT IN ANY WAY RELEASE THE CONSULTANTS FROM THEIR DUTY OF PRODUCING AN ACCURATE AND COMPLETE SET OF CONTRACT DOCUMENTS.
DATE: 11/10/06 SCALE: 1"=20' SHEET NO. 15 OF 17 SHEETS

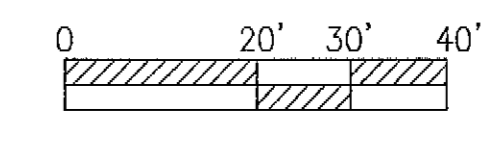
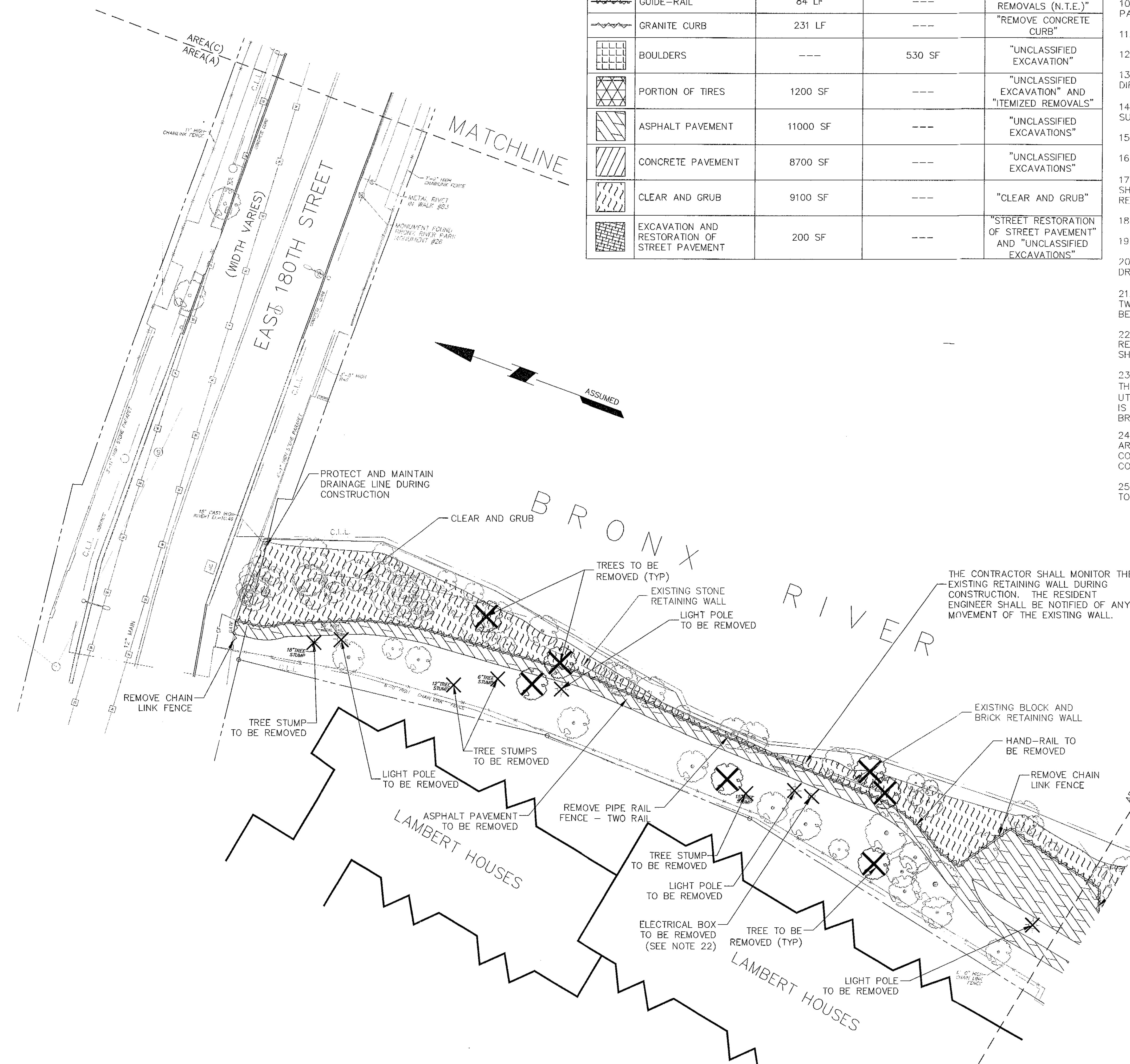

Filename: G:\data\3\649307\Draw Data - 649307.dwg Date: 12/11/2006 Time: 10:32 User: ftear Date: 12/11/2006 Plot: 12/11/2006 10:32:00

File name: G:\Data\35-09-01\Spec Data - 5649301\Drawings\Soil\Soil Protection - 4, B AND SECTIONS 1-2 For Borehole 5649301-35-09-01-2.dwg Date: 12/7/2006 Time: 10:30 AM User: Mester, Shay Taber, Langr, etc Layout: 4-2.dwg

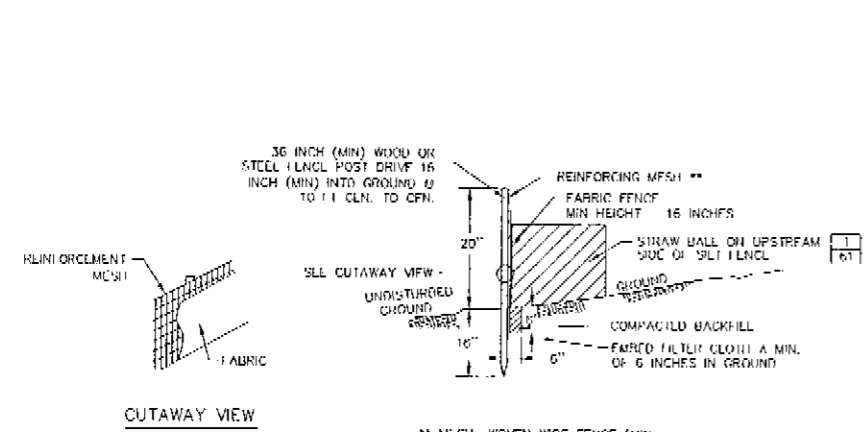

- NOTES:**
- WOVEN WIRE FENCE TO BE FASTENED SECURELY TO FENCE POSTS WITH WIRE TIES OR STAPLES. POSTS SHALL BE STEEL EITHER "T" OR "U" TYPE, OR HARDWOOD.
 - FILTER CLOTH TO BE FASTENED SECURELY TO WOVEN WIRE FENCE WITH TIES SPACED EVERY 24" AT TOP AND MID SECTION. FENCE SHALL BE WOVEN WIRE, 12 1/2 GAUGE, 6" MAXIMUM MESH OPENING.
 - WHEN TWO SECTIONS OF FILTER CLOTH ADJOIN EACH OTHER THEY SHALL BE OVERLAPPED BY SIX INCHES AND FOLDED. FILTER CLOTH SHALL BE EITHER FILTER X, MIRA 100X, STABILINKA T140N, OR APPROVED EQUIV.
 - UNSATURATED UNITS SHALL BE GRAVEL, SANDSTONE, OR APPROVED EQUAL.
 - MAINTENANCE SHALL BE PERFORMED AS NEEDED AND MATERIAL REMOVED WITH RAKE/S. DEVELOP IN THE SILT FENCE.
 - SEDIMENT MUST BE REMOVED WHEN ACCUMULATIONS REACH 1/2 THE ABOVE GROUND HEIGHT OF THE SILT FENCING.

1 SILT FENCE NOT TO SCALE

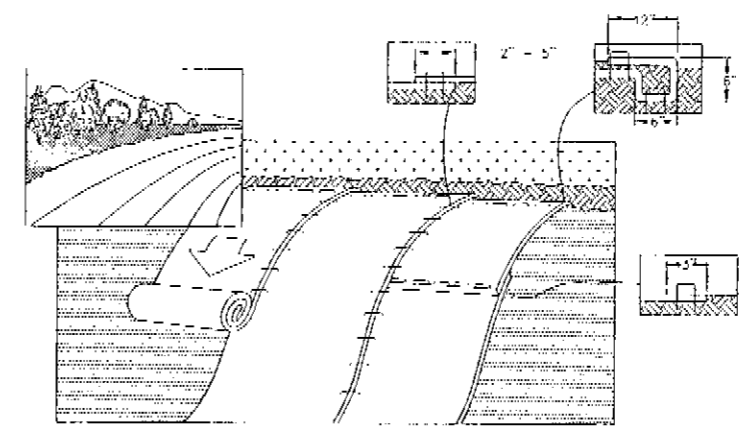

- NOTES:**
- FINE GRADE SOIL AND PLACE 2" OF STRAW MULCH ON GROUND BEFORE INSTALLING ROLLED EROSION CONTROL PRODUCTS (RECP'S). INCLUDE ANY NECESSARY APPLICATION OF LIME, FERTILIZER, AND SEED. NOTE: WHEN USING CULL-O-SEED DO NOT SEED PREPARED MULCH. CULL-O-SEED MUST BE INSTALLED WITH FINDER ROLL DOWN.
 - UNROLL AT THE TOP OF THE SLOPE BY ANCHORING THE RECP'S IN A 6" DEEP X 6" WIDE TRENCH WITH APPROXIMATELY 12" OF RECP'S EXTENDED BEYOND THE UP-SLOPE PORTION OF THE TRENCH. ANCHOR THE RECP'S WITH A ROW OF "U" STAPLES APPROXIMATELY 12" APART IN THE BOTTOM OF THE TRENCH. BACKFILL AND COMPACT THE TRENCH AFTER STAPLING. APPLY SILL TO COMPACTED SOIL AND FOLD REMAINING 12" PORTION OF RECP'S BACK OVER SEED AND COMPACTED SOIL. SECURE RECP'S OVER COMPACTED SOIL WITH A ROW OF "U" STAPLES SPACED APPROXIMATELY 12" APART ACROSS THE WIDTH OF THE RECP'S.
 - ROLL THE RECP'S (A.) DOWN OR (B.) HORIZONTALLY ACROSS THE SLOPE. RECP'S WILL UNROLL WITH APPROPRIATE SIDE AGAINST THE SOIL SURFACE. ALL RECP'S MUST BE SECURELY FASTENED TO SOIL SURFACE BY PLACING "U" STAPLES IN APPROPRIATE LOCATIONS AS SHOWN IN THE STAPLE PATTERN GUIDE. WHEN USING THE DUE SYSTEM "U" STAPLES SHOULD BE PLACED THROUGH EACH OF THE COLORED DOTS CORRESPONDING TO THE APPROPRIATE STAPLE PATTERN.
 - THE JOINTS OF PARALLEL RECP'S MUST BE STAPLED WITH APPROXIMATELY 2" - 5" OVERLAP DEPENDING ON RECP'S WIDTH. NOTE: IN LOOSE SOIL CONDITIONS, THE USE OF STAPLE OR STAKE LENGTHS GREATER THAN 6" MAY BE NECESSARY TO PROPERLY SECURE THE RECP'S.

2 INSTALLATION FOR EROSION CONTROL BLANKET NOT TO SCALE

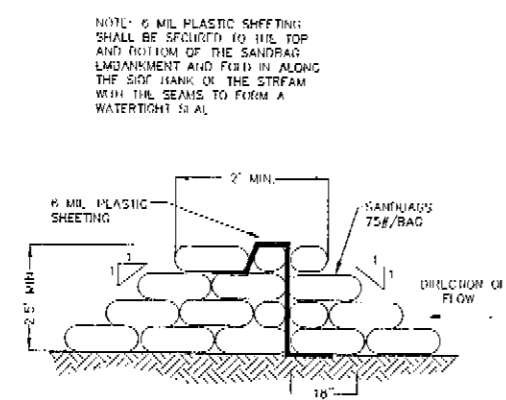

3 SANDBAG COFFERDAM NOT TO SCALE

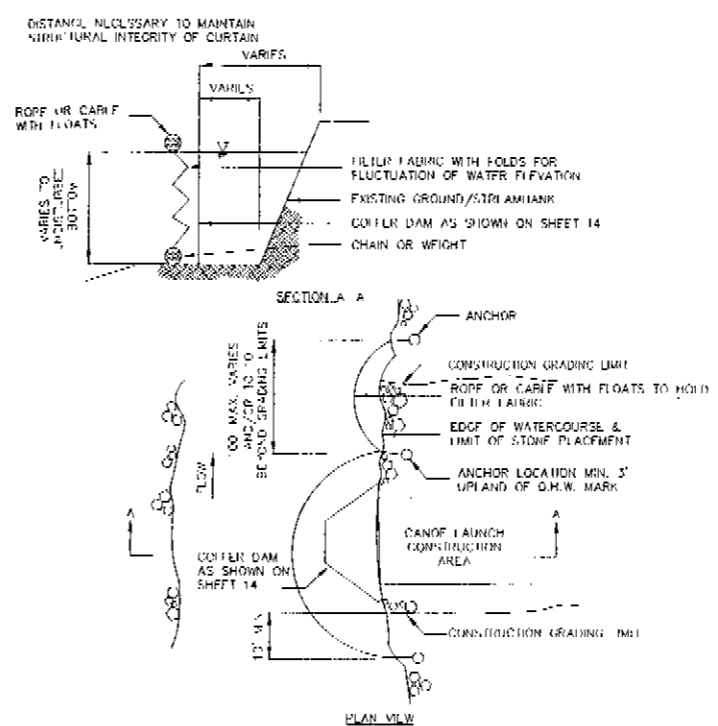

4 FLOATING BOOM WITH SILT CURTAIN NOT TO SCALE

NO.	DATE	DESCRIPTION
5	12/04/06	PERMITTING PLANS
4	11/10/06	FINAL SUBMISSION
3	08/23/06	100% REVISED SUBMISSION (PLAN CHANGE)
2	03/30/06	100% SUBMISSION
1	02/06/06	NOI IN VIEW SUBMISSION (PLAN CHANGE)
0	12/06/05	NOI IN VIEW SUBMISSION REVISION / SUBMITTAL

MARK K MORRISON ASSOCIATES LTD
 LANDSCAPE ARCHITECTURE
 242 W 34th Street, 8th Floor
 New York, NY 10001-2227
 P: 212.470.5400 F: 212.470.5444
 www.mkmorrison.com

LANGAN
 ENVIRONMENTAL CONSULTANTS & ENGINEERS
 21 Park Plaza
 100 West 31st Street, 8th Floor
 New York, NY 10001-2227
 P: 212.470.5400 F: 212.470.5444
 www.langan.com

City of New York
Parks & Recreation
 Olmsted Center
 Flushing Meadows-Corona Park
 Flushing, New York 11368

PROJECT TITLE:
 THE RECONSTRUCTION OF BRONX RIVER (WEST FARMS) PARK, LOCATED AT EAST 179th STREET BETWEEN EAST 180th STREET AND EAST TREMONT AVENUE, BOROUGH OF BRONX (BLOCK 3141, LOTS 1, 14 & 17)

D.O.T. PIN# X55045
DRAWING TITLE: DETAILS - 2

DESIGNED BY: KRG	DRAWN BY: KRG	CHECKED BY: DJM, JMS
REVIEWED - TEAM LEADER: Raymundo Gomez, RIA	APPROVED DIRECTOR: David Gulsion, RIA	APPROVED CHIEF OF DESIGN: Charles McKinney
APPROVED CHIEF ENGINEER: JOHN J. NAJORE	CONTRACT NO. X288-102M	

THE ABOVE SIGNATURES DO NOT IN ANY WAY RELEASE THE CONSULTANTS FROM THEIR DUTY OF PROVIDING AN ACCURATE AND COMPLETE SET OF CONTRACT DOCUMENTS.

DATE 11/10/06 SCALE N.T.S. SHEET NO. 17 OF 17 SHEETS

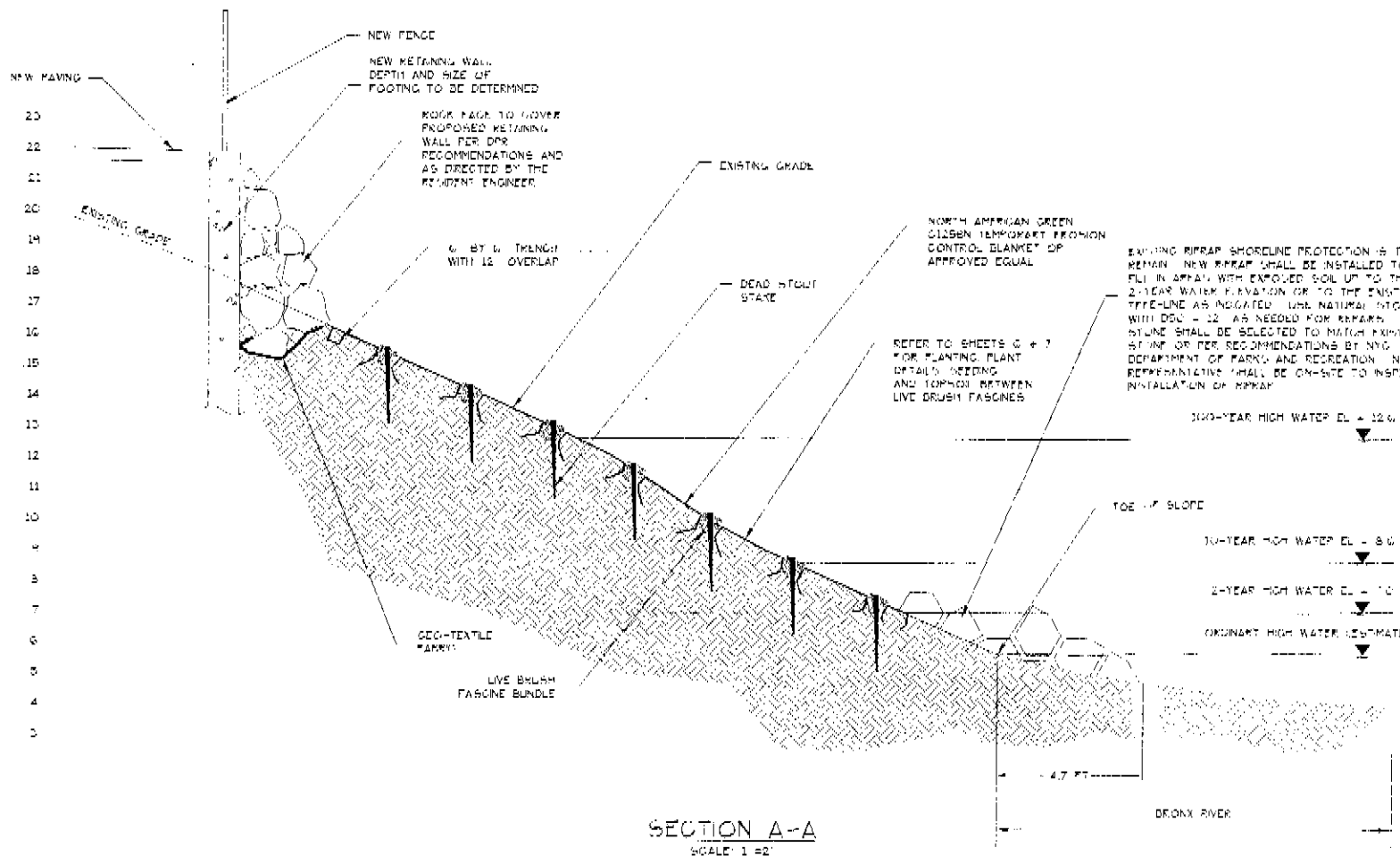

SECTION A-A
SCALE: 1"=2'

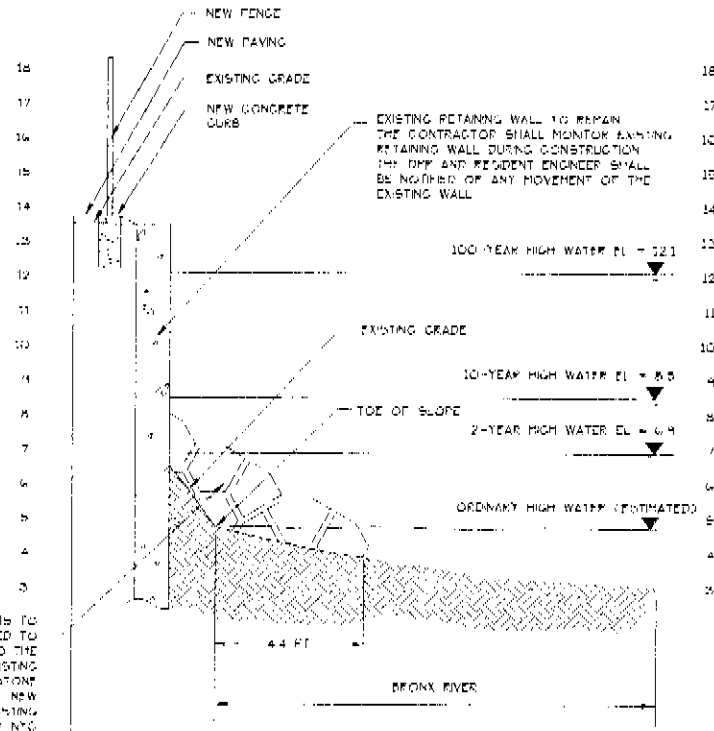

SECTION B-B
SCALE: 1"=2'

20 LIVE BRUSH FASCINE NOTES

- 22 CONSTRUCTION GUIDELINES:
 23 LIVE MATERIALS - CUTTINGS MUST BE FROM SPECIES THAT ROOT FAMILY
 24 AND HAVE LONG STRAIGHT BRANCHES
- 25 NATURAL RESOURCES GROUP REPRESENTATIVE SHALL BE ON-SITE TO
 26 ASSIST INSTALLATION OF LIVE FASCINES
- 27 LIVE MATERIAL PREPARATION:
 28 1. CUTTINGS AND TOGETHER TO FORM LIVE BRUSH FASCINE BUNDLES
 29 ARE TO BE 8 FEET IN LENGTH OR LONGER DEPENDING ON SITE
 30 CONDITIONS AND LIMITATIONS IN HANDLING. CUTTINGS ARE TO BE 1/4
 31 TO 3/4" IN DIAMETER
- 32 2. THE COMPLETED BUNDLES SHALL BE 8 INCHES IN DIAMETER WITH ALL
 33 OF THE GROWING TOPS ORIENTED IN THE SAME DIRECTION. STAGGER THE
 34 CUTTINGS IN THE BUNDLES SO THAT TOPS ARE EVENLY DISTRIBUTED
 35 THROUGHOUT THE LENGTH OF THE UNIFORMLY USED LIVE FASCINE
- 36 3. LIVE MATERIALS TO BE INSTALLED SAME DAY THEY ARE PREPARED
- 37 INERT MATERIAL PREPARATION:
 38 1. CUTTINGS USED FOR BUNDLING SHALL BE UNTREATED TWINE
 39 2. DEAD STOUT STAKES USED TO SECURE THE LIVE BRUSH FASCINES
 40 SHALL BE 3-FOOT UNTREATED 2" BY 2" LUMBER. EACH LENGTH SHALL
 41 BE CUT DIAGONALLY ACROSS THE 4" END FACE TO MAKE TWO STAKES
 42 FROM EACH 3-FOOT LENGTH. ONLY NEW SOUND LUMBER SHALL BE
 43 USED AND ANY DEAD STOUT STAKES THAT SHATTER UPON INSTALLATION
 44 SHALL BE DISCARDED AND REPLACED
- 45 INSTALLATION:
 46 1. PREPARE THE LIVE BRUSH FASCINE BUNDLE AND LIVE STAKE
 47 IMMEDIATELY BEFORE INSTALLATION
 48 2. BEGINNING AT THE BASE OF THE INFLUENCE OF RIPRAP, DIG A
 49 TRENCH ON THE CONTOUR APPROXIMATELY 4 TO 6 INCHES WIDE AND
 50 DEEP
 51 3. EXCAVATE TRENCHES UP THE SLOPE AT 5 FOOT INTERVALS FOR 3:1
 52 SLOPES OR FLATTER. EXCAVATE TRENCHES UP THE SLOPE AT 3 FOOT
 53 INTERVALS FOR SLOPES STEEPER THAN 3:1
 54 4. PLACE LONG STAKE AND ANCHOR BRASS/STAPLE BETWEEN ROWS
 55 5. INSTALL AND SECURE THE EROSION CONTROL BLANKET AS SPECIFIED
 56 ON THE DETAIL SHEET
 57 6. PLACE THE LIVE BRUSH FASCINE INTO THE TRENCH LEAVING
 58 APPROXIMATELY 1/4 OF THE LIVE FASCINE ABOVE GRADE
 59 7. DRIVE THE DEAD STOUT STAKES DIRECTLY THROUGH LIVE BRUSH
 60 FASCINE USING A 2" TO 3" FOOT HEADING. EXTRA STAKES SHOULD BE
 61 USED AT CONNECTIONS OR BUNDLE OVERLAPS. LEAVE THE TOP OF THE
 62 DEAD STOUT STAKES FLUSH WITH THE INSTALLED BUNDLE
 63 8. PLACE MOIST SOIL ALONG SIDES OF THE BUNDLE. THE TOP OF
 64 THE LIVE BRUSH FASCINE SHOULD BE VISIBLE WHEN THE INSTALLATION IS
 65 COMPLETED

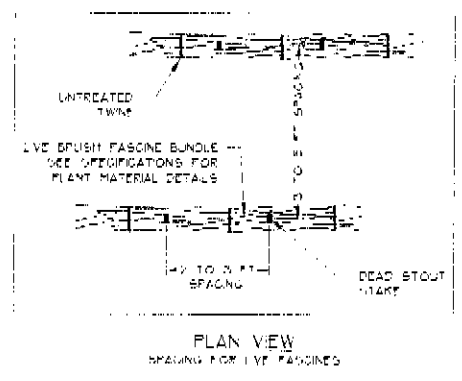

NO.	DATE	DESCRIPTION
1	11/15/05	PRELIMINARY PLAN
2	12/15/05	REVISED PLAN
3	02/22/06	REVISED SUBMITTAL (REVISION 1)
4	03/22/06	100% SUBMITTAL
5	05/15/06	REVISED PLAN
6	07/15/06	REVISED PLAN
7	08/15/06	REVISED PLAN
8	09/15/06	REVISED PLAN
9	10/15/06	REVISED PLAN
10	11/15/06	REVISED PLAN
11	12/15/06	REVISED PLAN
12	01/15/07	REVISED PLAN
13	02/15/07	REVISED PLAN
14	03/15/07	REVISED PLAN
15	04/15/07	REVISED PLAN
16	05/15/07	REVISED PLAN
17	06/15/07	REVISED PLAN
18	07/15/07	REVISED PLAN
19	08/15/07	REVISED PLAN
20	09/15/07	REVISED PLAN
21	10/15/07	REVISED PLAN
22	11/15/07	REVISED PLAN
23	12/15/07	REVISED PLAN
24	01/15/08	REVISED PLAN
25	02/15/08	REVISED PLAN
26	03/15/08	REVISED PLAN
27	04/15/08	REVISED PLAN
28	05/15/08	REVISED PLAN
29	06/15/08	REVISED PLAN
30	07/15/08	REVISED PLAN
31	08/15/08	REVISED PLAN
32	09/15/08	REVISED PLAN
33	10/15/08	REVISED PLAN
34	11/15/08	REVISED PLAN
35	12/15/08	REVISED PLAN
36	01/15/09	REVISED PLAN
37	02/15/09	REVISED PLAN
38	03/15/09	REVISED PLAN
39	04/15/09	REVISED PLAN
40	05/15/09	REVISED PLAN
41	06/15/09	REVISED PLAN
42	07/15/09	REVISED PLAN
43	08/15/09	REVISED PLAN
44	09/15/09	REVISED PLAN
45	10/15/09	REVISED PLAN
46	11/15/09	REVISED PLAN
47	12/15/09	REVISED PLAN
48	01/15/10	REVISED PLAN
49	02/15/10	REVISED PLAN
50	03/15/10	REVISED PLAN
51	04/15/10	REVISED PLAN
52	05/15/10	REVISED PLAN
53	06/15/10	REVISED PLAN
54	07/15/10	REVISED PLAN
55	08/15/10	REVISED PLAN
56	09/15/10	REVISED PLAN
57	10/15/10	REVISED PLAN
58	11/15/10	REVISED PLAN
59	12/15/10	REVISED PLAN
60	01/15/11	REVISED PLAN
61	02/15/11	REVISED PLAN
62	03/15/11	REVISED PLAN
63	04/15/11	REVISED PLAN
64	05/15/11	REVISED PLAN
65	06/15/11	REVISED PLAN
66	07/15/11	REVISED PLAN
67	08/15/11	REVISED PLAN
68	09/15/11	REVISED PLAN
69	10/15/11	REVISED PLAN
70	11/15/11	REVISED PLAN
71	12/15/11	REVISED PLAN
72	01/15/12	REVISED PLAN
73	02/15/12	REVISED PLAN
74	03/15/12	REVISED PLAN
75	04/15/12	REVISED PLAN
76	05/15/12	REVISED PLAN
77	06/15/12	REVISED PLAN
78	07/15/12	REVISED PLAN
79	08/15/12	REVISED PLAN
80	09/15/12	REVISED PLAN
81	10/15/12	REVISED PLAN
82	11/15/12	REVISED PLAN
83	12/15/12	REVISED PLAN
84	01/15/13	REVISED PLAN
85	02/15/13	REVISED PLAN
86	03/15/13	REVISED PLAN
87	04/15/13	REVISED PLAN
88	05/15/13	REVISED PLAN
89	06/15/13	REVISED PLAN
90	07/15/13	REVISED PLAN
91	08/15/13	REVISED PLAN
92	09/15/13	REVISED PLAN
93	10/15/13	REVISED PLAN
94	11/15/13	REVISED PLAN
95	12/15/13	REVISED PLAN
96	01/15/14	REVISED PLAN
97	02/15/14	REVISED PLAN
98	03/15/14	REVISED PLAN
99	04/15/14	REVISED PLAN
100	05/15/14	REVISED PLAN

MARK MORRISON ASSOCIATES LTD
 LANDSCAPE ARCHITECTURE
 110 WEST 40TH STREET, 10TH FLOOR
 NEW YORK, NY 10018-3601
 TEL: 212 693 1234 FAX: 212 693 1235
 WWW.MORRISONASSOCIATES.COM

LANGAN
 ENGINEERING AND ARCHITECTURE
 21 West Street, 21st Floor
 New York, NY 10006-2022
 P: 212 693 1234 F: 212 693 1235
 WWW.LANGAN.COM

City of New York
 Parks & Recreation
 Donaldson Center
 110 West 40th Street, 10th Floor
 New York, NY 10018-3601

PROJECT TITLE
THE RECONSTRUCTION OF BRONX RIVER (WEST FARMS) PARK, LOCATED AT EAST 179th STREET BETWEEN EAST 180th STREET AND EAST TREMONT AVENUE, BOROUGH OF BRONX (BLOCK 3141, LOTS 1, 14 & 17)

02.01 FIG# X550.15

DRAWING TITLE **SHORELINE PROTECTION SECTIONS - 1**

DESIGNED BY: RCF DRAWN BY: JRC CHECKED BY: JML

APPROVED BY: JML

DATE: 11/15/06 SCALE: 1"=2'



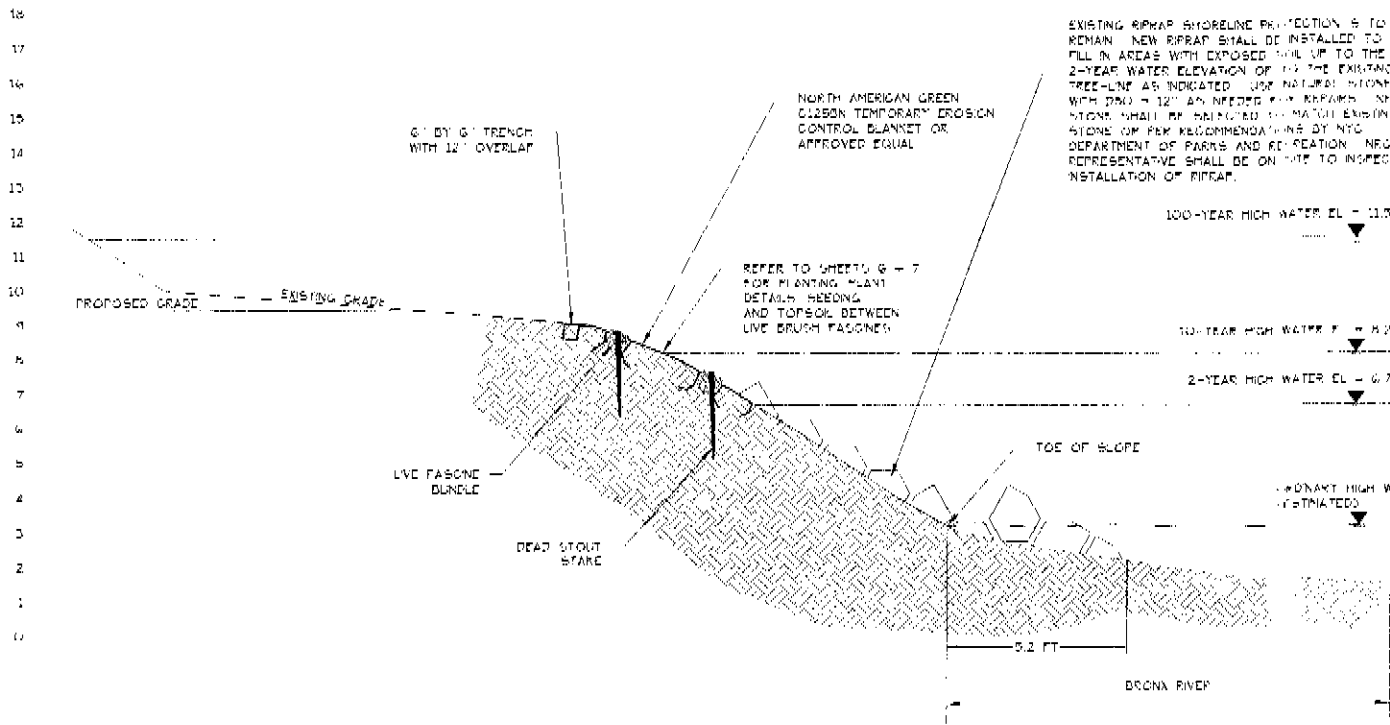

SECTION C-C
SCALE: 1" = 2'

EXISTING RIPRAP SHORELINE PROTECTION TO REMAIN. NEW RIPRAP SHALL BE INSTALLED TO FILL IN AREAS WITH EXPOSED SOIL UP TO THE 2-YEAR WATER ELEVATION OF 6.7. THE EXISTING TREE-LINE AS INDICATED. USE NATURAL POLYLOG WITH 200 - 12" DIA. INFLECTED PINE REPAIRS. NEW STONE SHALL BE DRIVEN TO MATCH EXISTING STONE OR PER RECOMMENDATIONS BY NYC DEPARTMENT OF PARKS AND RECREATION. NEG REPRESENTATIVE SHALL BE ON-SITE TO INSPECT INSTALLATION OF RIPRAP.

LIVE BRUSH FASCINE NOTES:

- CONSTRUCTION SPECIFICATIONS**
LIVE MATERIALS - CUTTINGS MUST BE FROM SPECIES THAT ROOT EASILY AND HAVE LONG STRAIGHT BRANCHES.
- NATURAL RESOURCES GROUP REPRESENTATIVE SHALL BE ON-SITE TO INSPECT INSTALLATION OF LIVE FASCINES.
- LIVE MATERIAL PREPARATION**
- CUTTINGS TIED TOGETHER TO FORM LIVE BRUSH FASCINE BUNDLES ARE TO BE 8 FEET IN LENGTH OR LONGER DEPENDING ON SITE CONDITIONS AND LIMITATIONS IN HANDLING. CUTTINGS ARE TO BE 1/4" TO 3/4" IN DIAMETER.
 - THE COMPLETED BUNDLES SHALL BE 8 INCHES IN DIAMETER WITH ALL OF THE GROWING TIPS ORIENTED IN THE SAME DIRECTION. STAGGER THE CUTTINGS IN THE BUNDLE SO THAT TOPS ARE EVENLY DISTRIBUTED THROUGHOUT THE LENGTH OF THE UNIFORMLY SIZED LIVE FASCINE.
 - LIVE MATERIALS TO BE INSTALLED SAME DAY THEY ARE PREPARED.
- NEED MATERIAL PREPARATION:**
- STRAW USED FOR BUNDLING SHALL BE UNTREATED TWINE.
 - DEAD STOUT STAKES USED TO SECURE THE LIVE BRUSH FASCINES SHALL BE 3-FOOT UNTREATED 2" BY 2" LUMBER. EACH END SHALL BE CUT DIAGONALLY THROUGH THE 4" HIGH FACE TO MAKE TWO BEARS FROM EACH 3 FOOT LENGTH. ONLY NEW ROUND LUMBER SHALL BE USED AND ANY DEAD STOUT STAKES THAT SHATTER UPON INSTALLATION SHALL BE DISCARDED AND REPLACED.
- INSTALLATION**
- PREPARE THE LIVE BRUSH FASCINE BUNDLE AND LIVE STAKES IMMEDIATELY BEFORE INSTALLATION.
 - BEGINNING AT THE BASE OF THE SLOPE (TOP OF RIPRAP) DIG A TRENCH ON THE CONTOUR APPROXIMATELY 4 TO 6 INCHES WIDE AND DEEP.
 - EXCAVATE TRENCHES UP THE SLOPE AT 5 FOOT INTERVALS FOR 20' SLOPES OR FLATTER. EXCAVATE TRENCHES UP THE SLOPE AT 3 FOOT INTERVALS FOR SLOPES STEEPER THAN 2:1.
 - PLACE LONG STRAW AND ANNUAL GRASSES BETWEEN ROWS.
 - INSTALL AND SECURE THE EROSION CONTROL BLANKET AS SPECIFIED ON THE DETAIL SHEET.
 - PLACE THE LIVE BRUSH FASCINE INTO THE TRENCH LEAVING APPROXIMATELY 1/4 OF THE LIVE FASCINE ABOVE GRADE.
 - DRIVE THE DEAD STOUT STAKES DIRECTLY THROUGH LIVE BRUSH FASCINE USING A 2 TO 3 FOOT SPACING. EXTRA STAKES SHOULD BE USED AT CONNECTIONS OR BUNDLE OVERLAPS. LEAVE THE TOP OF THE DEAD STOUT STAKES FLUSH WITH THE INSTALLED BUNDLE.
 - PLACE MOIST SOIL ALONG SIDES OF THE BUNDLES. THE TOP OF THE LIVE BRUSH FASCINE SHOULD BE VISIBLE WHEN THE INSTALLATION IS COMPLETED.

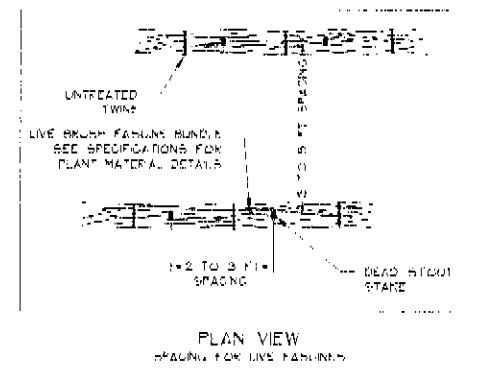

PLAN VIEW
SPACING FOR LIVE FASCINES

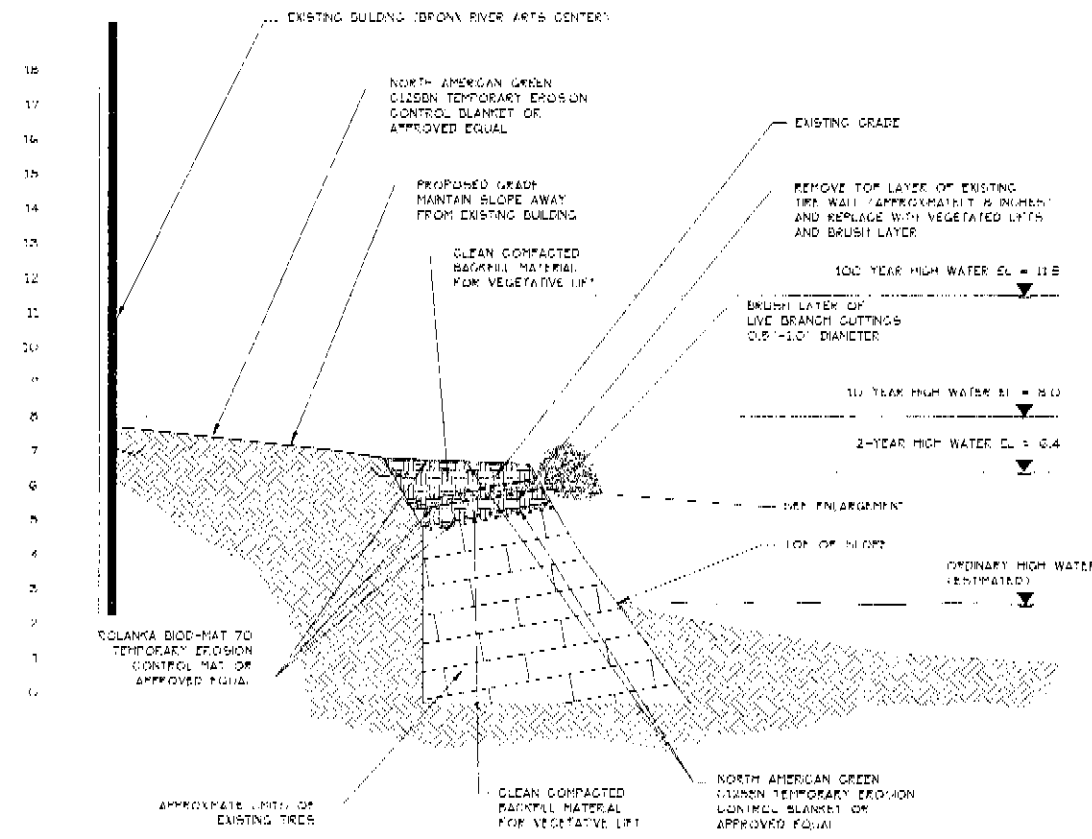

SECTION D-D
SCALE: 1" = 2'

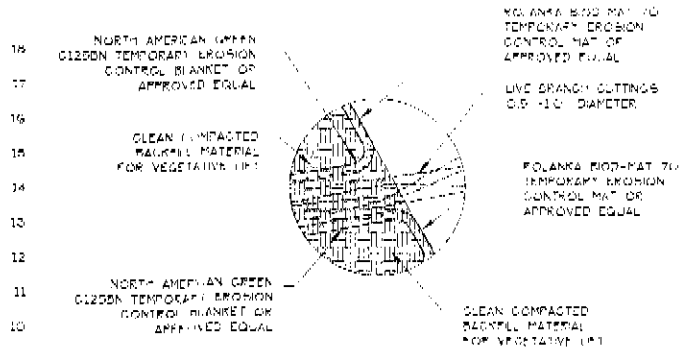

ENLARGEMENT
NOT TO SCALE
FOR ILLUSTRATIVE PURPOSES ONLY

NOTES FOR VEGETATIVE LIFTS WITH BRUSH LAYER

- NATURAL RESOURCES GROUP REPRESENTATIVE SHALL BE ON-SITE TO INSPECT INSTALLATION OF VEGETATIVE LIFTS AND BRUSH LAYER.
- LIVE BRANCH CUTTINGS FOR BRUSH LAYER: LIVE BRANCHES SHALL RANGE FROM 0.5 TO 1.0 INCHES IN DIAMETER AND SHALL BE 4 TO 6 FEET IN LENGTH.
- VEGETATIVE LIFTS: SEE SPECIFICATIONS FOR INSTALLATION OF VEGETATIVE LIFTS.

- GENERAL NOTES:**
- THE EXISTING INFORMATION ON THIS PLAN IS FROM A SURVEY TITLED "TOPOGRAPHIC SURVEY" BY LANGAN ENGINEERING AND ENVIRONMENTAL SERVICES DATED NOVEMBER 10, 2005.
 - ELEVATIONS SHOWN ARE REFERENCED TO THE BRONX BOROUGH DATUM.
 - EXISTING CONDITIONS OF THE BRONX RIVER SHOWN BELOW THE TOP OF SLOPE ARE ASSUMED AND ARE NOT TO SCALE.
 - HIGH WATER ELEVATIONS FOR THE 10-YEAR AND 100-YEAR STORM EVENT WERE OBTAINED FROM THE FLOOD INSURANCE STUDY FOR THE CITY OF NEW YORK BY THE FEDERAL EMERGENCY MANAGEMENT AGENCY DATED MAY 10, 1983. HIGH WATER ELEVATIONS FOR THE 2-YEAR STORM EVENT WERE ESTIMATED BASED UPON AVAILABLE INFORMATION MODELED WITH FLOWMASTER SOFTWARE.

NO.	DATE	DESCRIPTION
1	11/10/05	ISSUED FOR PERMIT
2	01/10/06	REVISION: PERMIT
3	02/10/06	100% REVISED SUBMISSION (LOCAL PERMITS)
4	04/10/06	100% SUBMISSION
5	05/22/06	FOR REVIEW SUBMISSION (FINAL PERMIT)
6	05/22/06	FOR REVIEW SUBMISSION
7	05/22/06	FOR REVIEW SUBMISSION

MARK K MORRISON ASSOCIATES LTD
LANDSCAPE ARCHITECTS
145 WEST 14th STREET, 10TH FLOOR
NEW YORK, NY 10011-3201
TEL: 212 254 1100 FAX: 212 254 1101
WWW.MORRISONASSOCIATES.COM

LANGAN
ENGINEERING & ENVIRONMENTAL SERVICES
24 West 11th Street, 10th Floor
New York, NY 10011-3201
P: 212 279 8800 F: 212 279 8822
WWW.LANGAN.COM

City of New York
Parks & Recreation
District Office
Flushing Meadows Corona Park
Flushing, New York 11368

PROJECT TITLE: **THE RECONSTRUCTION OF BRONX RIVER (WEST FARMS) PARK, LOCATED AT EAST 179th STREET BETWEEN EAST 180th STREET AND EAST TRÉMONT AVENUE, BOROUGH OF BRONX (BLOCK 3141, LOTS 1, 14 & 17)**

LOT: **PH# X550-45**
DRAWING TITLE: **SHORELINE PROTECTION SECTIONS - 2**
DESIGNED BY: **KBC** DRAWN BY: **EBG** CHECKED BY: **DMH**
REVIEWED: **TEAM LEADER APPROVED** (APPROVED REPRESENTATIVE OF CLIENT)
APPROVED: **CHIEF ENGINEER** (APPROVED REPRESENTATIVE OF CONTRACTOR)
DATE: **11/10/05** (DATE OF ISSUE) SCALE: **AS SHOWN**



