

# **HISTORICAL PERSPECTIVES INC.**



11/20/2014

**New York City School Construction Authority  
Primary School Facility: 1 Peck Slip, Block 106, Lot 9**

**Phase IA Archaeological Resources Documentary Study,  
Monitoring Addendum  
NYS OPRHP No. 11PR00200  
NYC LPC Project No. United States Postal Service / 106-M**

## **Introduction**

The New York City School Construction Authority (SCA) proposes the development of a new public school facility for the Manhattan neighborhood between the South Street Seaport and the Brooklyn Bridge at 1 Peck Slip (Figure 1). The proposed school site, Block 106, Lot 9, is the existing four-story Peck Slip Station United States Post Office (USPS) building (Figure 2). The transfer of the Peck Slip Post Office Station to the SCA and subsequent proposed alterations to the property has required various environmental reviews. As a function of this review process, Historical Perspectives, Inc. (HPI) completed an Archaeological Documentary Study, or Phase IA of the 1 Peck Slip site in 2010 in order to evaluate the potential sensitivity for archaeological resources.

The New York State Office of Parks, Recreation and Historic Preservation (OPRHP) reviewed HPI's Archaeological Documentary Study under Section 106 of the National Historic Preservation Act of 1966 and the relevant implementing regulations, as well as under Section 14.09. OPRHP concurred with the findings of sensitive zones within Lot 9 (4/13/11). As the SCA moved forward with design plans to adapt the extant building for a school facility, limited subsurface excavation of Lot 9 became necessary for the design team to test the extant piles and pile caps under the post office perimeter to determine integrity and load bearing capabilities. The limited testing program would involve minimum disturbance and provide an opportunity for archaeological monitoring within portions of the Lot 9 sensitivity zones. HPI, at the request of the SCA, submitted a protocol to monitor the piles and pile cap tests. The final protocol was forwarded to the OPRHP and the NYC Landmarks Preservation Commission by the SCA (9/15/11).

The initial archaeological monitoring at 1 Peck Slip (Block 106, Lot 9) began on 9/15/11 and was completed on 10/4/11, prior to the closure of the postal facility. A total of four locations (Test Pits 1 – 4) that were excavated by the Langan Engineering and the TDX Construction team were monitored by the archaeologists from HPI. A Phase IA Archaeological Documentary

Study Monitoring Addendum was prepared by HPI (10/20/11), including a refined and focused single sensitivity zone based on the results of TPs 1-4.

In July 2012, the construction design team required the excavation of additional interior and exterior test pits to examine additional pile caps as well as the existing foundation of the Post Office, now vacated by the USPS. For the 2012 phase of testing, HPI utilized the same monitoring protocol that was previously submitted to OPRHP. In order to ensure full compliance with both city and state recognition of archaeological sensitivity, the SCA and HPI extended the Peck Slip archaeological monitoring to the exterior sidewalk foundation testing. Although the sidewalks were not a part of the original Area of Potential Effect (APE), information on their potential sensitivity was collected from adjacent projects once subsurface impacts to the sidewalks was proposed (Dallal and Meade, 2007; Chrysalis Archaeological Consultants, Inc. 2012). OPRHP was notified of this additional effort (6/15/12). The results were included in the second Monitoring Addendum to the Phase IA Archaeological Documentary Study (HPI 9/20/2012).

In December 2013 through January 2014 HPI archaeologists monitored the removal of the concrete floor within the section of the sensitivity zone where two new elevator shafts were being installed. Following the removal of the remaining concrete floor, additional work within the monitoring zone was required in 2014 when (1) trenches were excavated to expose the strap beams and column bases, (2) waterproofing trenches were opened along the exterior walls, and (3) when trenches were excavated for utility installation within the monitoring zone. The following Monitoring report by HPI Field Director, Sara Mascia, PhD and HPI archaeologist Christine Flaherty, describes the 2013 and 2014 archaeological work and serves as what is assumed to be the final Monitoring Addendum to the original Phase IA Archaeological Documentary Study.

## **Results of Field Monitoring**

From December 2013 through July 2014, the SCA requested that the HPI archaeological team report to the 1 Peck Slip site to monitor below ground excavations within the refined archaeological sensitivity zone. The goals of the SCA's limited actions within this location were to install two new elevator shafts, expose the strap beams and column bases, excavate waterproofing trenches along the exterior walls, and complete utility installation within the monitoring zone. A series of 18 trenches were excavated and ten features were identified during monitoring by the archaeologists (Figure 2). Below is the discussion of the Features.

Ten features were identified during the course of archaeological monitoring (Figure 2). Seven of these were shaft features, including a cistern and four privies. Of the remaining three features, two were likely trash deposits adjacent to former foundation walls, and the remaining feature was a deep refuse midden with no discernible boundaries.

### **Feature 1**

Feature 1 was a truncated, circular, stone and brick-lined shaft feature found during the machine excavation of Trench 1 for a new elevator shaft (Figure 2). The top course of bricks was exposed at 80 centimeters below surface (cmbs) or 2.6 feet (ft). Ten courses of brick were exposed and cleaned by hand. Although the bricks were mortared together there was no interior

mortar or cement lining within the feature. The walls of the feature were one brick course thick on the interior with a stone course making up the exterior, visible on the left in Photograph 1. The northern and western sides of the feature had been truncated and a precise diameter was difficult to determine. Based on the remaining portion of the feature, it is likely that the shaft was approximately 1 m (3.3 ft) in diameter.

When the feature was encountered, the soil removed by the backhoe was sifted and a number of mid-19<sup>th</sup>-century domestic artifacts were recovered from soils that were from the interior of the feature. The remaining fill (soil) within the feature was hand-excavated from approximately 124-154 cmbs (4 – 5 ft). The fill consisted of very dark grayish brown to very dark gray (10YR 3/2 to 10YR 3/1) damp ashy silty sand. The exterior soil around the feature was brown (10YR 4/3) sand.

A cluster of artifacts was found against the southern interior wall, including a number of ceramic fragments. The remaining fill from the feature was removed by machine and trowel-sifted. The bottom of the feature, which was unlined, was encountered at approximately 199 cmbs (6.5 ft). Of the remaining *in situ* portion of the feature, the HPI team sampled approximately 90% of the interior fill.

The sampling of the feature resulted in the collection of 428 artifacts, which were overwhelmingly food-related, mainly ceramics (Appendix A). Several of the ceramic fragments recovered had maker's marks that were identified on several web sites. They included a number of fragments of a blue transferprint plate, marked "Seine" by J. Wedgwood (1841-1860) and an ironstone plate marked "T. Goodfellow" (1823-1859). There were also a number of different vessels with the same pattern, particularly a series of blue transfer-printed ironstone plates called "British Lakes," produced by Charles J. Mason and Co. in England sometime between 1829 and 1845. Another identified pattern was "Canova," by Thomas Mayer, found on a bowl, saucer, and plate. The plate was produced between 1836-1838 while the bowl and saucer were produced between 1826-1838.

In addition to the whiteware noted above, numerous fragments of pearlware and mochoware, representing at least two chamberpots, a mug, a pitcher, and other vessels were also in the assemblage. The base of an ironstone pitcher, stoneware crock fragments, and one piece of incised, cobalt-decorated stoneware vessel were recovered. Of the glass fragments in the assemblage, a number were mold-blown bottle fragments. Personal items included a carved shell button (with thread still remaining in the holes), a bone button, and a fragment of a kaolin smoking pipe with a thistle design. Finally, several bone food remains were present, some of which exhibited evidence of butchering activity.

As the interior of Feature 1 was not mortared, the shaft was likely used as a privy. The feature is in the general location of a privy identified on Pullings *Sanitary and Social Chart, City of New York* in 1866 (Pulling, 1866). The artifacts recovered from within the feature indicate that it was filled during the mid 19<sup>th</sup> century, likely just prior to the 1866 map was created.

## **Feature 2**

Feature 2, a round brick cistern lined with mortar, was encountered during the excavation of Trench 2 (Figure 2; Photograph 2). The top portion of the cistern had been severely truncated

during the construction of the post office, but the extant *in situ* courses of brick were found immediately below the northern concrete foundation wall, beginning at a depth of 83 cmbs (2.7 ft). The remaining portion of the cistern below this depth appeared to be mostly intact with the southern half located within the building interior, and the northern half within the Areaway. Following the removal of a portion of the southern half of the cistern by machine excavation, it was noted that the eastern side of the feature had been previously disturbed when a ceramic utility pipe had been installed at a depth of 130 cmbs (4.3 ft). In addition, the eastern end was partly under the existing concrete footing. The cistern had an exposed diameter of approximately 195 cm (6.4 ft). The interior of the southern half of the cistern was hand-excavated, and the brick exterior was removed by machine. The interior fill was excavated according to the four distinct soil layers that were present. The table below describes the soil levels, with depths given at the center of the feature (Table 1).

Table 1. Soil Stratigraphy from Feature 2.

Level	Soil	Color	Depth in cmbs
1	Coarse sand	Brown (10YR 3/6)	85-126
1a	Silty sand (large lens with Level 1)	Very dark brown (10YR 2/2)	99-116 center of feature only
2	Silty sand with heavy furnace scale and lenses of shell	Black (10YR 2/1)	126-164
3	Sandy silt	Black (10YR 2/1)	164-188
4	Coarse silty sand	Very dark brown (10YR 2/2)	188-193

Each of the strata within the feature sloped downwards to the east side of the cistern where the feature had been impacted by the installation of the utility pipe. The base of the cistern was reached at a depth of 193 cmbs (5.7 ft). The base, a layer of brick with mortar lining, had an underlying support of cut stone (Photograph 3).

Artifacts were collected from each level except Level 4, a shallow stratum that only contained some small pieces of furnace scale, grit, and very small brick fragments (Appendix A). The recovered assemblage totaled 143 artifacts, with the majority being food-related ceramics and glass. The ceramics included a variety of earthenware types: creamware, hand-painted pearlware, a few fragments of tin-glazed earthenware, redware, two fragments of yellowware, and whiteware, including transferprint-decorated and ironstone. A pearlware saucer with a hand-painted polychrome floral decoration in the center with a sponge pattern around it dates from the 1820s-1830s. Most of the earthenware fragments were fairly small, and no definitive makers' marks were found on any pieces. The stoneware recovered included five fragments of white salt-glazed stoneware and three fragments of the more utilitarian gray- or buff-bodied stoneware. There was also a fragment of a porcelain "gothic-style" egg cup and a few other undecorated porcelain sherds. There were also food remains including small shell and bone fragments, architectural elements such as window glass, and personal items including as nine fragments of kaolin smoking pipes, a shell button, and a slate pencil.

While the tin-glazed earthenware, white salt-glazed stoneware, creamware and pearlware fragments date to the 18<sup>th</sup> century, several of the artifacts from the interior strata indicate a fill



date between 1840-1850s. These artifacts include ironstone tableware in the gothic pattern, which was popular beginning in the 1840s and had almost ceased production by 1860, and yellowware, a ware type that had been produced in the United States as early as ca.1800, but the style noted in the collection was not common until mid-century.

### Feature 3

Feature 3 was exposed at a depth of 85 cmbs (2.8 ft) during the excavation of Trench 2 (Figure 2). It was a truncated round brick-lined shaft feature, five feet in diameter, found in proximity to Feature 2 (Photograph 4). The feature was bisected and the western half was excavated by hand (Photograph 5). Excavation halted at 254 cmbs (8.3 ft), although the bottom level only had the southwest quadrant excavated. The base of the feature was not found, as it extended below the monitoring level. This feature is also in the general location of a privy identified on Pullings *Sanitary and Social Chart, City of New York* in 1866 (Pulling, 1866). Hand excavation revealed seven levels of fill, including a thick layer of lime (see Table 2 below).

Table 2. Soil Stratigraphy from Feature 3.

Level	Soil	Color	Depth in cmbs
1	Silty sand	Brown (10YR 3/6)	85-119
2	Silty sand with charcoal	Very dark brown (10YR 2/2)	119-130
3	Sand	Brown (10YR 3/6)	130-140
4	Sandy silt	Dark brown (10YR 3/3)	140-152
5	Lime and silt with charcoal	Grayish brown (10YR 5/2)	152-169
6	Silty sand with some charcoal	Very dark grayish brown (10YR 3/2)	169-191
7	Sand	Brown (10YR 3/4)	191-254

The first level of the truncated feature included some debris from previous construction episodes. Levels 2-4 were excavated as one layer until a 17 cm (.6 ft) layer of lime and charcoal was encountered (Level 5). This stratum was identified at a depth of 152 cmbs (5 ft), indicating this shaft feature was likely a privy, and was probably filled during or shortly after its use period.

The upper portion of the feature had been truncated by the construction of the Post Office and a shallow section of the base/eastern half of the feature was left *in situ* as it was not located within the area excavated for construction purposes. Therefore, only a limited portion of the feature was sampled during monitoring. The examination of the assemblage from this feature indicated that the portion of the shaft that was sampled had materials dating from the late 18<sup>th</sup> century. It is likely that these materials were close to the base of the feature and were likely refuse thrown into the privy during its usage. It is probably that more recent 19<sup>th</sup> century fill was removed when the upper portion of the feature was truncated.

### Feature 4

Feature 4 was a truncated cut stone-lined shaft feature. It was exposed after Trench 1 was expanded through machine excavation (Figure 2; Photograph 6). The eastern half was bisected by the construction of the modern Post Office foundation and what remained of the feature was

revealed to a depth of 282 cmbs (9.3 ft). Because of its location directly under the existing foundation the feature could not be excavated. The interior fill appeared to contain a large pocket of oyster shell in very dark grayish brown (10YR 3/2) silty sand. No other artifacts were visible on the exposed surface. The feature remained *in situ*.

### **Feature 5**

Feature 5 was a truncated brick- and stone-lined shaft feature that was revealed after Trench 1 was expanded through machine excavation (Figure 2; Photograph 7). It appeared to have an inner liner of cut sandstone blocks and an outer wall of bricks. The feature could not be excavated because of the possibility of undermining the existing concrete strut and footer above it. The fill was quickly sampled but it did not appear to contain a great number of artifacts. There were some large stones and other rubble within the fill, which was a very dark gray (10YR 3/1) sandy silt. The feature remained *in situ*. The limited artifacts in the collected were a mixed variety of ceramic types with an indeterminate date range (Appendix A). They included black transfer-printed ironstone, a trailed slip-decorated buff-bodied earthenware fragment, and four fragments of porcelain with a light blue applied sprig decoration.

### **Feature 6**

Feature 6 was identified during the excavation of Trench 6, near the northwest corner of the old elevator bank (Figure 2; Photograph 8). A vertical row of cut stones was noted in the north wall at the west end of the trench. Several distinct stratigraphic layers of soil were visible immediately to the west of the stones. Upon further machine excavation, another vertical row of stones was noted in the west wall of the trench. The remaining portion of this impacted feature was sampled and some artifacts collected. The purpose of this feature could not be readily determined due to the constraints of the construction trench. However, the subsequent excavation of Trench 8e immediately to the north revealed a stone foundation wall aligned with the north row of stones in Feature 6. It is likely that Feature 6 was once part of the foundation, with an artifact deposit alongside the exterior of the wall. There were 19 food-related ceramic fragments recovered adjacent to the wall (Feature 6). The date range of the assemblage extended from the late 18<sup>th</sup> to the early 19<sup>th</sup> century, and included creamware, tin-glazed earthenware, pearlware, and white salt-glazed stoneware (Appendix A). No whiteware was found during the sampling, which would indicate a 19<sup>th</sup> century deposition date.

### **Feature 7**

Feature 7, a truncated, circular stone-lined privy, was identified during the excavation of Trench 8b at a depth of 48 cmbs (1.6 ft) (Figure 2). The northern portion of the feature appeared to have been partially removed prior to excavation by the installation of two 20<sup>th</sup> century utility pipes running southwest/northeast in the west half of the feature. The pipe trench contained two 6" pipes, one terracotta and one iron, with the top of the pipes at 80 cmbs (2.6 ft). The interior diameter of the privy was approximately 2 m (6 ft). The extant portion of the northeast section of the feature was excavated by hand in three levels (Table 3; Photograph 9).

In the lowest 20 cm of the third stratum, the irregular depositions of soil disappeared and there were less artifacts present. No further construction excavation was required in this area, so the southern half and the western edge of the feature remained *in situ*.

Table 3. Soil Stratigraphy from Feature 7.

Level	Soil	Color	Depth in cmbs
1	Compact sandy silt	Dark brown (7.5YR 3/4)	48-84
2	Sandy silt with bricks and artifacts	Very dark grayish brown (10YR 3/2)	84-112
lens	Wood and window glass		112-129
3	Silty sand with artifacts	Dark yellowish brown (10YR 4/4) with irregular depositions of dark brown (10YR 3/3) brown (10YR 5/3)	112-163

### Feature 8

Feature 8, a small round severely truncated brick-lined shaft feature, was identified during the excavation of Trench 8b (Figure 2; Photograph 10). The northern section of the feature, which had been severely truncated by prior construction episodes, was encountered at 55 cmbs (1.8 ft). The archaeologist excavated and sampled a portion of this feature. The shaft had an outer diameter of 1.1 m (3.6 ft), with an interior diameter of 66 cm (2.2 ft) at the truncated top and 77 cm (2.5 ft) at the base of the excavated portion. Immediately adjacent to the north side of this feature, a small concentration of artifacts was noted, that had likely been displaced from the interior of the feature when it was truncated.

The feature was one course of bricks thick and each brick was laid with the long sides together. The majority of bricks were not mortared together, but a few appeared to have a small amount of shell mortar between them. They may have been reused, or the shell mortar may have dissolved over time, particularly as this feature was exposed to tidal groundwater during the 19<sup>th</sup> and 20<sup>th</sup> centuries. Eleven extant courses of brick extending 73 cm (2.4) below the top row were noted as well as two courses (18-27 cm) of rough-cut stone near the base. The bottom row of stones had an encrusted stain that might have been the remnants of wood or metal. Although the stone and brick lining ended, the fill continued and was hand-excavated down to 146 cmbs (4.8 ft). Two distinct deposition layers were excavated. The first level, from 55-100 cmbs, contained dark brown (10YR 3/2) silty sand, and the second level, which was below the stones from 100-146 cmbs, contained brown (10YR 5/3) sand. Yellow brick fragments were present throughout both levels. As the limits of the current construction did not continue deeper, excavation of the feature was halted at 146 cmbs (4.8 ft).

### Feature 9

Feature 9 was identified during the excavation of the northern end of Trench 8c, and presented as a large deposit with shell in a dark soil matrix (Figure 2; Photograph 11). No outer walls were apparent. Since the construction excavation did not continue further, and no other cultural materials were visible in the exposed surface, no sampling was done of this feature. It likely represents an irregular trash deposit of unknown date.

## Feature 10

Feature 10 was revealed during the excavation of the southern half of Trench 8c (Figure 2; Photograph 12). The feature was a 92 cm (3 ft) section of large cut stones running north/south with a very dark deposit on the eastern side of the stones. The feature appeared to be a remnant of a wall. Although a few artifacts were collected from the adjacent deposit, further machine excavation revealed that the stones did not continue. A kaolin smoking pipe stem and a fragment of creamware were found within the deposit as well as a large amount of tar and possible roofing material. The identified material indicates a 20<sup>th</sup> century date and likely does not represent a discrete deposition of cultural domestic material (Appendix A).

## Analysis

During the mid 19<sup>th</sup> century, the residents of the neighboring properties 3, 5, and 7 Peck Slip appear to have been closely associated with each other and potentially shared rear yard space and features. Documentary research indicates that several individuals worked at the commercial establishments located on the ground floor of these structures and either resided in one of the three buildings or in the general neighborhood (see Tables 4-6). Six of the ten features identified during this phase of monitoring were located in the back lots of these three buildings.

The 1866 Sanitary map indicates that there were at least five privies in the back lots of 3 and 5 Peck Slip at that time. It is likely that Features 3, 4, and 5 described above were three of the privies identified on the 1866 map (Pulling 1866). However, the 1866 map did not include a privy in the location of the recovered Feature 1 in the rear lot of 3 Peck Slip. Further, no privy was depicted in the rear of the former back yard of 7 Peck Slip, the recovered Feature 7. The artifacts noted in the interior of Features 3 and 7 indicate that they were filled during the mid 19<sup>th</sup> century, possibly prior to the creation of the Sanitary map in 1866.

### 3 Peck Slip

Documentary research found that this neighborhood was developed near the end of the 18<sup>th</sup> century (Table 4). Similar to the neighboring buildings, 3 Peck Slip had a commercial establishment on the ground floor and residential units above. It is unclear if the Harrisons, the printers who occupied the ground-floor space were renters or owners of the structure. These individuals were no longer present by 1815 when attorney William Seaman purchased the property. It is likely, however, that one or more of the three privies located to the rear of 3 Peck Slip (Features 1, 4, and 5) were installed prior to the sale to Seaman.

**Table 4. Occupation Documentation for 3 Peck Slip (Lot 15)**

Date	Resident	Occupation/Household	Resource
1789	Harrison & Purdy	Printers	Directory
1790	Harris[on?], John	Free white males <16: 1; ≥16: 3 Free white females: 4	Federal Census
1791	Harrison, John Ogilvie, Anthony St. John, Joseph	Printer Painter Mariner	Directory
1808	Harrison, Charles Museum (weekly)	Printer & bookstore Office of	Directory

Date	Resident	Occupation/Household	Resource
1810	Harrison, Charles	Free white males 10–15: 1; 16–25: 1 Free white females <10: 1; 10–15: 2; 16–25 Slaves: 1	Federal Census
1812	Read, Samuel C. Frist, Samuel	Board h Barber	Directory
1815	<i>B &amp; E Andariese to W. Seaman</i>		Deed (L113 p. 45)
1820	Seaman, William	Free white males <10: 1; 26–<45: 1 Free white females <10: 2; 16–<26: 3	Federal Census
1825	Allen, Joseph W. D.S. & I Brown Seaman, Wm. Seaman, Wills Wills, Thomas	merchant, 253 pearl tallow chandlers atty., h. 144 Cherry attys atty	Directory
1827	Bulkley, Wm. H. Seaman. William Allen, Joseph W. Seaman & Wills Wills, Thomas	atty & couns., h. 213 Duane atty, h. 144 Cherry merchant, 258 Pearl attys atty	Directory
1829	Burtus, J. A. Hall, William B. Seaman & Wills Wills, Thomas	bookstore & stationery, 19 Peck Slip  attys atty & mast in chancery, h 298 Pearl	Directory
1830	Burtus, James	Males 20 to <30: 1; 30 to <40: 1; 40 to <50: 1 Females 10 to <15: 1; 20 to <30: 1; 30 to <40: 1; 70 to <80: 1	Federal Census
1834	Burtus, James A. Cameron, John J. Maurice, James, Jr.	bookstore & stationery, 19 Peck Slip atty, h. 6 Murray	Directory
1839	Carle, John Jr. Mills, Ethelbert S. Mills & Taggard	Druggist, 153 Water atty, h 111 E Bway attys	Directory
1840	Carle, John Jr.	Males 15 to <20: 1; 20 to <30: 2; 30 to <40: 1 Females <5: 1; 5 to <10: 1; 30 to <40: 1 no people employed	Federal Census
1842	Cludius, Charles Cure, Hiram	Paperboxes, 127 Wm Jewelry, 104 South	Directory
1847	<i>J. Herriman (Dev. of W. Seaman) to H. A Seaman (trust of Herriman)</i>		Deed (L485 p.584)
1848	Moreau, Frederick Moreau, Lewis Wood, Susannah	caps, h 49 Mott hatter, h 49 Mott wid. Richard, bhouse	Directory
1850	<i>Exec W. Seaman to J. Sullivan</i>		Deed (L535 p.192)
1850	T. Nostrand Henry Fowler & Co	Feed dealer Feed dealers	Directory
1851	Katz, Isaac Pearsall, David Ennis, Obadiah Sherwood, B. F.	bootmaker/shoemaker refectory, * 2 Fulton market morocco, 26 Ferry, h. Westchester refectory	Directory

<b>Date</b>	<b>Resident</b>	<b>Occupation/Household</b>	<b>Resource</b>
1856	Gribble, Edward, Hogan, Timothy, Konig, Daniel, Peck, Alonzo R., Sheridan, Catherine	rubber, h cooper, h bootmaker drygoods, 3 Peck pl.?, h W 27th n 6 <sup>th</sup> wid. John, h	Directory
1860	Baldwin, John Meyer, John Meyer, John Meyer, John	boots waiter eatinghouse, 55 Pearl grocer 16 Cherry and eatingh 55 Pearl	Directory
1860	Butler, Francis	51, segar store, r.e. 15,000, p.e. 500, b. England Susan, 30, b. England	Federal Census
1860	Baldwin, John	boot & shoemaker, p.e. 200, b. Ire Honora, 28, b. Ire James, 10, b. Ire; John, 8; Ann, 3; Ellen, 1	Federal Census
1860	Monsel, Margaret	22, servant, b. Ire	Federal Census
1860	Smith, Thos	30, boot maker, b. Ire	Federal Census
1860	Mulligan, Patrick	39, boot maker, b. Ire	Federal Census
1860	Mahoney, Catherine	32, dress maker, b. Ire	Federal Census
1860	Lawrence, James	34, tailor, p.e. 300, b. Ire Ellen, 38, b. Ire	Federal Census
1860	McGeary, Mary	21, tailoress	Federal Census
1860	Martin, John P.	28, porter, b. Ger Louisa, 18	Federal Census
1860	Schultz, John B.	30, barber, pe 500, b. Ger	Federal Census
1860	Kellen, Henry	29, seaman, b. Ger	Federal Census
1860	Lasen, Benj.	21, segar maker, b. Ger	Federal Census
1860	Sporenberg, Charlotte	47, washerwoman, b. Ger Charles, 15, printer Louis, 6	Federal Census
1869	Baldwin, John Butler, Francis O'Neill, John Ratchford, Thomas Smith, Thomas Stanton, John Sullivan, Cornelius	boots dogs, h Brklyn liquors, *53 South seaman, h laborer, h laborer, h laborer, h	Directory
1870	Gleason, Patrick	30, longshoreman, b. Ire Margaret, 30, kh, b. Ire Patrick, 12, b. Ire	Federal Census

Date	Resident	Occupation/Household	Resource
1870	O'Neal, John	50, liquor dealer, b. Ire Honora, 40, kh, b. Ire	Federal Census
1870	Lary, Joseph	30, cartman, b. Ire	Federal Census
1870	Tobbin, Wm	22, laborer, b. Ire	Federal Census
1870	Railford, J.	39, laborer, b. Ire Thomas, 9	Federal Census
1870	Corcoran, James	21, clerk in store, b. Ire	Federal Census
1870	Harrison, Benjamin	40, sailmaker, b. Gothenburg (Sweden)	Federal Census
1870	Corcoran, Mary	30. kh, b. Ire	Federal Census
1870	Harrison, Millie	5; Benjamin, 1	Federal Census
1870	Sullivan, Cornelius	60, laborer, b. Ire Margaret, 60, kh, b. Ire	Federal Census
1870	Powers, John	24, porter in store Elenor, 22, kh, b. Ire	Federal Census
1870	Connors, B	40, kh, b. Ire Ellen, 10	Federal Census
1877	<i>E. Williams et al def to A. S. Underhill</i>		Deed (L1441 p.96)

Feature 1 contained several artifacts near the base of the feature that indicate a late 18<sup>th</sup> century construction date (Appendix A). They include an array of pearlware, mochaware, and slip decorated earthenware, as well as 18<sup>th</sup> century kaolin smoking pipe fragments. Seaman lived and worked in the structure for a short time before moving to Cherry Street. Although occupied by tenants, the property appeared to remain with the Seaman family until 1850 (Table 4). It is likely that during the Seaman ownership the additional privies were built to accommodate the growing number of residents in the building. Although Feature 1 was severely truncated by later construction activity on the site, the majority of the ceramics recovered from this feature were whiteware with decorative elements that indicate that the privy was likely filled around the time of the sale in 1850. In addition, a few diagnostic bottles also indicate a ca. 1850 date for the assemblage (Appendix A).

### **5 Peck Slip**

Documentary evidence also indicates that the building at 5 Peck Slip was constructed about the same time as its neighbor. The building appears to have been originally owned by Isaac Cock, who was a Grocer (Table 5). Daniel Cromwell's Dry Goods Store was also in the building. Both Cock and Cromwell also lived on the upper floors with their families. It is likely that Feature 3 was built by Cock at the same time as the building. The excavation of Feature 3 resulted in the collection of over 600 artifacts (Appendix A). The majority of these were food-related or food remains, with 176 earthenware fragments, 34 stoneware fragments, 21 porcelain fragments, 22 glass fragments, and 215 bone fragments. The majority of the refined ceramics were tin-glazed (n=27), creamware (n=80), porcelain (n=18) and white salt-glazed (n=11) sherds.

***Table 5. Occupation Documentation for 5 Peck Slip (Lot 14)***

<b>Date</b>	<b>Resident</b>	<b>Occupation/Household</b>	<b>Resource</b>
1789	Cock, Isaac & Andrew	Grocer	Directory
1789	Cromwell, Daniel	Dry Goods Store	Directory
1790	Cock, Isaac	Free white males <16: 1; ≥16: 3 Free white females: 4	Federal Census
1790	Cromwell, Daniel	Free white males <16: 1; >16: 2 Free white females 3	Federal Census
1791	Cromwell, Daniel	Dry Goods Store	Directory
1800	Cock, Isaac	Free white males 10–15: 1; 26–44: 1 Free white females <10: 2; 10–15: 1; 26–44: 1 Free other: 2	Federal Census
1810	Cock, Isaac	Free white males 26–44: 1; ≥45: 1 Free white females <10: 1; 16–25: 2; 26–44: 1 Free other: 2	Federal Census
1812	Cock, Isaac	Merchant, 244 Water	Directory
1816	<i>Exec of I. Cock to C. Smith</i>		Deed (L115 p.232)
1820	Brown, Isaac	Free white males <10: 2; 10–<16: 1; 16–<18: 1; 18–<26: 2; 26–<45: 1 Free white females 16–<26: 1 Free colored males <14: 1 Free colored females 26–<45: 1 3 engaged in manufactures	Federal Census
1825	Chadeayne, John	merchant-tailor	Directory
1827	Chadeayne, John	merchant-tailor	Directory
1828	<i>Exec of C. S. Smith to I. Brown</i>		Deed (L235 p.241)
1829	Brown, Isaac	tallow chandler, *8 Peck-slip	Directory
1829	Wiley, William	atty & counsellor	Directory
1830	Brown, Isaac	Males 5 to <10: 1; 10 to <15: 1; 30 to <40: 1 Females <5: 3; 5 to <10: 1; 20 to <30: 2; 30 to <40: 1	Federal Census
1834	Brown, Isaac	tallow chandler, *8 Peck-slip	Directory
1839	Carpenter, Seymour	atty	Directory
1839	Cromwell, Charles T.	attor & sol., h 107 E Bway	Directory
1839	Drew, Mary	wid. of Edward, boardinghse	Directory
1840	Whittemore, Adelia	Males >5: 1; 30 to <30: 4; 30 to <40: 1; Females 5 to <10: 1; 15 to <20: 2; 20 to <30: 3 4 employed in commerce	Federal Census
1842	<i>D. S. Brown et al. def. to J. Frost</i>		Deed (L428 p.533)
1842	Cromwell, Charles	lawyer, h 107 E Bway	Directory
1842	Duff, Martin H.	lawyer	Directory
1842	Reid, Archibald	grocer, *446 Water	Directory
1848	Gwynne, Thomas	merchant, *177 Pearl, h	Directory
1850	Henry Newman & Co	watchmakers	Directory
1850	Murphy, B	boots and shoes	Directory



Date	Resident	Occupation/Household	Resource
1850	<i>Exec J. Frost to E. Wade</i>		Deed (L541 p.408)
1851	Marks, Joseph	clothing, * & h.	Directory
1851	Gwynne, Thomas	commercial merchant, * 26 Cedar	Directory
1851	Lawrence, James	tailor	Directory
1856	Berry, Henry C	3 Peck slip, h. 5 Peck sl	Directory
1856	Land, Andrew H.	bdinghse	Directory
1856	Singer, Isidore	clothing	Directory
1860	Mead, Peter	stevedore	Directory
1860	Singer, Isidore	clothing	Directory
1860	Singer, Isidor	53, clothing store, pe 2,000, b. Poland Paulina, 30, b. Ger Eliza, 8; Sara, 6; Louis, 4; Charles, 3; William, 1	Federal Census
1860	Limbeck, Andrew	30, bdg ho, pe 1,000, b. Sweden Elizabeth, 20, b. Ire Martha, 2	Federal Census
1860	Duggan, Jane	27, servant, b. Ire	Federal Census
1860	McGuelph, Mary	20, servant, b. Ire	Federal Census
1860	Shore, Jane	18, servant, b. Ire	Federal Census
1860	Bennett, Mary	seamstress, b. Ire	Federal Census
1860	Bergman, Jules	25, sea captain, pe 500, b. Sweden	Federal Census
1860	17 seamen	(6 Sweden, 6 Norway, 3 Ireland, 1 England, 1 Scotland)	Federal Census
1869	Drucker, Ahrend	grocer, *5 Peck, & liquors, * 7 Peck slip, h 7 Peck	Directory
1869	Lindbergh, Andrew S.	Boarding	Directory
1869	Marks, Abraham	tailor	Directory
1870	Marks, A.,	30, taylor, b. Prussia Mina, 30, kh, b. Prussia Esta, 9; Marcus, 7; Elizabeth, 2; Morris, 1	Federal Census
1870	Landberg, A.	40, [seamen's boarding h keeper, b. Sweden Elizabeth, 40, kh, b. Ire Maria, 13; Elizabeth, 9; Joshua, 7	Federal Census
1870	Barman, Cha	7	Federal Census
1870	Hargan, Edward	30, baker, b. Ire	Federal Census
1870		146 seamen (b. 83 Sweden, 18 Ire, 8 Russia, 7 Norway, 6 England, 6 Prussia, 4 NY, 3 Denmark, 3 Spain, 2 Germany, 2 South America, 1 West Jersey, 2 Indeter.)	Federal Census
1870		3 female Irish-born servants	Federal Census

The ceramic assemblage from Feature 3 had the earliest overall date range of all the features. Tin-glazed earthenware began production in the 1600s but had tapered off by the 1770s, white salt-glazed stoneware was made between 1685-1785, but most popular between 1720-1770 and creamware was in production mainly between 1740-1780. Other 18<sup>th</sup> century ware included two fragments of English brown stoneware, made between 1690-1775, and several fragments of German Rhenish ware, which declined in popularity by the 1770s. In addition, a nearly complete buff-bodied stoneware chamberpot was found in Level 7. Decorated with a cobalt grape or wave motif, this crudely made vessel was likely an example of early New York-made pottery (Janowitz, personal communication, 1/26/2014).

The examination of personal items in the assemblage identified 53 fragments of kaolin smoking pipes. The majority of the pipe stems appeared to have large bore holes, indicating an earlier manufacture date, as bore-hole diameters decreased during 19<sup>th</sup> century as manufacturing techniques improved. One pipe had the initials “W.G.” stamped in a cartouche on the bowl as well as on the spur; this type of pipe has been found on Revolutionary War-era sites. Along with the pipe fragments, six fragments of large mammal rib bones were recovered. Each had circular cutouts in them, approximately 1/2” in size, and were most likely the remnants of bone used in the home manufacture of buttons.

Isaac Cock appears to have died before 1816. By 1820 Isaac Brown and his family had replaced Isaac Cock’s as the residents of 5 Peck Slip. The assemblage of artifacts does not include any definitive mid-19<sup>th</sup> century artifacts (whiteware, glassware) that would indicate that this feature was utilized after the Cock and Cromwell occupation of the building.

The brick cistern that was identified (Feature 2) within the former back lot of 5 Peck Slip appears to have been both installed and filled during the mid-19<sup>th</sup> century. The handful of 18<sup>th</sup> century artifacts in the fill was likely from yard scatter that was gathered up when filling the interior of the shaft. During that time period, the number of occupants within the building had grown considerably as the structure was utilized more as a boarding house than the earlier single or two-family residence. This increase in the number of occupants likely corresponded with the construction of additional conveniences (e.g., cisterns, privies).

### **7 Peck Slip**

Early documents indicate that the property at 7 Peck Slip was likely owned by an absentee landlord. No land deeds were found that indicated Peter Kissam, the initial occupant of the structure, was the owner (Table 6). By the early 19<sup>th</sup> century, grocer Joseph P. Smith and his family were the occupants of the building.

***Table 6. Occupation Documentation for 7 Peck Slip (Lot 13)***

<b>Date</b>	<b>Resident</b>	<b>Occupation/Household</b>	<b>Resource</b>
1790	Kissam, Peter	Free white males <16: 1; >16: 2 Free white females 6	Federal Census
1791	Kissam, Peter R. & Samuel	Store 22 Peck Slip	Directory
1808	Nash, M.	select seminary & grocer	Directory
1812	Smith, Joseph Sherman, Samuel	grocer builder	Directory
1820	Smith, Joseph	Free white males <10: 3; 18-<26: 1; 26-<45: 1 Free white females <10: 1; 10-<16: 1; 16-<26: 1; 26-<45: 1 2 engaged in commerce	Federal Census
1825	Smith, Joseph P.	grocer	Directory
1827	Smith, Joseph P.	grocer	Directory
1829	Smith, Joseph P.	grocer	Directory

<b>Date</b>	<b>Resident</b>	<b>Occupation/Household</b>	<b>Resource</b>
1830	Smith, Joseph P.	Males 5 to <10: 1; 10 to <15: 1; 10 to <15: 2; 40 to <50: 1 Females 5 to <10: 1; 10 to <15: 1; 15 to <20: 2; 40 to <50: 1 Free colored male 36 to <55: 1	Federal Census
1834	Smith, Joseph P.	grocer & firebricks	Directory
1839	Smith John C. Smith, Joseph P.	saddler, 319 Pearl grocer & firebricks	Directory
1840	Smith, Joseph P.	Males 10 to <15: 2; 20 to <30: 2; 50 to <60: 1 Females 10 to <15: 1; 15 to <20: 2; 50 to <60:1; 80 to >90:1 no persons employed	Federal Census
1842	Smith, Joseph P.	grocer	Directory
1843	<i>J. S. Shotwell to R.C. Cornell</i>		<i>Deed (L435 p.127)</i>
1848	Schiernbeck, Aaron	grocer, 7 Peck, h 7 Peck	Directory
1850	Schierenbeck, Ahrand	41, grocer, b. Ger Anna G., 34, b. Ger John, 4; Anna, 6 mos.	Federal Census
1850	Husing, Richard	15, clerk, b. Ger	Federal Census
1850	Husing, Albert	17, clerk, b. Ger	Federal Census
1850	Trumbull, Wm	47, currier, b. Ire	Federal Census
1850	Condon, H. A.	19, baker, b. Ire	Federal Census
1851	Schierenbeek, Aaron	grocer, 313 Pearl & 7 Peck, h. 7 Peck sl	Directory
1856	Donovan, Ann Drucker, Aaron	dressmaker, h grocer	Directory
1860	Burk, Patrick Ford, Catherine Powers, Ellen	seaman widow wid. Ed., fruits	Directory
1860		13 seamen in one household (5 Sweden, 1 Norway, 1 Canada, 1 England, 1 Ireland, 1 NY, 1 Maine, 1 RI, 1 MD)	Federal Census
1860	Nelson, Wm.	23, seaman?, b. Denmark Freda, 21, b. Ger	Federal Census
1860	Drycker, Shamd?	34, seaman?, pe 500, b. Ger Catherine, 23, b. Ger Annie, 5; Albert, 3; Adeline, 10 mos.	Federal Census
1860	Powers, Ellen	30, laundress, b. Ire John, 8	Federal Census
1860	McCue, Wm.	14, b. Ire	Federal Census
1860	Ford, Catherine	34, b. Ire Mary, 15, book folder, b. Ire Catherine, 9	Federal Census
1860	Walsh, Joanna	41, cook, b. Ire	Federal Census
1860	Burke, Patrick	35, seaman, b. Ire Mary, 30, b. Ire Richard, 8 John, 2	Federal Census
1860	Kinkamber, Ernest	31, seaman, b. Ger Rebecca, 27, b. Ger	Federal Census
1867	<i>S. &amp; E. Michel to C. M. Drucker</i>		<i>Deed (L1009 p.410)</i>

Date	Resident	Occupation/Household	Resource
1869	Drucker, Ahrend	grocer, 5 Peck, & liquors, * 7 Peck slip, h 7 Peck	Directory
1870	Drucker, A.,	40, grocery store, b. Prussia Mary, kh, b. Prussia Ana, 15; Albert, 13; Edetrica, 11; Frederick, 8; Mina, 5; Gecinia, 3	Federal Census
1870	Kirkhoff, H.	30, clerk in store, b. Prussia	Federal Census
1870	Welsley, G. G.	30, longshoreman, b. England	Federal Census
1870	Ford, Katy	40, kh, b. Ire Maria, 18, bookfolder Katy, 16	Federal Census
1882	<i>A. Drucker et al. def to H. Block</i>		<i>Deed (L1675 p.285)</i>

Four hundred artifacts were collected in this feature, with nearly 75% representing food-related ceramics (Appendix A). The number of large artifact fragments recovered, particularly the ceramics, and the numerous discrete soil lens, indicated that the privy was likely utilized as a receptacle for refuse over a period of time as well as a privy.

Nearly one-third of the ceramics in the assemblage were pearlware fragments (n=113). Many of these represented nearly whole vessels. The majority of the pearlware was decorated with blue floral transfer prints, but there were also blue and green shell-edged wares as well as some polychrome hand-painted vessels. Two of the pearlware vessels had a makers' mark identified with Enoch Woods and Sons, Burslem, dating from 1818-1846. Included in the assemblage were a small number of refined earthenware types including whiteware, mochaware, creamware, cream-colored ware, and tin-glazed earthenware fragments. Utilitarian wares included a number of redware, stoneware, and buff-bodied earthenware fragments. In addition, the assemblage contained fragments of white salt-glazed stoneware and 30 fragments of Chinese-export and other hard-paste porcelain.

There were 15 clear glass fragments from at least three drinking tumblers. Personal items included 18 kaolin smoking pipe fragments, including one pipe bowl with the letters "WN" scratched into the clay. A piece of slate, possibly part of a slate tablet, also had designs scratched into it.

The assemblage that was collected indicates that the feature was likely constructed before the turn of the 19<sup>th</sup> century and filled sometime before the mid-19<sup>th</sup> century. It is likely that this might have occurred when the property was sold in 1843 and the building changed from a single-family residence to one where a family was living with multiple boarders.

### **9 Peck Slip**

Feature 8 appears to have been associated with the building at 9 Peck Slip. Similar to the features identified in the adjacent properties, Feature 8 appears to have been installed in the later 18<sup>th</sup> century and might have been used as a small privy. The feature was clearly altered over time and after the introduction of public utilities it was filled. Unlike the neighboring buildings which appeared to have one family (or two in the case of 5 Peck Slip) residing in the buildings in the late 18<sup>th</sup> century, 9 Peck Slip had at least three families occupying the building (Table 7).

Sometime prior to 1829 the building appears to have become officially a boarding house with multiple individuals.

Over one third of the 333 recovered artifacts were food remains with the majority being butchered mammal bone (Appendix A). Several fragments were from smaller, more expensive cuts of beef (rib eye). Most of the ceramics were small fragments, and included a variety of earthenwares (e.g., trailed slip decorated, creamware, cream colored, jackfield, and pearlware) from both the 18<sup>th</sup> century and the first half of the 19<sup>th</sup> century. In addition, several fragments of mid-19<sup>th</sup> century ironstone (whiteware) were in the assemblage recovered.

Personal items included pipe bowl and stem fragments, including one Peter Dorni pipe stem, a popular pipe that has been found across the country with a general date range of 1850-80. Finally, a carved bone utensil handle and two porcelain buttons were also recovered.

**Table 7. Occupation Documentation for 9 Peck Slip (Lot 12)**

<b>Date</b>	<b>Resident</b>	<b>Occupation/Household</b>	<b>Resource</b>
1789	Agnew, John	Tobacconist	Directory
1790	Berry, Charles	Free white males <16: 1; >16: 1 Free white females 1	Federal Census
1790	Cooper, Thomas	Free white males <16: 1; >16: 1 Free white females 1	Federal Census
1790	Agnew, John	Free white males <16: 1; >16: 1 Free white females 2	Federal Census
1791	Agnew, John	Tobacconist	Directory
1791	Berry, Charles	huckster	Directory
1812	Shaw, William Thompson, Abr. G.	Dry good store	Directory
1820	Backus, Simon	Free white males 26–<45: 3 Free white females <10: 3; 10–<16: 1; 16– <26: 1; 26–<45:1	Federal Census
1825	Brown, Isaac Burr, Edwin White, Samuel L.	Tallow chandler, * 8 Peck Slip Atty Chairmaker, h 523 Broome	Directory
1827	Brown, Isaac Burr, Edwin	Tallow chandler, * 8 Peck Slip Atty	Directory
1829	Burr, Edwin Taylor, Lewis	Atty boardinghouse	Directory
1830	Taylor, Lewis	Males 5 to <10: 1; 15 to <20: 1; 30 to <40: 2 Females <5: 1; 10 to <15: 2; 20 to <30: 1; 30 to <40: 1; 50 to <60: 1	Federal Census
1834	Benedict, Erastus C. Burr, Edwin Burr & Benedict Dobbs, Charles J. Evans, Joseph	atty & couns, h. 123 Monroe atty, h Park Pl attys & couns atty, h 25 Orchard MD, *14 Peck slip	Directory
1839	Evans, William Penfold, Nicholas B. Vandyck, Thomas	M d. 100 chatham & Peck Sip printer bookbinder	Directory
1840	Peacock, Allen	Males 10 to <15: 1; 40 to <50: 1; Females 10 to <15: 1; 40 to <50: 1 1 in manufactures and trades	Federal Census

Date	Resident	Occupation/Household	Resource
1842	Bedell, Richard Peacock, Allen	Tailor Glove manu., *286 Pearl	Directory
1843	<i>J. S. Shotwell to R.C. Cornell</i>		<i>Deed (L435 p.129)</i>
1848	Metzger, Marks	segars	Directory
1850	Metzger, Marx	Tobacconist	Directory
1850	Metzer, Marks	34, tobacconist, b. Ger Pareeny?, 29, b. Ger Henry, 7; Fanny, 5; Sarah, 3; Isaac, 1	Federal Census
1851	Metzger, Marks	segars	Directory
1856	Metzger, Marks	segars	Directory
1860	Metzger, Marks	segars	Directory
1860	Metzger, M	45, segar shop, pe 200, b. Ger B. (female), 46, b. Ger, illit. Henry, 17, segar maker Fanny, 15; Sarah, 13; Isaac, 10; Henrietta, 8; Eliza, 4	Federal Census
1860	Lewis, Virginia	40, servant, b. VA	Federal Census
1869	Buney, Peter Michael, Solomon	Segars Tailor, *259 Water	Directory
1870	Michael, S.,	40, taylor, b. Prussia Esta, 40, kh, b. Prussia Ph., 18, M taylor Sarah, 16; Rebeca, 14; Nagel, 12; Louisa, 11; Charles, 8; Barry, 5; Batjie, 1	Federal Census
1901	<i>Exec. of S. Michael to D. Gordon</i>		<i>Deed (L65? p.72)</i>

### **11 Peck Slip and 262 Water Street**

Features 6 and 9 and 10 were stone walls or partial foundation walls associated with former buildings on the rear lots of 11 Peck Slip and 262 Water Street. The surrounding fill contained mostly 19<sup>th</sup> and 20<sup>th</sup> century artifacts and architectural demolition refuse.

### **Conclusions and Recommendations**

All of the features identified during archaeological monitoring had been severely truncated by either late 19<sup>th</sup> century building construction or the mid-20<sup>th</sup> century clearing and construction associated with the current Post Office building.

The majority of the collected and examined interior fill samples from the truncated features contained 18<sup>th</sup> and early 19<sup>th</sup> century artifacts, representing the initial phase of historical development on the project block. The majority of the recovered materials from all of the shaft features were diagnostic food related artifacts which helped to establish the approximate construction and/or filling dates of the features (Appendix A). It appears that the identified privies (Features 1, 3, 4, 5, and 7) were likely constructed in the late 18<sup>th</sup> century and filled, cleaned, and in some cases repaired during the early 19<sup>th</sup> century. The lone cistern (Feature 2) that was identified as a mid-19<sup>th</sup> century feature was apparently installed when the number of occupants at 5 Peck Slip increased significantly.

Documentary research indicates that the area was initially settled near the end of the 18<sup>th</sup> century and all of the buildings were utilized for both commercial and residential occupations. The

filling dates of the features varied as the ownership of the properties changed or the features were replaced. All of these yard conveniences would no longer have been necessary by the 1860s when public utilities would have replaced these outdated features.

The artifacts from the sampled features offer a narrow snapshot on the lifestyle of the residents of Peck Slip when the area was initially developed at the end of the 18<sup>th</sup> century through the mid-19<sup>th</sup> century. The collection would provide an excellent visual exhibit for the new school building. One potential exhibit could focus on comparing the past to the present - *Objects of Everyday Life: A New York City Waterfront Neighborhood – Yesterday and Today*. Using images, maps, and artifacts, family life and work life in 1790-1820 could be contrasted with the family life and work life in 1990-2020. This type of exhibit would be an asset to the neighborhood and provide a deeper connection for the students to the urban heritage of this wonderful Historic District.

## References

Chrysalis Archaeological Consultants, Inc.

2012 Phase 1A Historical Documentary Report and Archaeological Assessment of 246 Front Street (aka 267 ½ Water Street) (Block 107, Lot 34), Manhattan, New York.

Dallal, Diane, and Elizabeth Meade

2007 Phase 1A Archaeological Documentary Study of Peck Slip between Pearl and South Streets; Water Street between Beekman and Dover Streets; and Front Street between Peck Slip and Dover Street. Prepared by AKRF, Inc., New York, NY, for Lower Manhattan Development Corporation, New York, NY. 30 April.

Historical Perspectives, Inc.

2010 Phase 1A Archaeological Resources Documentary Study, Proposed School, One Peck Slip, Block 106, Lot 9, New York. Prepared for the New York City School Construction Authority.

2011 Archaeology Monitoring Memorandum, One Peck Slip, New York. NYS OPRHP No. 11PR00200. Prepared for the New York City School Construction Authority.

2012 Second Archaeology Monitoring Memorandum, One Peck Slip, New York. NYS OPRHP No. 11PR00200. Prepared for the New York City School Construction Authority.

Pulling, E.R.

1866 *Sanitary and Social Chart, City of New York*. Citizens' Association of New York. Council of Hygiene and Public Health.

## Web Sites

<http://www.thepotteries.org/mark/m/mayert.html>

[www.cyclopaedia.de/wiki/John\\_Wedgwood](http://www.cyclopaedia.de/wiki/John_Wedgwood)

[http://englishpink.net/pink\\_patterns.htm](http://englishpink.net/pink_patterns.htm)

<http://www.museumcollections.parks.ca.gov/code/emuseum.asp?style=single&currentrecord=3&page=seealso&profile=objects&searchdesc=Related%20to%20Thomas%20Goodfellow&searchstring=constituentid/,is/,/53140/,false/,true&sessionid=C9A9236D-0BF8-4531-B432-78AA493D18AD&action=searchrequest&currentrecord=4>



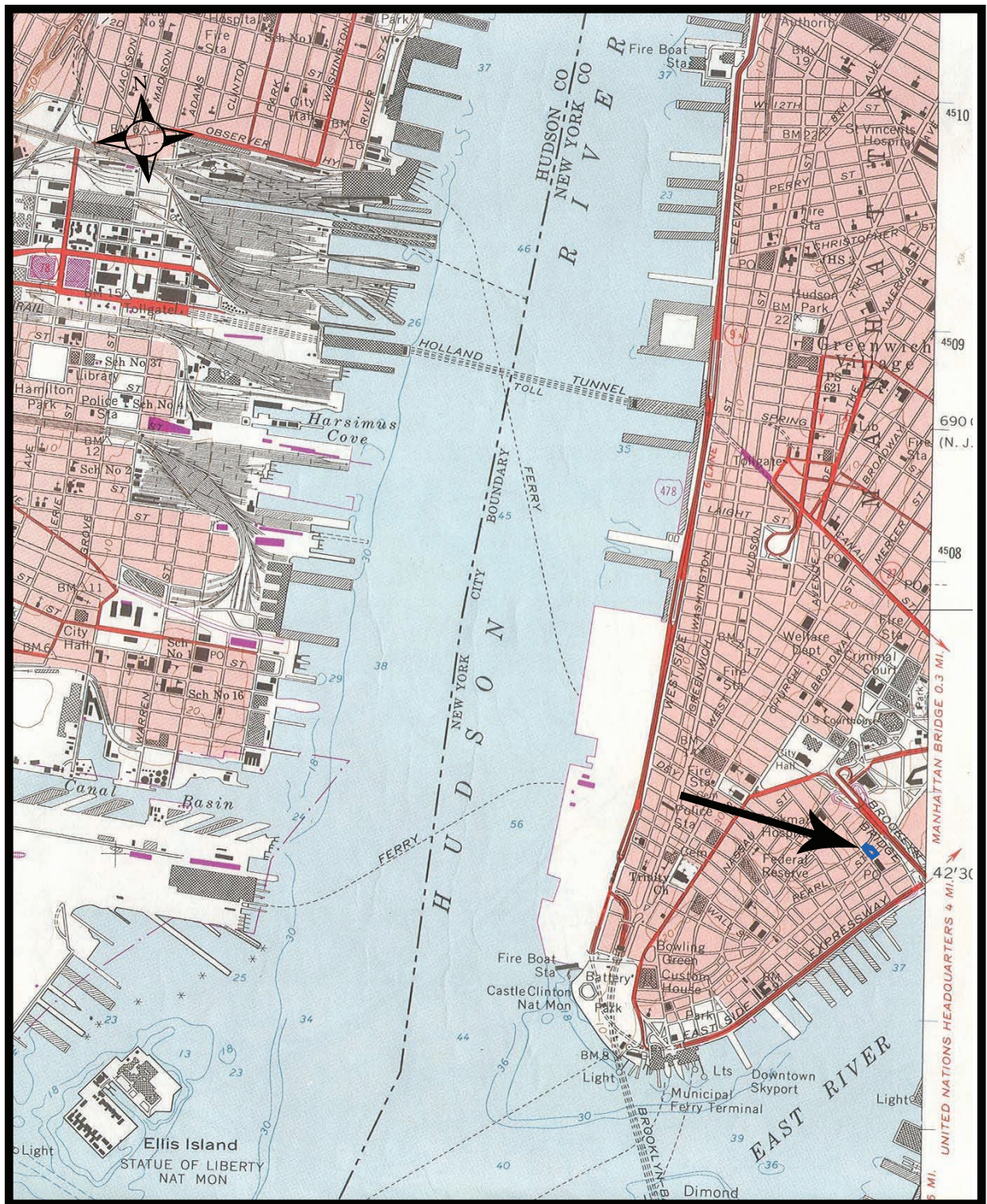

# **LEGEND**

— Area of Potential Effect

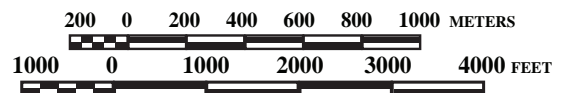









*Proposed School Site, One Peck Slip Station, New York, NY*

**FIGURE 1.** USGS Topographic Map, Jersey City N.J.-N.Y. Quad, 1981





LEGEND

-  GAS PERMEABLE AGGREGATE TRENCH UNDER GRADE BEAM. (REFER TO DETAIL 9 ON H204)
-  6"Ø C.I. PIPE SLEEVE THROUGH FOUNDATION WALL. (REFER TO DETAIL 11 ON H204)
-  Completed monitoring in trenches
-  Area of archaeological sensitivity
-  Archaeological shaft feature
-  Approximate extent of archaeological sampling
-  Sensitive for identified archaeological features remaining *in situ* (some features remain sensitive below depth of construction trench)
-  Previously monitored test trenches
-  Existing support piers

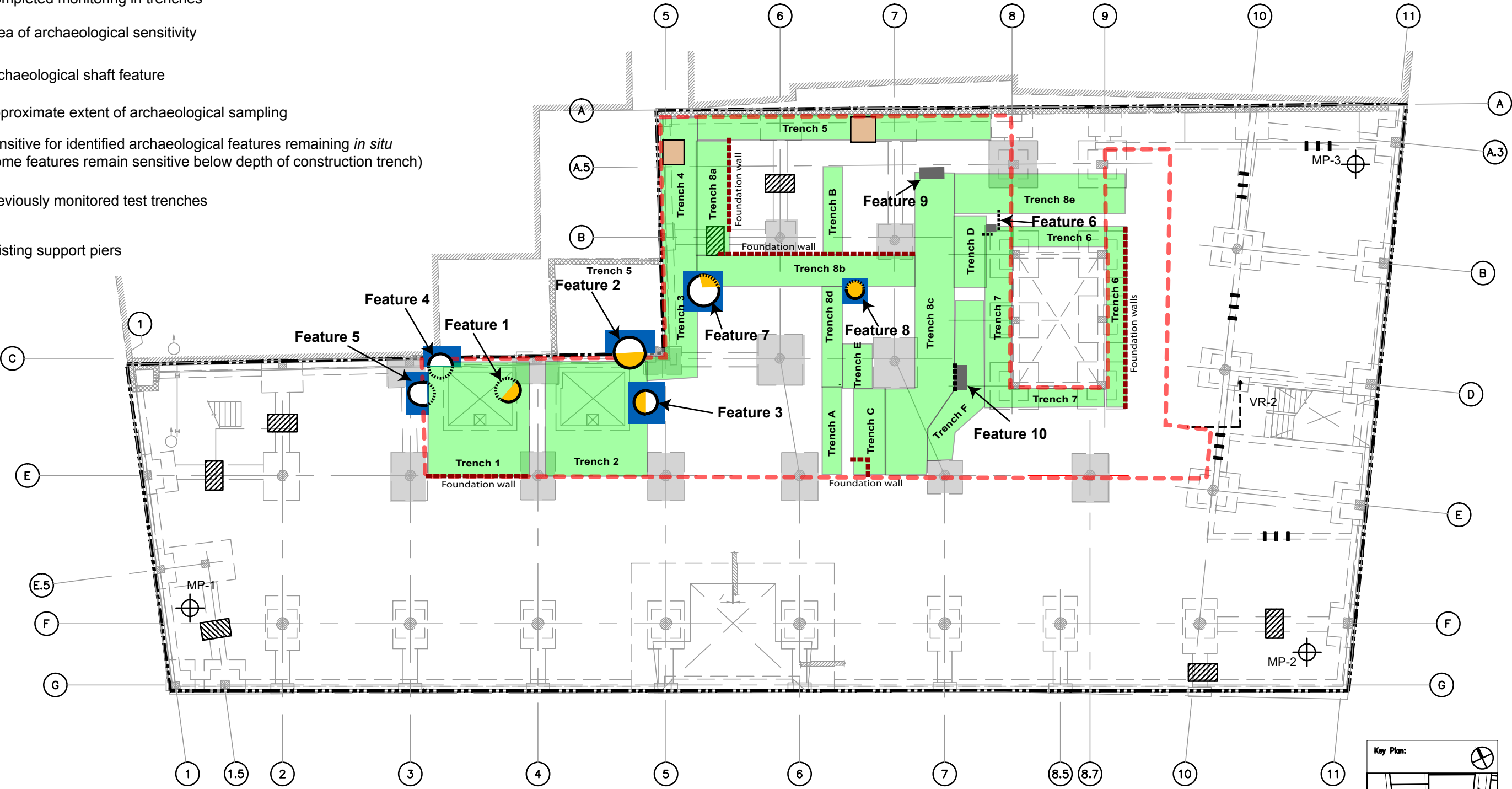

1 GROUND FLOOR PLAN  
H-201  
0 10 20  
SCALE: 1" = 8'

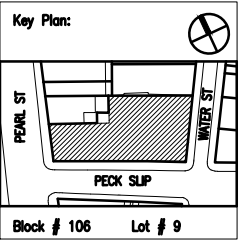

Proposed School Site, One Peck Slip Station, New York, NY

FIGURE 2. Locations of Archaeological Monitoring Trenches and Identified Features.



**Photograph 1. Feature 1, Looking East.**



**Photograph 2. Feature 2, Looking Northeast.**





**Photograph 3. Feature 2, During Excavation, Looking East.**



**Photograph 4. Trench 2, Features 2 and 3, Looking East.**



**Photograph 5. Features 3, During Excavation, Looking East.**





**Photograph 6. Feature 4, Looking North.**



**Photograph 7. Feature 5, Looking North.**



**Photograph 8. Feature 6.**





**Photograph 9. Feature 7, Looking South.**





**Photograph 10. Feature 8, Looking South.**



**Photograph 11. Feature 9, Looking North.**



**Photograph 12. Feature 10, Looking East.**



Trench	Feature	Level	No.	Functional Group	Class	Material	Type	Object	Part	Description
1	conc. 1		3	food related	ceramic	earthenware	buff-bodied	vessel	fragment	slip-decorated
1	conc. 1		1	food related	ceramic	earthenware	tin-glazed	vessel	fragment	rim, trace of blue design (flaking off)
1	conc. 1		1	food related	ceramic	earthenware	whiteware	vessel	fragment	ironstone
1	conc. 1		1	food related	ceramic	earthenware	whiteware	vessel	fragment	
1	conc. 1		1	food related	glass	colorless	mold-blown	bottle	fragment	base, possibly jar, 4" diam, finished pontil mark, 3-part mold
1	conc. 1		1	food related	glass	dark green	mold-blown	bottle	fragment	lip and neck, mineral finish (applied downtooled lip w/ V ring below), mold seam to ring, bulbous neck
1	conc. 1		1	food remains	organic	bone	chicken	bone	fragment	
1	conc. 1		1	food remains	organic	bone	large mammal	rib	fragment	cut
1	conc. 1		2	food remains	organic	shell	clam	shell	complete	
1	conc. 1		4	food remains	organic	shell	oyster	shell	complete	large
1	conc. 1		1	personal	ceramic	earthenware	redware	vessel	fragment	possibly flowerpot or decorative container, ruffled rim, unglazed int, clear and brown glazed ext, incised bands of straight and wavy lines, large
1	conc. 1		2	personal	clay	kaolin	smoking pipe	pipe stem	fragment	
1	conc. 1		1	personal	glass	colorless	mold-blown	vessel	fragment	base, 2" diam, possibly bud vase, molded fluting with embossed dots between flutes
1	1	1	1	architectural	glass	light green tint	flat	window	fragment	
1	1	1	1	food related	ceramic	earthenware	buff-bodied	vessel	fragment	rim, no glaze extant, probably slip-decorated
1	1	1	1	food related	ceramic	earthenware	buff-bodied	vessel	fragment	slip-decorated
1	1	1	1	food related	ceramic	earthenware	redware	vessel	fragment	base, clear and green glaze int, flat bottom, sloped side
1	1	1	1	food related	ceramic	earthenware	redware	vessel	fragment	clear glaze ext, burnished incised pattern of straight and wavy lines
1	1	1	3	food related	ceramic	earthenware	whiteware	bowl	fragment	rim and body, mends, undecorated ironstone, molded ridge partway
1	1	1	20	food related	ceramic	earthenware	whiteware	pitcher	fragment	white ironstone large pitcher with large
1	1	1	1	food related	ceramic	earthenware	whiteware	vessel	fragment	base, probably saucer
1	1	1	5	food related	ceramic	earthenware	whiteware	vessel	fragment	ironstone
1	1	1	1	food related	ceramic	earthenware	whiteware	vessel	fragment	rim, saucer or plate
1	1	1	1	food related	ceramic	earthenware	whiteware	vessel	fragment	base, ironstone

Trench	Feature	Level	No.	Functional Group	Class	Material	Type	Object	Part	Description
1	1	1	1	food related	ceramic	porcelain	soft-paste	lid	fragment	gothic-style, thick, probably tureen or veg dish lid
1	1	1	1	food related	glass	colorless		vessel	fragment	rim, possibly large bowl
1	1	1	1	food related	glass	green	mold-blown	bottle	complete	round, 7.25" H, 2-part mold, rough pontil, attached blob top w/ downtooled lip
1	1	1	1	food remains	organic	bone	large mammal	bone	fragment	
1	1	1	3	food remains	organic	bone	large mammal	rib	fragment	cut marks
1	1	1	1	food remains	organic	bone	mammal	bone	fragment	juvenile
1	1	1	1	food remains	organic	bone	mammal	bone	fragment	
1	1	1	1	food remains	organic	shell	oyster	shell	fragment	
1	1	1	1	unaffiliated	other		anthracite	coal	fragment	
1	1	2	1	architectural	glass	light green tint	flat	window	fragment	
1	1	2	1	food related	ceramic	earthenware	buff-bodied	vessel	fragment	trace of clear glaze ext
1	1	2	11	food related	ceramic	earthenware	mochaware	mug	fragment	mends, brown annular decoration w/ incised bands and white trailed slip on dark brown, handle has molded foliate design
1	1	2	10	food related	ceramic	earthenware	mochaware	pitcher	fragment	small pitcher, pearlware, mends, green impressed bands of hatching top and bottom w/ dotted/trailed slip decoration, handle has molded foliate design
1	1	2	9	food related	ceramic	earthenware	mochaware	vessel	fragment	base and body, bottom of attached handle w/ molded foliate design, mends, white, brown, black and white cat's eye design on light blue background with impressed hatch and dot pattern surrounded by black banding, lime in interior
1	1	2	7	food related	ceramic	earthenware	pearlware	bowl	fragment	most of bowl, blue transfer design w/ grape and vines w/ diamonds edge decoration int and ext, figural scene in center, boy w/ flute and girl; mends
1	1	2	1	food related	ceramic	earthenware	pearlware	lid	fragment	possibly teapot lid

Trench	Feature	Level	No.	Functional Group	Class	Material	Type	Object	Part	Description
1	1	2	8	food related	ceramic	earthenware	pearlware	plate	fragment	base, blue transfer scenic design, sitting lute player w/ other figures, architecture, lake, 2 pcs mend, min 2 plates represented, 1 pc has partial backstamp of gryphon
1	1	2	1	food related	ceramic	earthenware	pearlware	plate	fragment	base and body, blue transfer landscape w/ peacock, partial backstamp (not decipherable)
1	1	2	1	food related	ceramic	earthenware	pearlware	vessel	fragment	rim
1	1	2	1	food related	ceramic	earthenware	redware	bowl	fragment	base, clear glaze int and ext
1	1	2	1	food related	ceramic	earthenware	redware	vessel	fragment	clear and green glaze int
1	1	2	3	food related	ceramic	earthenware	redware	vessel	fragment	trailed slip-decorated, 1 rim w/ piecrust edge
1	1	2	1	food related	ceramic	earthenware	redware	vessel	fragment	brown glaze int and ext
1	1	2	1	food related	ceramic	earthenware	redware	vessel	fragment	possibly crock, clear glaze ext, no glaze int
1	1	2	1	food related	ceramic	earthenware	redware	vessel	fragment	rim, ruffled, clear glaze int and ext w/ brown glaze
1	1	2	4	food related	ceramic	earthenware	salt-glazed stoneware	teapot	fragment	spout, body, base of handle, paneled, handpainted polychrome flower on top of spout
1	1	2	1	food related	ceramic	earthenware	salt-glazed stoneware	vessel	fragment	trace of handpainted blue decoration, probably floral, may be part or lid of teapot
1	1	2	4	food related	ceramic	earthenware	whiteware	bowl	fragment	footed bowl, blue transfer design, floral scroll edge decoration int and ext, scenic landscape in center, 5-pointed star printed on base
1	1	2	5	food related	ceramic	earthenware	whiteware	bowl	fragment	rim, body, base, ironstone, large
1	1	2	1	food related	ceramic	earthenware	whiteware	handle	fragment	ironstone, molded leaf design
1	1	2	1	food related	ceramic	earthenware	whiteware	handle	fragment	ironstone, two-sided handle, possibly for tureen or lid, probably goes on top
1	1	2	1	food related	ceramic	earthenware	whiteware	handle	fragment	black transfer floral design w/ diamonds
1	1	2	1	food related	ceramic	earthenware	whiteware	handle	fragment	ironstone, possibly for lid of tureen or similar
1	1	2	4	food related	ceramic	earthenware	whiteware	lid	fragment	tureen lid, black transfer scenic design, scalloped rim, mends

Trench	Feature	Level	No.	Functional Group	Class	Material	Type	Object	Part	Description
1	1	2	1	food related	ceramic	earthenware	whiteware	plate	fragment	base, body, rim, gothic pattern, stamped with "PATENT/IRONSTONE CHINA/T. GOODFELLOW" around sailing ship w/ bird on top, and impressed mark of "T. GOODFELLOW/IRONSTONE CHINA" around anchor; T Goodfellow operated 1828-1854
1	1	2	1	food related	ceramic	earthenware	whiteware	plate	fragment	base, body, rim, blue transfer design, ironstone, 12-sided rim, river scene, marked "...EINE/...WEDGWOOD", mends, "Seine" pattern by J Wedgwood, 1841-1860
1	1	2	4	food related	ceramic	earthenware	whiteware	plate	fragment	blue transfer w/ floral vine design, angled rim
1	1	2	31	food related	ceramic	earthenware	whiteware	plate	fragment	at least 2 plates, some pcs mend, blue transfer design with center scenic landscape design, scalloped rim, and floral and landscape edge design
1	1	2	11	food related	ceramic	earthenware	whiteware	plate	fragment	blue transfer design, smooth rim, floral and scenic sailing cartouches along rim, scenic landscape in center, some pcs mend, marked "CANOVA/T MAYER LONGPORT", 1836-38
1	1	2	4	food related	ceramic	earthenware	whiteware	plate	fragment	rim and base, blue transfer scenic landscape with scroll border, scalloped rim w/ floral design, marked on base "British Lakes [script, partially obscured]/NEW/STONE CHINA/Eiterwater/C.J.M & Co." w/ crown in center; mends, *1
1	1	2	1	food related	ceramic	earthenware	whiteware	plate	fragment	base, blue transfer scenic landscape, marked w/ diamond registration mark on base, only "3" at bottom visible, below is "FRIBURG/G. PHILLIPS LONGPOR..."

Trench	Feature	Level	No.	Functional Group	Class	Material	Type	Object	Part	Description
1	1	2	2	food related	ceramic	earthenware	whiteware	plate	fragment	rim and base, blue transfer pastoral landscape w/ shepherdess and cows, scalloped rim w/ floral/leaf scrolls, mends, *1
1	1	2	6	food related	ceramic	earthenware	whiteware	plate	fragment	rim, body, base, backstamp of weeping willow tree and "British..." (British Lakes), blue transfer scenic landscape w/ fishermen, scalloped rim w/ floral/leaf scrolls, mends, *1
1	1	2	3	food related	ceramic	earthenware	whiteware	plate	fragment	base and body, backstamp of weeping willow tree and "Briti..." (British Lakes), blue transfer scenic landscape (w/ fisherman), mends, *1
1	1	2	3	food related	ceramic	earthenware	whiteware	plate	fragment	base, backstamp of weeping willow tree and "British Lakes", blue transfer scenic landscape w/ fisherman, 2 pcs mend, *1
1	1	2	2	food related	ceramic	earthenware	whiteware	plate	fragment	rim, scalloped, blue transfer floral/leaf scroll design, larger plate/charger, British Lakes pattern, mends, *1
1	1	2	2	food related	ceramic	earthenware	whiteware	plate	fragment	rim, scalloped, blue transfer floral/leaf scroll design, British Lakes pattern, mends, *1
1	1	2	5	food related	ceramic	earthenware	whiteware	plate	fragment	2 rim, 3 body, scalloped rim, blue transfer floral/leaf scroll design, British Lakes pattern, *1
1	1	2	4	food related	ceramic	earthenware	whiteware	saucer	fragment	polychrome transfer castle scenic design in center w/ brown floral transfer design on rim; 2pcs mend
1	1	2	5	food related	ceramic	earthenware	whiteware	saucer	fragment	blue transfer design, scalloped rim, Canova pattern by T Mayer, 1826-38
1	1	2	2	food related	ceramic	earthenware	whiteware	saucer	fragment	most of saucer, ironstone, marked on base in floral scroll "T. J. & J MAYER'S/IMPROVED/IRONSTONE/CHINA", w/ gryphon above, molded panels, 1843-1855
1	1	2	1	food related	ceramic	earthenware	whiteware	teacup	fragment	ironstone, molded panels

Trench	Feature	Level	No.	Functional Group	Class	Material	Type	Object	Part	Description
1	1	2	1	food related	ceramic	earthenware	whiteware	vessel	fragment	base, probably for pitcher, possibly tureen, ironstone, molded design
1	1	2	5	food related	ceramic	earthenware	whiteware	vessel	fragment	ironstone
1	1	2	1	food related	ceramic	earthenware	whiteware	vessel	fragment	base
1	1	2	1	food related	ceramic	earthenware	whiteware	vessel	fragment	black transfer floral design
1	1	2	2	food related	ceramic	earthenware	whiteware	vessel	fragment	rim, possibly mug, black annular edge decoration, gray glaze ext
1	1	2	1	food related	ceramic	earthenware	whiteware	vessel	fragment	rim, scalloped molded blue shell-edged, plate or saucer
1	1	2	1	food related	ceramic	earthenware	whiteware	vessel	fragment	handpainted polychrome floral design, may be pearlware
1	1	2	1	food related	ceramic	earthenware	whiteware	vessel	fragment	rim, brown annular edge decoration w/ blue glaze on body
1	1	2	1	food related	ceramic	earthenware	whiteware	vessel	fragment	blue transfer scenic design w/ geometric border, almost porcelain
1	1	2	9	food related	ceramic	earthenware	whiteware	vessel	fragment	serving vessel, flared rim, scalloped, blue transfer print, trace of landscape design in center, floral rim border, floral and landscape cartouches on ext; some pcs mend
1	1	2	1	food related	ceramic	earthenware	whiteware	vessel	fragment	probably bowl, blue transfer design int and ext, smooth rim, Canova pattern by T Mayer, 1826-38
1	1	2	4	food related	ceramic	earthenware	whiteware	vessel	fragment	base, mends, ironstone, six-sided gothic style, pitcher or teapot
1	1	2	1	food related	ceramic	earthenware	whiteware	vessel	fragment	rim, flared, molded scroll design along rim, possibly large serving dish
1	1	2	1	food related	ceramic	earthenware	whiteware	vessel	fragment	rim, flared, paneled rim, possibly large serving dish
1	1	2	1	food related	ceramic	earthenware	whiteware	vessel	fragment	base, footed, possibly for bowl
1	1	2	1	food related	ceramic	earthenware	whiteware	vessel	fragment	base, ironstone, possibly large bowl
1	1	2	1	food related	ceramic	earthenware	whiteware	vessel	fragment	base, probably small plate
1	1	2	1	food related	ceramic	earthenware	whiteware	vessel	fragment	base, footed
1	1	2	1	food related	ceramic	earthenware	whiteware	vessel	fragment	molded design of stylized fluted leaves
1	1	2	1	food related	ceramic	earthenware	whiteware	vessel	fragment	base, molded panels
1	1	2	1	food related	ceramic	earthenware	whiteware	vessel	fragment	rim, flat flared rim
1	1	2	5	food related	ceramic	earthenware	whiteware	vessel	fragment	body
1	1	2	1	food related	ceramic	earthenware	whiteware	vessel	fragment	rim, molded band, probably bowl



Trench	Feature	Level	No.	Functional Group	Class	Material	Type	Object	Part	Description
1	1	2	1	food related	ceramic	earthenware	whiteware	vessel	fragment	rim, angled, molded panels, probably saucer or small plate
1	1	2	1	food related	ceramic	earthenware	whiteware	vessel	fragment	base, probably plate
1	1	2	2	food related	ceramic	earthenware	whiteware	vessel	fragment	base, mends, probably small plate
1	1	2	1	food related	ceramic	earthenware	whiteware	vessel	fragment	base, no foot
1	1	2	2	food related	ceramic	earthenware	whiteware	vessel	fragment	body, sharp molded angle, mends
1	1	2	1	food related	ceramic	earthenware	whiteware	vessel	fragment	body, sharp molded angle, large vessel
1	1	2	2	food related	ceramic	earthenware	whiteware	vessel	fragment	body, semi-rectangular with molded band
1	1	2	1	food related	ceramic	earthenware	whiteware	vessel	fragment	rim and body, molded gothic style with angled shape
1	1	2	2	food related	ceramic	earthenware	whiteware	vessel	fragment	rim, scalloped, blue transfer floral design w/ landscape in cartouche
1	1	2	1	food related	ceramic	earthenware	whiteware	vessel	fragment	rim, blue transfer geometric border w/ floral design
1	1	2	1	food related	ceramic	earthenware	whiteware	vessel	fragment	base, blue transfer landscape w/ arched bridge, partial (undecipherable) backstamp
1	1	2	1	food related	ceramic	earthenware	whiteware	vessel	fragment	base, probably plate, not footed, blue transfer scenic design, partial backstamp with foliage and "...N"
1	1	2	1	food related	ceramic	earthenware	whiteware	vessel	spall	
1	1	2	1	food related	ceramic	earthenware	whiteware	vessel	spall	
1	1	2	2	food related	ceramic	earthenware	whiteware	vessel	spall	trace of blue transfer design
1	1	2	3	food related	ceramic	porcelain	hard-paste	saucer	fragment	rim and base, no decoration, lightly molded panels, mends
1	1	2	2	food related	ceramic	porcelain	soft-paste	lid	fragment	gothic-style, thick, probably tureen or veg dish lid, same as in Level 1
1	1	2	1	food related	ceramic	porcelain	soft-paste	teacup	fragment	handpainted polychrome floral overglaze design
1	1	2	1	food related	ceramic	stoneware	buff-bodied	vessel	fragment	clear glaze ext, brown glaze int
1	1	2	2	food related	ceramic	stoneware	buff-bodied	vessel	fragment	rim, mends salt-glaze int and ext
1	1	2	1	food related	ceramic	stoneware	gray-bodied	crook	fragment	base, white glaze int and ext
1	1	2	1	food related	ceramic	stoneware	gray-bodied	crook	fragment	rim, body, salt-glazed ext, brown slip int, trace of cobalt design, stamped "...E" near rim
1	1	2	1	food related	ceramic	stoneware	gray-bodied	vessel	fragment	incised cobalt decoration, salt glazed
1	1	2	5	food remains	organic	bone	avian	bone	fragment	

Trench	Feature	Level	No.	Functional Group	Class	Material	Type	Object	Part	Description
1	1	2	2	food remains	organic	bone	large mammal	bone	fragment	cut marks, mends
1	1	2	10	food remains	organic	bone	mammal	bone	complete	juvenile
1	1	2	3	food remains	organic	bone	mammal	bone	fragment	cut marks
1	1	2	1	food remains	organic	shell	clam	shell	complete	
1	1	2	3	food remains	organic	shell	oyster	shell	complete	1 paired
1	1	2	1	lighting	glass	colorless		lamp chimney	fragment	could possibly be bottle
1	1	2	1	medicinal	glass	colorless	mold-blown	bottle	fragment	embossed "...AN..." on body
1	1	2	18	personal	ceramic	earthenware	mochaware	chamberpot	fragment	base, body, rim, mends, small, flared flat rim, light blue, brown, and black, cat's eye on rim, looped worm design w/ light brown background on body, annular decoration above and below, pearlware
1	1	2	4	personal	ceramic	earthenware	redware	flowerpot	fragment	base, body, rim, mends, 5" H
1	1	2	1	personal	ceramic	earthenware	redware	flowerpot	fragment	
1	1	2	1	personal	ceramic	earthenware	redware	vessel	fragment	rim, unglazed, probably flowerpot saucer
1	1	2	1	personal	clay	kaolin	smoking pipe	pipe bowl	fragment	includes part of stem, bowl has molded thistle design, used
1	1	2	2	personal	clay	kaolin	smoking pipe	pipe stem	fragment	
1	1	2	1	personal	metal	brass		pin	complete	tran
1	1	2	1	personal	organic	bone		button	complete	5-hole, 3/4" diam
1	1	2	1	personal	organic	shell		button	complete	4-hole carved shell, thread remaining in holes
1	1	2	1	unaffiliated	metal	iron		unidentified	fragment	possibly bolt with wood pieces
1	1	2	2	unaffiliated	other		anthracite	coal	fragment	
1	1	3	25	architectural	glass	light green tint	flat	window	fragment	
1	1	3	2	food related	glass	blue	mold	bottle	fragment	Embossed" & A. DEAR" and "D", J. & A. Dearborn, NY, mineral water c. 1850
1	1	3	1	food related	glass	colorless	mold-blown	bottle	fragment	base, 2 1/4" diameter
1	1	3	2	food related	glass	colorless		bottle	fragment	thick 2 1/2" diameter base
1	1	3	1	food related	glass	dark green	mold-blown	bottle	fragment	
1	1	3	2	food related	glass	green tint	mold-blown	bottle	fragment	base/kick
1	1	3	11	food related	glass	light green tint	mold-blown	bottle	fragment	thin
1	1	3	1	food related	glass	light green tint	mold-blown	bottle	fragment	top of kick
1	1	3	1	food related	glass	light green tint	mold-blown	bottle	fragment	down tooled lip to shoulder

Trench	Feature	Level	No.	Functional Group	Class	Material	Type	Object	Part	Description
1	1	3	1	food related	glass	light green tint	mold-blown	bottle	fragment	lip with flat ring, long neck
1	1	3	1	food related	glass	light green tint	mold-blown	jar	fragment	large mouth lip
1	1	3	1	food related	glass	light green tint	mold-blown	jug	fragment	large 5" diameter base
1	1	3	2	food remains	organic	shell	clam	shell	fragment	
1	1	3	6	food remains	organic	shell	oyster	shell	fragment	
1	1	3	2	food remains	organic	bone	cow	rib	fragment	cut
1	1	3	1	food remains	organic	bone	medium mammal	bone	fragment	cut
1	1	3	4	food remains	organic	bone	medium mammal	bone	fragment	
1	1	3	1	food remains	organic	bone	large mammal	bone	fragment	cut
2	2	1	2	architectural	glass	colorless	flat	window	fragment	
2	2	1	2	architectural	glass	light green tint	flat	window	fragment	
2	2	1	1	food related	ceramic	earthenware	buff-bodied	vessel	fragment	rim, brown slip decorated
2	2	1	1	food related	ceramic	earthenware	creamware	vessel	fragment	rim, probably plate, Queensware style
2	2	1	1	food related	ceramic	earthenware	creamware	vessel	fragment	
2	2	1	1	food related	ceramic	earthenware	creamware	vessel	spall	
2	2	1	1	food related	ceramic	earthenware	pearlware	teacup	fragment	blue handpainted decoration
2	2	1	1	food related	ceramic	earthenware	pearlware	vessel	fragment	
2	2	1	1	food related	ceramic	earthenware	pearlware	vessel	fragment	rim, design of pierced holes
2	2	1	1	food related	ceramic	earthenware	pearlware	vessel	fragment	rim, handpainted blue design int and ext, ext is annular
2	2	1	2	food related	ceramic	earthenware	pearlware	vessel	fragment	1 boddy and 1 footed bowl base
2	2	1	1	food related	ceramic	earthenware	pearlware	vessel	fragment	blue shell edge with scalloped rim
2	2	1	1	food related	ceramic	earthenware	pearlware	vessel	fragment	trace of blue decoration
2	2	1	1	food related	ceramic	earthenware	pearlware	vessel	fragment	trace of handpainted brown decoration
2	2	1	1	food related	ceramic	earthenware	pearlware	vessel	fragment	trace of handpainted brown and blue decoration
2	2	1	6	food related	ceramic	earthenware	redware	vessel	fragment	lght pink body, trailed/combed brown slip decoration with pie crust rim, mends
2	2	1	1	food related	ceramic	earthenware	tin-glazed	vessel	fragment	base, handpainted blue design int and ext, glaze has some lead
2	2	1	1	food related	ceramic	earthenware	tin-glazed	vessel	fragment	undecorated
2	2	1	7	food related	ceramic	earthenware	whiteware	plate	fragment	rim and base fragments with faded blue transferprint, architectural scene with floral edge decoration, marked on back "IRONSTONE" and partial floral mark, mends

Trench	Feature	Level	No.	Functional Group	Class	Material	Type	Object	Part	Description
2	2	1	3	food related	ceramic	earthenware	whiteware	vessel	fragment	rim and body, possibly jar, 2 pcs mend, cut nail concretion attached to one pc, blue band design on shoulder
2	2	1	8	food related	ceramic	earthenware	whiteware	vessel	fragment	undecorated
2	2	1	1	food related	ceramic	earthenware	whiteware	vessel	fragment	base, blue floral transferprint fragment
2	2	1	1	food related	ceramic	earthenware	whiteware	vessel	fragment	base with blue transferprint landscape design, trace of mark on base - tree design
2	2	1	1	food related	ceramic	earthenware	whiteware	vessel	fragment	rim, green transferprint floral scroll edge decoration
2	2	1	1	food related	ceramic	earthenware	whiteware	vessel	fragment	ironstone
2	2	1	2	food related	ceramic	earthenware	yellowware	vessel	fragment	annular white and blue design
2	2	1	1	food related	ceramic	porcelain	hard-paste	vessel	fragment	rim, blue handpainted design both sides
2	2	1	1	food related	ceramic	porcelain	soft-paste	egg cup	fragment	eight-sided base, paneled, gothic style
2	2	1	1	food related	ceramic	porcelain	soft-paste	vessel	fragment	base
2	2	1	1	food related	ceramic	porcelain	soft-paste	vessel	fragment	polychrome overglazed floral design
2	2	1	1	food related	ceramic	stoneware	buff-bodied	vessel	fragment	salt glazed
2	2	1	1	food related	ceramic	stoneware	gray-bodied	vessel	fragment	American made with traces of blue design
2	2	1	1	food related	ceramic	stoneware	white salt glazed	plate	fragment	rim to base
2	2	1	2	food related	ceramic	stoneware	white salt glazed	vessel	fragment	undecorated
2	2	1	1	food related	ceramic	stoneware	white salt glazed	vessel	fragment	rim with molded edge decoration
2	2	1	1	food related	ceramic	stoneware	white salt glazed	vessel	fragment	rim with basket weave design
2	2	1	1	food related	glass	dark green		bottle	fragment	
2	2	1	1	food remains	organic	bone	avian	bone	fragment	
2	2	1	1	food remains	organic	bone	mammal	bone	fragment	medium, scapula
2	2	1	1	food remains	organic	bone	mammal	bone	fragment	rib
2	2	1	6	food remains	organic	bone	mammal	bone	fragment	
2	2	1	2	food remains	organic	shell	oyster	shell	fragment	
2	2	1	1	lighting	glass	colorless		lamp	fragment	etched and frosted
2	2	1	1	personal	clay	kaolin	smoking pipe	pipe bowl	fragment	pronounced heel spur, used
2	2	1	1	personal	clay	kaolin	smoking pipe	pipe bowl	fragment	no heel or spur, undecorated, used
2	2	1	1	personal	clay	kaolin	smoking pipe	pipe bowl	fragment	undecorated
2	2	1	4	personal	clay	kaolin	smoking pipe	pipe stem	fragment	
2	2	1	1	personal	clay	kaolin	smoking pipe	pipe stem	fragment	molded design of 3 bands at end, with botanical sprigs adjacent

Trench	Feature	Level	No.	Functional Group	Class	Material	Type	Object	Part	Description
2	2	1	1	personal	other	slate		pencil	fragment	
2	2	1	1	unaffiliated	ceramic	earthenware	whiteware	vessel	fragment	probably toilet fixture
2	2	1	1	unaffiliated	ceramic	porcelain		vessel	fragment	probably toilet fixture
2	2	1	1	unaffiliated	metal	iron		wire	fragment	
2	2	1	2	unaffiliated	other	slate	flat	unidentified	fragment	
2	2	1	1	unaffiliated	other			unidentified	fragment	rectangular, possible carbon, cut marks on sides
2	2	2	2	food related	ceramic	earthenware	whiteware	vessel	fragment	
2	2	2	1	food related	ceramic	earthenware	yellowware	handle	fragment	probably for pitcher, molded ribbing
2	2	2	1	food related	glass	dark green	mold-blown	bottle	fragment	lip and neck, mineral finish (applied dwntooled lip w/ V ring below)
2	2	2	1	personal	clay	kaolin	smoking pipe	pipe bowl	fragment	molded fluted design w/ large and small flutes, hatches along mold seams
2	2	2	1	unaffiliated	organic	wood		wood	fragment	burned
2	2	2	1	unaffiliated	other			slag	fragment	large concretion, typical of this level
2	2	3	1	architectural	glass	light green tint	flat	window	fragment	
2	2	3	2	food related	ceramic	earthenware	creamware	vessel	fragment	base, rim, plate or saucer
2	2	3	1	food related	ceramic	earthenware	pearlware	saucer	fragment	most of dish, 6" diam, blue sponge edge decoration w/ handpainted red and green floral design in center, probably 1820-30
2	2	3	4	food related	ceramic	earthenware	redware	pitcher	fragment	mends, brown glaze int and ext, banding at shoulder
2	2	3	3	food related	ceramic	earthenware	whiteware	teacup	fragment	base, body, rim, ironstone, gothic pattern, mends
2	2	3	1	food related	ceramic	earthenware	whiteware	vessel	fragment	plate or platter, blue shell-edged, molded design
2	2	3	1	food related	ceramic	earthenware	whiteware	vessel	fragment	rim
2	2	3	4	food related	ceramic	earthenware	yellowware	bowl	fragment	large footed bowl, annular decoration of 3 white, 3 blue, 3 white bands (same as fragment in Level 2)
2	2	3	1	food related	ceramic	porcelain	hard-paste	vessel	fragment	base
2	2	3	1	food related	ceramic	stoneware	buff-bodied	vessel	fragment	salt-glazed over gray slip ext, unglazed in
2	2	3	1	food related	glass	colorless	turn mold	bottle	fragment	base, 2" diam
2	2	3	2	food related	glass	colorless		drinking vessel	fragment	rim and body, tumbler or goblet, molded arched panels

Trench	Feature	Level	No.	Functional Group	Class	Material	Type	Object	Part	Description
2	2	3	2	food related	glass	olive green		bottle	fragment	body, kickup, wine bottle
2	2	3	1	food remains	organic	bone	fish	vertebrae	fragment	
2	2	3	1	food remains	organic	bone	large mammal	long bone	fragment	cut
2	2	3	1	food remains	organic	bone	large mammal	rib	fragment	cut
2	2	3	9	food remains	organic	bone	mammal	bone	fragment	2 w/ cut marks
2	2	3	3	food remains	organic	bone	mammal	bone	fragment	calcined
2	2	3	2	food remains	organic	shell	mussel	shell	fragment	
2	2	3	1	personal	ceramic	earthenware	redware	flowerpot	fragment	
2	2	3	1	personal	organic	shell		button	complete	4-hole carved shell
2	2	3	1	unaffiliated	glass	white	blown	lid	fragment	translucent white, 3" diam w/ broken final, lid to small dish
2	2	3	1	unaffiliated	metal	iron	sheet	unidentified	fragment	1" strip
2	2	3	2	unaffiliated	metal	iron		unidentified	fragment	mends, rod w/ base, possibly of very thin rolled sheet metal
2	3	1N	2	architectural	glass	light green tint	flat	window	fragment	
2	3	1N	1	architectural	metal	iron	cut	nail	fragment	
2	3	1N	2	faunal	organic	bone	small mammal	bone	fragment	
2	3	1N	2	food related	ceramic	earthenware	cream-colored	vessel	fragment	part of foot ring and base
2	3	1N	1	food related	ceramic	earthenware	redware	vessel	fragment	brown slip decorated, pie crust rim
2	3	1N	1	food related	ceramic	earthenware	redware	vessel	fragment	rim, light brown glaze
2	3	1N	2	food related	ceramic	earthenware	redware	vessel	fragment	brownish green glaze with trace of green slip decoration
2	3	1N	1	food related	ceramic	earthenware	whiteware	vessel	fragment	
2	3	1N	1	food related	ceramic	porcelain	Chinese export	vessel	fragment	rim, with handpainted blue decoration
2	3	1N	1	food related	ceramic	porcelain	hard-paste	vessel	fragment	base, footed, possibly burned
2	3	1N	1	food related	ceramic	stoneware	English brown	vessel	fragment	Brown vessel, rim with banded edge decoration
2	3	1N	1	food related	ceramic	stoneware	gray-bodied	vessel	fragment	slat glaze exterior, brown glaze interior, impressed with "D.I...." just below shoulder of possible jug
2	3	1N	1	food related	ceramic	stoneware	gray-bodied	vessel	fragment	rim, and trace of handle, salt glazed, traced of blue decoration
2	3	1N	1	food related	ceramic	stoneware	gray-bodied	vessel	fragment	salt-glazed ext, brown int
2	3	1N	1	food related	ceramic	stoneware	white salt-glazed	vessel	fragment	rim, scalloped, with molded edge decoration
2	3	1N	6	food remains	organic	bone	mammal	bone	fragment	
2	3	1N	1	food remains	organic	shell	oyster	shell	fragment	

Trench	Feature	Level	No.	Functional Group	Class	Material	Type	Object	Part	Description
2	3	1N	2	personal	ceramic	earthenware	redware	flowerpot	fragment	saucer
2	3	1N	4	personal	clay	kaolin	smoking pipe	pipe stem	fragment	
2	3	1S	1	architectural	glass	light green tint	flat	window	fragment	
2	3	1S	5	faunal	organic	bone	small mammal	bone	fragment	
2	3	1S	1	food related	ceramic	earthenware	cream-colored	vessel	spall	
2	3	1S	1	food related	ceramic	earthenware	creamware	vessel	fragment	
2	3	1S	1	food related	ceramic	earthenware	mochaware	vessel	fragment	brown geometric band and blue annual slip
2	3	1S	1	food related	ceramic	earthenware	pearlware	vessel	fragment	rim, handpainted blue "Chinese style" decoration
2	3	1S	1	food related	ceramic	earthenware	tin-glazed	vessel	fragment	base, reddish body
2	3	1S	1	food related	ceramic	earthenware	Whieldon-ware	vessel	fragment	with applied sprig
2	3	1S	1	food related	ceramic	earthenware	whiteware	vessel	fragment	
2	3	1S	1	food related	ceramic	porcelain	hard-paste	vessel	fragment	handpainted polychrome floral design
2	3	1S	1	food related	ceramic	stoneware	white salt-glazed	vessel	fragment	
2	3	1S	1	food remains	organic	bone	large mammal	bone	fragment	
2	3	1S	4	food remains	organic	bone	medium mammal	bone	fragment	
2	3	1S	1	personal	clay	kaolin		pipe bowl	fragment	
2	3	1S	1	personal	clay	kaolin		pipe stem	fragment	
2	3	1S	1	unaffiliated	metal	copper alloy		wire	fragment	twisted wire
2	3	2 - 4	1	architectural	clay			brick	fragment	
2	3	2 - 4	2	architectural	glass	light green tint	flat	window	fragment	
2	3	2 - 4	3	architectural	metal	iron	cut	nail	fragment	
2	3	2 - 4	1	architectural	metal	iron	cut	nail	fragment	
2	3	2 - 4	7	faunal	organic	bone	small mammal	bone	fragment	
2	3	2 - 4	1	food related	ceramic	earthenware	buff-bodied	vessel	fragment	rim, trace of slip decoration, pie crust rim
2	3	2 - 4	1	food related	ceramic	earthenware	cream-colored	vessel	fragment	rim
2	3	2 - 4	1	food related	ceramic	earthenware	cream-colored	vessel	fragment	green decorated exterior
2	3	2 - 4	8	food related	ceramic	earthenware	creamware	vessel	fragment	undecorated body
2	3	2 - 4	1	food related	ceramic	earthenware	creamware	vessel	fragment	base with foot ring
2	3	2 - 4	2	food related	ceramic	earthenware	creamware	vessel	fragment	rim, Royal Pattern
2	3	2 - 4	2	food related	ceramic	earthenware	creamware	vessel	fragment	molded body
2	3	2 - 4	1	food related	ceramic	earthenware	creamware	vessel	fragment	thick molded rim
2	3	2 - 4	1	food related	ceramic	earthenware	redware	vessel	fragment	green and cream slip decoration
2	3	2 - 4	2	food related	ceramic	earthenware	redware	vessel	fragment	brown glaze int, unglazed ext
2	3	2 - 4	1	food related	ceramic	earthenware	redware	vessel	fragment	clear glaze int, unglazed ext

Trench	Feature	Level	No.	Functional Group	Class	Material	Type	Object	Part	Description
2	3	2 - 4	1	food related	ceramic	earthenware	redware	vessel	fragment	light brown glaze int/ext
2	3	2 - 4	2	food related	ceramic	earthenware	tin-glazed	vessel	fragment	rim with handpainted geometric design, body with handpainted blue design
2	3	2 - 4	2	food related	ceramic	earthenware	tin-glazed	vessel	fragment	1 rim with trace of handpainted blue design
2	3	2 - 4	1	food related	ceramic	earthenware	tin-glazed	vessel	spall	
2	3	2 - 4	1	food related	ceramic	earthenware	unidentified	vessel	fragment	burned body
2	3	2 - 4	2	food related	ceramic	porcelain	hard-paste	vessel	fragment	handpainted blue design, mend
2	3	2 - 4	1	food related	ceramic	porcelain	hard-paste	vessel	fragment	handpainted polychrome, unidentified overglaze design
2	3	2 - 4	1	food related	ceramic	porcelain	hard-paste	vessel	fragment	trace of handpainted blue design
2	3	2 - 4	1	food related	ceramic	porcelain	hard-paste	vessel	fragment	trace of handpainted overglaze design
2	3	2 - 4	1	food related	ceramic	stoneware	English brown	vessel	fragment	incised lines
2	3	2 - 4	1	food related	ceramic	stoneware	gray-bodied	vessel	fragment	possibly debased scratch blue or German enameled
2	3	2 - 4	1	food related	ceramic	stoneware	white salt-glazed	vessel	fragment	rim, burned
2	3	2 - 4	1	food related	glass	green	flat	bottle	fragment	
2	3	2 - 4	6	food remains	organic	bone	avian	bone	fragment	
2	3	2 - 4	1	food remains	organic	bone	fish	bone	fragment	vertebra
2	3	2 - 4	10	food remains	organic	bone	mammal	bone	fragment	2 cut, 2 burned
2	3	2 - 4	3	food remains	organic	bone	mammal	bone	fragment	1 possible tooth fragment
2	3	2 - 4	4	food remains	organic	bone	medium mammal	bone	fragment	
2	3	2 - 4	4	food remains	organic	shell	clam	shell	complete	
2	3	2 - 4	1	food remains	organic	shell	clam	shell	fragment	
2	3	2 - 4	1	food remains	organic	shell	oyster	shell	complete	
2	3	2 - 4	2	personal	ceramic	earthenware	redware	flowerpot	fragment	saucer
2	3	2 - 4	7	personal	clay	kaolin	smoking pipe	pipe stem	fragment	
2	3	2 - 4	1	personal	clay	kaolin	smoking pipe	pipe stem	fragment	incised band on stem
2	3	2 - 4	1	unaffiliated	ceramic	earthenware	redware	vessel	spall	
2	3	2 - 4	3	unaffiliated	organic	wood		charcoal	fragment	
2	3	5	4	architectural	ceramic	earthenware	tin-glazed	tile	fragment	traces of blue decoration
2	3	5	1	architectural	clay			brick	fragment	
2	3	5	1	architectural	glass	light green tint	flat	window	fragment	
2	3	5	7	architectural	metal	iron	cut	nail	fragment	
2	3	5	1	food related	ceramic	earthenware	buff-bodied	vessel	fragment	clear glaze interior, unglazed exterior
2	3	5	3	food related	ceramic	earthenware	buff-bodied	vessel	fragment	trailed brown slip decoration



Trench	Feature	Level	No.	Functional Group	Class	Material	Type	Object	Part	Description
2	3	5	1	food related	ceramic	earthenware	creamware	handle	fragment	
2	3	5	4	food related	ceramic	earthenware	creamware	plate	fragment	feather edge decoration
2	3	5	1	food related	ceramic	earthenware	creamware	vessel	fragment	rim, molded diamond edge decoration
2	3	5	9	food related	ceramic	earthenware	creamware	vessel	fragment	undecorated body
2	3	5	2	food related	ceramic	earthenware	creamware	vessel	fragment	base, undecorated
2	3	5	1	food related	ceramic	earthenware	creamware	vessel	fragment	rim, molded dotted edge decoration
2	3	5	1	food related	ceramic	earthenware	creamware	vessel	fragment	base, footed small vessel
2	3	5	1	food related	ceramic	earthenware	pearlware	vessel	fragment	molded sprig decorated blue edge
2	3	5	1	food related	ceramic	earthenware	pearlware	vessel	fragment	rim, handpainted polychrome decoration
2	3	5	1	food related	ceramic	earthenware	pearlware	vessel	fragment	rim, with handpainted blue decoration
2	3	5	2	food related	ceramic	earthenware	redware	vessel	fragment	mottled surface colors of tans and browns
2	3	5	1	food related	ceramic	earthenware	redware	vessel	fragment	rim, slip decorated, pie crust
2	3	5	1	food related	ceramic	earthenware	redware	vessel	fragment	rim, green and cream slip decoration, pie crust
2	3	5	1	food related	ceramic	earthenware	redware	vessel	fragment	body, green brown glaze, int and ext
2	3	5	1	food related	ceramic	earthenware	redware	vessel	fragment	rim, with light brown speckled glaze int and ext
2	3	5	1	food related	ceramic	earthenware	redware	vessel	fragment	unidentified glaze, burned
2	3	5	1	food related	ceramic	earthenware	tin-glazed	vessel	fragment	handpainted geometric design
2	3	5	3	food related	ceramic	earthenware	tin-glazed	vessel	fragment	scalloped rim
2	3	5	2	food related	ceramic	earthenware	unidentified	vessel	fragment	burned rims
2	3	5	5	food related	ceramic	porcelain	Chinese export	vessel	fragment	trace of handpainted blue design
2	3	5	1	food related	ceramic	stoneware	gray-bodied	bottle	fragment	brown salt glazed
2	3	5	1	food related	glass	dark green	free blown	bottle	fragment	lip to shoulder, roughly square
2	3	5	2	food related	glass	dark green	free blown	bottle	fragment	possibly from case bottle
2	3	5	1	food related	glass	green tint	unidentified	bottle	fragment	
2	3	5	1	food related	glass	light green tint		vessel	fragment	small diameter, possible vial
2	3	5	1	food related	glass	olive green	free blown	bottle	fragment	partial base
2	3	5	5	food remains	organic	bone	avian	bone	fragment	
2	3	5	1	food remains	organic	bone	fish	bone	fragment	
2	3	5	8	food remains	organic	bone	large mammal	bone	fragment	4 cut fragments
2	3	5	12	food remains	organic	bone	mammal	bone	fragment	1 cut
2	3	5	5	food remains	organic	bone	mammal	bone	fragment	calcined
2	3	5	3	food remains	organic	bone	medium mammal	bone	fragment	
2	3	5	5	food remains	organic	bone	small mammal	bone	fragment	

Trench	Feature	Level	No.	Functional Group	Class	Material	Type	Object	Part	Description
2	3	5	3	food remains	organic	shell	clam	shell	fragment	
2	3	5	1	food remains	organic	shell	scallop	shell	fragment	
2	3	5	1	personal	clay	kaolin	smoking pipe	pipe bowl	fragment	Partial Mark, Incised "W..." in a rouletted circle
2	3	5	7	personal	clay	kaolin	smoking pipe	pipe stem	fragment	
2	3	5	1	personal	metal	brass		straight pin	complete	ball head
2	3	6	1	architectural	glass	light green tint	flat	window	fragment	
2	3	6	1	architectural	glass	light green tint	flat	window	fragment	
2	3	6	5	architectural	metal	iron	cut	nail	fragment	
2	3	6	2	architectural	other			mortar	fragment	
2	3	6	2	architectural	other			plaster	fragment	
2	3	6	1	faunal	organic	bone	small mammal	bone	fragment	
2	3	6	1	food related	ceramic	earthenware	buff-bodied	vessel	fragment	rim, probably tin-glazed, no glaze extant
2	3	6	1	food related	ceramic	earthenware	buff-bodied	vessel	fragment	
2	3	6	1	food related	ceramic	earthenware	buff-bodied	vessel	spall	coarse, no glaze extant
2	3	6	2	food related	ceramic	earthenware	creamware	plate	fragment	base, no foot, mends
2	3	6	2	food related	ceramic	earthenware	creamware	vessel	fragment	rim, feather edge, probably plate, mends
2	3	6	1	food related	ceramic	earthenware	creamware	vessel	fragment	body, molded basket w/grapes, highlighted w/ green and brown glaze
2	3	6	1	food related	ceramic	earthenware	creamware	vessel	fragment	body, molded ridges, filled w/ black
2	3	6	1	food related	ceramic	earthenware	creamware	vessel	fragment	rim, probably plate, molded diamond edge decoration
2	3	6	2	food related	ceramic	earthenware	creamware	vessel	fragment	body, molded ribbing
2	3	6	1	food related	ceramic	earthenware	creamware	vessel	fragment	rim, lipped for cover, possibly sugar bowl or similar
2	3	6	3	food related	ceramic	earthenware	creamware	vessel	fragment	rim
2	3	6	1	food related	ceramic	earthenware	creamware	vessel	fragment	rim, incised line
2	3	6	1	food related	ceramic	earthenware	creamware	vessel	fragment	body, w/ fleur-de-lis sprigging
2	3	6	9	food related	ceramic	earthenware	creamware	vessel	fragment	body
2	3	6	3	food related	ceramic	earthenware	creamware	vessel	fragment	rim
2	3	6	1	food related	ceramic	earthenware	creamware	vessel	fragment	body, molded straight fluting
2	3	6	2	food related	ceramic	earthenware	creamware	vessel	spall	
2	3	6	1	food related	ceramic	earthenware	pearlware	vessel	fragment	base
2	3	6	1	food related	ceramic	earthenware	pearlware	vessel	fragment	handpainted blue decoration
2	3	6	1	food related	ceramic	earthenware	redware	handle	fragment	brown glaze

Trench	Feature	Level	No.	Functional Group	Class	Material	Type	Object	Part	Description
2	3	6	1	food related	ceramic	earthenware	redware	vessel	fragment	body, brown glaze, int and ext
2	3	6	3	food related	ceramic	earthenware	redware	vessel	fragment	body, dark brown glaze int and ext
2	3	6	1	food related	ceramic	earthenware	redware	vessel	fragment	rim, clear glaze int, trace of piecrust rim
2	3	6	1	food related	ceramic	earthenware	redware	vessel	fragment	body, coarse, clear glaze int
2	3	6	1	food related	ceramic	earthenware	redware	vessel	fragment	rim, green glaze
2	3	6	1	food related	ceramic	earthenware	redware	vessel	fragment	v. coarse temper, no glaze extant, possibly unglazed
2	3	6	1	food related	ceramic	earthenware	redware	vessel	fragment	clear glaze interior, unglazed exterior
2	3	6	1	food related	ceramic	earthenware	tin-glazed	vessel	fragment	body, overglaze handpainted inscription in blue "Come.../...lse y..." in script
2	3	6	1	food related	ceramic	earthenware	tin-glazed	vessel	fragment	body, overglaze handpainted polychrome floral design
2	3	6	1	food related	ceramic	earthenware	tin-glazed	vessel	fragment	body, overglaze blue handpainted geometric design
2	3	6	1	food related	ceramic	earthenware	tin-glazed	vessel	fragment	rim and body, ext had handpainted underglaze blue pagoda design
2	3	6	1	food related	ceramic	earthenware	tin-glazed	vessel	fragment	rim, brown edge decoration, blue handpainted underglaze design
2	3	6	1	food related	ceramic	earthenware	tin-glazed	vessel	fragment	rim, ext has brown sponge decoration w/ trace of green
2	3	6	1	food related	ceramic	earthenware	tin-glazed	vessel	fragment	body, glaze flaking off
2	3	6	2	food related	ceramic	earthenware	tin-glazed	vessel	fragment	rim, rounded (perhaps large scallops)
2	3	6	1	food related	ceramic	earthenware	tin-glazed	vessel	fragment	rim, shallow vessel
2	3	6	1	food related	ceramic	earthenware	tin-glazed	vessel	fragment	rim, with traces of handpainted floral and geometric design int and ext
2	3	6	2	food related	ceramic	earthenware	tin-glazed	vessel	fragment	undecorated body, 1 burned
2	3	6	1	food related	ceramic	earthenware	Whieldon-ware	vessel	fragment	base, probably plate, not footed
2	3	6	3	food related	ceramic	porcelain	Chinese export	vessel	fragment	base, 2 have trace of handpainted blue design, 1 has boats, footed (3 different vessels)
2	3	6	1	food related	ceramic	porcelain	Chinese export	vessel	fragment	rim, handpainted blue design int and ext, int rim has diamond pattern w/in semicircles
2	3	6	2	food related	ceramic	porcelain	Chinese export	vessel	fragment	rim, handpainted blue design, 2 different vessels

Trench	Feature	Level	No.	Functional Group	Class	Material	Type	Object	Part	Description
2	3	6	3	food related	ceramic	porcelain	Chinese export	vessel	fragment	body, handpainted blue design, 3 different vessels
2	3	6	1	food related	ceramic	porcelain	hard-paste	vessel	fragment	
2	3	6	1	food related	ceramic	porcelain	hard-paste	vessel	fragment	body, possibly burned, trace of green glaze
2	3	6	1	food related	ceramic	porcelain	hard-paste	vessel	spall	
2	3	6	1	food related	ceramic	stoneware	buff-bodied	vessel	fragment	rim, probably slip-decorated, glazed both sides
2	3	6	1	food related	ceramic	stoneware	buff-bodied	vessel	fragment	slip-decorated
2	3	6	1	food related	ceramic	stoneware	buff-bodied	vessel	fragment	
2	3	6	1	food related	ceramic	stoneware	gray-bodied	vessel	fragment	rim and body, salt-glaze, cobalt floral design w/ molded banding under flat rim, probably German
2	3	6	1	food related	ceramic	stoneware	gray-bodied	vessel	fragment	base and body, salt-glaze ext, slipped int
2	3	6	1	food related	ceramic	stoneware	gray-bodied	vessel	fragment	salt-glaze
2	3	6	1	food related	ceramic	stoneware	gray-bodied	vessel	fragment	body, thin, brown glaze, slightly matte, turned band decoration, probably English
2	3	6	1	food related	ceramic	stoneware	gray-bodied	vessel	fragment	body, brown salt-glaze, molded band edge decoration, probably German
2	3	6	1	food related	ceramic	stoneware	gray-bodied	vessel	fragment	rim, Westerwald, 2 blue incised bands
2	3	6	1	food related	ceramic	stoneware	white salt-glazed	vessel	fragment	rim, barley pattern w/ wavy basket pattern 1740-1785
2	3	6	1	food related	ceramic	stoneware	white salt-glazed	vessel	fragment	base, footed
2	3	6	3	food related	ceramic	stoneware	white salt-glazed	vessel	fragment	body
2	3	6	1	food related	ceramic	stoneware	white salt-glazed	vessel	fragment	rim, cup or bowl
2	3	6	1	food related	glass	black	blown	bottle	fragment	neck, v dark green/black
2	3	6	2	food related	glass	dark green	blown	bottle	fragment	
2	3	6	1	food related	glass	green	blown	bottle	fragment	
2	3	6	1	food related	glass	green	blown	bottle	fragment	flat, case bottle
2	3	6	1	food related	glass	olive green	blown	bottle	fragment	base, 4" diam, wine or similar
2	3	6	1	food related	glass	olive green	blown	bottle	fragment	base, wine or similar
2	3	6	3	food related	glass	olive green	blown	bottle	fragment	
2	3	6	1	food related	glass	olive green		bottle	fragment	
2	3	6	17	food remains	organic	bone	avian	bone	fragment	
2	3	6	2	food remains	organic	bone	Cow	bone	fragment	Mandible with teeth

Trench	Feature	Level	No.	Functional Group	Class	Material	Type	Object	Part	Description
2	3	6	4	food remains	organic	bone	fish	bone	complete	
2	3	6	18	food remains	organic	bone	large	bone	fragment	3 cut
2	3	6	26	food remains	organic	bone	mammal	bone	fragment	
2	3	6	1	food remains	organic	bone	mammal	tooth	complete	
2	3	6	22	food remains	organic	bone	medium mammal	bone	fragment	1 cut
2	3	6	4	food remains	organic	shell	clam	shell	fragment	
2	3	6	1	food remains	organic	shell	oyster	shell	fragment	
2	3	6	1	personal	ceramic	earthenware	redware	flowerpot	fragment	rim
2	3	6	2	personal	clay	kaolin	smoking pipe	pipe	fragment	pipe bowl and stem (mends), unused, bowl stamped cartouche w/ "W G", and "W" and "G" on either side of heel
2	3	6	18	personal	clay	kaolin	smoking pipe	pipe stem	fragment	
2	3	6	2	personal	clay	kaolin	smoking pipe	pipe stem	fragment	salt glazed int and ext, trace of blue decoration
2	3	6	1	personal	organic	bone		button blank	fragment	bone strip with circular cutouts 1/2" diam
2	3	6	4	personal	organic	bone		button blank	fragment	bone strip with circular cutouts 1/2" diam
2	3	6	1	unaffiliated	other	slate		unidentified	fragment	
2	3	7	1	architectural	other			plaster	fragment	
2	3	7	1	food related	ceramic	earthenware	cream-colored	vessel	fragment	handpainted polychrome overglaze floral decoration
2	3	7	1	food related	ceramic	earthenware	creamware	vessel	fragment	base, possibly teacup or small bowl, molded ridges in circle at center int
2	3	7	1	food related	ceramic	earthenware	creamware	vessel	fragment	rim and body, indentation to hold lid, possibly sugar bowl or similar
2	3	7	2	food related	ceramic	earthenware	creamware	vessel	fragment	
2	3	7	1	food related	ceramic	earthenware	creamware	vessel	fragment	rim, possibly teacup
2	3	7	2	food related	ceramic	earthenware	redware	vessel	fragment	rim, body, dark brown glaze int and ext, molded annular design
2	3	7	3	food related	ceramic	porcelain	Chinese export	bowl	fragment	small bowl, blue handpainted pagoda scene, 2 pcs mend
2	3	7	1	food related	ceramic	stoneware	buff-bodied	handle	fragment	salt-glazed
2	3	7	1	food related	ceramic	stoneware	buff-bodied	vessel	fragment	rim, salt-glazed, probably for crock
2	3	7	1	food related	ceramic	stoneware	gray-bodied	vessel	fragment	probably Rhenish, incised lines
2	3	7	1	food related	ceramic	stoneware	white salt-glazed	vessel	fragment	
2	3	7	1	food related	glass	olive green		bottle	fragment	

Trench	Feature	Level	No.	Functional Group	Class	Material	Type	Object	Part	Description
2	3	7	2	food remains	organic	bone	medium mammal	vertebra	fragment	
2	3	7	1	food remains	organic	bone	medium mammal	tibia	fragment	juvenile
2	3	7	1	food remains	organic	bone	medium mammal	long bone	fragment	cut
2	3	7	1	food remains	organic	bone	large mammal	long bone	fragment	cut
2	3	7	1	food remains	organic	bone	large mammal	bone	fragment	
2	3	7	1	unaffiliated	clay			tile	fragment	curved with mortar
2	3	7		personal	ceramic	stoneware	buff-bodied	chamberpot	fragment	salt glazed, mends, handpainted blue grape motif, crudely made, 1 handle
2	3	7	2	personal	clay	kaolin	smoking pipe	pipe stem	fragment	
2	3	7	1	unaffiliated	clay			tile	fragment	curved with mortar
2	3	7	18	personal	ceramic	stoneware	buff-bodied	chamberpot	fragment	salt glazed, mends, handpainted blue grape motif, crudely made, 1 handle
2	3	7	2	personal	clay	kaolin	smoking pipe	pipe stem	fragment	
2	3	clean up	1	architectural	ceramic	earthenware	tin-glazed	tile	fragment	
2	3	clean up	1	architectural	clay			brick	fragment	
2	3	clean up	2	food related	ceramic	earthenware	buff-bodied	vessel	fragment	1 rim, piecrust edge, 1 body, slip-decorated
2	3	clean up	1	food related	ceramic	earthenware	buff-bodied	vessel	fragment	buff yellow glazed exterior/interior
2	3	clean up	1	food related	ceramic	earthenware	creamware	vessel	fragment	rim, wavy edge
2	3	clean up	1	food related	ceramic	earthenware	creamware	vessel	fragment	base, footed
2	3	clean up	1	food related	ceramic	earthenware	creamware	vessel	fragment	base, possibly teacup
2	3	clean up	1	food related	ceramic	earthenware	creamware	vessel	fragment	body
2	3	clean up	1	food related	ceramic	earthenware	creamware	vessel	fragment	rim, molded dots in band edge decoration
2	3	clean up	1	food related	ceramic	earthenware	creamware	vessel	fragment	rim, molded feather edge decoration, plate or saucer
2	3	clean up	1	food related	ceramic	earthenware	creamware	vessel	fragment	part of undecorated small circular container base
2	3	clean up	4	food related	ceramic	earthenware	creamware	vessel	fragment	
2	3	clean up	1	food related	ceramic	earthenware	pearlware	vessel	fragment	
2	3	clean up	1	food related	ceramic	earthenware	pearlware	vessel	fragment	blue transferprint
2	3	clean up	1	food related	ceramic	earthenware	redware	vessel	fragment	rim, probably bowl, incised edge decoration, green glaze w/ slip decoration
2	3	clean up	1	food related	ceramic	earthenware	redware	vessel	fragment	dark brown glaze int and ext
2	3	clean up	1	food related	ceramic	earthenware	redware	vessel	fragment	rim and body, probably bowl, brown glaze int, unglazed ext, burned

Trench	Feature	Level	No.	Functional Group	Class	Material	Type	Object	Part	Description
2	3	clean up	1	food related	ceramic	earthenware	redware	vessel	fragment	rim, scalloped, probably plate, white tin/lead glaze
2	3	clean up	1	food related	ceramic	earthenware	redware	vessel	fragment	traces of trailed slip decoration
2	3	clean up	1	food related	ceramic	earthenware	redware	vessel	fragment	brown glaze exterior, yellow glazed interior
2	3	clean up	1	food related	ceramic	earthenware	tin-glazed	vessel	fragment	Delft, blue handpainted design ext
2	3	clean up	1	food related	ceramic	earthenware	tin-glazed	plate	fragment	traces of handpainted brown decoration
2	3	clean up	1	food related	ceramic	earthenware	tin-glazed	vessel	fragment	handpainted blue decoration
2	3	clean up	1	food related	ceramic	earthenware	tin-glazed	vessel	fragment	rim, handpainted blue geometric design
2	3	clean up	1	food related	ceramic	earthenware	unidentified	vessel	fragment	clay flat base burned
2	3	clean up	1	food related	ceramic	earthenware	whiteware	vessel	fragment	molded fluing w/ trace of green glaze
2	3	clean up	1	food related	ceramic	porcelain	hard-paste	vessel	fragment	base, plate or saucer, handpainted blue floral design, later Chinese export
2	3	clean up	1	food related	ceramic	stoneware	gray-bodied	vessel	fragment	salt-glazed ext, tan int
2	3	clean up	1	food related	ceramic	stoneware	gray-bodied	vessel	fragment	salt-glazed int and ext
2	3	clean up	1	food related	ceramic	stoneware	gray-bodied	vessel	fragment	rim, probably mug or tankard, salt-glazed, molded edge banding w/ cobalt decoration, Westerwald-like
2	3	clean up	1	food related	ceramic	stoneware	white salt-glazed	vessel	fragment	base, probably plate
2	3	clean up	1	food related	glass	dark green		bottle	fragment	
2	3	clean up	1	food related	glass	green		bottle	fragment	
2	3	clean up	1	food related	glass	olive green		bottle	fragment	
2	3	clean up	2	food remains	organic	bone	avian	long bone	fragment	
2	3	clean up	1	food remains	organic	bone	avian	rib	fragment	or small mammal
2	3	clean up	1	food remains	organic	bone	large mammal	long bone	fragment	
2	3	clean up	1	food remains	organic	bone	large mammal	rib	fragment	
2	3	clean up	6	food remains	organic	bone	large mammal	rib	fragment	
2	3	clean up	8	food remains	organic	bone	mammal	bone	fragment	1 pc cut
2	3	clean up	7	food remains	organic	bone	mammal	bone	fragment	
2	3	clean up	2	food remains	organic	shell	clam	shell	fragment	
2	3	clean up	1	food remains	organic	shell	clam	shell	fragment	small size
2	3	clean up	2	personal	clay	kaolin	smoking pipe	pipe stem	fragment	fairly large bore
2	3	clean up	1	personal	clay	kaolin	smoking pipe	pipe stem	fragment	impressed mark w/ initials, possibly "IDR" "LDP" "ILP" or combination thereof, fairly large bore
2	3	clean up	2	personal	clay	kaolin	smoking pipe	pipe stem	fragment	

Trench	Feature	Level	No.	Functional Group	Class	Material	Type	Object	Part	Description
2	3	clean up	1	personal	metal	iron		lock	complete	
2	3	clean up	1	personal	organic	bone		button blank	fragment	bone strip with circular cutouts 1/2" diam
2	5	interior	1	food related	ceramic	earthenware	buff-bodied	vessel	fragment	trailed slip decoration
2	5	interior	3	food related	ceramic	porcelain	hard-paste	vessel	fragment	no decoration
2	5	interior	4	food related	ceramic	porcelain	hard-paste	bowl	fragment	with applied blue sprig
2	5	interior	1	food related	ceramic	earthenware	ironstone	vessel	fragment	black transferprint
6	6	interior	1	architectural	glass	light green tint	flat	window	fragment	
6	6	interior	2	architectural	metal	iron	unidentified	nail	fragment	
6	6	interior	1	food related	ceramic	earthenware	tin-glazed	vessel	spall	
6	6	interior	1	food related	ceramic	earthenware	redware	vessel	fragment	unglazed
6	6	interior	1	food related	ceramic	earthenware	redware	vessel	fragment	dark brown glaze int and ext
6	6	interior	1	food related	ceramic	earthenware	redware	vessel	fragment	trailed slip decoration, pie crust rim
6	6	interior	2	food related	ceramic	earthenware	buff-bodied	vessel	fragment	dark brown slip decoration
6	6	interior	2	food related	ceramic	earthenware	creamware	vessel	fragment	no decoration
6	6	interior	3	food related	ceramic	earthenware	cream-colored	vessel	fragment	no decoration
6	6	interior	2	food related	ceramic	earthenware	pearlware	vessel	fragment	handpainted blue decoration - Chinese motif
6	6	interior	1	food related	ceramic	earthenware	pearlware	vessel	fragment	blue shell edge
6	6	interior	1	food related	ceramic	earthenware	pearlware	vessel	fragment	base of oval dish or small pitcher
6	6	interior	1	food related	ceramic	stoneware	white salt-glazed	vessel	fragment	
6	6	interior	1	food related	ceramic	stoneware	gray-bodied	vessel	fragment	salt glazed exterior with blue geometric decoration
6	6	interior	2	food related	ceramic	porcelain	Chinese export	vessel	fragment	
6	6	interior	1	food related	glass	green	mold-blown	bottle	fragment	
6	6	interior	1	food related	glass	olive green	mold-blown	bottle	fragment	
6	6	interior	1	food related	glass	colorless	mold-blown	bottle	fragment	
6	6	interior	3	food remains	organic	bone	mammal	bone	fragment	
6	6	interior	1	food remains	organic	bone	chicken	bone	complete	
6	6	interior	1	food remains	organic	shell	unidentified	shell	fragment	
6	6	interior	1	personal	clay	kaolin	smoking pipe	pipe bowl	fragment	
6	6	interior	1	unaffiliated	metal	copper alloy	brass	tack	complete	
6	6	interior	2	unaffiliated	organic	wood	cut	wood	fragment	small cut square, mends
6	6	interior	2	unaffiliated	metal	iron		unidentified	fragment	
8b	7	1	1	food related	ceramic	earthenware	cream-colored	vessel	fragment	base
8b	7	1	1	food related	ceramic	earthenware	redware	vessel	fragment	brown glaze int



Trench	Feature	Level	No.	Functional Group	Class	Material	Type	Object	Part	Description
8b	7	1	1	food related	ceramic	earthenware	redware	vessel	fragment	thick rim with traces of brown glaze int and slip band around edge
8b	7	1	4	food related	ceramic	earthenware	whiteware	vessel	fragment	blue transferprint floral designs with basket weave edge decoration, mend
8b	7	1	1	food related	ceramic	earthenware	whiteware	vessel	fragment	blue transferprint floral and scroll design int and ext
8b	7	1	1	food related	ceramic	stoneware	buff-bodied	vessel	fragment	mottled salt glazed exterior
8b	7	1	1	food related	ceramic	stoneware	gray-bodied	vessel	fragment	salt-glazed ext, tan int
8b	7	1	1	food related	glass	olive green	mold-blown	bottle	fragment	case, base with mortar and mixed artifacts stuck interior
8b	7	1	1	unaffiliated	metal	lead		unidentified	fragment	
8b	7	2	9	architectural	glass	light green tint	flat	window	fragment	
8b	7	2	1	architectural	metal	iron	cut	nail	fragment	
8b	7	2	1	architectural	metal	iron	wrought	nail	complete	
8b	7	2	2	food related	ceramic	earthenware	agate ware-type	vessel	fragment	mottled surface colors of tans and browns
8b	7	2	2	food related	ceramic	earthenware	buff-bodied	handle	fragment	
8b	7	2	7	food related	ceramic	earthenware	buff-bodied	vessel	fragment	body
8b	7	2	5	food related	ceramic	earthenware	buff-bodied	vessel	fragment	body, dark brown combed slip-decorated
8b	7	2	2	food related	ceramic	earthenware	buff-bodied	vessel	fragment	rim, dark brown dotted slip-decorated
8b	7	2	3	food related	ceramic	earthenware	buff-bodied	vessel	fragment	body, slip-decorated, brown/dark brown
8b	7	2	1	food related	ceramic	earthenware	buff-bodied	vessel	fragment	no glaze extant, probably tin-glazed
8b	7	2	1	food related	ceramic	earthenware	buff-bodied	vessel	fragment	int white, ext green glaze, possibly tin-glazed
8b	7	2	1	food related	ceramic	earthenware	buff-bodied	vessel	fragment	bisque colored glaze int and ext
8b	7	2	1	food related	ceramic	earthenware	buff-bodied	vessel	spall	trace of white glaze
8b	7	2	4	food related	ceramic	earthenware	cream-colored	plate	fragment	rim and body, probably creamware, black transfer print overglaze; foliate scroll on rim, and wreath decoration with book in center
8b	7	2	1	food related	ceramic	earthenware	creamware	vessel	fragment	rim, probably platter or charger, molded bead design
8b	7	2	1	food related	ceramic	earthenware	mochaware	vessel	fragment	only brown slip visible
8b	7	2	4	food related	ceramic	earthenware	pearlware	teacup	fragment	handpainted polychrome, body, base, green, brown, blue, red, different items

Trench	Feature	Level	No.	Functional Group	Class	Material	Type	Object	Part	Description
8b	7	2	4	food related	ceramic	earthenware	pearlware	vessel	fragment	green shell-edged
8b	7	2	1	food related	ceramic	earthenware	pearlware	vessel	fragment	brown transfer print, landscape scene
8b	7	2	1	food related	ceramic	earthenware	pearlware	vessel	fragment	rim, black transfer print, floral edge decoration, scalloped rim
8b	7	2	1	food related	ceramic	earthenware	pearlware	vessel	fragment	rim, handpainted blue and white design
8b	7	2	1	food related	ceramic	earthenware	redware	bottle	fragment	lip, brown (tortoise) glaze int, partial glaze ext
8b	7	2	1	food related	ceramic	earthenware	redware	milk pan	fragment	no glaze extant
8b	7	2	1	food related	ceramic	earthenware	redware	vessel	fragment	body, slip-decorated brown one side
8b	7	2	2	food related	ceramic	earthenware	redware	vessel	fragment	rim, possibly milk pan, piecrust edge, slip-decorated green and cream
8b	7	2	1	food related	ceramic	earthenware	redware	vessel	fragment	body, cream glaze int, brown glaze ext w/ polychrome encrustation
8b	7	2	1	food related	ceramic	earthenware	redware	vessel	fragment	blue lead glaze ext, cream colored lead glaze int
8b	7	2	2	food related	ceramic	earthenware	redware	vessel	fragment	body, dk brown glaze int and ext
8b	7	2	1	food related	ceramic	earthenware	redware	vessel	fragment	base, dk brown glaze int, partial dk brown glaze ext (base unglazed)
8b	7	2	1	food related	ceramic	earthenware	redware	vessel	fragment	rim, dk brown glaze in and ext
8b	7	2	2	food related	ceramic	earthenware	redware	vessel	fragment	rim, body, brown glaze int and ext
8b	7	2	3	food related	ceramic	earthenware	redware	vessel	fragment	body, lt brown glaze int and ext
8b	7	2	1	food related	ceramic	earthenware	redware	vessel	fragment	body, lt brown glaze ext with molded lines, burnished int
8b	7	2	1	food related	ceramic	earthenware	redware	vessel	fragment	rim, possibly milk pan, lt brown glaze int
8b	7	2	1	food related	ceramic	earthenware	redware	vessel	fragment	rim, clear glaze int, ext burnished
8b	7	2	3	food related	ceramic	earthenware	redware	vessel	fragment	body, clear glaze w/ brown slip decoration int and ext
8b	7	2	1	food related	ceramic	earthenware	redware	vessel	fragment	rim, lt brown ext, lt brown w/ dk brown slip decoration int
8b	7	2	1	food related	ceramic	earthenware	redware	vessel	fragment	body, brown glaze int w/ cream slip decoration, unglazed ext
8b	7	2	1	food related	ceramic	earthenware	tin-glazed	vessel	fragment	base, footed, blue tint
8b	7	2	1	food related	ceramic	earthenware	tin-glazed	vessel	fragment	rim, trace of handpainted blue line
8b	7	2	3	food related	ceramic	earthenware	tin-glazed	vessel	fragment	body, handpainted blue design
8b	7	2	2	food related	ceramic	earthenware	tin-glazed	vessel	fragment	body
8b	7	2	1	food related	ceramic	earthenware	whiteware	vessel	fragment	body, purple transfer print, landscape design

Trench	Feature	Level	No.	Functional Group	Class	Material	Type	Object	Part	Description
8b	7	2	2	food related	ceramic	earthenware	whiteware	vessel	fragment	body, green transfer print, geometric cross design
8b	7	2	1	food related	ceramic	earthenware	whiteware	vessel	fragment	lip and neck, possibly bottle, trace of white glaze below lip
8b	7	2	1	food related	ceramic	earthenware	yellowware	vessel	fragment	rim
8b	7	2	12	food related	ceramic	porcelain	Chinese export	bowl	fragment	rim, body, base, handpainted blue and white Asian scene, mends
8b	7	2	1	food related	ceramic	porcelain	Chinese export	bowl	fragment	polychrome handpainted overglaze vine design, base
8b	7	2	1	food related	ceramic	porcelain	Chinese export	plate	fragment	base, handpainted blue and white Asian scene
8b	7	2	5	food related	ceramic	porcelain	Chinese export	teacup	fragment	rim, body, base, handpainted blue and white Asian scenes, different items
8b	7	2	1	food related	ceramic	porcelain	Chinese export	teacup	fragment	base, handpainted black and red boat design, overglaze
8b	7	2	3	food related	ceramic	porcelain	Chinese export	vessel	fragment	body, traces of handpainted overglaze design
8b	7	2	1	food related	ceramic	porcelain	hard-paste	teacup	fragment	rim and body, gilt banding at top int and ext, overglaze polychrome floral design
8b	7	2	2	food related	ceramic	porcelain	hard-paste	vessel	fragment	body
8b	7	2	1	food related	ceramic	porcelain	hard-paste	vessel	fragment	base, traces of blue design
8b	7	2	1	food related	ceramic	porcelain	hard-paste	vessel	fragment	overglaze polychrome design
8b	7	2	1	food related	ceramic	stoneware	buff-bodied	jug	fragment	body w/ trace of handle, salt-glaze ext w/ blue design, no glaze int, American
8b	7	2	3	food related	ceramic	stoneware	buff-bodied	vessel	fragment	body, tan ext, dk brown int
8b	7	2	2	food related	ceramic	stoneware	buff-bodied	vessel	fragment	body, salt-glazed ext, dk brown int, overfired cobalt decoration
8b	7	2	1	food related	ceramic	stoneware	buff-bodied	vessel	fragment	body, salt-glazed ext, dk brown glaze int
8b	7	2	1	food related	ceramic	stoneware	English brown	vessel	fragment	body, base, possibly tankard, molded band design, brown int and ext
8b	7	2	2	food related	ceramic	stoneware	gray-bodied	bottle	fragment	lip and neck, brown/lt brown glaze ext, unglazed int, German
8b	7	2	1	food related	ceramic	stoneware	gray-bodied	bottle	fragment	body, dk brown salt-glaze w/ cream decoration, clear salt-glaze int
8b	7	2	4	food related	ceramic	stoneware	gray-bodied	jug	fragment	body, 1 pc impressed "5", salt-glazed ext, dk brown glaze int

Trench	Feature	Level	No.	Functional Group	Class	Material	Type	Object	Part	Description
8b	7	2	2	food related	ceramic	stoneware	gray-bodied	jug	fragment	body, lt brown salt-glaze ext, brown glaze int
8b	7	2	1	food related	ceramic	stoneware	gray-bodied	vessel	fragment	body, brown salt-glaze ext, unglazed int, possibly German
8b	7	2	2	food related	ceramic	stoneware	gray-bodied	vessel	fragment	rim, probably crock, salt-glazed int and ext, 2 items
8b	7	2	2	food related	ceramic	stoneware	gray-bodied	vessel	fragment	body, salt-glazed ext, lt brown int, probably German
8b	7	2	2	food related	ceramic	stoneware	gray-bodied	vessel	fragment	body, salt-glaze ext, unglazed int
8b	7	2	1	food related	ceramic	stoneware	gray-bodied	vessel	fragment	body w/ partial eared handle, tan salt-glaze ext and brown slip, smooth brown glaze int
8b	7	2	1	food related	ceramic	stoneware	gray-bodied	vessel	fragment	body, salt-glazed ext w/ blue decoration, tan glaze int
8b	7	2	1	food related	ceramic	stoneware	gray-bodied	vessel	fragment	rim, salt-glazed w/ blue twined design, flat flared rim, possibly basin
8b	7	2	1	food related	ceramic	stoneware	scratch blue	vessel	fragment	
8b	7	2	2	food related	ceramic	stoneware	white salt-glazed	teacup	fragment	bases, 2 items
8b	7	2	1	food related	ceramic	stoneware	white salt-glazed	vessel	fragment	rim, probably plate, scalloped rim, molded dot and diamond design
8b	7	2	1	food related	ceramic	stoneware	white salt-glazed	vessel	fragment	body, molded annular ring on shoulder
8b	7	2	1	food related	glass	bright green tint		bottle	fragment	body
8b	7	2	3	food related	glass	colorless		tumbler	fragment	bases, approx 2.5" diam, 3 items
8b	7	2	1	food related	glass	colorless		tumbler	fragment	base
8b	7	2	5	food related	glass	colorless		tumbler	fragment	body
8b	7	2	6	food related	glass	colorless		tumbler	fragment	rim
8b	7	2	1	food related	glass	colorless		vessel	fragment	body, possibly bottle
8b	7	2	1	food related	glass	colorless		vessel	fragment	possibly frosted, body
8b	7	2	1	food related	glass	colorless		vessel	fragment	body, probably tumbler, faceted, etched
8b	7	2	1	food related	glass	dark green	turn mold	bottle	fragment	base, 3" diam, wine or similar, 1.5" kickup
8b	7	2	2	food related	glass	dark green		bottle	fragment	bases
8b	7	2	7	food related	glass	dark green		bottle	fragment	body
8b	7	2	1	food related	glass	green tint		bottle	fragment	body
8b	7	2	1	food related	glass	light green tint		bottle	fragment	body

Trench	Feature	Level	No.	Functional Group	Class	Material	Type	Object	Part	Description
8b	7	2	1	food related	glass	olive green	turn mold	bottle	fragment	base, 4" diam, wine or similar, 2" kickup
8b	7	2	1	food related	glass	olive green		bottle	fragment	neck
8b	7	2	4	food related	glass	olive green		bottle	fragment	body
8b	7	2	8	food related	glass	olive green		bottle	fragment	body, v. thin
8b	7	2	1	food remains	organic	bone	mammal	bone	fragment	cut vertebrae
8b	7	2	1	food remains	organic	bone	mammal	bone	fragment	
8b	7	2	7	food remains	organic	bone	medium mammal	long bone	fragment	
8b	7	2	1	food remains	organic	bone	medium mammal	long bone	fragment	cut
8b	7	2	1	food remains	organic	bone	medium mammal	rib	fragment	
8b	7	2	1	food remains	organic	bone		bone	fragment	calcined
8b	7	2	1	medicinal	glass	light green tint	mold-blown	bottle	fragment	base, body, chamfered corners, rectangular, pontil mark
8b	7	2	10	personal	ceramic	earthenware	redware	flowerpot	fragment	bodies, rims, at least 3 items
8b	7	2	1	personal	clay	kaolin	smoking pipe	pipe bowl	fragment	unused, w/ spur and part of stem, and "WN" scratched in clay
8b	7	2	1	personal	clay	kaolin	smoking pipe	pipe bowl	fragment	used
8b	7	2	4	personal	clay	kaolin	smoking pipe	pipe stem	fragment	used
8b	7	2	10	personal	clay	kaolin	smoking pipe	pipe stem	fragment	unused
8b	7	2	1	personal	glass	colorless	free blown	bottle	fragment	3.5" H, top broken off, swirled body, possibly for perfume
8b	7	2	3	unaffiliated	ceramic	earthenware	redware	vessel	fragment	bases, probably flowerpots
8b	7	2	6	unaffiliated	ceramic	earthenware	redware	vessel	fragment	probably unglazed
8b	7	2	1	unaffiliated	clay			utility pipe	fragment	portion of large connector piece
8b	7	2	2	unaffiliated	clay			utility pipe	fragment	incised lines
8b	7	2	1	unaffiliated	metal	brass		knob	complete	oval, mid-sized, possibly for cupboard or similar
8b	7	2	1	unaffiliated	metal	iron		D-ring	fragment	
8b	7	2	1	unaffiliated	metal	lead		unidentified	fragment	dome-shaped
8b	7	2	1	unaffiliated	other		anthracite	coal	fragment	
8b	7	2	1	unaffiliated	stone	honey chert		nodule	complete	possibly French
8b	7	3	2	architectural	glass	light green tint	flat	window	fragment	
8b	7	3	8	food related	ceramic	earthenware	cream-colored	bowl	fragment	with shell edge decoration no color, mends
8b	7	3	1	food related	ceramic	earthenware	cream-colored	vessel	fragment	
8b	7	3	2	food related	ceramic	earthenware	creamware	vessel	fragment	

Trench	Feature	Level	No.	Functional Group	Class	Material	Type	Object	Part	Description
8b	7	3	19	food related	ceramic	earthenware	pearlware	bowl	fragment	blue shell edge decoration, impressed on base "Adams"
8b	7	3	1	food related	ceramic	earthenware	pearlware	bowl	fragment	blue transferprint floral and fruit basket motif, impressed circle with Eagle and "E. Wood & Sons/Warranted Burslem/Semi China"
8b	7	3	3	food related	ceramic	earthenware	pearlware	bowl	fragment	blue transferprint floral and basket motif, mends
8b	7	3	5	food related	ceramic	earthenware	pearlware	plate	fragment	blue edge decorated, molded and scalloped rim
8b	7	3	2	food related	ceramic	earthenware	pearlware	spout	fragment	for teapot, blue floral transferprint, mends
8b	7	3	12	food related	ceramic	earthenware	pearlware	teacup	fragment	blue transferprint floral and fruit basket motif, mends with handle, footed, impressed on base "17"
8b	7	3	3	food related	ceramic	earthenware	pearlware	teacup	fragment	blue transferprint floral and fruit basket motif, mends
8b	7	3	17	food related	ceramic	earthenware	pearlware	teacup	fragment	blue transferprint, landscape with figures design
8b	7	3	7	food related	ceramic	earthenware	pearlware	vessel	fragment	blue transferprint, square base, possible teapot, impressed on foot "18"
8b	7	3	3	food related	ceramic	earthenware	pearlware	vessel	fragment	scallop blue shell edge rim with feather molding, impressed circle with Eagle and "Enoch Wood & Sons/Burslem" on base
8b	7	3	6	food related	ceramic	earthenware	pearlware	vessel	fragment	blue shell edge
8b	7	3	1	food related	ceramic	earthenware	pearlware	vessel	fragment	blue edge decorated with molded wheat pattern
8b	7	3	5	food related	ceramic	earthenware	pearlware	vessel	fragment	traces of blue transferprint
8b	7	3	2	food related	ceramic	earthenware	pearlware	vessel	fragment	undecorated
8b	7	3	16	food related	ceramic	earthenware	pearlware	vessel	fragment	blue transferprint Asian landscape scene, impressed "HARLE"
8b	7	3	6	food related	ceramic	earthenware	redware	bowl	fragment	clear glaze and dark brown slip decoration
8b	7	3	2	food related	ceramic	earthenware	redware	lid	fragment	for tureen, embossed beaded design with slip decoration
8b	7	3	1	food related	ceramic	porcelain	Chinese export	vessel	fragment	base, handpainted blue floral design
8b	7	3	1	food related	ceramic	porcelain	hard-paste	vessel	fragment	

Trench	Feature	Level	No.	Functional Group	Class	Material	Type	Object	Part	Description
8b	7	3	1	food related	ceramic	porcelain	soft-paste	vessel	fragment	traces of overglaze decoration
8b	7	3	1	food related	ceramic	stoneware	gray-bodied	vessel	fragment	traces of blue decoration, salt glaze
8b	7	3	1	food related	ceramic	stoneware	white salt-glazed	vessel	fragment	rim
8b	7	3	1	food related	glass	colorless		vessel	fragment	possible base of tumbler
8b	7	3	1	food related	glass	dark green		bottle	fragment	
8b	7	3	2	food related	glass	green		bottle	fragment	
8b	7	3	1	food related	glass	olive green		bottle	fragment	
8b	7	3	1	personal	ceramic	earthenware	redware	flowerpot	fragment	
8b	7	3	1	personal	clay	kaolin	smoking pipe	pipe bowl	fragment	molded, ribbed with swags and leaf design, unused
8b	7	3	1	personal	clay	kaolin	smoking pipe	pipe stem	fragment	
8b	7	3	1	personal	other	slate		slate	fragment	with scratched design
8b	8	1	1	food related	ceramic	earthenware	buff-bodied	vessel	fragment	traces of trailed slip decoration
8b	8	1	1	food related	ceramic	earthenware	buff-bodied	vessel	fragment	yellow exterior, brown glazed interior
8b	8	1	1	food related	ceramic	earthenware	buff-bodied	vessel	fragment	yellow glazed exterior/interior
8b	8	1	9	food related	ceramic	earthenware	cream-colored	vessel	fragment	thick
8b	8	1	1	food related	ceramic	earthenware	cream-colored	vessel	fragment	handpainted brown decoration
8b	8	1	9	food related	ceramic	earthenware	creamware	vessel	fragment	
8b	8	1	5	food related	ceramic	earthenware	ironstone	cup	fragment	molded gothic decoration
8b	8	1	4	food related	ceramic	earthenware	ironstone	cup	fragment	no decoration
8b	8	1	4	food related	ceramic	earthenware	ironstone	vessel	fragment	foot ring
8b	8	1	1	food related	ceramic	earthenware	jackfield	vessel	fragment	molded exterior
8b	8	1	1	food related	ceramic	earthenware	pearlware	vessel	fragment	green shell-edged
8b	8	1	2	food related	ceramic	earthenware	pearlware	vessel	fragment	blue transferprint
8b	8	1	2	food related	ceramic	earthenware	pearlware	vessel	fragment	no decoration
8b	8	1	1	food related	ceramic	earthenware	pearlware	vessel	fragment	handpainted blue decoration
8b	8	1	1	food related	ceramic	earthenware	redware	vessel	fragment	traces of brown interior glaze
8b	8	1	3	food related	ceramic	earthenware	redware	vessel	fragment	brown glazed interior/exterior with dotted dark brown decoration
8b	8	1	1	food related	ceramic	earthenware	redware	vessel	fragment	brown glazed interior/exterior, ribbed
8b	8	1	1	food related	ceramic	earthenware	redware	vessel	fragment	traces of trailed slip decoration with pie crust rim, no glaze on exterior
8b	8	1	1	food related	ceramic	earthenware	redware	vessel	fragment	traces of trailed slip decoration
8b	8	1	2	food related	ceramic	earthenware	redware	vessel	spall	brown glazed exterior
8b	8	1	1	food related	ceramic	earthenware	tin-glazed	vessel	fragment	exterior purple sponge decoration
8b	8	1	3	food related	ceramic	earthenware	whiteware	cup	fragment	handpainted polychrome floral decoration

Trench	Feature	Level	No.	Functional Group	Class	Material	Type	Object	Part	Description
8b	8	1	7	food related	ceramic	earthenware	whiteware	vessel	fragment	blue transferprint
8b	8	1	2	food related	ceramic	earthenware	whiteware	vessel	fragment	black transferprint floral, landscape
8b	8	1	1	food related	ceramic	porcelain	hard paste	bowl	fragment	handpainted blue decoration
8b	8	1	1	food related	ceramic	porcelain	hard paste	plate	fragment	handpainted blue decoration
8b	8	1	1	food related	ceramic	porcelain	hard paste	vessel	spall	handpainted blue decoration
8b	8	1	1	food related	ceramic	stoneware	buff-bodied	vessel	fragment	gray salt glazed exterior
8b	8	1	1	food related	ceramic	stoneware	buff-bodied	vessel	fragment	brown salt glazed exterior, no glaze interior
8b	8	1	1	food related	ceramic	stoneware	gray-bodied	bottle	fragment	tan salt glazed exterior
8b	8	1	1	food related	ceramic	stoneware	gray-bodied	vessel	fragment	dark brown salt glazed exterior, no glaze interior
8b	8	1	1	food related	glass	blue green	mold made	bottle	fragment	part of the kick up
8b	8	1	1	food related	glass	colorless	etched	tumbler	fragment	starburst, basket, fluted
8b	8	1	3	food related	glass	colorless	pressed	tumbler	fragment	paneled and fluted
8b	8	1	3	food related	glass	colorless		tumbler	fragment	
8b	8	1	1	food related	glass	green	mold made	bottle	fragment	
8b	8	1	2	food related	glass	light green tint	mold made	bottle	fragment	wide mouth condiment or sauce bottle
8b	8	1	1	food related	glass	olive green	mold made	bottle	fragment	
8b	8	1	15	food remains	organic	bone	chicken	bone	fragment	
8b	8	1	9	food remains	organic	bone	cow	bone	fragment	cut (ribeye?, t bone?)
8b	8	1	29	food remains	organic	bone	cow	bone	fragment	cut
8b	8	1	3	food remains	organic	bone	cow	long bone	fragment	cut, shank
8b	8	1	1	food remains	organic	bone	cow	rib	fragment	cut
8b	8	1	13	food remains	organic	bone	fish	bone	fragment	
8b	8	1	21	food remains	organic	bone	medium mammal	bone	fragment	cut
8b	8	1	21	food remains	organic	bone	medium mammal	bone	fragment	
8b	8	1	1	medicinal	glass	light green tint	mold made	bottle	fragment	or possible perfume, paneled (six sided)
8b	8	1	1	personal	ceramic	porcelain		button	complete	four hole
8b	8	1	1	personal	ceramic	porcelain		button	complete	small four hole, front red glazed
8b	8	1	7	personal	clay	kaolin	smoking pipe	pipe stem	fragment	
8b	8	1	2	personal	clay	kaolin	smoking pipe	pipe stem	fragment	PET"ER" DOR"NI"
8b	8	1	1	personal	clay	kaolin	smoking pipe	pipe stem	fragment	possible Peter Dorni
8b	8	1	27	unaffiliated	ceramic	earthenware	redware	flowerpot	fragment	
8b	8	2	7	architectural	glass	tinted	flat	window	fragment	
8b	8	2	1	architectural	metal	iron	cut	nail	fragment	
8b	8	2	1	food related	ceramic	earthenware	buff-bodied	vessel	spall	interior/exterior buff glaze



Trench	Feature	Level	No.	Functional Group	Class	Material	Type	Object	Part	Description
8b	8	2	1	food related	ceramic	earthenware	creamware	bowl	fragment	no decoration
8b	8	2	2	food related	ceramic	earthenware	creamware	plate	fragment	no decoration
8b	8	2	1	food related	ceramic	earthenware	creamware	plate	fragment	molded rim
8b	8	2	12	food related	ceramic	earthenware	creamware	vessel	fragment	no decoration
8b	8	2	1	food related	ceramic	earthenware	ironstone	vessel	fragment	no decoration
8b	8	2	7	food related	ceramic	earthenware	pearlware	vessel	fragment	no decoration
8b	8	2	5	food related	ceramic	earthenware	pearlware	vessel	fragment	handpainted polychrome decoration
8b	8	2	1	food related	ceramic	earthenware	pearlware	vessel	fragment	handpainted blue decoration
8b	8	2	2	food related	ceramic	earthenware	pearlware	vessel	fragment	blue transferprint
8b	8	2	1	food related	ceramic	earthenware	pearlware	vessel	spall	blue shell edge
8b	8	2	2	food related	ceramic	earthenware	redware	vessel	fragment	traces of trailed slip decoration with pie crust rim, no glaze on exterior
8b	8	2	1	food related	ceramic	earthenware	redware	vessel	fragment	black glazed interior/exterior
8b	8	2	2	food related	ceramic	earthenware	redware	vessel	fragment	brown glazed exterior
8b	8	2	1	food related	ceramic	earthenware	redware	vessel	fragment	no glaze
8b	8	2	2	food related	ceramic	earthenware	redware	vessel	fragment	brown glazed interior/exterior with dotted dark brown decoration
8b	8	2	1	food related	ceramic	earthenware	redware	vessel	fragment	olive brown glazed interior/exterior
8b	8	2	1	food related	ceramic	earthenware	redware	vessel	spall	traces of dark brown and buff slip decoration
8b	8	2	1	food related	ceramic	earthenware	tin-glazed	vessel	fragment	no decoration
8b	8	2	2	food related	ceramic	earthenware	unidentified	vessel	fragment	burned, traces of handpainted decoration
8b	8	2	2	food related	ceramic	earthenware	whiteware	vessel	fragment	no decoration
8b	8	2	3	food related	ceramic	earthenware	whiteware	vessel	fragment	blue transferprint
8b	8	2	1	food related	ceramic	earthenware	whiteware	vessel	fragment	brown transferprint, landscape scene
8b	8	2	1	food related	ceramic	earthenware	whiteware	vessel	fragment	black transferprint, landscape scene
8b	8	2	2	food related	ceramic	earthenware	whiteware	vessel	fragment	traces of polychrome hand painted decoration
8b	8	2	1	food related	ceramic	porcelain	hard paste	teacup	fragment	trace of handpainted overglaze design
8b	8	2	1	food related	ceramic	porcelain	hard paste	vessel	fragment	plate base?, with traces of handpainted overglaze
8b	8	2	1	food related	ceramic	porcelain	hard paste	vessel	fragment	no decoration
8b	8	2	1	food related	ceramic	stoneware	gray-bodied	vessel	fragment	gray salt glazed exterior, brown glazed interior
8b	8	2	1	food related	ceramic	stoneware	gray-bodied	vessel	fragment	brown salt glazed
8b	8	2	1	food related	ceramic	stoneware	white salt-glazed	vessel	fragment	

Trench	Feature	Level	No.	Functional Group	Class	Material	Type	Object	Part	Description
8b	8	2	2	food remains	organic	bone	cow	bone	fragment	
8b	8	2	1	food remains	organic	bone	cow	bone	fragment	cut
8b	8	2	1	food remains	organic	bone	cow	long bone	fragment	cut, shank
8b	8	2	3	food remains	organic	bone	mammal	bone	fragment	
8b	8	2	1	food remains	organic	bone	mammal	unidentified	fragment	
8b	8	2	1	food remains	organic	bone	medium mammal	bone	fragment	
8b	8	2	1	food remains	organic	bone	medium mammal	rib	fragment	
8b	8	2	1	food remains	organic	bone	medium mammal	rib	fragment	
8b	8	2	1	lighting	glass	colorless		lamp chimney	fragment	
8b	8	2	2	personal	clay	kaolin	smoking pipe	pipe stem	fragment	
8b	8	2	1	personal	other	bone/iron		utensil	fragment	cut bone handle with iron in the center, top missing
8b	8	2	2	unaffiliated	metal	copper alloy	flat	sheet	fragment	
8b	8	2	2	unaffiliated	metal	copper alloy	wire	unidentified	fragment	
8b	8	2	1	unaffiliated	metal	iron		nail	fragment	with wood attached
8b	8	2	1	unaffiliated	metal	iron/copper alloy		unidentified	fragment	
8b	8	2	2	unaffiliated	organic	wood		wood	fragment	
8b	8	2	2	unaffiliated	other	coal	anthracite	coal	fragment	
8b	8	2	2	unaffiliated	other	furnace scale		furnace scale	fragment	
8b	8	2	1	unaffiliated	metal	iron	wire	unidentified	fragment	
8e	10	Interior	1	food related	ceramic	earthenware	creamware	vessel	fragment	
8e	10	Interior	1	personal	clay	kaolin	smoking pipe	pipe stem	fragment	
8e	10	Interior	1	unaffiliated	other			tar	fragment	possibly from roof

\*1 = Numerous vessels with same pattern